

INSTALLATION GUIDE

**2025 - CURRENT
CHEVROLET TAHOE SSV/PPV
FENDER WRAPS
4PBFW57T25**

Pro-gard™
PRODUCTS LLC.

STRONG. RELIABLE. SECURE.

THESE COMPONENTS ARE REQUIRED TO INSTALL THE FENDER WRAPS ON-TO THE HD PUSH BUMPER



4PBFW572500

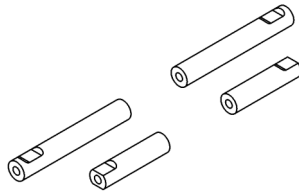
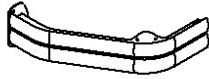

3PBFW472004
3PBFW472005

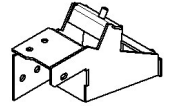
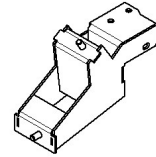
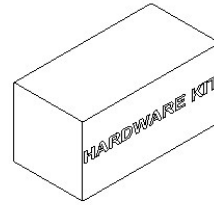

3PBFW572504
3PBFW572508

I. The following tools will be required to complete the installation

- | | | |
|-----------------------|---------------------|------------------|
| A. 10mm socket | G. 15mm wrench | M. 1.5" hole saw |
| B. 7mm socket | H. 9/16" socket | |
| C. Trim removal tools | I. 9/16" wrench | |
| D. T15 Torx | J. 3/4" socket | |
| E. Razor blade | K. 7/16" socket | |
| F. 15mm socket | L. 5/16" Hex wrench | |

II. Read all instructions and refer to the last page to ensure all parts were received

III. Fender wraps must be used in conjunction with Push Bumper. These cannot be used as a standalone item.

- A. If installing at the same time as Push Bumper, refer to Push Bumper installation instructions for fascia removal and skip to step V of this manual.
- B. If Push Bumper has been installed prior to fender wrap installation, Push Bumper will need to be removed from brackets in order to remove the fascia of vehicle. Please refer to Push Bumper installation instructions for mounting details of the Push Bumper.

WARNING: *Locate all wiring, fuel lines, brake lines, coolant lines, and refrigerant lines before drilling any holes or installing any self-drilling fasteners.*

IV. Fascia Removal

- A. Remove the plastic tray from between the grille and core support by removing the (9) plastic pop clips and the hood release extension. The hood release extension is fastened with (2) T15 torx screws.
- B. Using a 10mm socket, remove the (6) fasteners attaching the top of the grille to the core support.
- C. Using a 7mm socket, remove the (4) fasteners attaching the bottom of the fascia to the skid plate. Then move outward and remove the (1) fastener on each side attaching the bottom of the fascia to the fender liner.
- D. Switching to a T15 torx, remove the (2) rearmost fasteners per side attaching the fascia to the fender liner. Then continue around the fender liner removing the (3) remaining fasteners per side attaching the fender liner to the fascia. It is recommended to remove additional fasteners from the fender liner to allow it to be folded back for better access to the remaining fascia fasteners.

- E. Using a 7mm socket, remove the (1) lowest screw per side from the bumper clip where the fascia meets the fender. While removing the passenger side fastener, unplug the wiring harness.
- F. Using a 10mm socket, remove the (1) fastener per side attaching the lower fascia brackets to the frame by accessing it either through the fender well or from underneath the vehicle. All the fasteners securing the fascia are now removed.
- G. Pull up and forward on the top of the grille to unclip it from the core support. Unclip the fascia from the fenders by gently pulling the bumper away from the fenders. Use a trim tool to pry the chrome trim out of the headlight - there are (2) clips per side. There are two rows of clips remaining, one behind the Chevrolet logo and the other behind the top of the painted area; to release the clips, grip the grille between these two points and pull.

V. Support Bracket Installation

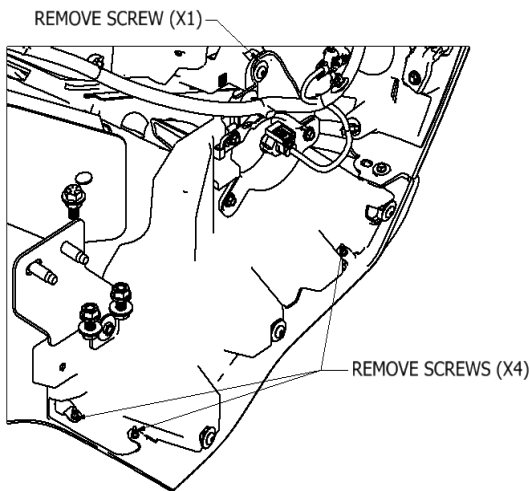

FIGURE 1

screw on the top of the bracket and 4 on the bottom. See Figure 1

- E. Cut the top portion of the bracket off as shown in Figure 2
- F. Reinstall Bracket into Fascia using the screws (X4) that go into the bottom of the fascia.

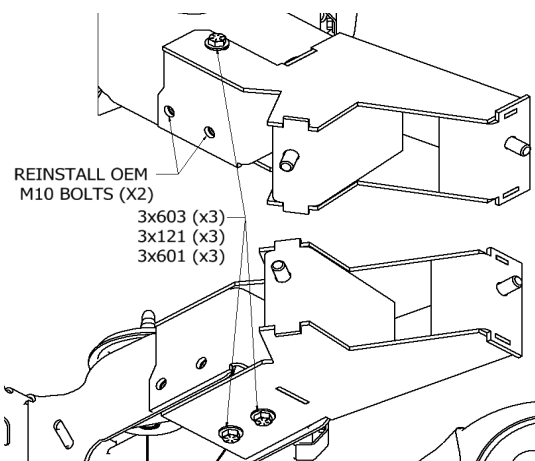

FIGURE 3

A. You must first loosen the bumper bar to gain enough clearance to install fender wrap bracket. Use a 15mm wrench to loosen 6 bolts holding the bumper bar to the front of the frame (3 per side). Complete removal is not necessary.

B. Locate outboard horns on vehicle frame that extend outwards just in front of the tires, 1 per side. Start with one side and repeat these steps for opposite side of vehicle.

C. These frame horns currently have a plastic OEM bracket bolted to them with M10 bolts. Using a 15mm socket or wrench, remove these 2 bolts and save them to use on 3PBFW572504 and 3PBFW572505.

D. On back of fascia remove the bracket that is for the fog lights. There will be one

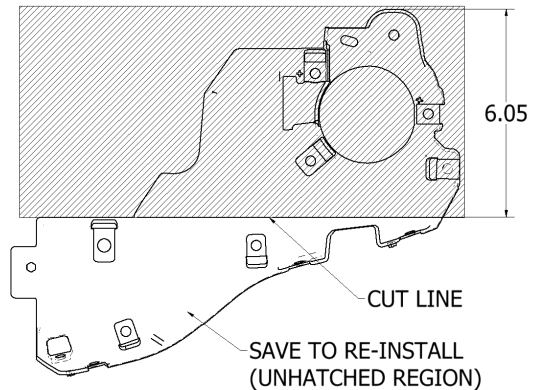

FIGURE 2

G. Place 3PBFW572504 (3PBFW572508 for passenger side) fender wrap bracket on the driver frame horn while insuring the OEM plastic bracket is in between the frame and the Pro-Gard bracket. Using the two bolts on one side and one bolt on the other, loosely secure 3PBFW2504 support bracket to the frame.

H. Using a 9/16" socket and wrench, use three supplied 3/8"- 16 bolts and whiz nuts to secure the bracket to the frame horn. The nuts will have to be installed inside the frame of the vehicle, there is access to the inside of this frame horn from the underside of the vehicle (Fig. 3).

I. Once all 3/8" and factory hardware is installed, tighten down all fasteners and repeat steps for opposite side of vehicle. Tighten fasteners holding bumper bar to frame once brackets are installed.

VI. Trimming the Fascia

- A. The fascia must first be trimmed and drilled before it can be re-installed on the vehicle.
- B. On the last page of these instructions you will find two templates that will be used to locate where the holes need to be drilled through the fascia. Take the last page and use scissors to trim the shape out. There is a cutout that will locate on the reflector on the leading edge of the front wheel wells. Line up this cutout with the reflector and then use a center punch or other similar tool to mark the center of the hole to be drilled.
- C. Once hole positions are marked, use a 1.5" diameter hole saw to drill holes into the fascia. Rough location of the driver side hole can be seen in Figure 4. This will need to be done for both sides, flip the template over to use on passenger side.
- D. Repeat this trimming for the passenger side of the vehicle.

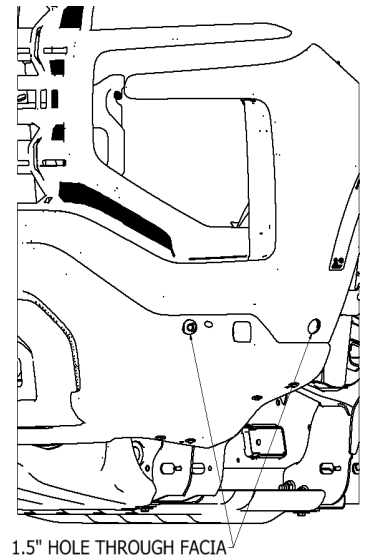

FIGURE 4

VII. Fascia Installation

- A. Reinstall the fascia by following the reverse of section IV.
- B. Reinstall Push Bumper if already equipped, if Push Bumper is being installed at same time refer to Push Bumper Installation Instructions and complete before finishing installation of Fender Wraps.

VIII. Fender wrap Installation

- A. Fender wraps will come assembled but will require slight disassembly in order to install on vehicle.
- B. Install Push bumper support rods to the fender wrap bracket through the holes in the fascia. The shorter rod (3PBFW472005—SIDE) will be closest to the door and the longer rod (3PBFW472004—FRONT) goes onto the other threaded rod. Tighten rods using a 3/4" wrench on the flats.
- C. Using a 5/16" hex wrench, remove the 2 long screws attaching the plastic black end cap and remove the cap.
- D. Using a 3/4" socket or wrench and a 5/16" hex wrench, remove the 2 bolts holding push bumper to lower push bumper bracket, these bolts will be replaced with longer bolts included with fender wraps but the nuts will be reused.
- E. Use a 3/4" socket and wrench to install 2 of the supplied 1/2"-13 x 1-1/2" (3x212) hex head bolts and reused nuts from the push bumper. Loosely secure fender wrap to push bumper.
- F. Install rounded head bolts and nuts using 5/16" Hex Key for the bolt with 3/4" Socket for the Nut.
- G. Using a 3/8" hex wrench, loosely install 1/2"-13 socket head screw with the supplied standoff to secure the back of the fender wrap to the bracket under the fascia. Tighten all hardware to secure fender wrap to vehicle.
- H. Reinstall black end caps.
- I. Repeat for opposite side of vehicle.

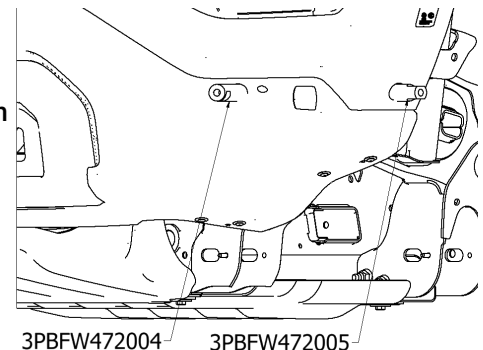

FIGURE 5

Installation complete

If you have any problems with this installation or have any questions please call (800-480-6680) and ask for technical assistance.

PARTS LIST

| ITEM | QTY | PART NUMBER | REVISION NUMBER | DESCRIPTION |
|------|-----|-------------|-----------------|---|
| 1 | 2 | 3PBFW472005 | B | FENDER WRAP SIDE STANDOFF |
| 2 | 2 | 3PBFW472004 | B | FENDER WRAP FRONT STANDOFF |
| 3 | 1 | 3PBFW572504 | B | DRIVERS FENDER WRAP MOUNT |
| 4 | 2 | 4PBFW572500 | A | TAHOE FENDER WRAP ASSEMBLY |
| 5 | 1 | 3PBFW572508 | B | PASSENGER FENDER WRAP MOUNT |
| 6 | 4 | 3X655 | A | 1/2-13 X 1" SOC HEAD CAPSCREW |
| 7 | 6 | 3X121 | | 3/8 FLAT WSHR, ZINC |
| 8 | 6 | 3X603 | A | 3/8-16 X 0.875" HEX HEAD BOLT, BLACK ZINC |
| 9 | 8 | 3X601 | A | 3/8-16 SERATED FLANGE HEX NUT, BLACK ZINC |
| 10 | 4 | 3X212 | A | 1/2-13X1 1/2 HEX CAP GR 8, BLACK ZINC |
| 11 | 4 | 3X220 | A | 1/2-13 NUT STOVER FLANGE GR8 B |
| 12 | 2 | 4PBFW472005 | A | FENDER WRAP TRIM ASSEMBLY |
| 13 | 2 | 3X656 | A | 3/8-16 X 4 HEX HEAD CAP SCREW |

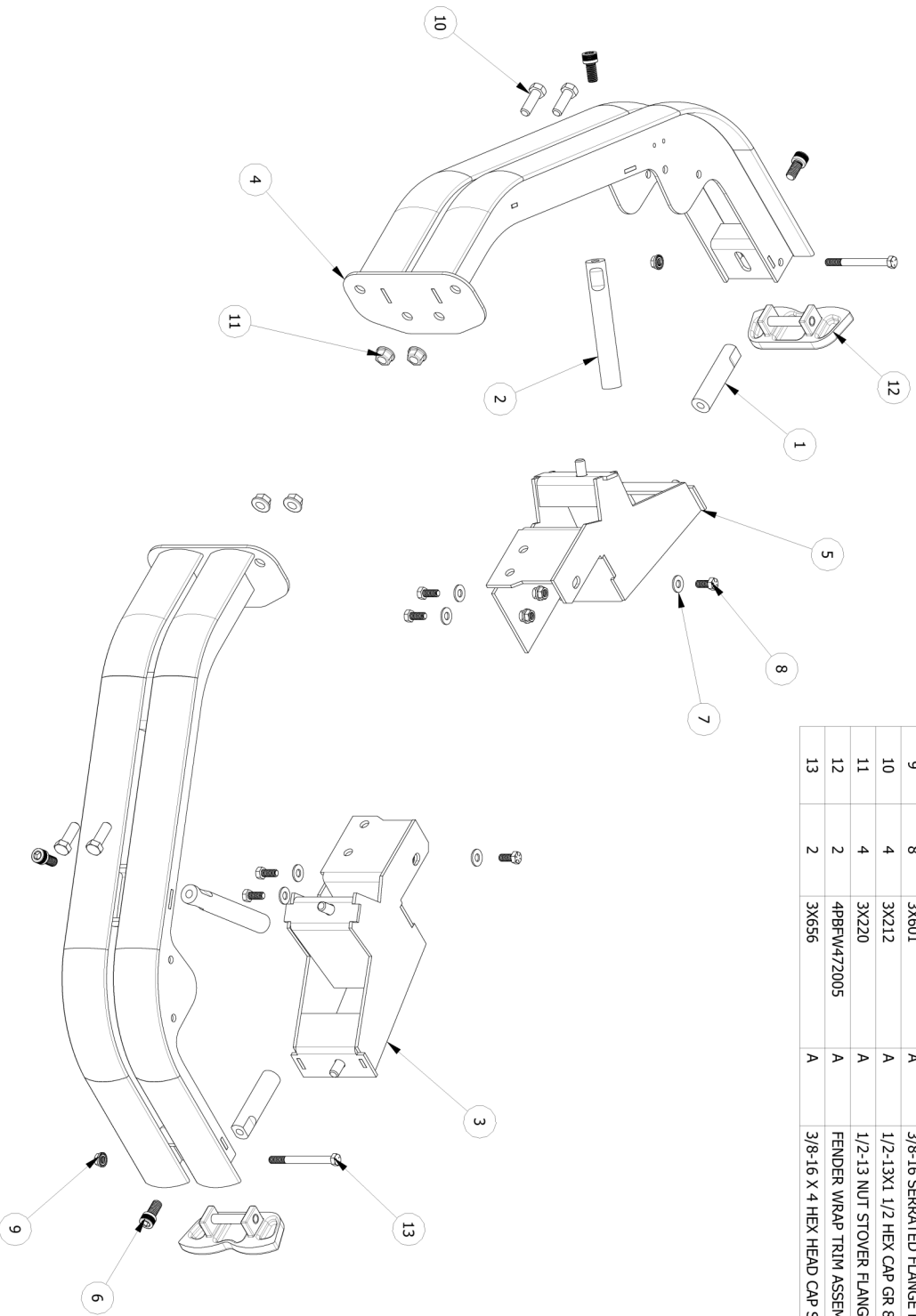

PASSENGER SIDE SHOWN

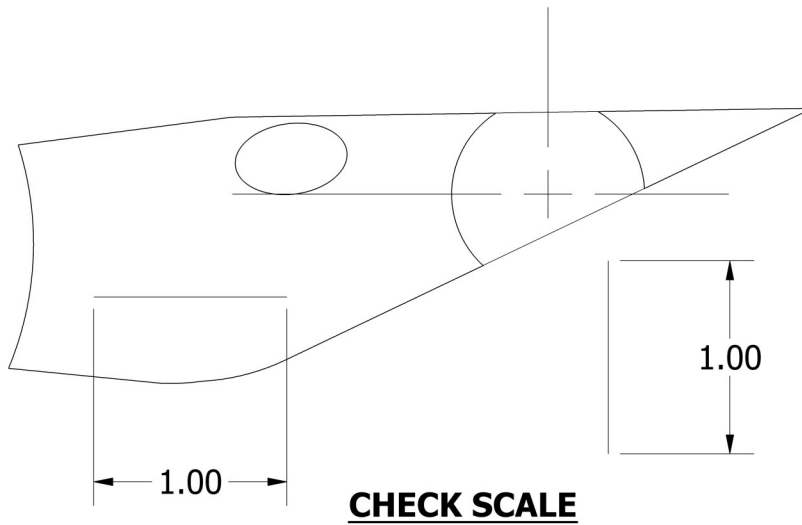
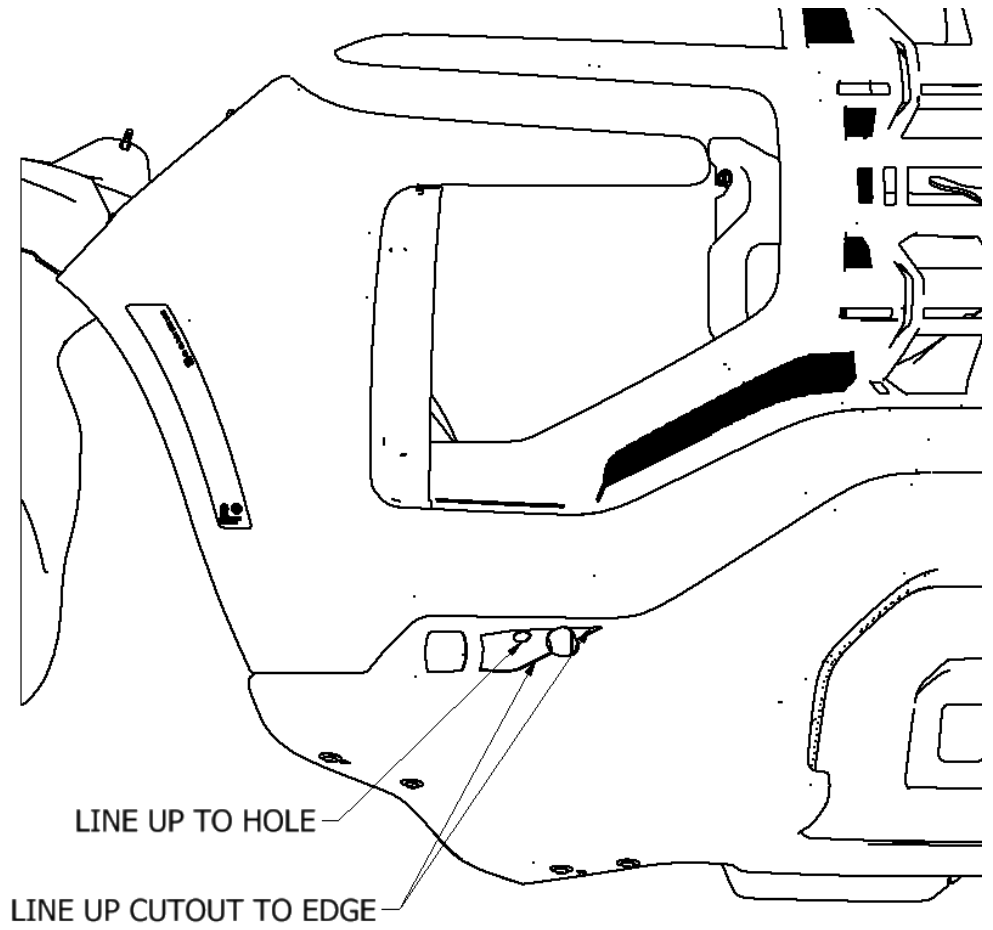

PASSENGER SIDE SHOWN

PRINT ON 8.5"X11" PAPER. FLIP FOR OTHER SIDE.

SCALE 1:1

DRIVER SIDE SHOWN

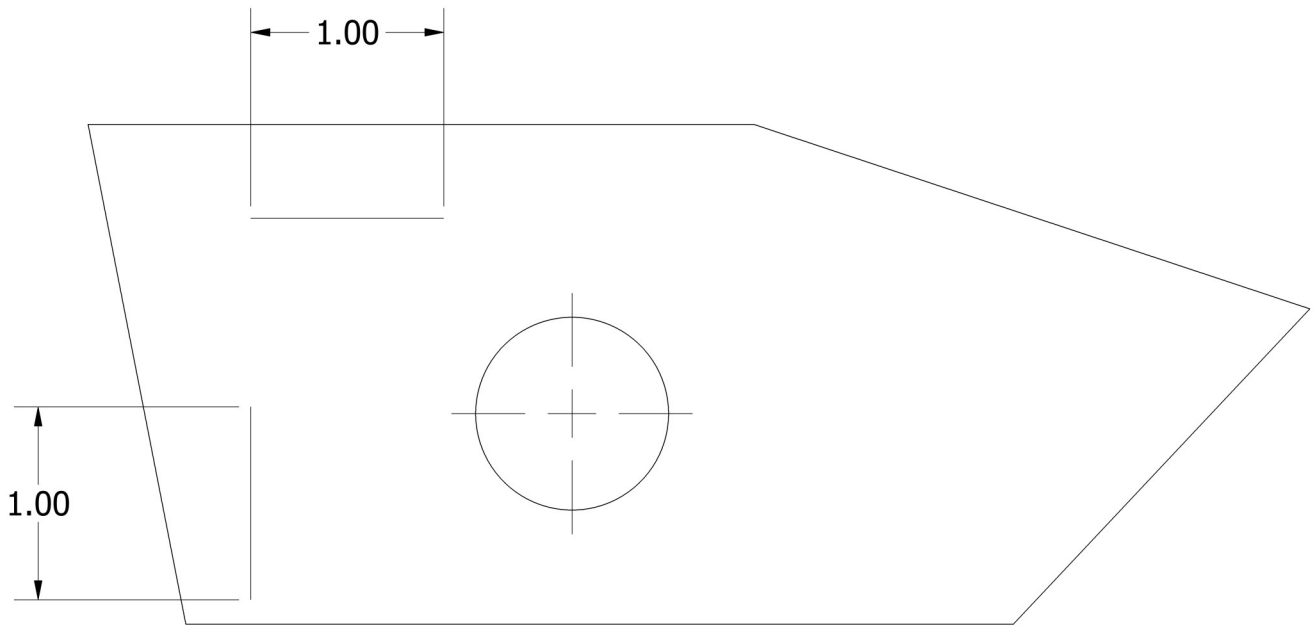
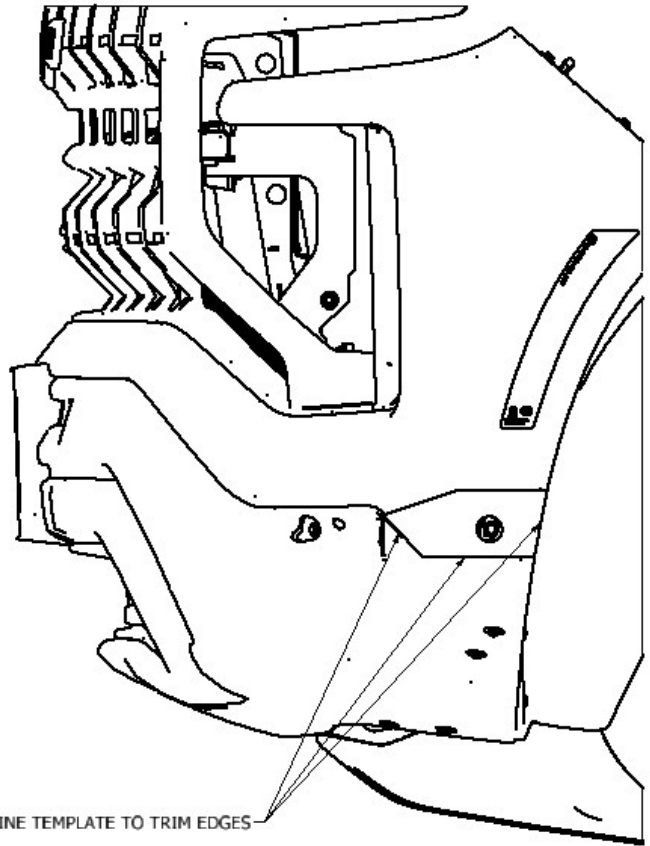

CHECK SCALE

PASSENGER SIDE SHOWN

PRINT ON 8.5"X11" PAPER. FLIP FOR OTHER SIDE.

SCALE 1:1