

INSTALLATION GUIDE

**2024+ CHEVY BLAZER EV PUSH BUMPER
PUSH BUMPER
PB51EVB24**

Pro-gardTM
PRODUCTS LLC.

STRONG. RELIABLE. SECURE.

**THESE COMPONENTS ARE REQUIRED
TO INSTALL THE PRO-GARD PUSH BUMPER**

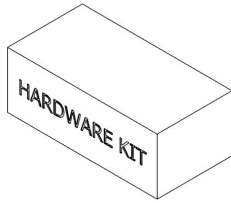

4PBK512401
HARDWARE KIT



4PBDHD
PUSH BUMPER

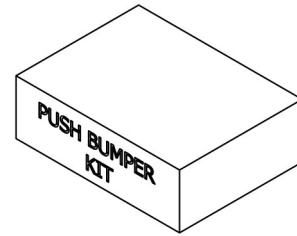

4PBK512400
PUSH BUMPER KIT

- I. Read all instructions and refer to last page to ensure all parts were received
- II. These tools will be required to complete installation

- A. Metric Sockets
- B. Standard Sockets
- C. Hex Sockets
- D. Torx Sockets
- E. Trim Removal Tools

WARNING: *Locate All wiring, fuel lines, brake lines, coolant lines, or refrigerant lines before drilling any holes or installing any self-drilling fasteners.*

II. REMOVE FASCIA

A. Wheel well

1. Move to the drivers wheel well and remove the lower front air deflector if applicable.
2. Remove the (3) T15 Torx bolts from the wheelhouse liner as seen in Figure 1

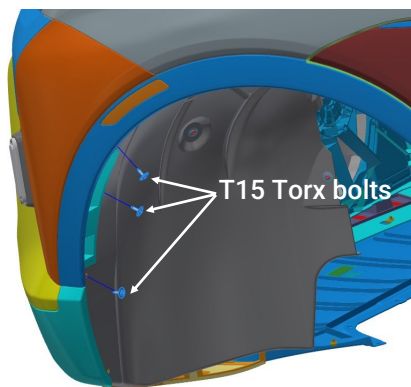

Figure 1

3. Unplug side marker
4. Remove molding. The clips you are disengaging are shown in figure 2b to visualize how they come off. Depress both sides to properly remove. *NOTE: it is possible to remove fascia by only removing the front 6 clips.*

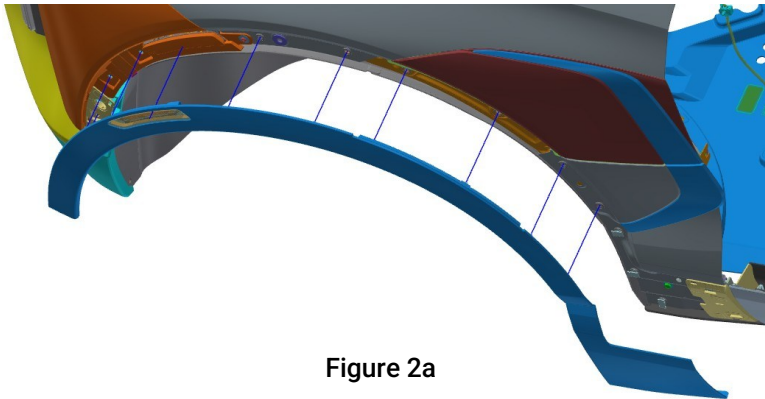
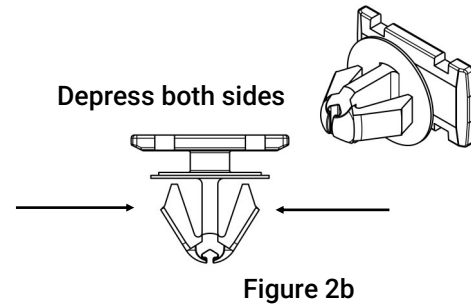

Figure 2a



5. Once the molding has been removed it will reveal the last Torx bolt, remove.

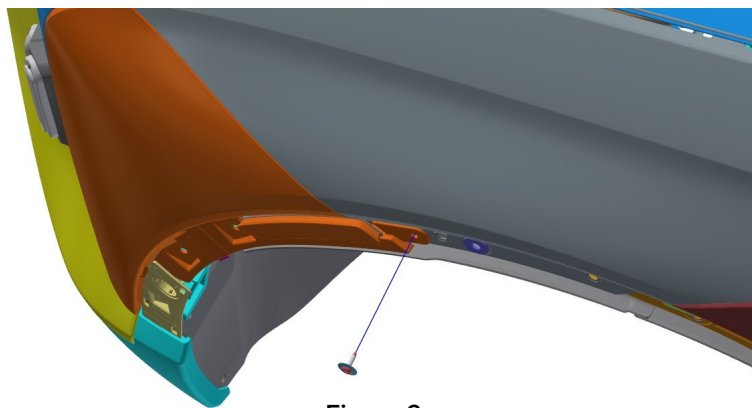

Figure 3

6. Repeat above steps on passenger side.

B. Lower Insulator Removal

1. Remove the 11 bolts from the underside (Figure 4a) with a 7mm socket.
2. Remove 4 more bolts in the recess cavities of the insulator (Figure 4b)

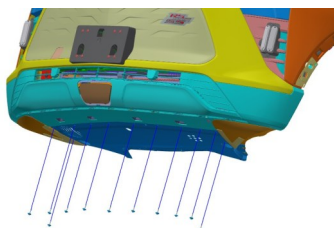

Figure 4a

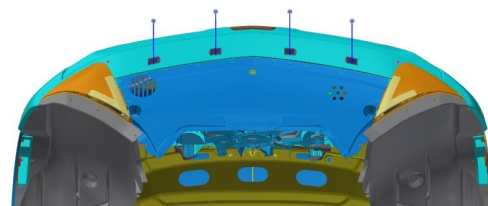

Figure 4b

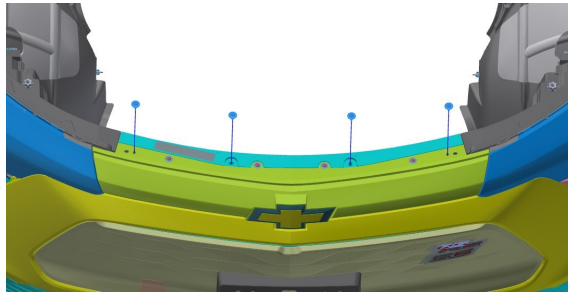

Figure 5

3. Move to the top of the engine compartment and remove the (4) Torx fasteners with a T15 bit

C. Lift Fascia off

1. Carefully push a small nylon wedge between the front bumper fascia (1) and the fascia guide. Insert a small flat-bladed tool into the fascia slot and depress the snaps one at a time and pull on the fascia at the same time to gradually remove the front bumper fascia.
2. Note the wiring harness on the passenger side, taking care not to damage, and pull the fascia from the rear and away from the vehicle in an upward motion carefully.
3. Disconnect the wiring harness.

III. REMOVE ENERGY ABSORBER

- A. Unplug the outside ambient air temperature sensor from the passenger side.

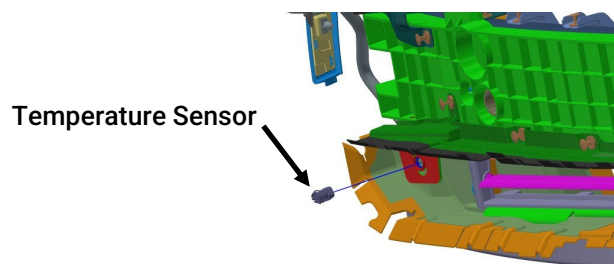

Figure 6

- B. Remove the six fasteners from the upper air baffle.

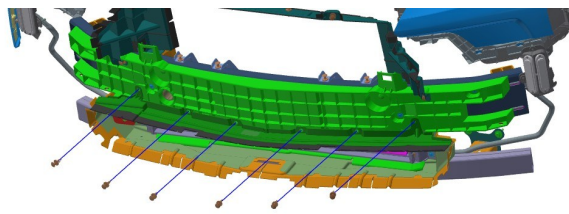

Figure 7

C. Remove the (4) bolts (Figure 8a) and (4) retainers (Figure 8b) from the energy absorber.

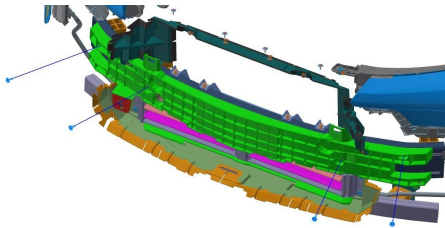

Figure 8a

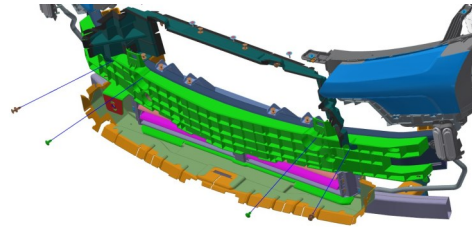

Figure 8b

D. Disconnect the wiring harness retainers and reposition the harness as necessary.

E. Set the energy absorber aside

IV. INSTALL BRACKETS

***Leave all fasteners loose until the bumper is mounted in step J

A. Using a 15mm socket remove the top two bolts holding the crash bar to the mounts (Figure 9a).

B. Install the top drivers side bracket [3PBP512400] reusing the OEM bolts.

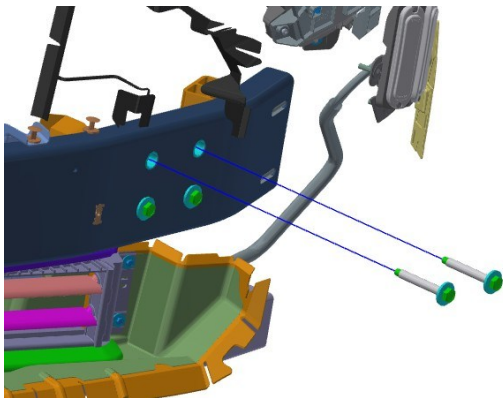

Figure 9a

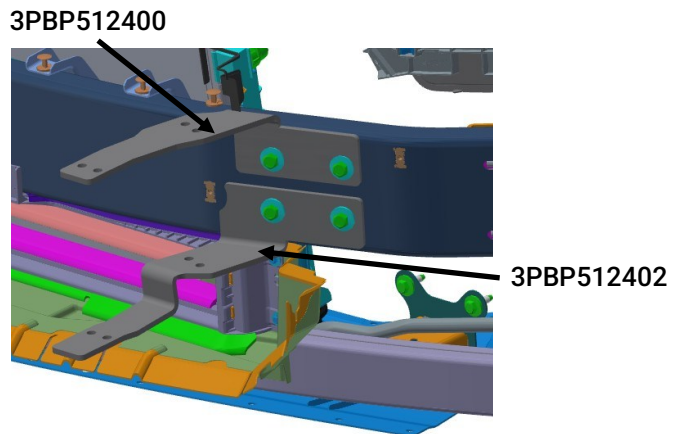

Figure 9b

C. Remove the bottom two bolts.

D. Install the lower drivers side bracket [3PBP512402] reusing the OEM bolts (Figure 9b above).

E. Trim the lower air deflector to allow the brackets to protrude through the deflector.

F. Insert the mid-bracket weldment [3PBP512404] between the upper and lower bracket. Secure with (4) [3X603] 3/8-16 bolts and (4) [3X601] 3/8-16 nuts. See Figure 10 below.

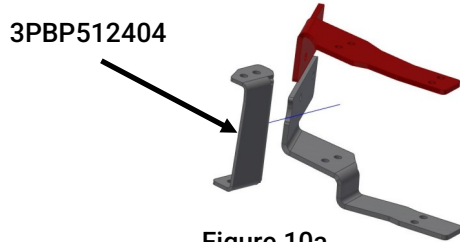

Figure 10a

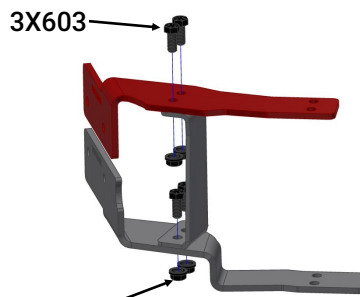
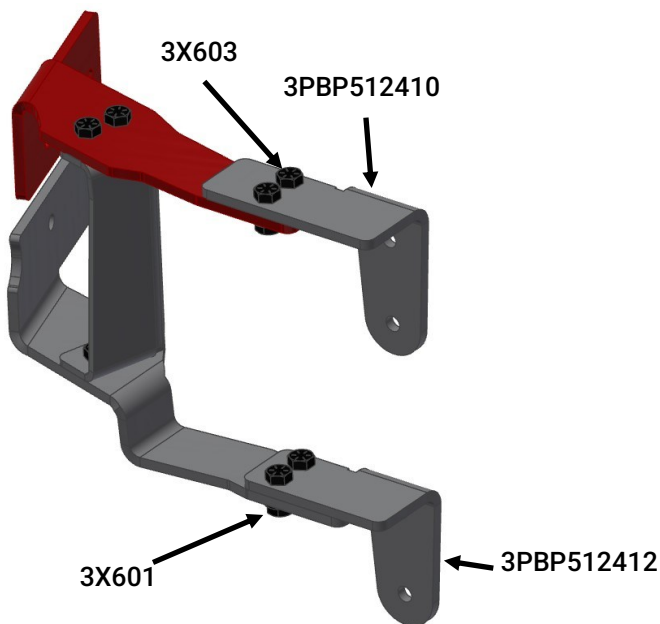

Figure 10b

G. Mount the external brackets [3PBP512410] and [3PBP512412] using (8) [3X603] and (8) [3X601]



H. Repeat above steps on passenger side with brackets [3PBP512401], [3PBP512403], [3PBP512405], [3PBP512411], and [3PBP512413].

I. Temporarily mount the bumper [4PBDHD] to the external brackets with (8) more [3X601] and [3X603] and ensure the bumper is square.

J. Tighten all bracket fasteners to vehicle (except the external brackets)

K. Remove the bumper.

L. Remove external brackets, [3PBP512410], [3PBP512411], [3PBP512412], and [3PBP512413].

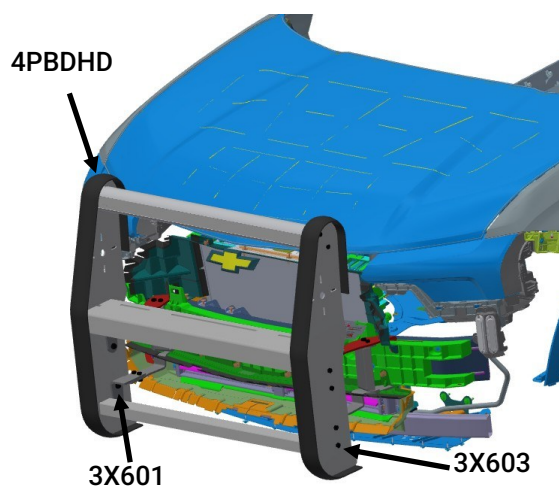

V. Re-install Fascia

- A. Reapply the energy absorber over the top of the bracketry, trimming the tab holding the external temperature sensor
- B. Remove the foam backing from the fascia and dispose.
- C. Cut rectangles to accommodate the upper external brackets using the dimensions shown below. The lower brackets will protrude through the existing openings.

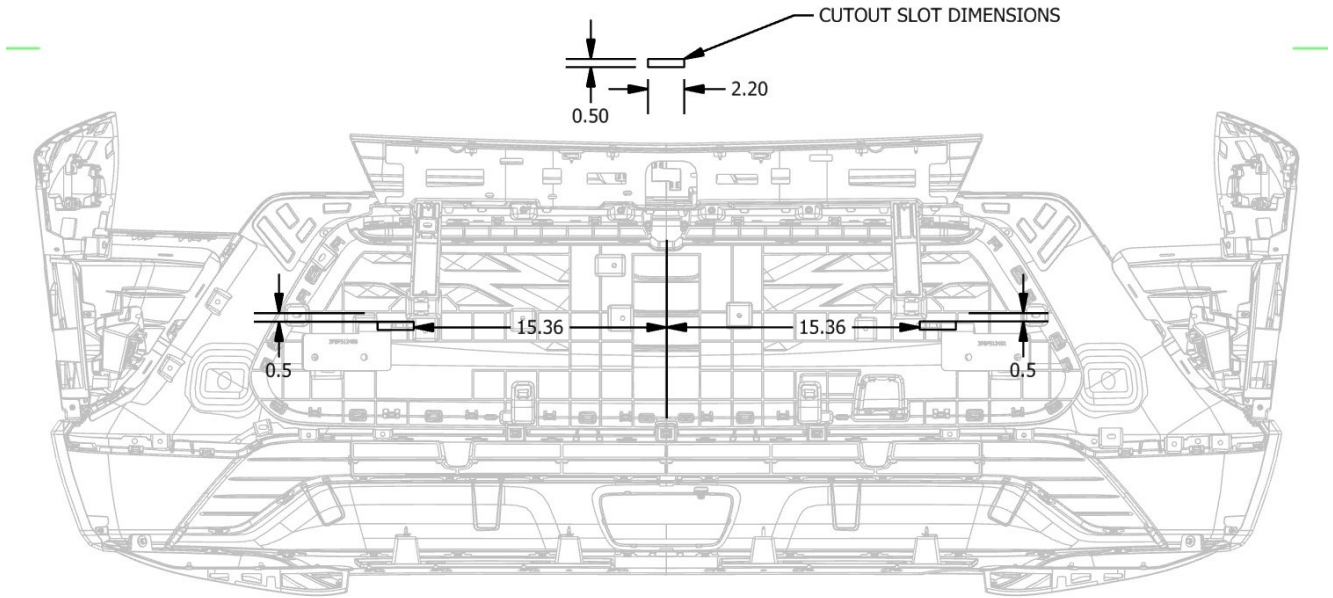

- D. Install the fascia on the vehicle reverse of the steps above.

VI. Install Bumper [4PBDHD]

- A. Reinstall the external brackets.
- B. Mount the bumper for the final time to the external brackets.
- C. The external brackets allow for small adjustments, make sure the bumper is sitting square and tighten bolts.

Installation Complete

If you have any problems with this installation or have any questions please call (800-480-6680)

PARTS LIST

ITEM	QTY	PART NUMBER	DESCRIPTION
1	1	4PBK512400	PUSH BUMPER KIT
1.1	1	3PBP512400	UPPER DS INNER PB BRACKET
1.2	1	3PBP512402	LOWER DS INNER PB BRACKET
1.3	1	3PBP512403	LOWER DS INNER PB BRACKET
1.4	1	3PBP512404	DS PB MID BRACKET WELDMENT
1.5	1	3PBP512405	PS PB MID BRACKET WELDMENT
1.6	1	3PBP512410	UPPER DS OUTER PB BRACKET
1.7	1	3PBP512411	UPPER PS OUTER PB BRACKET
1.8	1	3PBP512412	LOWER DS OUTER PB BRACKET
1.9	1	3PBP512401	UPPER DS INNER PB BRACKET
1.10	1	3PBP512413	LOWER DS OUTER PB BRACKET
1.11	1	4PBK512401	PUSH BUMPER HARDWARE KIT
2	1	4PBBDHD	HD SUV PUSH BUMPER, ASSEMBLY

