

# **INSTALLATION GUIDE**

**GVPM**  
**GUN RACK VERTICAL PARTITION MOUNT**  
**(FORMERLY G7210 SERIES)**

**Pro-gard**<sup>TM</sup>  
PRODUCTS LLC.

**STRONG. RELIABLE. SECURE.**

**THESE COMPONENTS ARE REQUIRED**  
**TO INSTALL THE VERTICAL PARTION MOUNTED GUNRACK**

This system requires a  
Space Saver or Space Saver Plus partition to be installed.

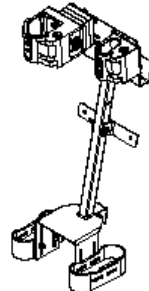

GVPM XXX

**I. The following tools will be required to complete the installation**

- |                         |                      |                              |
|-------------------------|----------------------|------------------------------|
| A. 7/16 and 1/2 Sockets | C. 7/16 Nut Driver   | E. 5/16 Drill Bit and Drill  |
| B. Ratchet              | D. 3/16 Allen Wrench | F. Phillips Head Screwdriver |

**II. Read all instructions and refer to last page to ensure all parts were received**

---

**NOTE:** *A Space Saver or Space Saver Plus partition must be installed for the gunrack to operate correctly, and is designed for use with the Space Saver recess panel.*

**WARNING:** *Locate all wiring, fuel lines, brake lines, coolant lines, or refrigerant lines before drilling any holes or installing any self-drilling fasteners.*

---

**III. Gunrack Installation**

- A. If installing in a SUV skip to step B. For installation in a sedan, find the two 5/16" holes drilled in the 1" square tube portion of the gun rack frame. Using the top hole for the Impala or the bottom hole for the Charger, attach the 3G7020C Mounting Bracket (supplied for a sedan only) (See Fig. 1) to the gun rack frame using a 3X09 screw, 3X12 washer and 3X15 acorn nut. Leave loose. The large two hole flange should face away from the locks and butt plates. (See Fig. 2)
- B. Remove the top two center carriage bolts and whiz nuts attaching the recess panel to the partition. Sedan go to step C. for a SUV go to step D.
- C. For a sedan, place the gun rack in the vehicle and reinstall the two bolts through the 3G7020C bracket, partition, and recess panel. Tighten bolts by hand.
- D. For a SUV, place the gun rack in the vehicle and reinstall the two bolts through the bottom of

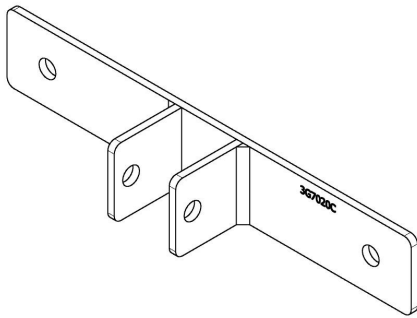

**Fig. 1**



**Fig. 2**

the top plate, partition, and recess panel. Tighten bolts by hand.

- E. Push the bottom of the gun rack frame back toward the inside of space saver panel. Mark the location of the hole in the lower mounting tab on the space saver panel. (See Fig 2)
- F. Remove the gun rack from the vehicle.
- G. Drill a 5/16" diameter hole through the recess panel at the location just marked.
- H. This would be a good time to insert the firearms and adjust each butt plate position and lock angle to the exact weapon being secured. First install the foam butt plate pads provided. Tighten lock and butt plate fasteners when properly adjusted. Remove weapons.
- I. The gun rack frame has holes provided through the upper and lower brackets to allow wiring to pass through both brackets and the square tubular portion of the gun rack weldment. Pre-wiring can be done at this time. A standard wiring diagram is provided.
- J. Re-install the gun rack as before. This time include a 3X36 carriage bolt and 3X16Z whiz nut through the lower mounting tab location just drilled.
- K. Check the complete installation for best fit and function. Tighten all fasteners at this time.

## IV. Gun Lock Switch and Timer Installation

### **NOTE:**

*Pro-gard requires the use of a 10 AMP fuse between the power source and gun lock circuit or the warranty will be voided!*

- A. We suggest mounting the momentary release button in a concealed location that can be easily reached by the officer, but would be hidden in case an unauthorized entry occurs.
- B. Connect the gun lock wiring as shown in the diagram (See Fig. 3)

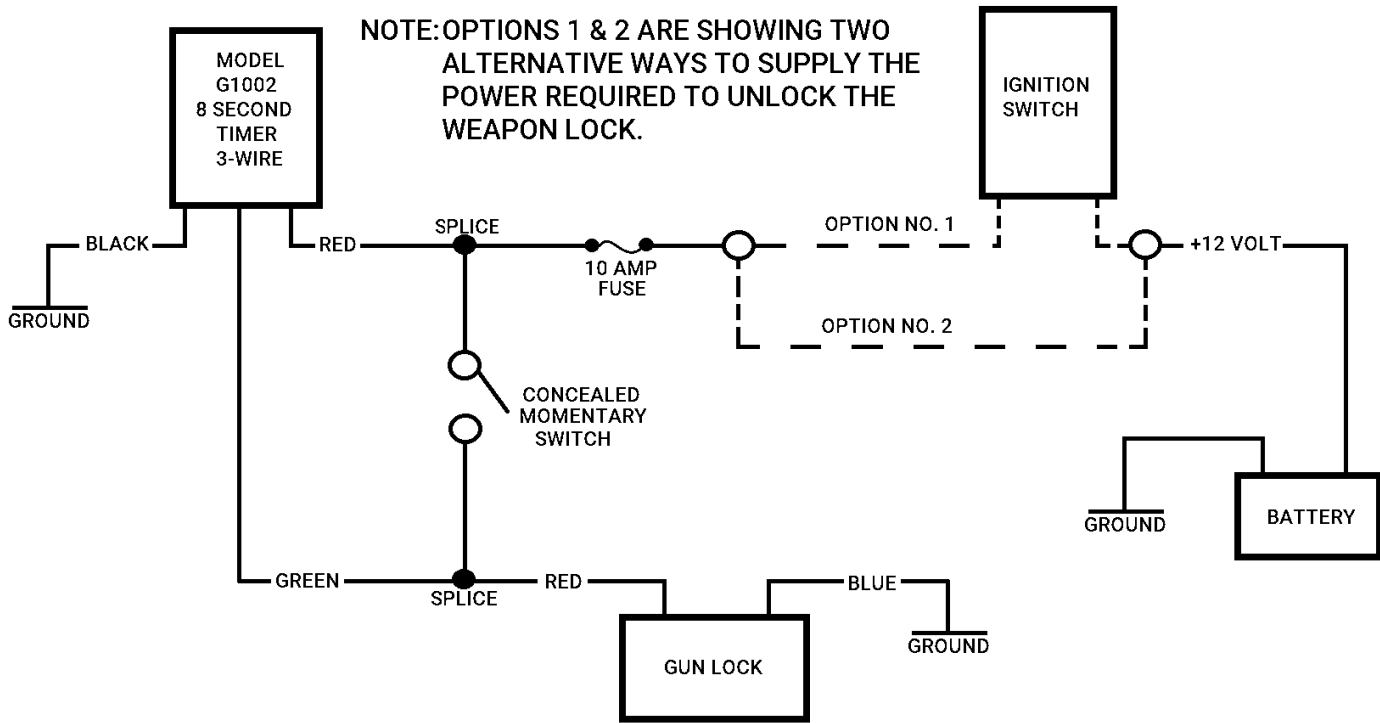

**Fig. 3**

## VI. Lock Head Operating Instructions

- A. To release, grasp the weapon, but do not pull against the lid of the gun lock.
- B. After depressing the release button (momentary switch), push and pull the weapon towards the lid of the lock to release it.

**NOTE:** *One handed operation is possible utilizing the optional 8 second timer. The timer will unlock the lock for 8 seconds following activation of the momentary switch. If the gun is not pulled out of the lock within 8 seconds after activation of the momentary switch, the lock will automatically re-lock.*

**TIP:** *If lid of the lock does not release, press in on the lid to release tension and reactivate the release button (unless timer is still active).*

## Installation complete

If you have any problems with this installation or have any questions please call (800-480-6680) and ask for technical assistance.

PARTS LIST			
ITEM	QTY	PART NUMBER	DESCRIPTION
1	1	3G7020A	RACK BASE
2	2	3G4963-002	RUBBER BUTT PLATE PAD
3	2	3G4962-002	BUTT PLATE BLACK NYLON
4	3	3G5085	LOCK SPACER (AMOUNT VARIES)
5	1	3G5082	GUN LOCK SPACER
6	4	3X184	1/4-20x0.75, SHCS, BLACK OXIDE
7	4	3X16	1/4-20 HEX WHIZ NUT - BLACK
8	2	3X16Z	1/4-20 LARGE HEX WHIZ NUT-ZINC
9	1	3X36	1/4-20 X 5/8 CARRIAGE BOLT
10	2	3X58	5/16" Wshr Split Lock, Zn/C
11	2	3X210	5/16-18x2 1/4 HEX CAP GR5 ZINC
12	2	3X33	1/4 FLAT USS WASHER, ZINC
13	2	3X75	5/16-18 x 1" HHMS, Zn
14	1	G4904R-NPG	LOCK
15	1	G4904H	LOCK SMALL STYLE H
16	1	3G7020C	BRACKET, MS MOUNTING (OPTIONAL)
17	1	3X09	1/4-20 X 1-3/4 PHIL TRUSS HD
18	1	3X12	1/4 FLAT WASHER, BLACK

