

INSTALLATION GUIDE

**WSD47UINT20FS WEAPON STORAGE DRAWER
ASBD47UINT20FS ALUMINUM STORAGE DRAWER
2020 FORD INTERCEPTOR UTILITY**

Pro-gardTM
PRODUCTS LLC.

STRONG. RELIABLE. SECURE.

THESE COMPONENTS ARE REQUIRED TO INSTALL THE STORAGE DRAWER

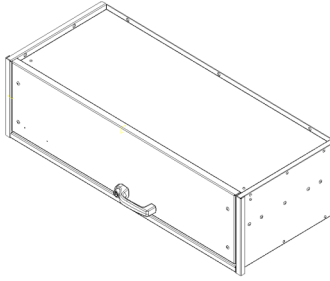

ASBD47UINT13

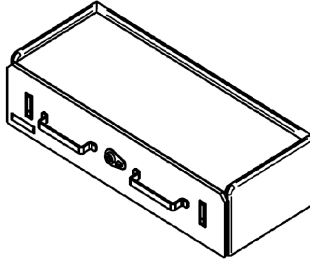

WSD47UINT13



4WSK472002

I. The following tools will be required to complete the installation of free standing drawer systems

- | | | |
|---------------------------|--------------------------|-------------------------|
| A. 7/16" Deep Well Socket | C. 15mm Deep Well Socket | E. 8mm and 18mm Sockets |
| B. 5/32" Allen Wrench | D. T55 Torx Driver | F. 1.25" Hole Saw |

II. Read all instructions and refer to last page to ensure all parts were received

Note: *Storage Drawers may be installed with or without barrier in place. If barrier is to be used, follow its instructions and install it first. Storage drawer brackets will be placed over previously installed barrier brackets.*

Warning: *Locate All wiring, fuel lines, brake lines, coolant lines, or refrigerant lines before drilling any holes or installing any self-drilling fasteners.*

III. Cargo Area Preparation

- A. Remove the rear load floor from above the spare tire.
- B. Using a T55 Torx driver remove the two bolts from the remaining front section of the load floor.
- C. Remove the front section of the load floor.
- D. Using a 8mm socket remove the two bolts attaching the rear sections of foam to the vehicle.
- E. Remove the two rear sections of foam.
- F. Unplug the OEM upfitter power terminal and feed all wires to the underside of the foam.
- G. Remove the front section of foam.

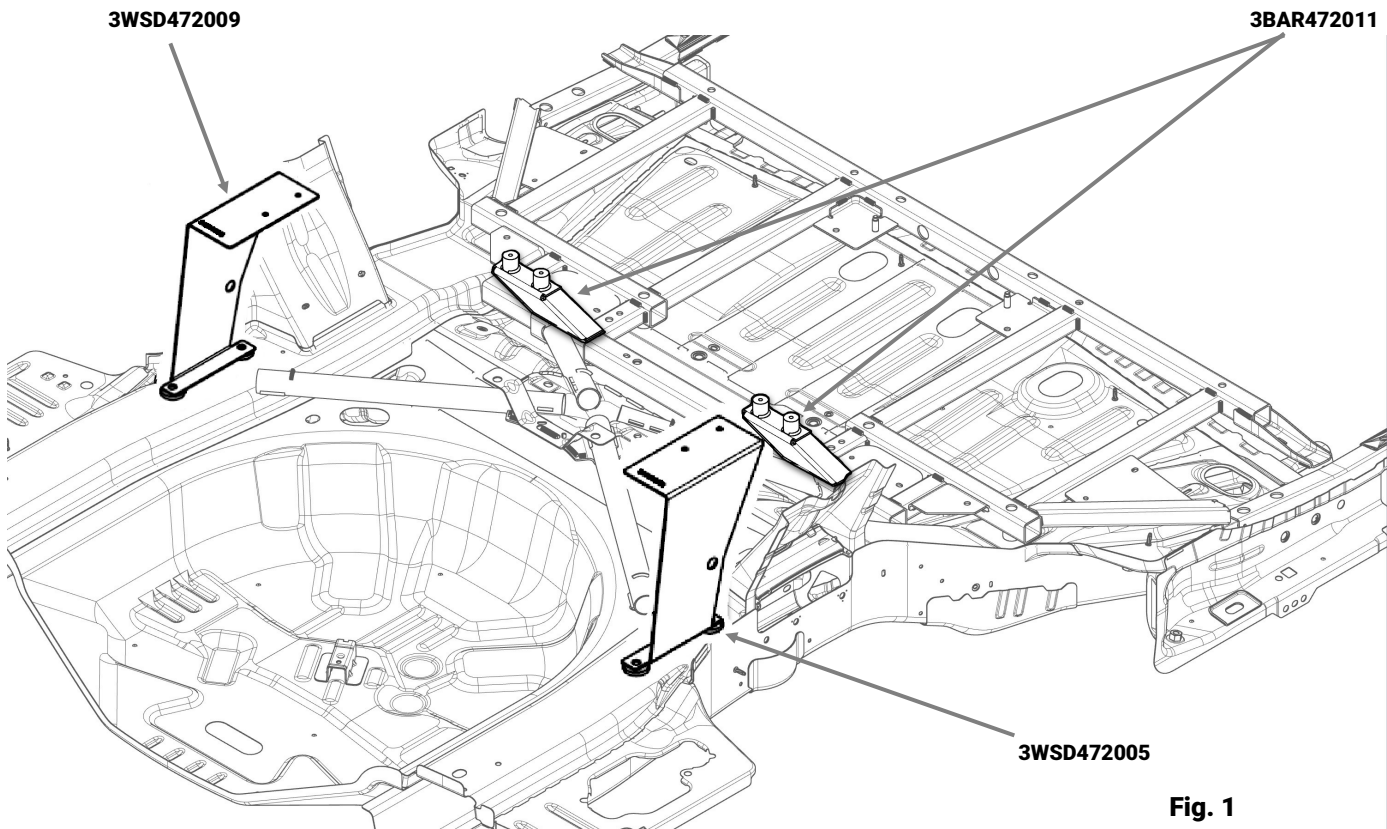

Fig. 1

IV. Install Lower Front and Rear Support Brackets

- A. Remove the two front driver side bolts from the OEM X-brace using a 18mm socket.
- B. Place (1) Barrier Support Bracket [3BAR472011] on top of the X-brace with the standoffs towards the rear of the vehicle. Set the front edge of the bracket just behind the front edge of the X-brace. Reinstall the OEM bolts and torque to factory specifications.
- C. Remove the two rear driver side bolts from the OEM X-brace with an 18mm socket.
- D. Place [3WSD472003] over the holes in the OEM X-brace with circular spacers facing downward.
- E. Place the Driver Side Weapon Storage Drawer Bracket [3WSD472009] on top of the rear spacer [3WSD472003] with the tall part of the bracket towards the front of the vehicle. Reinstall the OEM bolts and torque to factory specifications.
- F. Repeat Steps A - D for the passenger side with the second Barrier Support Bracket [3BAR472011] and the Passenger Side Barrier Bracket [3WSD472005].

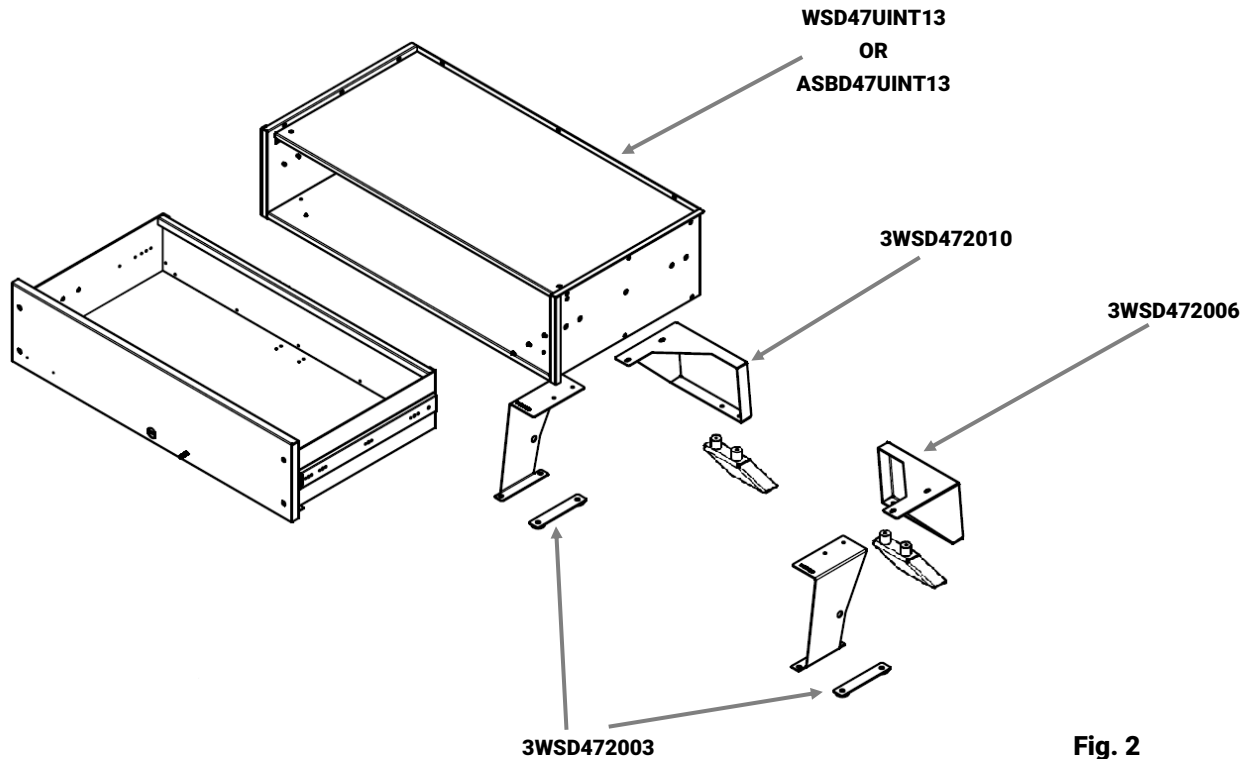

Fig. 2

V. Reinstall the Load Floor

- A. Test fit the front section of foam and mark the locations that need to be trimmed to fit around the Barrier Support Brackets [3BAR472011].
- B. Trim and reinstall the front foam section.
- C. Reinstall the two rear sections of foam and tighten the two bolts using a 8mm socket.
- D. Place the front section of the load floor into the vehicle and mark the locations where the Barrier Support Brackets contact the underside of the floor.
- E. Using a Ø1.25" hole saw, drill the necessary clearance to allow the front section of the load floor to sit in place.
- F. Reinstall the front section of the load floor and install the two fasteners that secure it using a T55 Torx driver.
- G. Reinstall the rear section of the load floor. Trim as necessary to fit around the rear Barrier Brackets/WDS Brackets.

VI. Install Front Brackets and Storage Drawer

- A. Place [3WSD472010] and [3WSD472006] Front WSD Brackets over (2) [3BAR472011] Barrier Support Brackets and use 5/32" Allen wrench to attach (4) [3X75] screws.
- B. Remove the sliding drawer from the storage drawer unit by depressing the tabs on the slides at each end and pulling it free.
- C. Pass (8) [3X001] carriage bolts through the inside of the box and through the holes on the corresponding mounting brackets. Using a 7/16" socket, tighten (8) [3X16Z] whiz nuts on the bottom of the fasteners to affix the drawer unit to the brackets.
- D. Carefully reconnect the slides at each end of the sliding drawer and close it into the storage drawer unit. Verify that the drawer opens and closes properly.

Installation complete

If you have any problems with this installation or have any questions please call (800-480-6680) and ask for technical assistance.

PARTS LIST			
ITEM	QTY	PART NUMBER	REVISION NUMBER DESCRIPTION
1	1	3WSD472009	B WSD BRACKET, DS REAR
2	1	3WSD472005	B WSD BRACKET, PS REAR
3	1	3WSD472006	B WSD BRACKET, FRONT PS
4	1	3WSD472010	B WSD BRACKET, FRONT DS
5	2	3WSD472003	A WEAPONS STORAGE DRAWER BRACKET, REAR SPACER
6	2	2BAR472003	C BARRIER SUPPORT BRACKET
7	1	4WSK472002-A	A KIT, WSD HARDWARE 2020 UTILITY
7.1	8	3X16Z	1/4-20 LARGE HEX WHIZ NUT-ZINC
7.2	8	3X001	1/4-20 X 3/4 CARRIAGE BOLT
7.3	4	3X75	5/16-18 x 1" HHMS, Zn

