

INSTALLATION GUIDE

**2021 - CURRENT
CHEVROLET TAHOE
TRANSPORT SEAT AND OSB RETRACTOR SYSTEM
S5702T21OSB-R, S5705T21OSB-R**

Pro-gardTM
PRODUCTS LLC.

STRONG. RELIABLE. SECURE.

**THESE COMPONENTS ARE REQUIRED
TO INSTALL THE TRANSPORT SEAT**

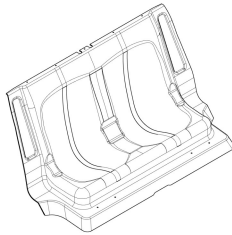

3TRS572157

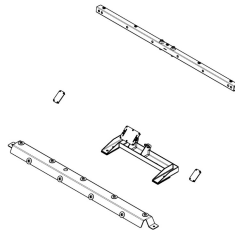

4OSBK5721-R

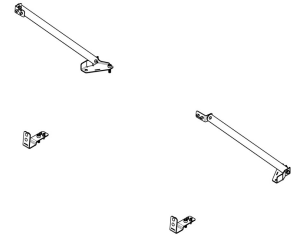

4BAK572100

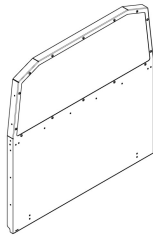

4BAR572100

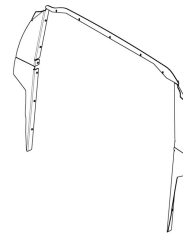

4WIK572110

NOTE: These products are not compatible with the ATZ “seat delete, second row” option

I. The following tools will be required to complete the installation

- | | | |
|-----------------|---------------------|---------------------------------|
| A. T50 torx | D. 5/8" socket | G. #2 Phillips head screwdriver |
| B. T25 torx | E. 5/8" wrench | H. Razor blade |
| C. 5.5mm socket | F. 7/32" hex wrench | |

II. Read all instructions and refer to the Parts List to ensure all parts were received.

WARNING: *Locate all wiring, fuel lines, brake lines, coolant lines, and refrigerant lines before drilling any holes or installing any self-drilling fasteners.*

III. OEM Seat Removal

- Remove the plastic trim pieces from the front side of the second row seats to gain access to the front fasteners.
- Using a T50 torx driver, remove the (4) bolts from the front of the second row seats.
- Tumble the seats forward and remove the (5) bolts from the rear of the second row seat rails. The seats should now be loose.
- Remove both seats from the vehicle. Keep the OEM fasteners removed in steps B. and C. in the car as they will be reused.

IV. Preparation

- Remove the tire change tools and then use a 5.5mm socket to remove the stud they were mounted to.
- Unscrew and remove the plastic cap from the stud on the passenger side of the vehicle. It may be necessary to use Channellock pliers or similar to initially loosen the cap.

- C. Trim the floor covering with a razor blade or similar to clear the Center Support Bracket [3OSB572101] and retractor bracket [3OSB572120]. The location of these brackets is detailed in section VI.
- D. Using a T50 torx, remove the lower seatbelt bolts from the C-pillars. This is necessary to be able to fit the seat into the vehicle.
- E. When installing a full OSB-R/OSB system, remove the rear quarter trims, remove the trim piece that snaps into the C-pillar trim from the OEM belt, and secure the OEM belts behind the trim panels. If installing a P1000 OSB-R/OSB with only a single belt, remove the trim from and secure only the passenger side belt. Reinstall the rear quarter trim(s) and the trim pieces removed from the belt(s).
- F. Install the Barrier and Barrier Kit per the instructions included with those items.

V. Seat Top Tube Installation

- A. Locate the OSB / Seat Bar [3OSB572122], (4) 5/16" button head screws [3X149], and (4) 5/16" whiz nuts [3X619].
- B. Remove the (4) button head screws [3X149] from the front of the Barrier holding the rear L-brackets on. Try to keep the L-brackets in place as it will ease reinstallation of these fasteners later.
- C. Orient the OSB Bar [3OSB572122] such that the (12) smallest holes face upward and the (8) largest holes face the front of the vehicle.
- D. Attach the OSB Bar to the barrier with the (8) total button head screws and (8) whiz nuts. Insert the screws from the front of the vehicle through the large holes in the OSB bar and fasten with the whiz nuts on the back side of the barrier (Fig. 1).

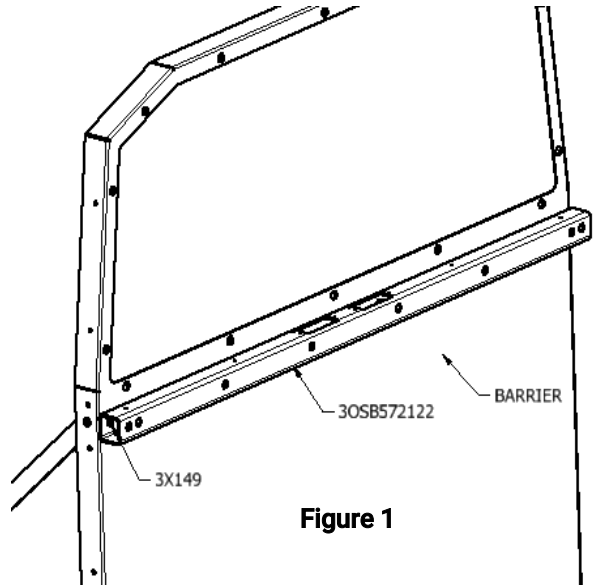

Figure 1

VI. Lower Bracket Installation

- A. Prior to installation in the vehicle, the center support bracket [3OSB572101] must be bolted to the retractor bracket [3OSB572120] using the supplied 7/16" bolts [3X616] and 7/16" nuts [3X614]. Align the 3 holes in each bracket and make sure the bottom of both brackets are flush. (Figure 1)
- B. Once center support bracket is securely fastened to the retractor bracket, install retractors to the retractor base with supplied GR.8 bolts [3X616] and GR.8 nuts [3X614]. Use the supplied button head bolt [3x258] and small flange whiz nuts [3X16] to prevent the retractors from pivoting around the main bolts. (Figure 3)

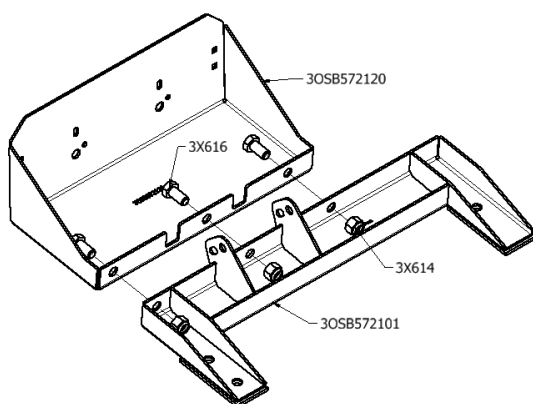

Figure 2

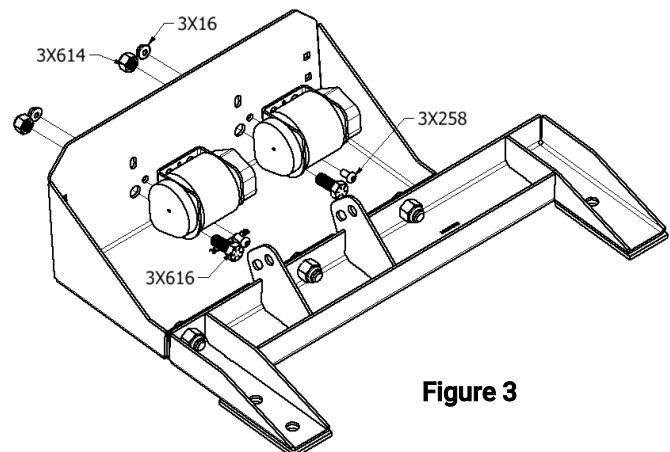

Figure 3

- C. Locate the seat bracket [3TRS572110] and orient it in the vehicle such that the long angled flange faces forward.
- D. Align the Seat Bracket with (3) of the front holes from the second row seats and install (3) of the OEM bolts that were removed from the seats.
- E. Locate the Center Support Bracket [3OSB572101] with retractor bracket [3OSB572120] and align them as shown in Figure 4 (barrier omitted for clarity).
- F. Ensure the Center Support Bracket is sitting flat on the sheet metal floor pan of the vehicle and then install (3) of the OEM bolts that were removed from the seats.

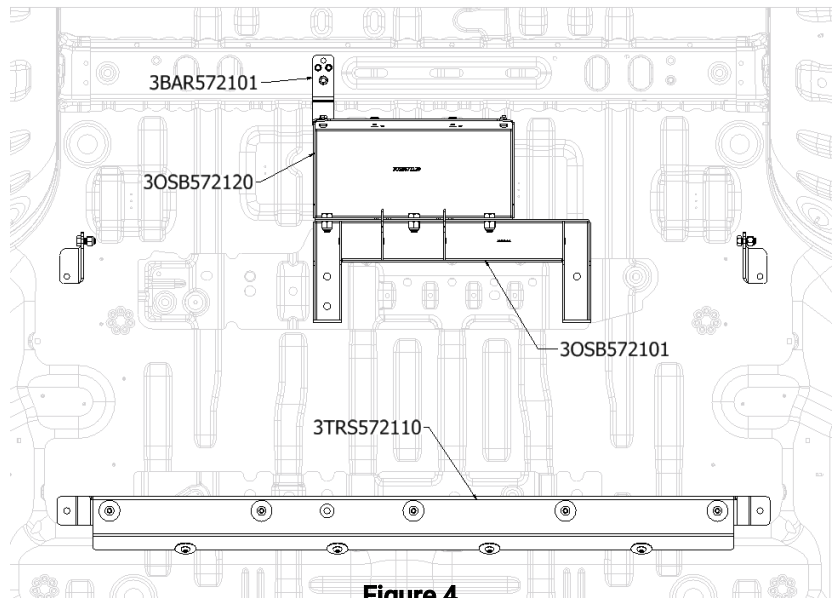

Figure 4

- G. Install 3rd barrier support bracket [3BAR572101] behind barrier with supplied M10 bolt [3X254] and self tapping screws [3X62]. Ensure square holes in bracket align with square holes in barrier and retractor bracket.
- H. Use supplied 1/4" carriage bolts [3X36] and large flange whiz nuts [3X612] to secure retractor base to barrier, inset bolts from the passenger compartment and install nuts on back side of barrier in the cargo area. Bolts will go through 3rd barrier bracket on passenger side of retractor bracket.
- I. Locate the Passenger Seatbelt Bracket [3OSB572103] and place it over the rear outboard hole which was used by the seat. Orient the bracket such that the rectangular flange is against the floor pan and the triangular flange is toward the inside of the vehicle (Fig. 3).
- J. Place the Lower Buckle [3OSB109RP] against the outside of the bracket and align the long edge of the stake with the rear face of the Seatbelt Bracket. Securely fasten with (1) 7/16" hex bolt [3X616] and (1) 7/16" nylon lock nut [3X614].
- K. If installing an OSB belt on the driver side of the vehicle repeat steps E. and F. for the driver side with the Driver Seatbelt Bracket [3OSB572102], the second Lower Buckle [3OSB109RP], (1) hex bolt [3X616], and

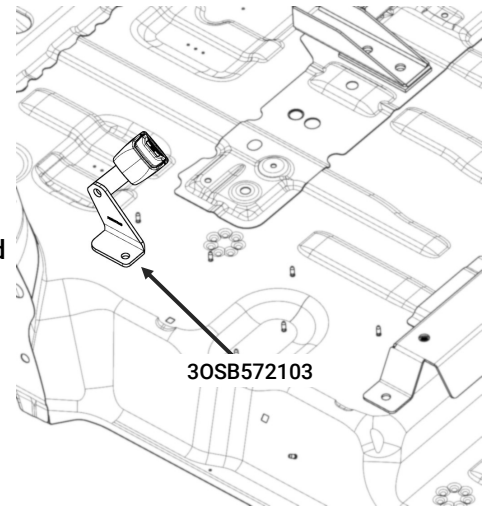

Figure 5 (1) nylon

VII. Initial Belt Installation

- A. Feed each belt through their respective slots in the OSB bar, ensure belts do not twist.
- B. Place the Transport Seat [3TRS572157] into the vehicle and run the lower anchor points of the (2) belts through the hole in the center of the seat. Secure the anchor points in place on the Center Support Bracket using (1) hex bolt [3X616] and (1) nylon lock nut [3X614] per belt.
- C. If using the P1000 OSB-R/OSB with only a passenger side belt, attach the OEM buckle to the driver side of the Center Support Bracket using Gr.8 bolt [3X616] and Gr.8 nut [3X614]. The tab on the end of the buckle should locate in the slot behind the hole on the bracket. Attach the OSB belt to the passenger side of the Center Support Bracket using same hardware.

VIII. Seat Installation

- A. Prepare (9) 3/8" button head screws [3X247] with (9) large washers [3X224] and (4) #10 torx self threading screws [3X615] with (4) small washers [3X12].
- B. Slide the seat backwards into position against the barrier and the Seat Bracket. Loosely start each of the (9) 3/8" fasteners with washers into the Seat Bracket and then install the (4) #10 screws with washers along the top of the seat. If the Lower Buckle(s) [3OSB109RP] are present, ensure they align with the outer pockets in the seat.
- C. Use a T25 torx to tighten the #10 screws along the top of the seat and then use a 7/32" hex wrench to tighten the fasteners along the bottom of the seat.
- D. Reinstall the OEM lower seatbelt fasteners that were removed in section IV step D. Use a T50 torx to torque to factory specifications. If using the OSB system, this fastener helps to cover a hole in the trim.

IX. Cover Plate and Puck Installation

- A. Locate the Center Panel [3TRS572122] and (10) phillips head screws [3X72]. Feed each of the seatbelt webs into the corresponding slot on the panel - with OEM belts, feed the web into the slot just below where it is stitched to attach to the buckle itself. Align the Center Panel over the center hole in the seat, orient as desired, then secure to the seat using the (10) phillips screws.
- B. If using the OSB system, locate the (2) OSB Pucks [3TRS572120]. These are ABS rectangles with a cutout in the center to match the profile of the Lower Buckles. Slip a Puck over one of the Lower Buckles, center in the seat pocket, secure using (4) phillips head screws [3X72], then repeat for the other side.
- C. If using the P1000 OSB system, locate the solid outer cover panel [3TRS572121]. Align cover panel over driver side outer hole, secure using (4) Philips head screws [3X72]. Follow step B. for passenger side.
- D. Install upper seat belt trim [3OSB472069] on to the OSB bar by sliding the belts through their respective slots (slot openings should face rear of vehicle) and secure the trim piece with (8) self tapping screws [3X615]. Be careful not to overtighten and crack the trim piece.
- E. Locate the Passenger Cover Puck [3OSB572110] and (5) phillips head screws [3X72]. Align the puck over where the shoulder portion of the OEM belt used to come out of the C-pillar - the puck should line up perfectly with the trim piece that was removed from the OEM belt. If it does not line up correctly, try the other puck as they are different. Once aligned, secure to the trim piece with the (5) screws.
- F. Repeat step C. for the driver side (disregard if using P1000 OSB system) with the Driver Cover Puck [3OSB572111] and (5) additional screws [3X72].

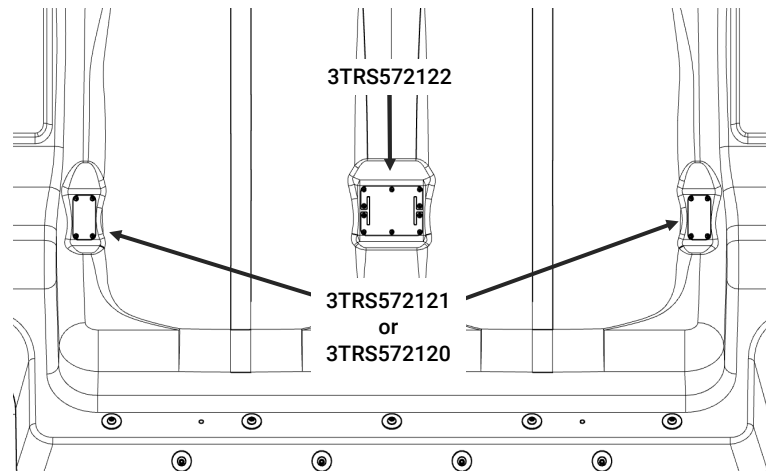

Figure 6

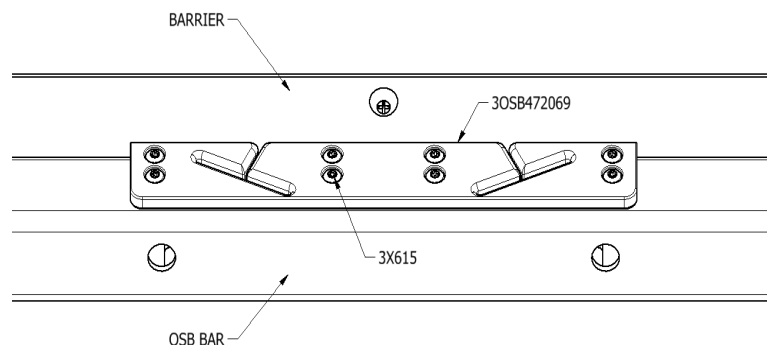

Figure 7

- G. Locate (1) Partition Buckle [3OSB109RP-1], (2) 1/4" carriage bolts [3X36], (2) 1/4" whiz nuts [3X16Z], and (2) plastic nut caps [3X145]. Position the Partition Buckle in the desired belt park position on the passenger Partition Mounting Plate, mark the location for (2) holes, drill the holes, then attach the buckle to the partition with the hardware gathered. Repeat for the driver side if using a full OSB system. Figure 8 shows the recommended position for the Partition Buckles.

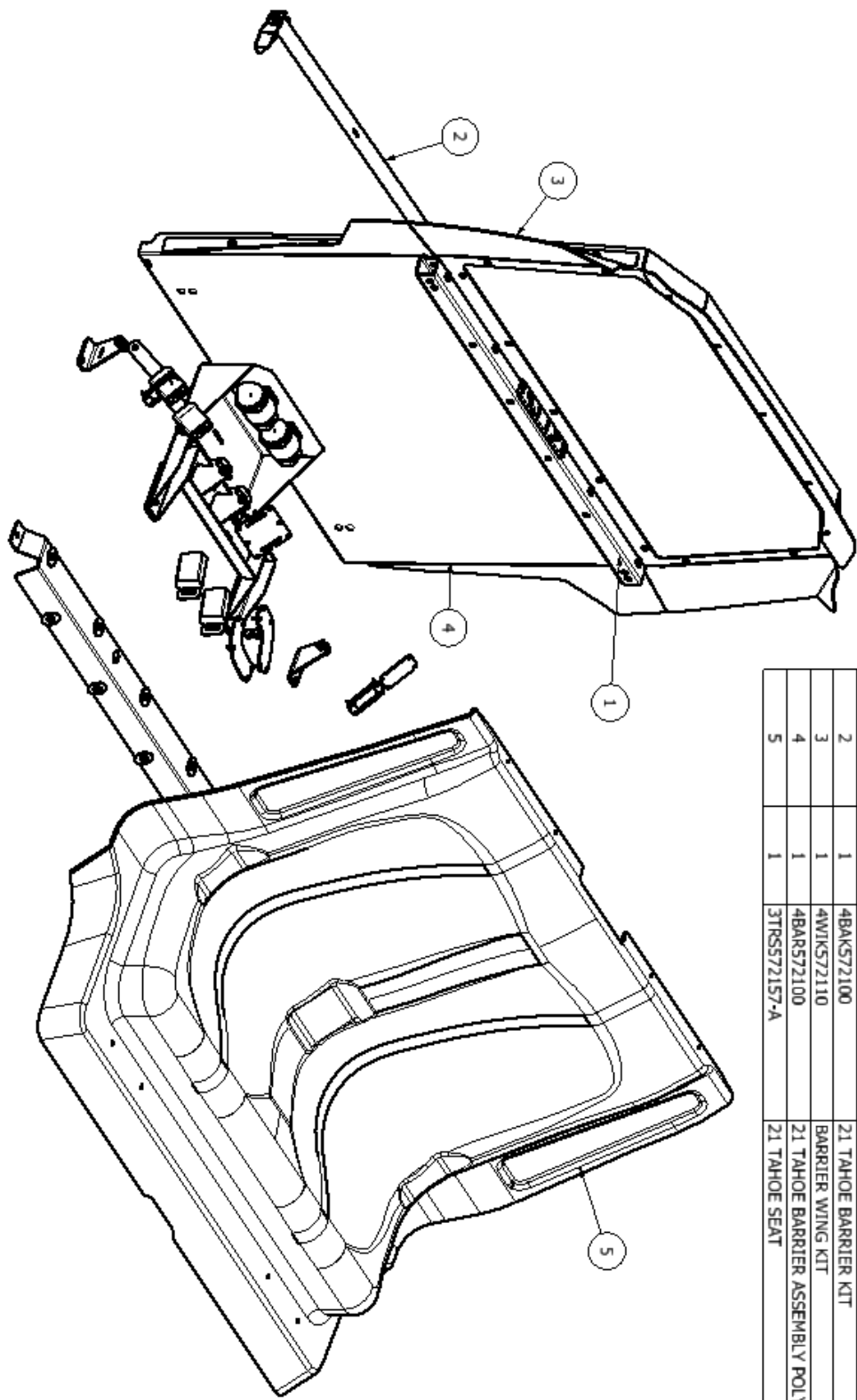

Figure 8

Installation complete

If you have any problems with this installation or have any questions please call (800-480-6680) and ask for technical assistance.

PARTS LIST			
ITEM	QTY	PART NUMBER	DESCRIPTION
1	1	40SBK5721R	RETRACTABLE SEAT BELT KIT
2	1	4BAK572100	21 TAHOE BARRIER KIT
3	1	4WIK572110	BARRIER WING KIT
4	1	4BAR572100	21 TAHOE BARRIER ASSEMBLY POLY
5	1	3TRSS72157-A	21 TAHOE SEAT



**Note: Poly Window
with OSB shown,
parts will vary**