

# ***INSTALLATION GUIDE***

2020 - CURRENT  
FORD POLICE INTERCEPTOR UTILITY  
TRANSPORT SEAT WITH RETRACTABLE OSB SYSTEM  
S4702UINT20OSBR  
S4705UINT20OSBR

**Pro-gard**<sup>TM</sup>  
PRODUCTS LLC.

**STRONG. RELIABLE. SECURE.**

**THESE COMPONENTS ARE REQUIRED**  
**TO INSTALL THE TRANSPORT SEAT**



3TRS472022

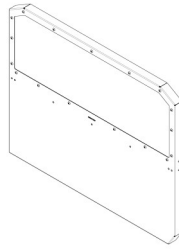

4BAR472000  
/4BAR47200

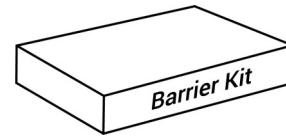

4BAK472000

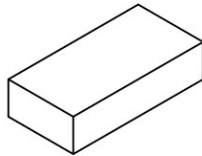

4OSBK4722-R



4WIK472010

**I. The following tools will be required to complete the installation**

- |                           |                       |                  |
|---------------------------|-----------------------|------------------|
| A. Trim removal tools     | C. Torx bit drivers   | E. Socket wrench |
| B. SAE and Metric Sockets | D. SAE Allen wrenches | F. Drill bits    |

**II. Read all instructions and refer to the Parts List to ensure all parts were received.**

---

**WARNING:** *Locate all wiring, fuel lines, brake lines, coolant lines, and refrigerant lines before drilling any holes or installing any self-drilling fasteners.*

---

**III. OEM Seat Removal**

- A. Remove all the bolts holding down the second row seats.
- B. Unclip the electrical connectors under each seat.
- C. Remove the seats from the vehicle.
- D. Remove the rear sill and the rear step trims.
- E. Remove factory seat belt buckles from driver, passenger, and center seats including the wiring harness. Note which buckle is in each location as these will later have to be plugged back into the correct harness. These buckles are needed to eliminate any warning lights on the dash.

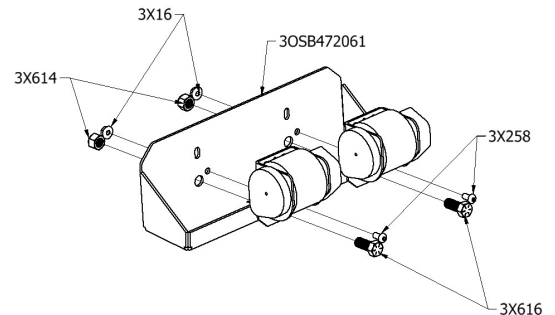

**IV. Preparation**

- A. Remove the interior rear quarter trim to gain access to the factory retractable seat belts. If installing P1000 OSB, only remove quarter trim on passenger side.
- B. Remove the bolt retaining the lower belt anchor and restrain the belt from movement behind the trim.
- C. Reinstall the quarter trim.
- D. Install the barrier and barrier kit per barrier instructions.
- E. Attach retractors to retractor base [30SB472061] using 7/16-20 bolts [3X616] and nuts [3X614] and 1/4-20 bolts [3X258] and nuts [3X16], DO NOT remove cardboard stops from retractors, these will be removed in a subsequent step. If installing P1000 OSB system, only (1) retractor will be attached to retractor base.

## V. Floor Pan Installation

- A. If not installing a floor pan, proceed to Section VI. Set the floor pan into the vehicle with the large vertical flange towards the rear of the vehicle.
- B. The floor pan sits underneath the OEM trim panels. The lower B-pillar trim panels can be placed either inboard or outboard of the floor pan flange.

## VI. Seat Top Tube Installation

- A. Remove the (4) button head screws [3X611] on the front face of the barrier holding the rear brackets on.
- B. Orient the Seat Top Tube [30SB472068] such that the 12 small holes face up, this is the face that the seat will screw into later on.
- C. Attach the Seat Top Tube [30SB472068] to the barrier using the (4) button head screws [3X611] removed in the previous step and (3) additional button head screws [3X611] and (3) whiz nuts [3X166]. Tighten all screws.

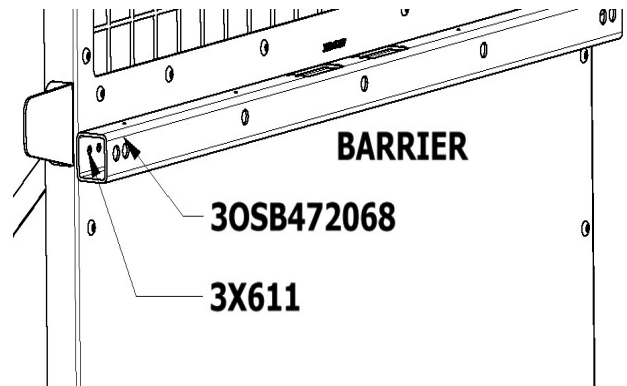

## VII. Lower Bracket Installation

- A. Install the Center Buckle Bracket [30SB472017] by removing the center rear factory bolts holding the seat subframe down and installing it in that location with the angled lip facing forward.
- B. Reinstall the factory subframe bolts.
- C. Place retractor base in position where the center seat sliders bolt to rear of subframe, mark and trim load floor to allow retractable belts to move without contacting load floor when fed through OSB bar.
- D. Install retractor base (after attaching retractors to base) by using OEM bolts from center seat slide rails. Base will mount on rear set of holes for the center seat.
- E. Align the (2) Front Seat Support Brackets [30SB472005] over the holes from the driver and passenger seat bolts. Install and tighten the (4) OEM seat bolts.
- F. Plug the electrical harness for the driver, center, and passenger buckles back into their respective connectors on the vehicle. All OEM buckles must be plugged into the vehicle to prevent any warning lights and ensure proper restraint operation.

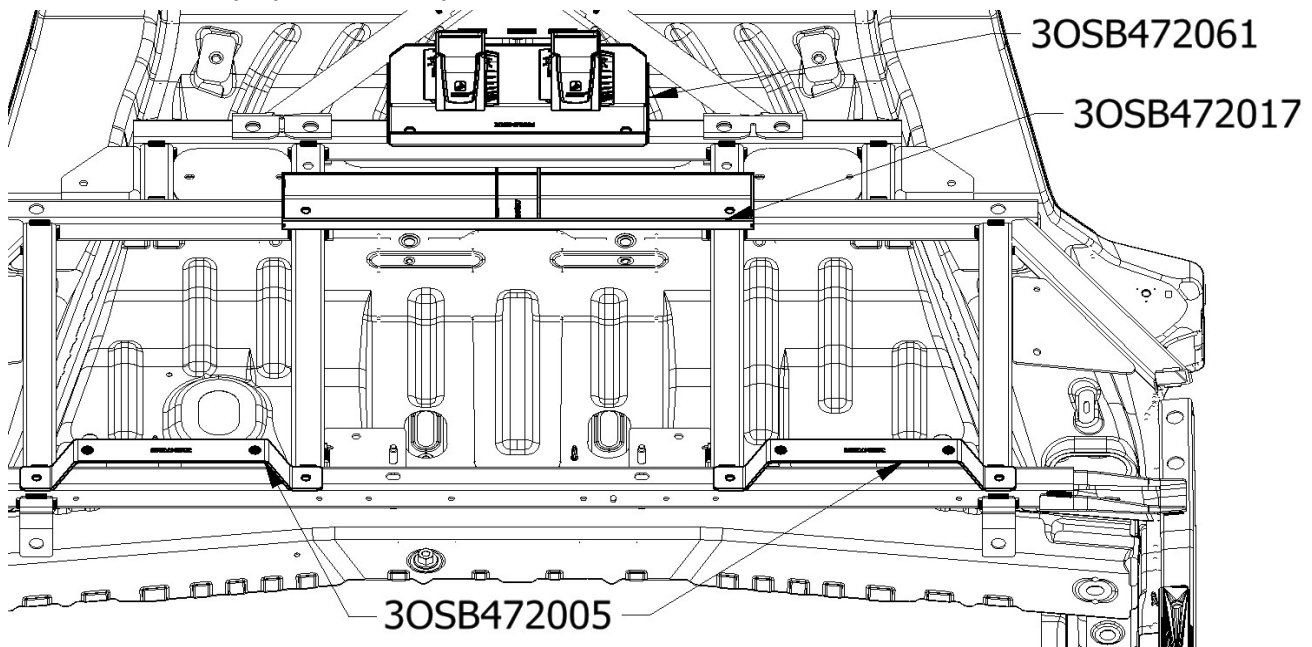

## VIII. OSB Bracket Installation

- A. Remove the rear outer seat sub-frame bolts on the driver and passenger side. If installing P1000 OSB, do not remove driver side bolt.
- B. Place the Passenger OSB Bracket [3OSB472014] by aligning the hole over the outer seat sub-frame bolt hole with the tab engaged on the back side of the OEM tube. The vertical flange should be towards the center line of the vehicle. Install the rear sub-frame bolt back into its respective location.
- C. If installing full OSB system repeat the process on the driver side for the Driver OSB Bracket [3OSB472015].
- D. All the factory seat bolts and seat sub-frame bolts should now be re-installed and tightened to factory torque specifications.

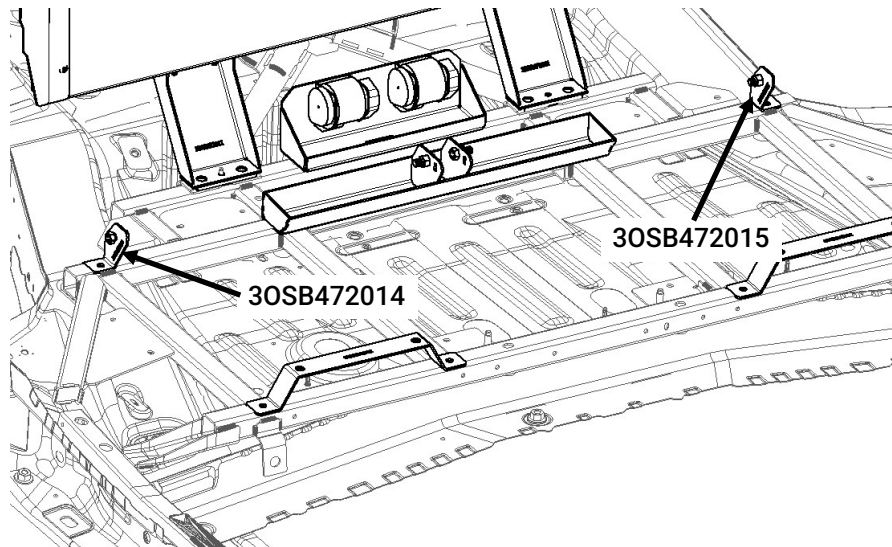

## IX. Belt Installation using Pro-gard OSB Retracting belts

- A. Attach a Lower Release Buckle with Stake [3OSB109RP] to the outer face of the Passenger OSB Bracket [3OSB472014], aligning the edge of the stake with the angled edge of the bracket. Insert a 7/16-20 bolt [3X616] through the Lower Release Buckle with Stake [3OSB109RP] and Passenger OSB Bracket [3OSB472014] and affix with a 7/16-20 nut [3X614]. Tighten nut and keep edge of stake and bracket aligned. If installing P1000 OSB, skip to step C.
- B. Repeat this process for the Driver OSB Bracket [3OSB472015]. Disregard if installing P1000 OSB.
- C. Feed buckle and belts through respective slots on OSB bar, insure belts stay in flat and straight orientation.
- D. If installing P1000 OSB, attach OEM buckle to driver side tab of the center buckle bracket [3OSB472017]. The locating tab on the OEM buckle should go into the slot behind the hole on the center buckle bracket. Use supplied Gr.8 bolt [3X616] and nut [3X614].
- E. Place the Transport Seat [3TRS472022] in the vehicle and feed OSB Belts [3OSB000004] through the center opening.
- F. Attach the anchor end of the OSB Belt [3OSB000004] to the center buckle bracket using (2) 7/16-20 bolts [3X616] and (2) nuts [3X614]. Ensure that the passenger side belts are all attached to the passenger side mounting points and the driver side belts are all attached to the driver side mounting points.
- G. Once seat belts are anchored, remove plastic tab and cardboard to allow retractors to retract fully.

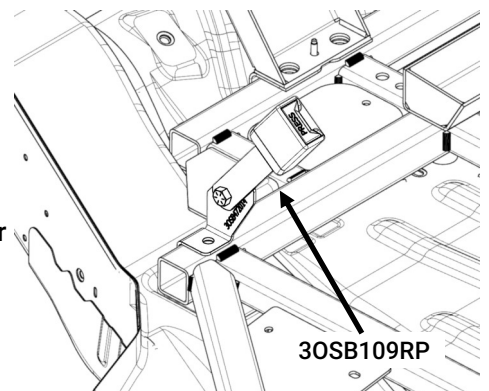

*Note: OEM bolts not shown*

## X. Seat Installation

- A. Place the Transport Seat [3TRS472047] such that the top flange rests on the Seat Top Tube [3OSB472068] and the bottom flange rests on the (2) Front Seat Brackets [3OSB472005].
- B. Attach the front of the seat to the Front Seat Brackets [3OSB472005] using (4) 3/8-16 button head screws [3X247] and (4) large flat washers [3X224].
- C. Attach the rear of the Transport Seat [3TRS472047] to the Seat Top Tube [3OSB472068] using (4) self-tapping screws [3X615] and (4) small flat washers [3X12]. The screws go into the pre-drilled holes, use caution not to over-tighten the screws and risk stress cracking the seat.

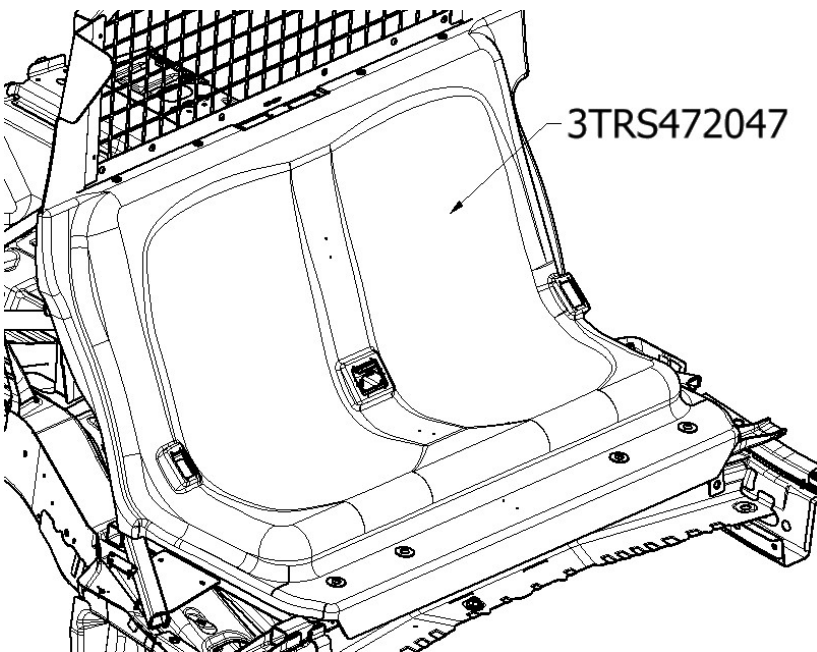

## XI. Trim Panel Installation

- A. Install the (2) OSB Outer Pucks [3TRS572120] to the Transport Seat [3TRS4720022] using (4) #8 screws [3X72] on each side. If installing P1000 OSB, install blank outer puck [3TRS572121] on driver side.
- B. Install the OSB Center Puck [3TRS572122] by threading the belt through the slots in the trim piece then screwing it down using (10) #8 screws [3X72]. If installing P1000 OSB, feed buckle through driver side slot on center puck.
- C. Install OEM belt cover puck [3OSB472013] over passenger side OEM belt opening on the C-pillar using (4) screws [3X72]. Repeat for driver side [3OSB472012] unless installing P1000 OSB. Cover puck not needed when using OEM belt.
- D. Install upper seat belt trim [3OSB472069] on to the OSB bar by sliding the belts through their respective slots (slot openings should face the rear of the vehicle) and secure the trim piece with (8) self tapping screws [3X615]. Be careful not to overtighten and crack the trim piece.

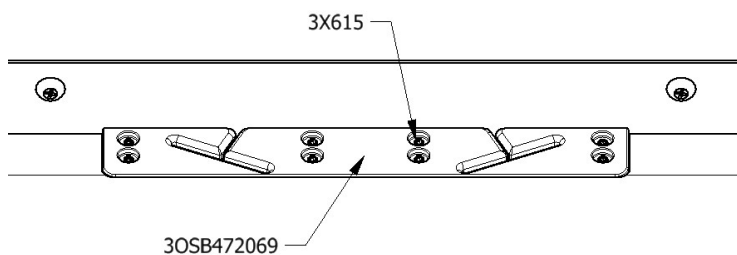
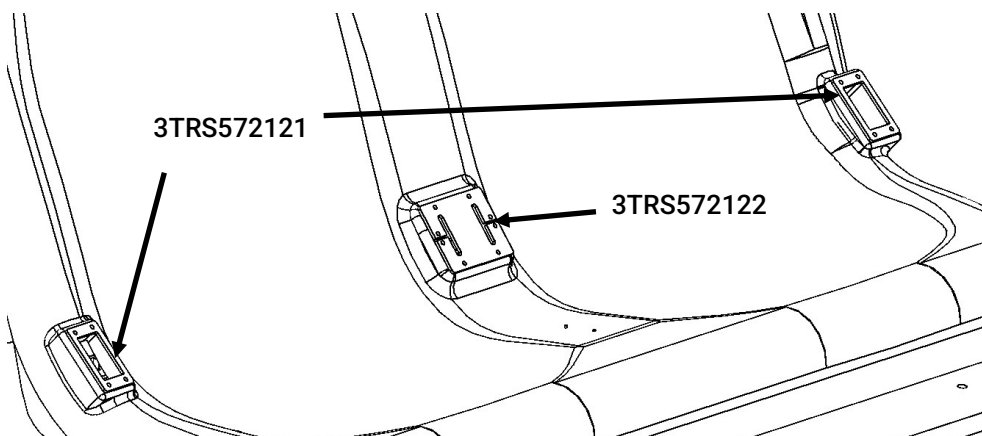

## **XII. OSB Partition Buckle Installation**

- A. Locate Partition Buckle [3OSB109RP-1] on the partition, ensuring the end of the buckle does not protrude past the partition into the prisoner area to avoid a catch point. The figure to the right shows the recommended position.
- B. Drill two 9/32" holes, one at each end of the buckle's slotted mounting tab, and attach with (2) carriage bolts [3X36] and (2) nuts [3X16]. This allows for the seat belt to be placed in the open position for receiving a passenger.



## **XIII. Finishing Steps**

- A. Ensure that belts operate properly.

## **Installation complete**

If you have any problems with this installation or have any questions please call (800-480-6680) and ask for technical assistance.

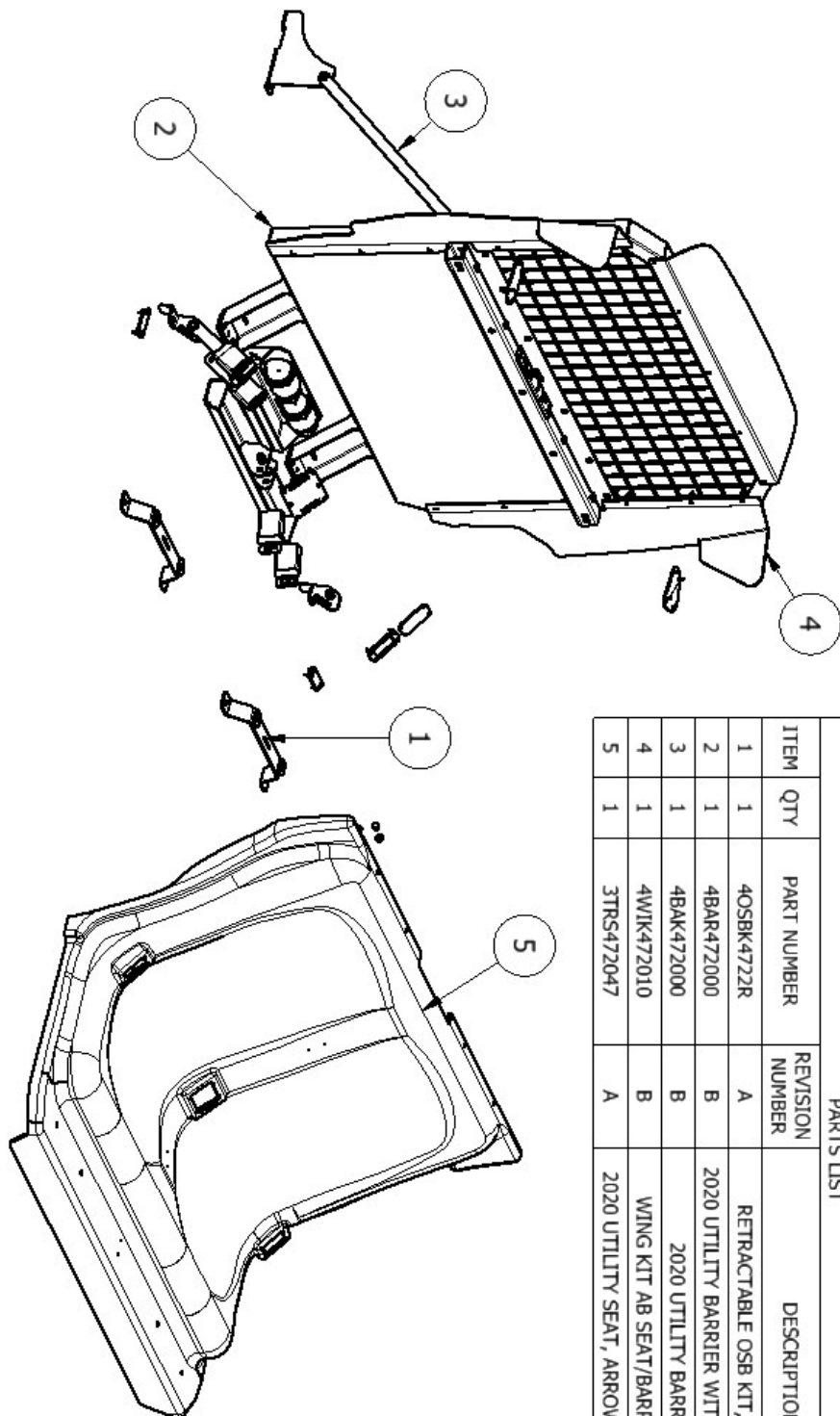

PARTS LIST				
ITEM	QTY	PART NUMBER	REVISION NUMBER	DESCRIPTION
1	1	4OSBK4722R	A	RETRACTABLE OSB KIT, 22 UTILITY
2	1	4BAR472000	B	2020 UTILITY BARRIER WITH WIRE SCREEN
3	1	4BAK472000	B	2020 UTILITY BARRIER KIT
4	1	4WIK472010	B	WING KIT AB SEAT/BARRIER UJNT 20
5	1	3TRS472047	A	2020 UTILITY SEAT, ARROWHEAD MFG, RT