



INSTALLATION GUIDE

**2021 - CURRENT
CHEVROLET TAHOE
P1300 PRO-CELL
P1300T21AOSB
P1300T21AOSB-R**

Pro-gardTM
PRODUCTS LLC.

STRONG. RELIABLE. SECURE.

**THESE COMPONENTS ARE REQUIRED
TO INSTALL THE P1300 PRO-CELL**



4PAR472050



4PAK572106

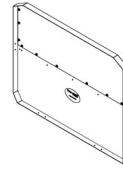

4BAR572102

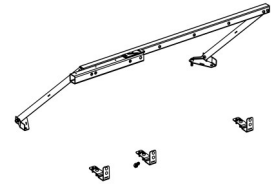

4BAK572102/04



3TRS572180

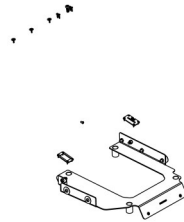

4TRK572133

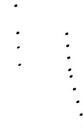

4DIK572155



3DIV572154

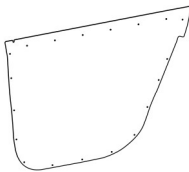

3DRP572154

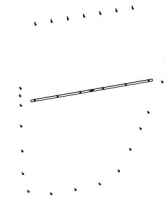

4DRP572105

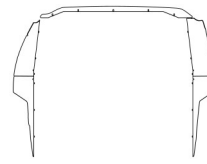

4WIK572110



4WIK572160

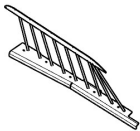

3RWA572150



3OSK000000

OR

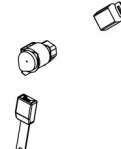

**3OSK000050
(RETRACTABLE)**

I. The following tools will be required to complete the installation

- | | | |
|------------------------|----------------------------|----------------------------|
| A. Centering punch | F. 8mm socket | K. #2 Phillips driver |
| B. 3/16" drill bit | G. Metric socket set | L. #3 Philips screw driver |
| C. 9/32" drill bit | H. Imperial hex wrench set | M. Trim removal tools |
| D. 1" hole saw | I. Torx drive bits | |
| E. Imperial Socket set | J. Imperial wrench set | |

II. Read all instructions and refer to the Parts List to ensure all parts were received.

WARNING: *Locate all wiring, fuel lines, brake lines, coolant lines, and refrigerant lines before drilling any holes or installing any self-drilling fasteners.*

III. Vehicle Teardown and Preparation

A. OEM Seat Removal

1. Remove the plastic trim pieces from the front side of the second row seats to gain access to the front fasteners.
2. Using a T50 Torx driver, remove the (4) bolts from the front of the second row seats.
3. Tumble the seats forward and remove the (5) bolts from the rear of the second row seat rails. The seats should now be loose.
4. Remove both seats from the vehicle keep the OEM fasteners removed in steps 2 and 3, they will be reused on the new seat and to reinstall center and driver side 2nd row seats.
5. Using a T50 Torx, remove the lower seatbelt bolt from the passenger side C-pillar.
6. Remove passenger side rear quarter trim, remove the trim piece that snaps into the C-pillar trim from the OEM belt and secure the OEM belt behind the trim panel. Reinstall the rear quarter trim and trim pieces removed from the belt.

B. Cargo Area Preparation

1. Locate the points where the barrier will mount. Figure 1 shows the brackets in their location on the sheet metal floor pan—the floor covering is not shown.
2. Using a utility knife, slit the floor covering such that it can be folded out of the way for bracket installation and then trimmed and replaced at the end of the installation.
3. All brackets must be fully seated on the sheet metal of the vehicle to be properly installed.

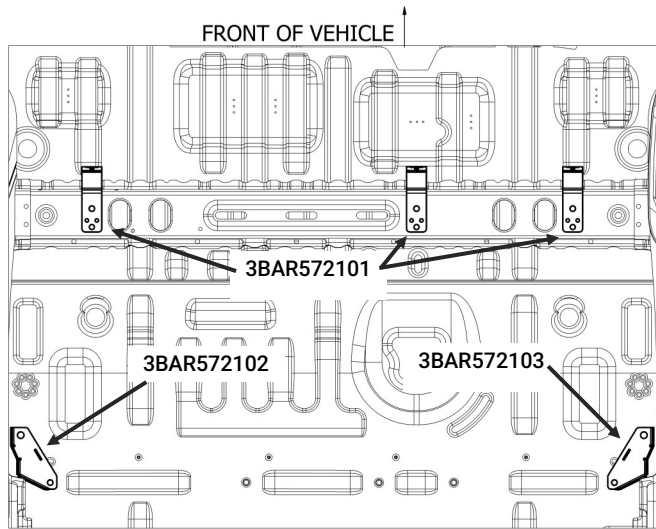

Figure 1

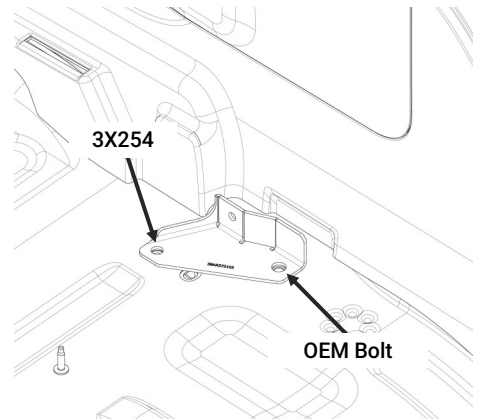

Figure 2

C. Install Rear Barrier Brackets

1. Using a T50 Torx, remove the OEM 3rd row seatbelt fastener.
2. Place the Driver Lower Barrier Bracket [3BAR572102] into position with the flanges towards the outside of the vehicle.
3. Start the OEM bolt removed in step 1. back into the hole it was removed from and start (1) of the M10 socket cap screws [3X254] into the corresponding hole in the floor (Figure 2).
4. Use a T50 and an 8mm hex key to tighten the fasteners.
5. Repeat steps 1. - 4. for the passenger side using the Passenger Lower Barrier Bracket [3BAR572103] and another (1) M10 socket cap screw [3X254].

IV. Barrier Installation

A. Prepare the Barrier

1. If installing retractable OSB belt, skip to step 5. If installing basic OSB belt proceed to step 2.
2. Locate the (2) Lower Barrier Brackets [3BAR572101], (4) 1/4"-20X5/8" carriage bolts [3X36], and (4) 1/4"-20 whiz nuts [3X612].
3. Align the Lower Barrier Brackets with the square holes in the bottom of the barrier. The brackets should be nearly touching the bottom flange of the barrier.
4. Loosely secure the Lower Barrier Brackets in place by inserting the (4) carriage bolts [3X36] through the square holes in the barrier and finger tightening the (4) whiz nuts [3X612] onto the bolts. The nuts should be on the back side of the barrier against the brackets. Figure 3 shows an installed driver side Lower Barrier Bracket. For basic OSB, **SKIP TO STEP 9**.
5. Locate the (3) Lower Barrier Brackets [3BAR572101], the retractor bracket [3OSB572124], (6) 1/4"-20X3/4" carriage bolts [3X61], and (6) 1/4"-20 whiz nuts [3X612].
6. Align the lower barrier brackets with the square holes in the bottom of the barrier. The brackets should be on the back of the barrier and be nearly touching the bottom flange of the barrier.
7. Loosely secure the driver side lower barrier bracket by inserting (2) carriage bolts [3X61] through the square holes in the barrier and finger tightening (2) whiz nuts [3X612] on the bolts. The nuts should be on the back side of the barrier against the brackets. Figure 3 shows the driver side Lower Barrier Bracket installed.
8. On the passenger side of the barrier, align the retractor bracket [3OSB572124] with the square holes on the front side of the barrier. Loosely secure the retractor bracket and barrier brackets by inserting (4) carriage bolts [3X61] and finger tightening (4) whiz nuts [3X612] onto the bolts. The bolts should go through the Retractor Bracket, the Barrier, and then the Lower Barrier Bracket in that order. Figure 4b shows the correct orientation of the retractor bracket.
9. Locate the Mother OSB Bar [3OSB572131], the Daughter OSB Bar [3OSB572130 or 3OSB572123 for retractable belt], (9) 5/16"-18 x 3/4" button head screws [3X149] and (9) 5/16"-18 whiz nuts [3X619]. Loosely install the bars in the orientation shown in figures 4a and 4b. The small side of the through holes in the bars goes against the barrier and the whiz nuts go on the back side of the barrier inside the Mother OSB Bar. Ensure the small holes for mounting the seat on the Daughter OSB Bar are facing upwards.
10. Locate the (2) Barrier Support Bars [3BAR572105] and (2) 5/16"-18 x 3/4" button head screws [3X149]. Slide one end of a Barrier Support Bar between the barrier and the Mother OSB bar end, align the holes in the bar and barrier. Loosely thread button head screw [3X149] into the hole. Repeat on opposite side of barrier. Figure 4c.
11. Loosely install divider brackets [3DIV472051] using supplied 1/4"-20 Phillips head bolts [3X06], these bolts will replace (2) existing bolts that hold the window into the barrier. The location of these brackets is detailed in Figure 5. Bent flange on brackets should face towards driver side of the vehicle

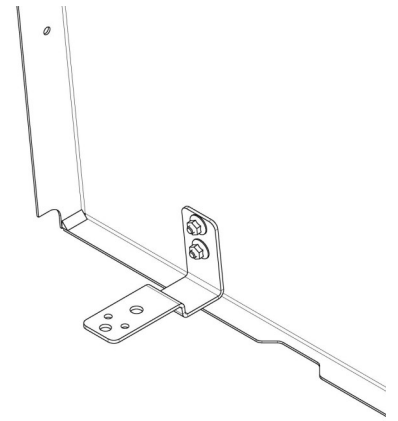

Figure 3

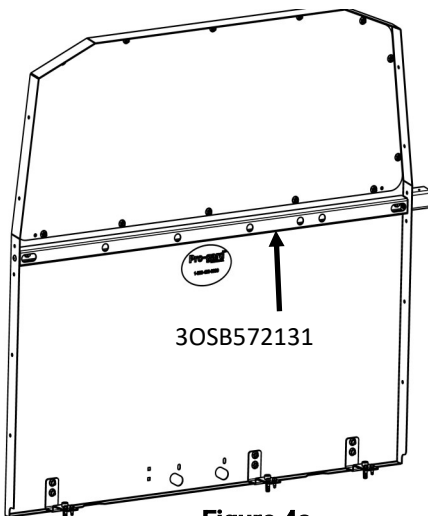

Figure 4a

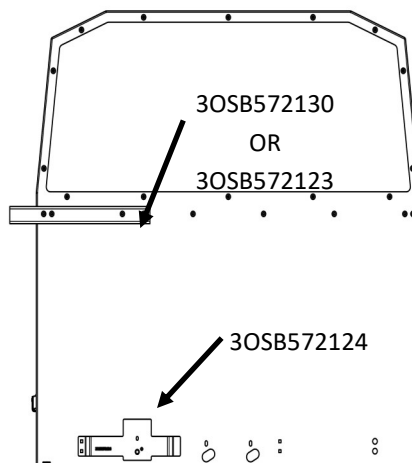

Figure 4b

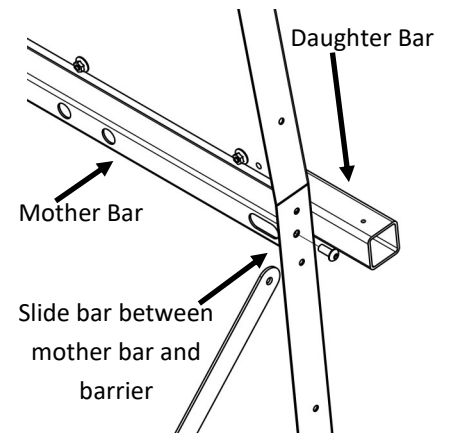

Figure 4c

12. All fasteners installed in this section should still be loose. They will all be tightened in a later section.

B. Install the Barrier

NOTE: Due to the size of the barrier it is recommended that two people lift and position the barrier in the vehicle.

1. Lean the barrier forwards such that the front side is facing the ground.
2. Bring the barrier assembly created in section A into the vehicle through the cargo area.
3. Once in the vehicle, rotate the barrier up and into position. Ensure the Lower Barrier Brackets are properly seated on the sheet metal crossmember behind the second row seat area. The barrier should sit about 6° leaned back from vertical.
4. Position the support bar on the driver side to line up with the Driver Lower Barrier Bracket and then insert (1) 5/16"-18 button head screw [3X149] into the support bar and loosely attach (1) 5/16"-18 whiz nut [3X619]. Repeat for the passenger side support bar with the remaining button head screw and whiz nut.
5. Locate the (2) [(3) for retractable belt] remaining M10 socket cap screws [3X254] and the (4) [(6) for retractable belt] self drilling hex head screws [3X162]
6. Starting on the driver side, align the large hole closest to the barrier in the Lower Barrier Bracket with the threaded hole in the OEM crossmember. Loosely thread (1) M10 socket cap screw [3X254] through the hole. Repeat on the remaining brackets with the remaining M10 screw(s).
7. Again starting on the driver side, align the rear hole in the Lower Barrier Bracket with the corresponding hole in the OEM crossmember. A 3/8" bolt (not included) can be used to align these holes.
8. Making sure the bracket stays aligned, use a 3/8" socket to drive (1) self drilling screw [3X612] into each of the (2) small holes on the Lower Barrier Bracket. Remove the 3/8" alignment bolt if one was used. Figure 6 shows a fully fastened Lower Barrier Bracket.
9. Use an 8mm hex key to tighten the socket cap screw [3X254].
10. Repeat steps 7-9 for remaining Lower Barrier Brackets using the remaining fasteners.

C. Tighten the Bolts

1. Ensure the barrier is in the proper position.
2. Tighten the 1/4"-20 whiz nuts [3X612] at the bottom of the barrier using a 7/16" socket.
3. Using a 3/16" hex key, start by gently tightening the fasteners going left and right through the barrier flanges, Support bars, and Mother OSB bar until the parts can just barely move. Then tighten the fasteners that are going front to back that are holding the Mother and Daughter OSB bars to the barrier. Finally, fully tighten the fasteners going left and right that were partially tightened previously, tightening in this sequence will reduce the possibility of the barrier flanges being warped.
4. Tighten the fasteners attaching the Support Bars to the Lower Barrier Brackets.
5. All fasteners should now be tight.

D. Barrier Wings

1. Remove the (5) bolts from the top of the barrier window.
2. Place the Barrier Top Wing [3WIN572114] against the front of the barrier and align the holes in the wing

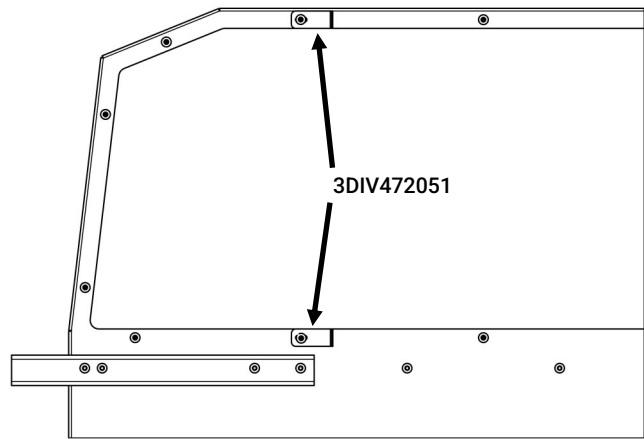

Figure 5

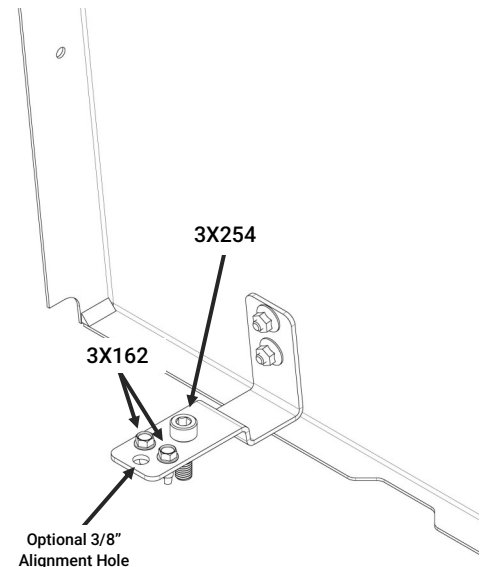

Figure 6

with the top holes in the barrier. Secure in place with the hardware removed in step 1. The Upper Divider Bracket placed in section A. step 11. sandwiches the upper wing; leave the fastener for this bracket finger tight.

3. Locate the Driver Upper Barrier Wing [3WIN572112] and align the holes in the wings flange with the corresponding holes on the upper driver side of the barrier flange.
4. Secure the upper wing in place using (3) 1/4"-20 button head screws [3X258] and (3) 1/4"-20 whiz nuts [3X612]. Orient the fastener such that the nuts are contacting the wing.
5. Locate the Driver Lower Barrier Wing [3WIN572113] and align the holes in the wings flange with the corresponding holes on the lower driver side of the barrier flange.
6. Secure the lower wing in place using (3) button head screws [3X258] and (3) 1/4"-20 whiz nuts [3X612] with the nuts contacting the wing.
7. Repeat steps 3.-6. for the passenger side using the Passenger Upper Barrier Wing [3BAR572110], the Passenger Lower Barrier Wing [3WIN572111], and the remaining (6) button head screws [3X258] and (6) whiz nuts [3X612]. Passenger wings will be tight against Daughter OSB bar.

V. Divider Placement and Seat Bracket Installation

A. Divider Placement

1. Place the Divider [3DIV572154] into the vehicle through the passenger side rear door, top in first.
2. A 1/4"-20 fastener can be temporarily installed into one of the Upper Divider Brackets on the Barrier if the Divider won't stay upright.

B. Seat Brackets

1. Locate the Seat Bracket [3TRS572199] and place it on the floor of the vehicle with the angled flange towards the front of the vehicle. Seat bracket should line up with all 4 OEM seat bolt locations. Loosely start all (4) OEM seat bolts. Once all (4) bolts are started, use T50 Torx to tighten bolts to OEM torque specifications to secure the Seat Bracket.
2. Place the OSB Buckle [3OSB000002 or 3OSB109RP for retractor belts] against the inboard face of the rear outside hole on the seat bracket (use the hole that DOES NOT have a weldnut). Secure the buckle in place using a 5/8" wrench and socket and (1) 7/16"-20X1" grade 8 hex bolt [3X616] and (1) 7/16"-20 grade 8 hex nut [3X614].
3. Figure 7 shows the locations of the seat bracket.

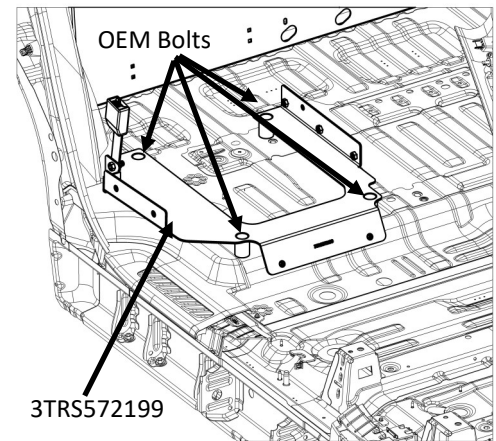

Figure 7

VI. Partition Installation

A. B-pillar Bracket

1. Remove Passenger side middle B-pillar trim panel from the center of the B-pillar by pulling. It may be necessary to pop the bottom of the upper trim panels out in order to get the locator tab on the B-pillar bracket into the proper location.
2. Place the Passenger B-pillar Bracket [3PAK572110] against the vehicle B-pillar with the locator tab in the bottom of the slot indicated in Figure 8. Ensure that the seatbelt is underneath the bracket.
3. Secure the B-pillar Bracket in place with a 3/8" socket and (4) self drilling screws [3X162]. The holes can be pre-drilled with a 3/16" drill bit if necessary.
4. Use the template supplied on the last page to mark the three hole locations in the Lower B-pillar trim panels.
5. Using a 1" hole saw, drill the holes marked in the previous step.
6. Reinstall the B-pillar trim overtop of the B-pillar Bracket.

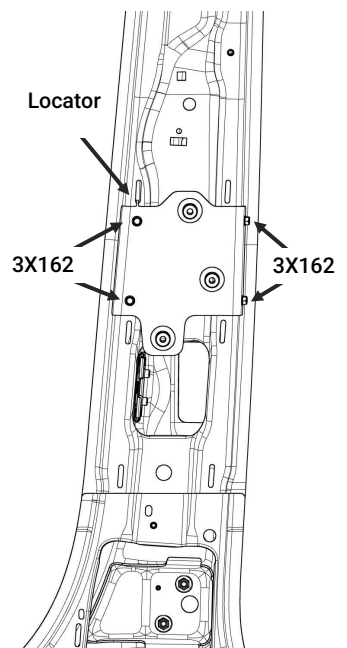

Figure 8

B. Mounting Plate and Inboard Support Bracket

1. Locate the passenger Mounting Plate [3PAR572119] and (3) 5/16"-18x3/4" button head screws [3X149].
2. Align the (3) holes in the plate with the (3) standoffs protruding through the B-pillar trim. Loosely secure with the button head screws. The fasteners will be tightened in a later section.

C. Partition

1. Prepare (4) 1/4"-20X5/8" carriage bolts [3X36], (1) 1/4"-20X1/2" button head screw [3X258], (4) 1/4"-20 whiz nuts [3X16Z], and (1) 1/4"-20 small whiz nut [3X16SZ] near the mounting plate.
2. Position the P1300 Partition into the vehicle and align the holes in the flange attached to the tube with the corresponding holes in the mounting plate.
3. Use the fasteners prepared in step 1. to loosely secure the Partition to the Mounting Plate. The button head screw and the small whiz nut go in the bottom hole. Figure 9 shows the partition installed at this stage.

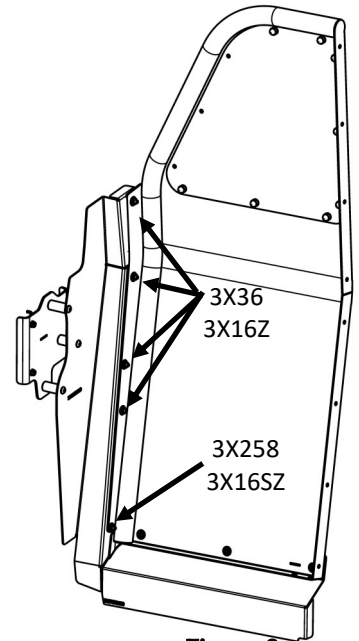

Figure 9

D. Lower Extension Panel

1. Locate the P1300 Lower Extension Panel [3LEP572130] and place it into the floorboard.
2. Slip the large radius flange between the Partition and Mounting Plate and align the holes. Use (3) 1/4"-20X5/8" carriage bolts [3X36] and (3) 1/4"-20 whiz nuts [3X16Z] to loosely secure the panel in place. It will be adjusted later.

E. Wing and Park Buckle

1. Locate the P1300 Partition Wing, the (3) Wing Brackets [3WIN000000], (6) 1/4"-20X3/4" carriage bolts [3X61], and (6) 1/4"-20 small whiz nuts [3X16SZ].
2. Put the long flange of the Wing Brackets against the front face of the Wing and install (3) of the carriage bolts from the wing side with (3) corresponding whiz nuts against the brackets. Tighten down the nuts to pull the carriage bolts into the wing and then loosen the nuts so that the brackets are able to move.
3. Place the short flange of the Wing Brackets against the Partition window and align the holes in the brackets with the (3) missing fasteners in the window. Insert the (3) remaining carriage bolts from the back side of the partition and loosely secure the Wing in place with whiz nuts against the Wing Brackets. The Wing will be adjusted and tightened in a later section. Figure 10 shows the installed wing.
4. Locate the OSB Park Buckle [3OSB000001 or 3OSB109RP-1 for retractable belts], (2) 1/4"-20X5/8" carriage bolts [3X36], and (2) 1/4"-20 whiz nuts [3X16Z].
5. Position the Park Buckle in the desired location on the Partition Mounting Plate and mark (2) hole locations.
6. Drill the locations marked in the previous step with a 9/32" drill bit and then install the Park Buckle with a 7/16" socket and the prepared hardware. Figure 11 shows the recommended location for the Park Buckle.

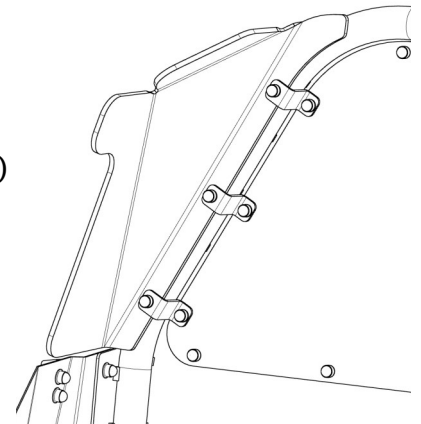

Figure 10

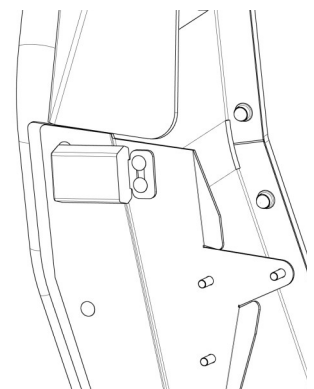

Figure 11

VII. Seat and Divider Installation

A. Seat

1. If installing standard OSB belt, skip to step 2. Locate retractable belt assembly [3OSB000006] and 7/16"-20 x 1" Gr.8 bolt [3X616] and 1/4"-20x0.75" button head screw [3X184]. Using this hardware, secure belt retractor to previously installed retractor bracket [3OSB572124] pictured in Figure 4b. Once retractor is secure, feed buckle and mounting tab end of belt through slot in daughter OSB Bar. Run the lower mounting tab through

the seatbelt slot on the inboard portion of the P1300 seat [3TRS572180]. Set the seat into the vehicle forward of its standard position. Skip to step 3.

2. Locate the OSB Seat Belt [3OSB000003] and run the lower mounting tab through the seatbelt slot on the inboard portion of the P1300 Seat [3TRS572180]. Set the Seat and Seat Belt into the vehicle forward of its standard position to retain access to the Seat Brackets.
3. Locate the [3X616] 7/16"-20X1" grade 8 hex bolt and the 7/16"-20 grade 8 nut [3X614]. Use these to attach the OSB Seat Belt lower mounting tab to the Lower Seat Bracket [3TRS472050] already installed in the vehicle. The belt will anchor on the inboard face of the driver-side flange of the seat bracket, use the hole that DOES NOT have a weld-nut.
4. Position seat on seat brackets by aligning the (7) holes accessible through the rear passenger door and ensuring seat belt buckle protrudes through seat. Loosely install (2) 3/8"-16X3/4" button head screws [3X247] and (2) 3/8" washers [3X224] at the front of the seat, (2) more button head screws [3X247] and washers [3X224] transversely along the outside of the seat, and (3) #10-24X3/4" self-tapping Torx screws [3X626] with (3) 1/4" washers [3X12] along the top of the seat. A T25 Torx driver will be need to start the [3X626] screws into the Daughter OSB Bar. These fasteners will all be tightened in a later section.
5. Locate top seat trim piece [3OSB472073 or 3OSB472072 for retractors]. Install top trim using (4) #10-24x3/4" self-tapping screws [3X626]. If using retractable belt, belt will need to be fed through slot in trim piece with opening facing barrier.
6. If installing standard OSB belt, locate the 7/16-20X1" grade 8 seatbelt bolt [3X616] and loosely attach the upper mounting tab of the OSB Seat Belt to the bung on the Daughter OSB Bar.

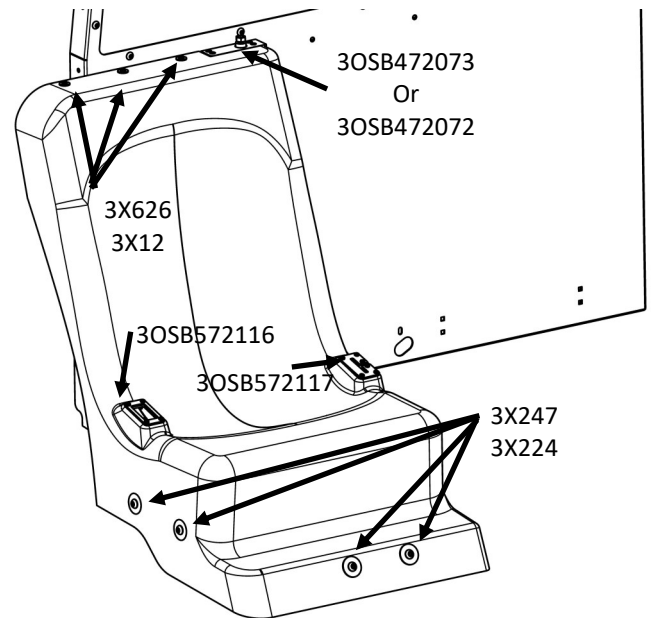

Figure 12

washers

B. Divider

1. Locate (10) 1/4"-20x3/4" carriage bolts [3X61], (10) 1/4"-20 whiz nuts [3X16Z], (2) 3/8" washers [3X224], and (2) 3/8-16X1.5" hex bolts [3X119].
2. Insert the (2) hex bolts [3X119] with the (2) washers [3X224] on them through the Divider, Seat, and into the Lower Seat Bracket. Leave these fasteners loose.
3. Align the Upper Divider Brackets with the corresponding slots on the Divider. The brackets go against the driver side of the Divider. Insert (1) carriage bolt [3X61] into each of the locations from the prisoner side of the Divider and loosely secure with (1) whiz nut [3X614] per carriage bolt.
4. Bring the Divider and the Partition together and align the corresponding holes. Insert (8) carriage bolts [3X61] from top to bottom through the Divider and Partition; the heads of the carriage bolts should be facing the driver side of the vehicle. Secure each fastener with (8) of the whiz nuts [3X16Z]. Figure 13 shows the Divider with the fastener locations called out.

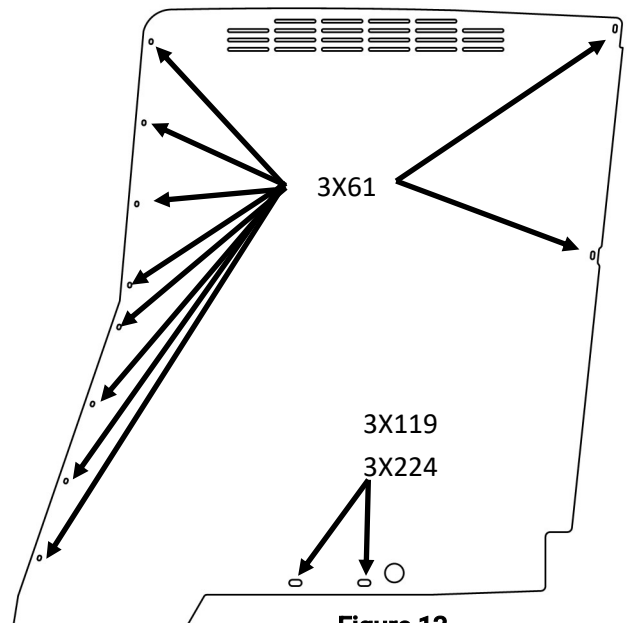

Figure 13

C. Tighten Fasteners

1. Tighten the (7) seat fasteners installed in Section A. that are accessible from the prisoner compartment using a T25 Torx driver and a 7/32" hex wrench. This will fully position and secure the seat.
2. Adjust the Partition / Divider interface to achieve the desired fitment and then tighten the fasteners attaching the Partition to the Divider with a 7/16" socket.

3. Tighten the fasteners attaching the Divider to the Barrier and the Lower Seat Bracket with a 7/16" socket and a 9/16" socket.
4. Tighten the fasteners between the Partition and the Mounting Plate with a 7/16" socket and then tighten the fasteners between the Mounting Plate and the B-Pillar Bracket with a 3/16" hex wrench.
5. Adjust and tighten the (6) fasteners on the Partition Wing and Wing Brackets with a 7/16" socket.
6. Adjust the Lower Extension Panel and tighten the (3) fasteners attaching it to the Partition with a 7/16" socket.

VIII. Door Panel and Window Armor Installation

A. OEM Door Panel Removal

1. Open passenger door and roll down window.
2. Remove OEM door panel.
3. Remove the speaker from the door.
4. Secure wiring harnesses and associated plugs by tape, cable tie and insert into door shell where possible.
5. Remove power window switch from door panel and re-connect it to vehicle wiring harness protect it from moisture and secure inside the door from away from window travel.
6. Secure door latch cable to prevent rattle.

B. Window Armor and Door Panel Assembly

1. Assemble Window Bar [3RWA572150] to Door Panel [3DRP572154] using the Door Panel Nut Plate [3RWA572122] and (6) #8 screws [3X292]. (Fig. 14)
2. Raise the window armor and door panel assembly above the vehicle door and insert the lower frame flanges into the window track. (Fig. 15)
3. Press the flanges into the door track and center the assembly on the door.
4. Align the upper bracket of the frame to the vehicle window trim.
5. Ensure the door panel is aligned with the door.
6. Once fitted satisfactorily, drive (7) self drilling screws [3X299] into the upper door. (Fig. 15)
7. Drive (4) more screws through the lower bracket into the door.
8. Drive remaining (13) screws [3X299] into the door panel and door. If necessary, drill a 7/64" pilot hole.

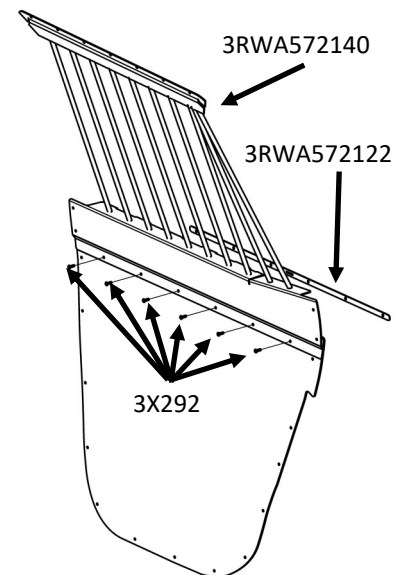

Figure 14

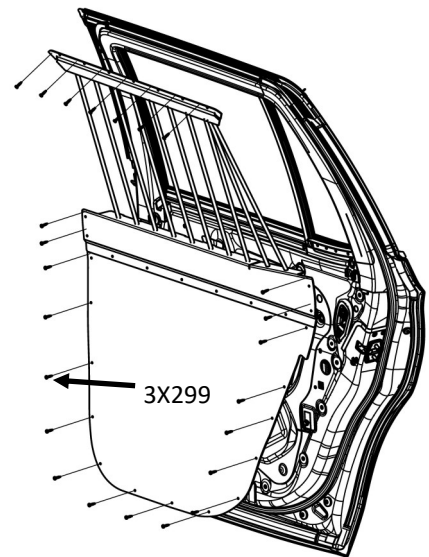

Figure 15

Phillips through

IX. Final Steps

- A. Ensure all fasteners are tight.
- B. Reinstall the OEM center seat.
- C. Install Trim Piece [30SB572116] around buckle in transport seat using (4) #8 head screws [3X72]. Install Trim Piece [30SB572117] around belt as it passes transport seat using (4) #8 Phillips head screws [3X72].
- D. Place plastic caps [3X145] over all nuts on the partition and divider.

Installation complete

If you have any problems with this installation or have any questions please call (800-480-6680) and ask for technical assistance.

PARTS LIST				
ITEM	QTY	PART NUMBER	REVISION NUMBER	DESCRIPTION
1	1	4BAK572102	A	P1300 BARRIER KIT OSB
2	1	4BAR572102	A	21 TAHOE BARRIER ASSEMBLY POLY
3	1	4WIK572110	A	BARRIER WING KIT
4	1	4PAK572106	A	TAHOE P1300 PARTITION KIT
5	1	4PAR472050	B	P1300 ASSEMBLED PARTITION
6	1	4WIK572160	A	21 TAHOE, P1300 WING KIT
7	1	3DIV572154	B	2021 TAHOE P1300 DIVIDER
8	1	4DIK572155	A	P1300 Divider Kit
9	1	4TRK572133	A	TAHOE P1300 SEAT KIT
10	1	3TRS572180	B	21' TAHOE 1/3 SEAT
11	1	3OSK000000	B	P1000 OSB KIT
12	1	4DRP572105	A	DOOR PANEL HARDWARE KIT
13	1	3DRP572154	C	DOOR PANEL TAHOE 21 P/S
14	1	3RWAS72150	B	WINDOW BARS TAH ABS PASSENGER SIDE

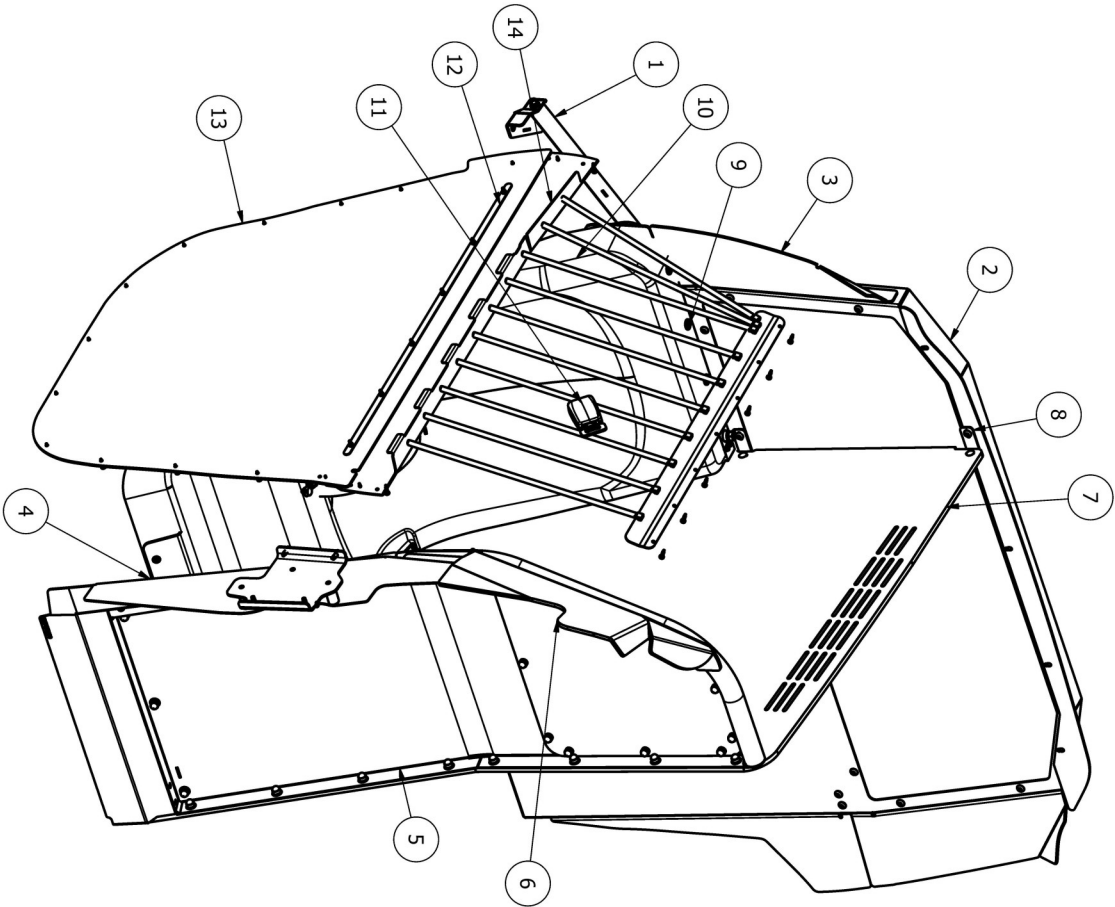

2021 - Current
Chevrolet Tahoe PPV / SSV

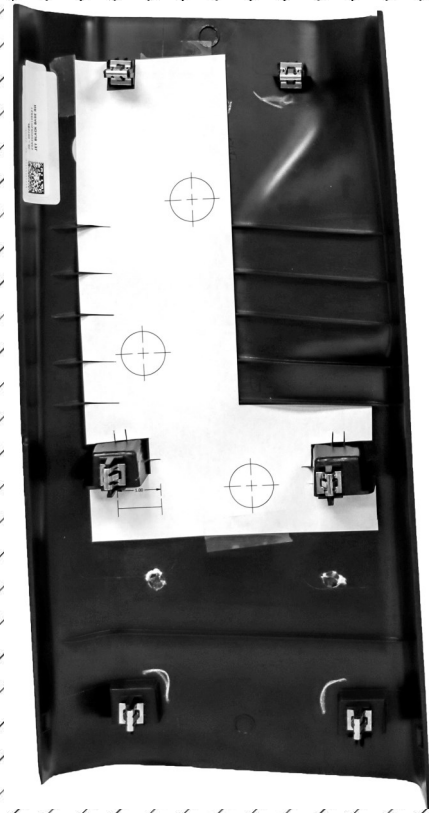
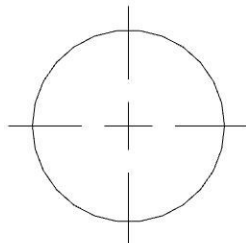
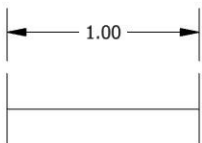
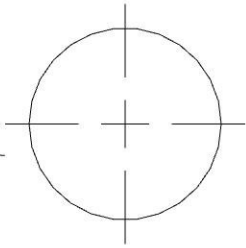
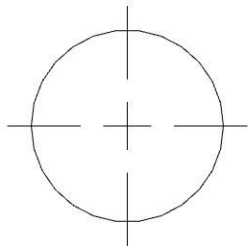

Directions

1. Cut and remove the hatched area.
2. Cut the solid lines to allow the template to sit in the ribs of the trim panel.
3. Place the template against the back side of the passenger side middle B-pillar trim.
4. Align as shown in the image locating primarily on the two middle clips and one of the upper clips.
5. Use tape to hold the template in place on the trim panel.