

# ***INSTALLATION GUIDE***

***CARGO STORAGE DRAWER***

***CSDLG001***

***CSDLG002***

***CSDLG003***

***CSDSM001***

***CSDSM002***

***CSDSM003***

**Pro-gard**<sup>TM</sup>  
PRODUCTS LLC.

**STRONG. RELIABLE. SECURE.**

**THESE COMPONENTS ARE REQUIRED  
TO INSTALL THE CARGO STORAGE DRAWERS**

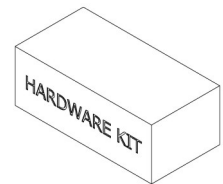
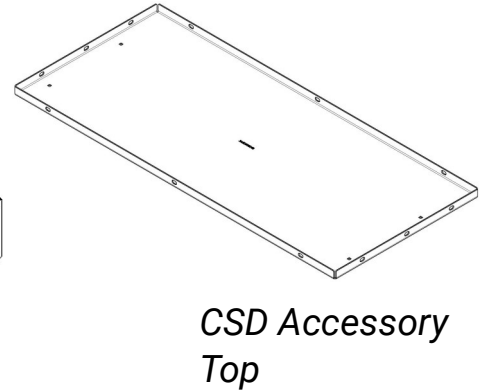
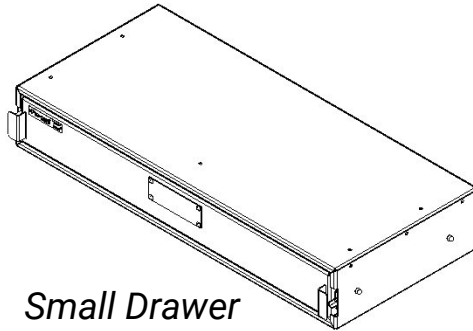
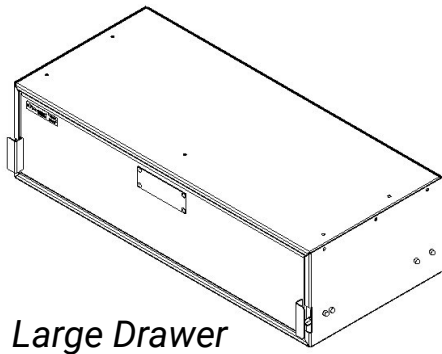

4CSD000098

**I. The following tools will be required to complete installation**

A. Hex keys

B. SAE Sockets

**II. Read all instructions and refer to last page to ensure all parts were received**

---

**NOTE: DRAWER OPTIONS ARE INTERCHANGABLE. DRAWERS WILL MOUNT ON TOP OF EACH OTHER IN ANY SIZE CONFIGURATION.**

---

**II. BOTTOM DRAWER INSTALLATION**

- A. Place drawer on mounts and insert (4) 3X249 (5/16-18 x 5/8" bolts) with (4) 3X12 (1/4 flat washers) and fasten to mounts.

Note: drawers are designed to install in multiple vehicles. Mounts will vary, but mounting points will remain the same. Ford Utility Police Interceptor Mounting System [4CSD47UINT20FS] with Large Cargo Storage Drawer [CSDLG003] shown (Figure 1)

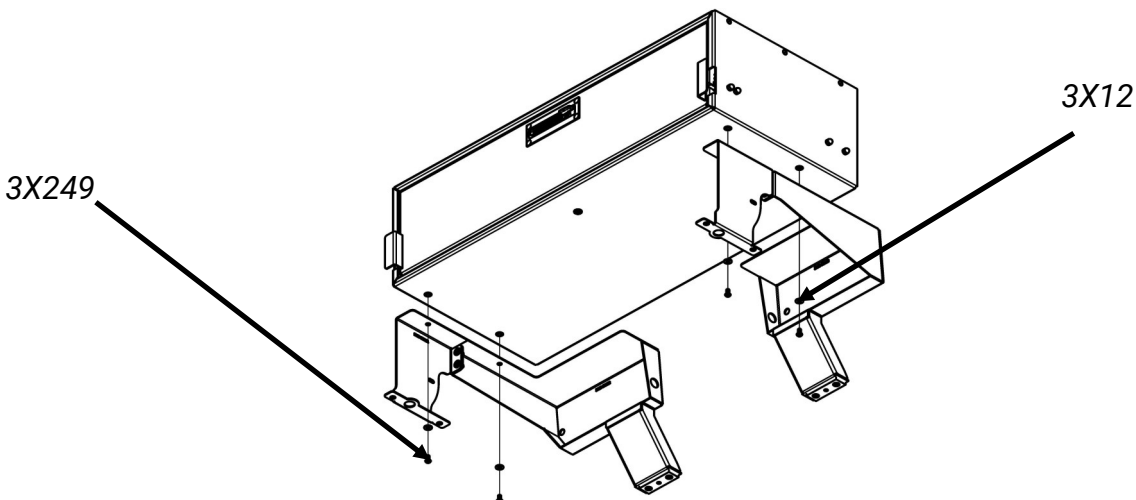

**Figure 1**

### III. ADDITIONAL DRAWER INSTALLATIONS

- A. Drawers can be stacked in any orientation as long as the vehicle has the height required. A large cargo storage drawer [CSDLG001] and small cargo storage drawer [CSDSM001] are shown.
- B. Place additional drawer on top of previously installed drawer.
- C. Open bottom drawer to gain access and install bolts (5) 3X12 (1/4 flat washers) and (5) 3X249 (5/16-18 x 5/8" bolts) from the inside of drawer. Stacking drawers requires one additional bolts, located in the center, above the locking mechanism. See Figure 2

### IV. CSD ACCESSORY TOP INSTALLATION

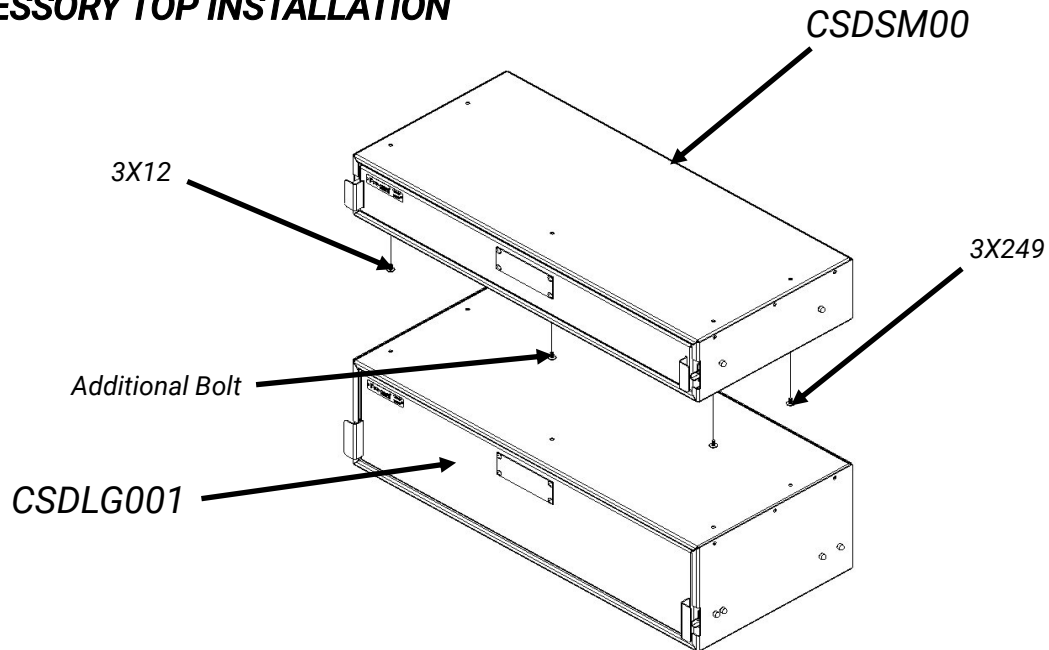

Figure 2

- A. The optional Cargo Storage Drawer Accessory top can be added to the top surface of either the CSDSM001 or CSDLG001.
- B. Place the CSD Accessory Top 3CSD000040 on the top of the drawer lining up the four holes.
- C. Open the drawer to gain access and install bolts (4) 3X36 (1/4-20 x 5/8" carriage bolt) from the top and (4) 3X16Z (1/4-20 whiz nut) from the inside of drawer. See Figure 3

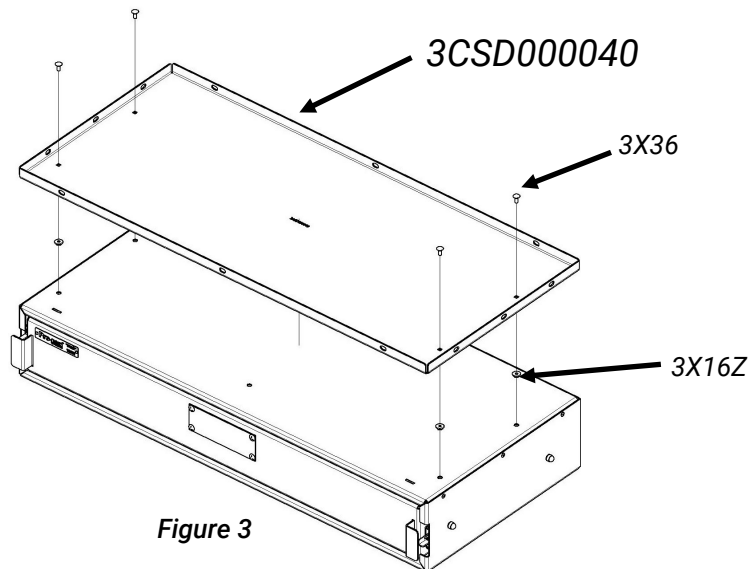

Figure 3

## IV. LOCK PLATE INSTALLATION

- A. Three different lock scenarios are offered. No lock [PN # ending in 001], T-Handle Lock [PN# ending in 002], and an Electronic Combination Lock [PN# ending in 003]
- B. The blank plate (no lock), t-handle lock, and combination lock plate, all install in the same way (See Fig. 4).
- C. Place lock on front face of drawer.
- D. Line up carriage bolt squares and insert carriage bolts, securing on the backside with nuts.

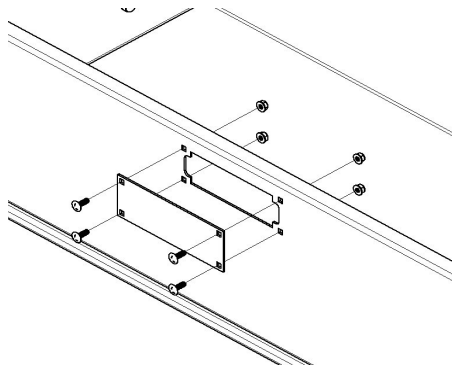

Figure 4

## V. OPTIONAL LOCKS

- A. T-handle: Place T-handle on the front face of lock plate and secure to the back side with screws provided. This lock has an adjustable pawl. Make sure the depth is set with the two jam nuts so that it engages in the catch. See Figure 5. The part number should face the inside of the drawer.

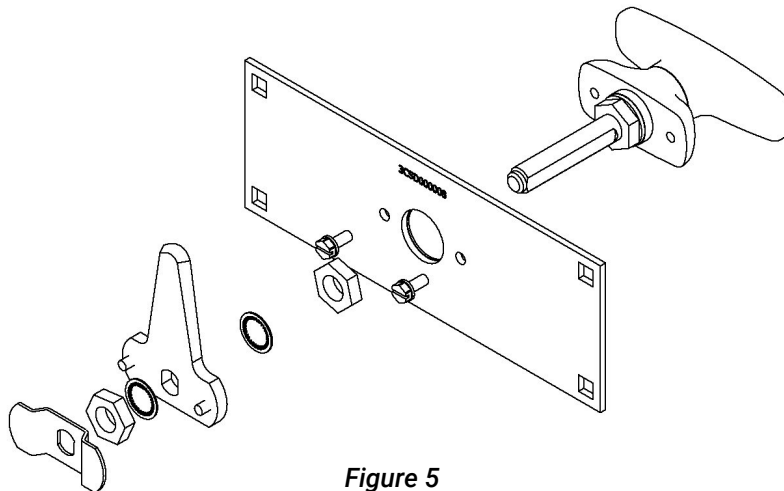

Figure 5

- B. *Electronic combination lock: Insert face of lock through opening. Secure with mounting cup to the back side using the screws provided. The lock comes with a tall and short mounting cup. Use the tall mounting cup. There is a rotation limiter on the shank that sets CW or CCW rotation, set on CW to lock. Battery pack can be placed as desired. See Figure 6. The part number should face the inside of the drawer.*

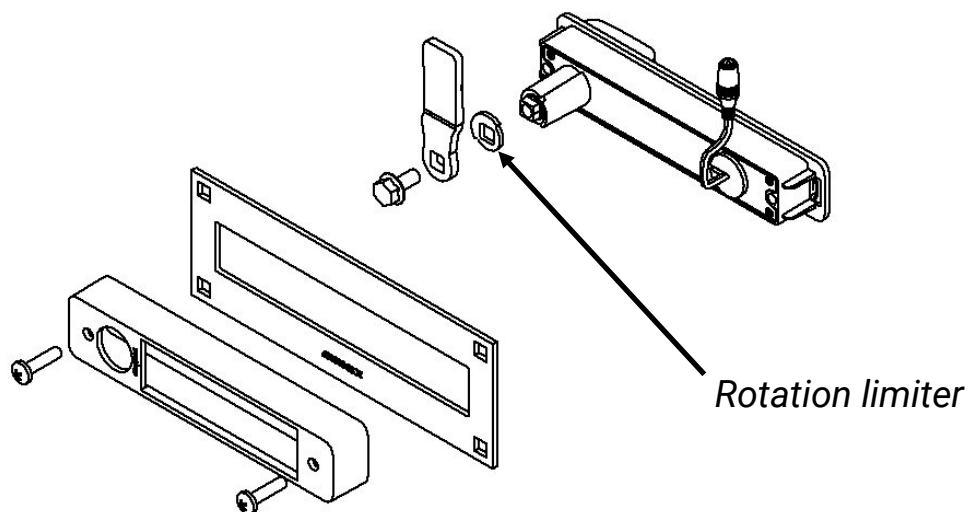
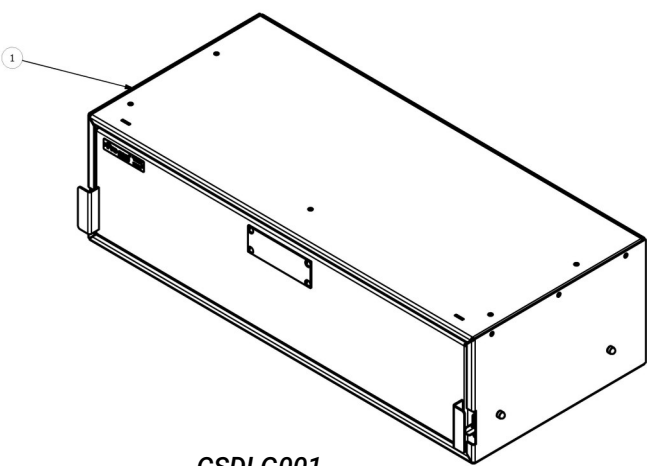

Figure 6

### ***Installation complete***

*If you have any problems with this installation or have any questions please call (800-480-6680) and ask for technical assistance.*

PARTS LIST			
ITEM	QTY	PART NUMBER	DESCRIPTION
1	1	4CSD000000	CARGO STORAGE DRAWER, LARGE



CSDLG001

PARTS LIST			
ITEM	QTY	PART NUMBER	DESCRIPTION
1	1	4CSD000000	CARGO STORAGE DRAWER, LARGE
2	1	3CSD000008	T HANDLE LOCK PLATE
3	1	92-21-532	T-HANDLE ASD

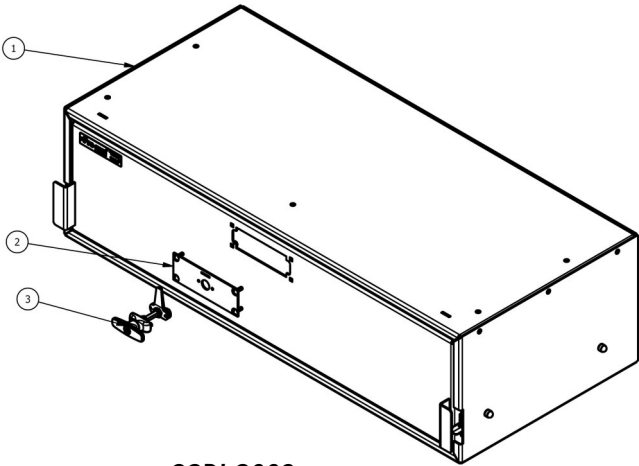

CSDLG002

PARTS LIST			
ITEM	QTY	PART NUMBER	DESCRIPTION
1	1	4CSD000000	CARGO STORAGE DRAWER, LARGE
2	1	3CSD000007	COMBINATION LOCK PLATE
3	1	SC-52-1000-10	ELECTRONIC LOCK CSD
4	1	SC-A20-10	Southco Manager Override Key
5	1	SC-5002	CAM FOR E-LOCK CSD

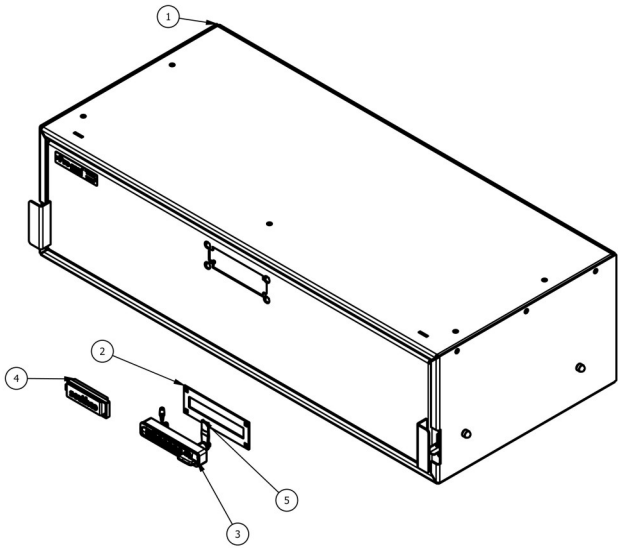

CSDLG003

PARTS LIST			
ITEM	QTY	PART NUMBER	DESCRIPTION
1	1	4CSD000010	CARGO STORAGE DRAWER, SMALL

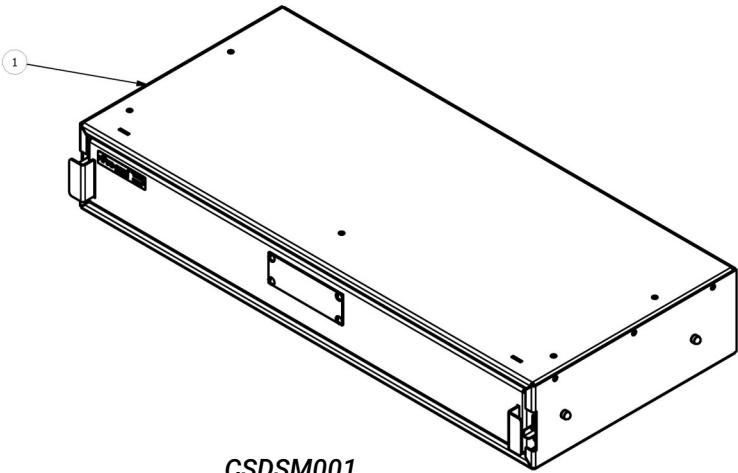

CSDSM001

PARTS LIST			
ITEM	QTY	PART NUMBER	DESCRIPTION
1	1	4CSD000010	CARGO STORAGE DRAWER, SMALL
2	1	3CSD000008	T HANDLE LOCK PLATE
3	1	92-21-532	T-HANDLE ASD

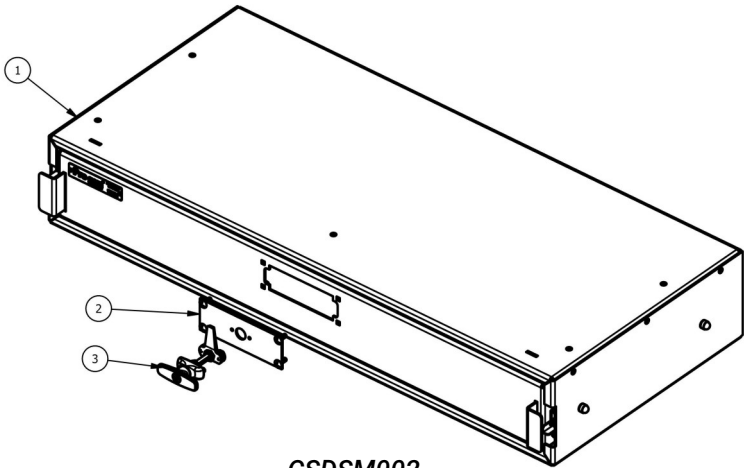

CSDSM002

PARTS LIST			
ITEM	QTY	PART NUMBER	DESCRIPTION
1	1	4CSD000010	CARGO STORAGE DRAWER, SMALL
2	1	3CSD000007	COMBINATION LOCK PLATE
3	1	SC-52-1000-10	ELECTRONIC LOCK CSD
4	1	SC-A20-10	Southco Manager Override Key
5	1	SC-5002	CAM FOR E-LOCK CSD

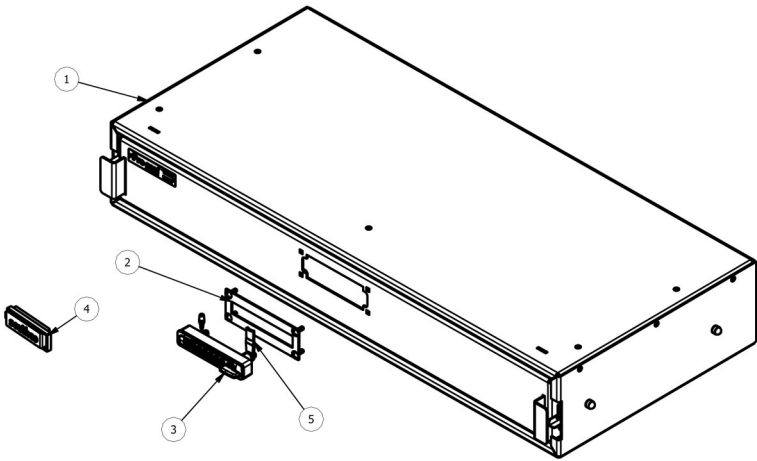

CSDSM003