

# **INSTALLATION GUIDE**

**2021 CHEVROLET TAHOE  
CARGO SECURITY COVER  
CSC57T21**

**Pro-gard**<sup>TM</sup>  
PRODUCTS LLC.

**STRONG. RELIABLE. SECURE.**

**THESE COMPONENTS ARE REQUIRED  
TO INSTALL THE CARGO SECURITY COVER**

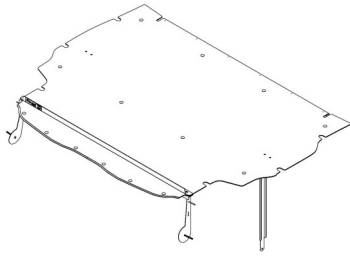

CSC57T21



4CSCHK5721

**I. The following tools will be required to complete the installation**

- |                          |                         |                |
|--------------------------|-------------------------|----------------|
| A. 7/16" Socket / Wrench | C. Phillips Screwdriver | E. 1/4" Socket |
| B. 10mm Socket           | D. 8mm Hex Key          |                |

**II. Read all instructions and refer to the last page to ensure all parts were received**

---

**WARNING:** *Locate All wiring, fuel lines, brake lines, coolant lines, and refrigerant lines before drilling any holes or installing any self-drilling fasteners.*

---

**III. Barrier Installation**

- A. Install barrier (B5702T21 or B5705T21) per the barrier installation manual.

**III. Barrier prep for Cargo Security Cover**

- A. Remove the (5) Phillips head screws and nuts that run horizontal across the bottom of the barrier screen / window.
- B. Attach CSC Front Bracket Weldment [3CSC572100] to barrier using fasteners from previous step (Figure 1).

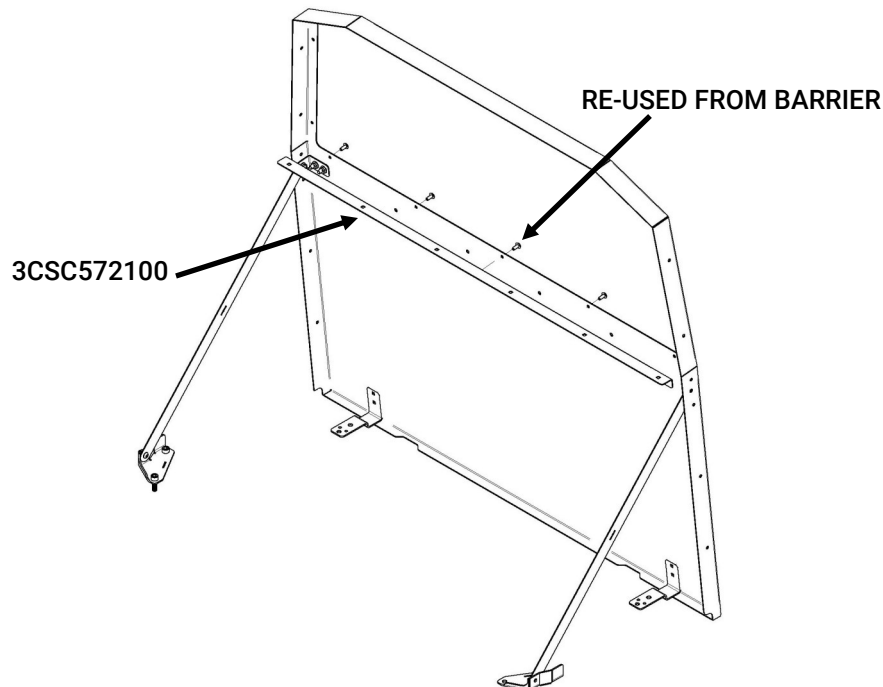

Figure 1

## IV. Attach Center Support Bracket

- A. Remove bolt and nut from the diagonal barrier support bar and attach CSC Center Support Bracket [3CSC572104] to the outside of the barrier floor bracket and re-install nut and bolt. (Figure 2)
- B. Repeat for opposite side.

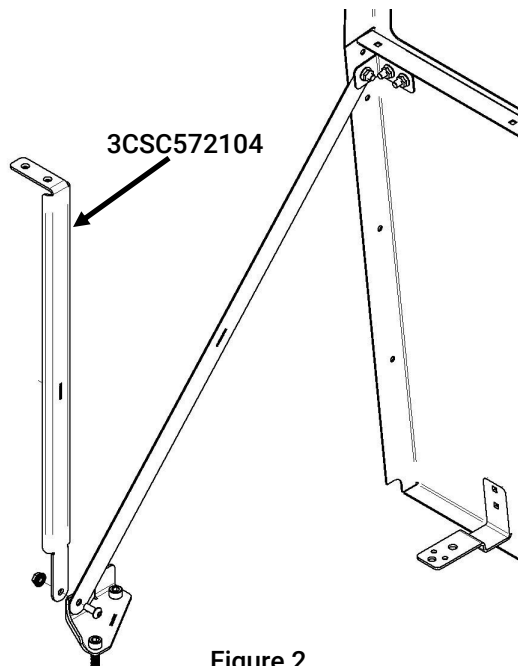

Figure 2

## V. Install Rear Supports

- A. Remove cargo tie-down on driver side, at hatch and fasten rear support bracket [3CSC572102] using M6x60mm Phillips head screw [3X248] as shown (Figure 3).
- B. Repeat for opposite side using [3CSC572103].
- C. Install Rear Support Bar [3CSC572101] by sliding in trim feature above tie-down and over previously installed brackets. 3CSC572101 should be pressed forward against trim feature. Then drive the (2) #8 x 2" sheet metal screw [3X618] (Figure 4) into [3CSC572102] and [3CSC572103].

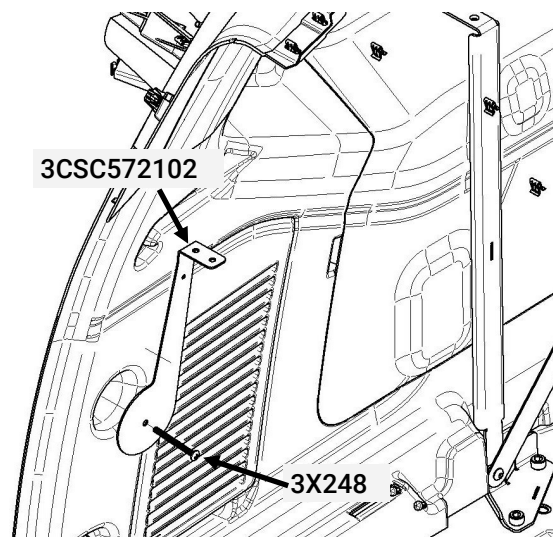

Figure 3

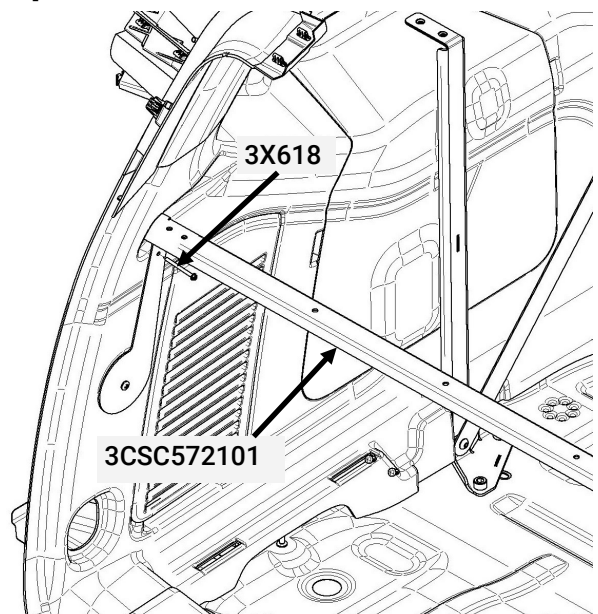

Figure 4

## VI. Install Panels to Supports

- A. Place the driver side cargo cover panel [3CSC572106] into the driver side of the vehicle on top of the previously installed brackets and fasten using (3) carriage bolts [3X36] and nuts [3X16Z] at barrier and (2) 1/4"-20 x 7/8" screws [3X05A] at center supports (Figure 5).
- B. Repeat step A. for the passenger side panel [3CSC572107].
- C. On the under side of the shelf, there are two flanges that need to be connected. Align the (7) holes and loosely

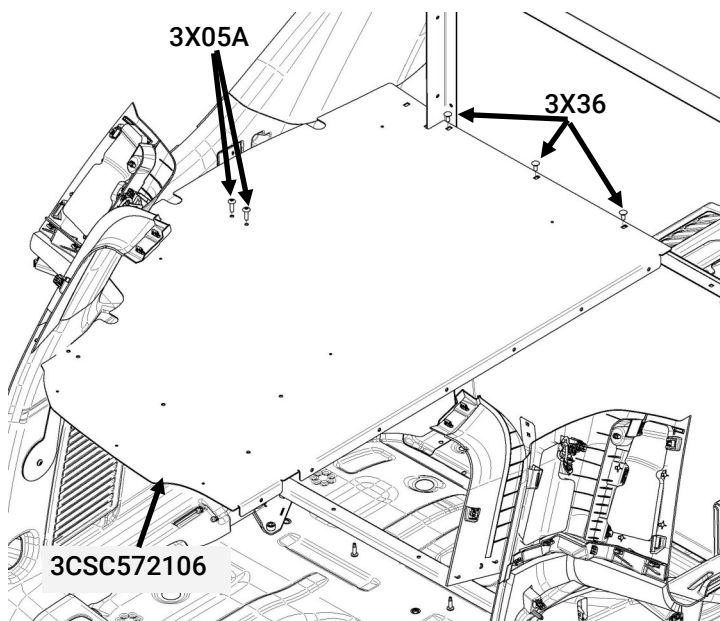

Figure 5

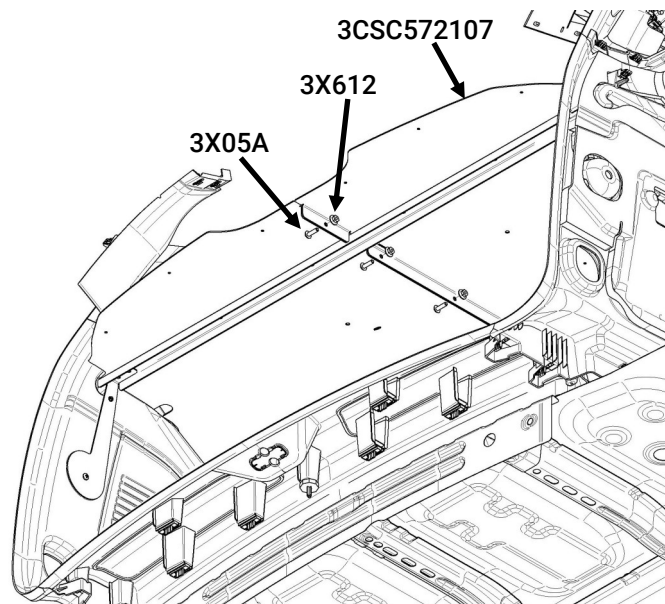

Figure 6

secure using (7) hex head screws [3X05A] and (7) serrated flange nuts [3X612] (Fig 6).

- D. All components aside from the rubber mat should now be loosely in place. Move and adjust the panels to achieve the desired fitment.

## VII. Install Rubber Mat and Top Bar

- A. Place the rubber mat [3CSC572110] over the panels and align with panel holes. Use the (6) push-in plastic rivets [3X246] to secure (Fig 7).
- B. Slide in and align the (8) holes in the Top Bar Assembly [3CSC572108] with the corresponding holes in the cargo cover panel, support brackets and rear crossmember.
- C. Fasten the (8) [3X05A] screws through the top, into the (8) [3X612] serrated nuts.

### Installation complete

If you have any problems with this installation or have any questions please call (800-480-6680) and ask for technical assistance.

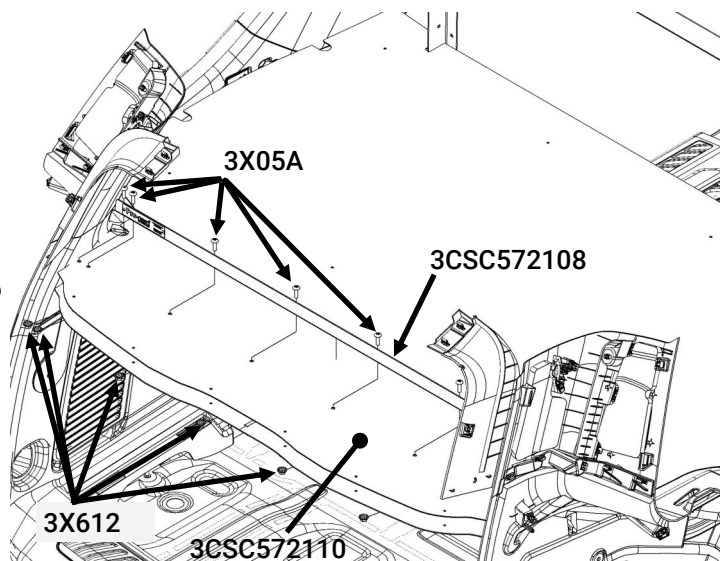

Figure 7

PARTS LIST			
ITEM	QTY	PART NUMBER	DESCRIPTION
1	1	3CSC572100	CSC FRONT BRACKET WELDMENT
2	1	3CSC572101	CSC REAR SUPPORT BAR
3	1	3CSC572102	CSC DRIVER REAR SUPPORT BRACKET
4	1	3CSC572103	CSC PASSENGER REAR SUPPORT BRACKET
5	1	3CSC572108	CSC TOP BAR ASSEMBLY
6	2	3CSC572104	CSC CENTER SUPPORT BRACKET WELDMENT
7	1	3CSC572106	CSC DRIVER PANEL
8	1	3CSC572107	CSC PASSENGER PANEL
9	1	4CSC572110	CSC NEOPRENE MAT
10	1	4CSK572100	CSC HARDWARE KIT

