



INSTALLATION GUIDE

**2021 - CURRENT
CHEVY TAHOE
COMMAND GRILLE®**

Pro-gardTM
PRODUCTS LLC.

STRONG. RELIABLE. SECURE.

**THESE COMPONENTS ARE REQUIRED
TO INSTALL THE COMMAND GRILLE®**

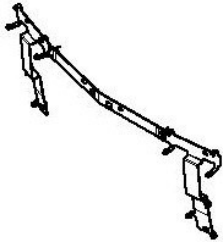

3LTH572105

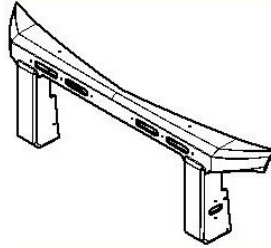

3LTH572120



3LTH572110

I. The following tools will be required to complete the installation

- A. 1/2" drill bit
- B. 3/32" hex key
- C. 5/32" hex key

II. Read all instructions and refer to the Parts List on the last page to ensure all parts were received.

WARNING: *Locate all wiring, fuel lines, brake lines, coolant lines, and refrigerant lines before drilling any holes or installing any self-drilling fasteners.*

III. Prepare the OEM Grille

- A. Black threaded plugs [3LTH572106] will go in (4) lower locations as shown and blue threaded plugs [3LTH572107] go in (4) upper locations. (Fig. 1).
- B. Plugs will be inserted into grill openings with arrow pointing left (Fig. 2) then rotated clockwise so that arrow will be pointing up when in position (Fig. 3).

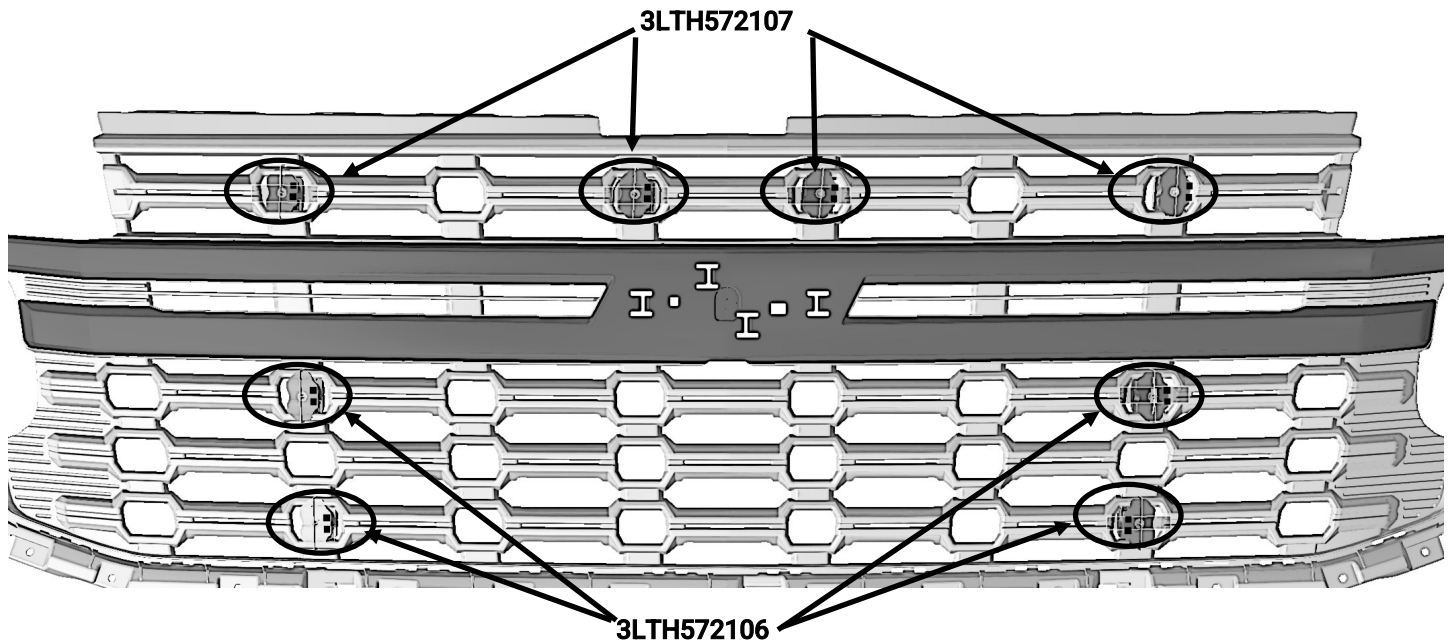

Figure 1

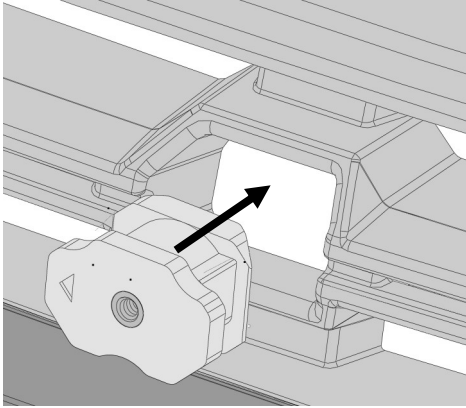

Figure 2

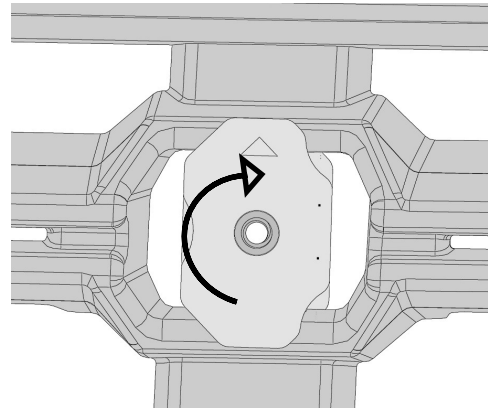

Figure 3

- C. Plugs are designed to be turned by hand. Should you find one difficult, turn using pair of pliers.

IV. Install the Mounting Bracket

- A. Align the (2) center upper tabs (Fig 4a) with the narrow horizontal grill slots to locate the bracket [3LTH572105] (Fig. 4).
- B. Threaded holes will be aligned with the bracket slots.
- C. Insert a 1/4-20 X 5/8" phillips fastener [3X03] into each of plug and hand tighten. Driving fasteners with powered tool is not recommended.

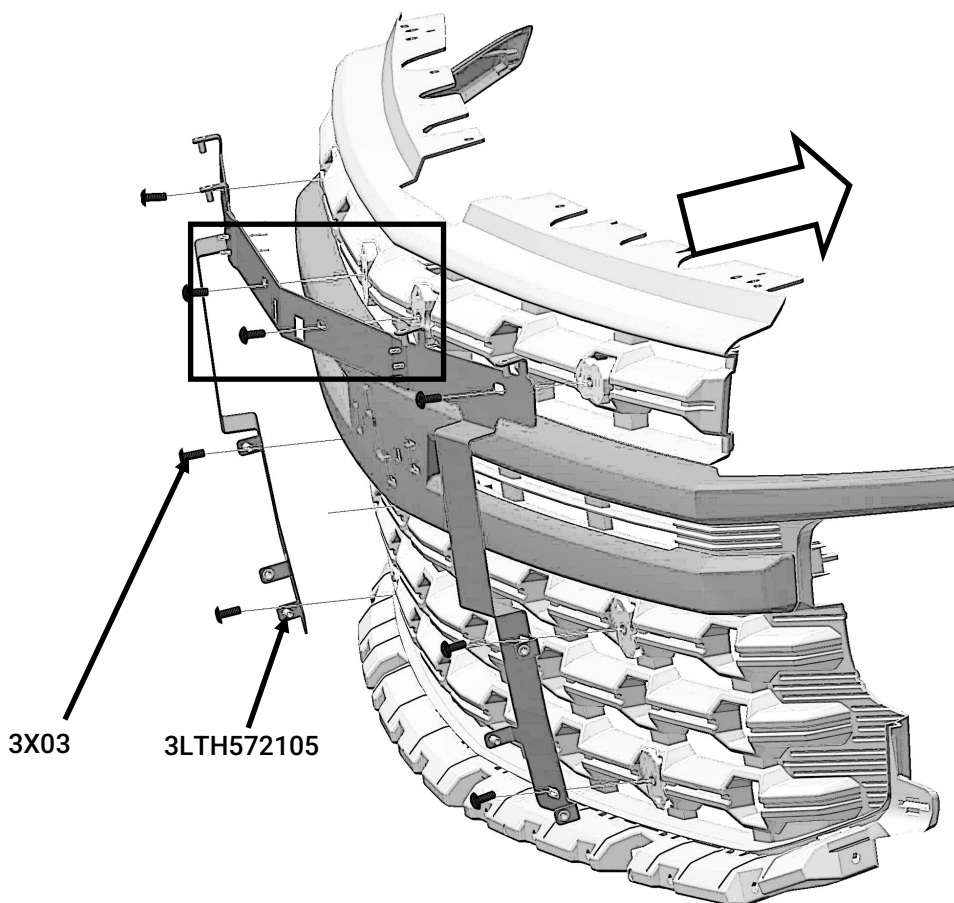

Figure 4

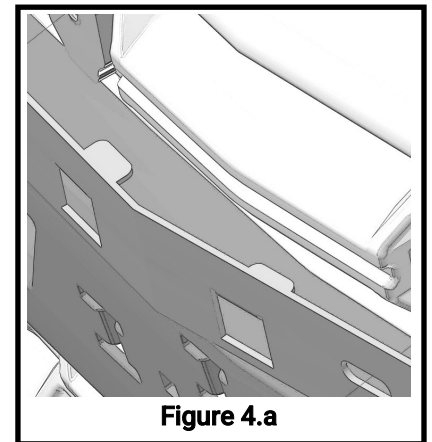

Figure 4.a

V. Attach the Command Grille®

- A. If installing lights into a Command Grille®, do so now. Be careful not to over torque the light retaining fasteners - the recommended torque is 12 in-lbs.
- The Command Grille® for Whelen lights [3LTH572120] is designed to work with Whelen Ion T-series lights across the top and Ion mini T-series lights on the sides.
 - The Command Grille® for SoundOff lights [3LTH572160] is designed to work with SoundOff Signal 4" mpower stud mount lights across the top and 3" mpower stud mount lights on the sides.
- B. Wire all of the lights in the Command Grille®.
- C. Prepare the (14) 8-32 X 5/8" button head fasteners [3X624] at the front of the vehicle.
- D. Pass all wiring through the OEM grille and then offer the Command Grille® up to the Brackets. Ensure the

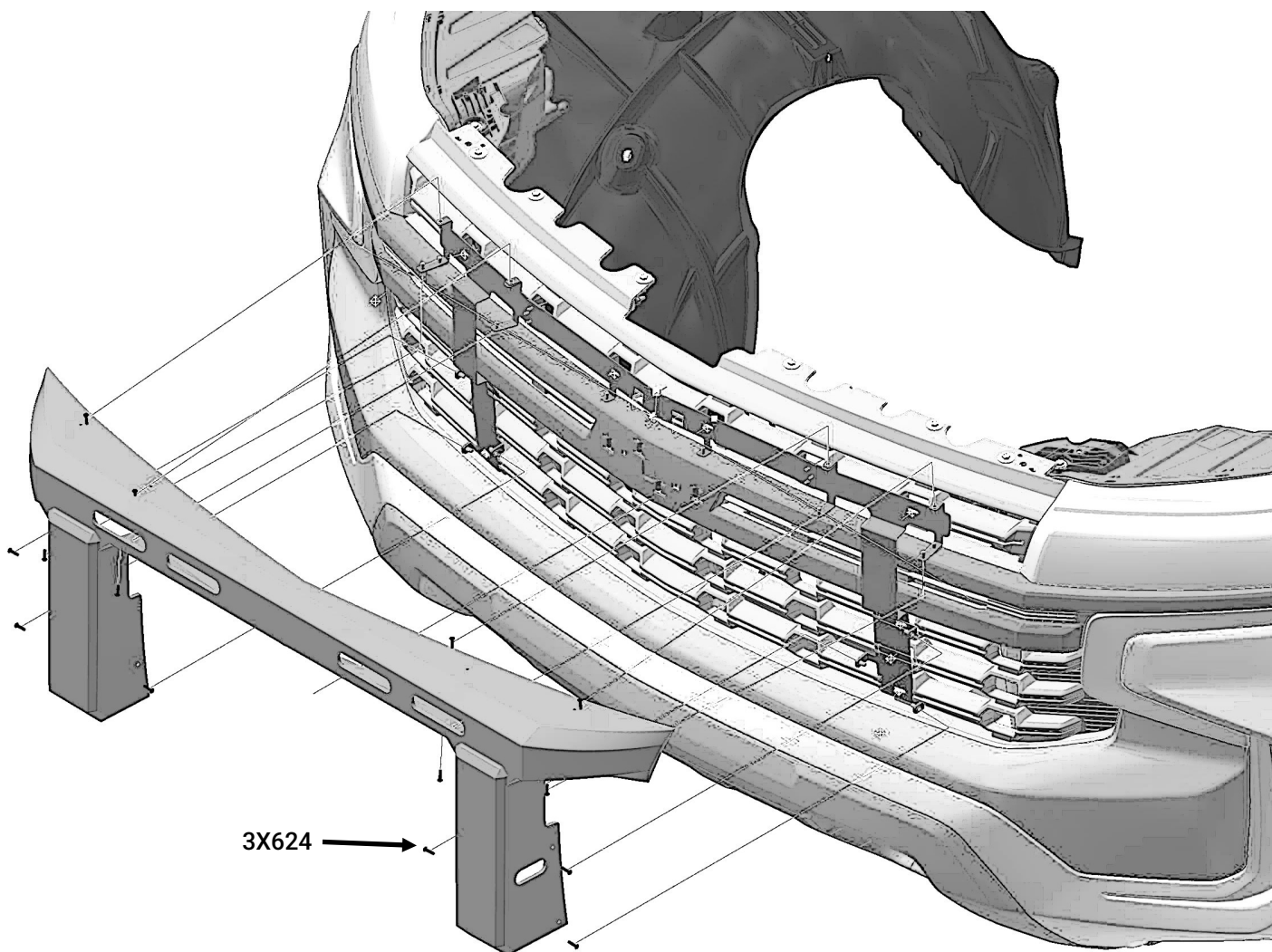

Figure 5

Command Grille® is on the outside of all the tabs from the grille bracket.

- E. Install the (14) button head screws [3X624] using a 3/32" hex key. There are (8) locations around the outside of the Command Grille® and (2) on the inside (Fig. 5).

Installation complete

If you have any problems with this installation or have any questions please call (800-480-6680) and ask for technical assistance.

PARTS LIST

ITEM	QTY	PART NUMBER	REVISION NUMBER	DESCRIPTION
1	1	3LTH572110	A	COMMAND GRILLE HARDWARE
1.1	10	3X624		8-32X5/8" BHSCS BO SS
1.2	8	3X03		1/4-20 X 5/8 PHIL TRUSS HD MS
1.3	4	3LTH572106	A	LOWER THREADED PLUG
1.4	4	3LTH572107	A	UPPER THREADED PLUG
2	1	4LTH572120	B	COMMAND GRILLE ASSEMBLY-WHELEN
3	1	3LTH572105	F	21' TAHOE COMMAND GRILLE BRACKET ASSEMBLY

