

# **INSTALLATION GUIDE**

**2021 - CURRENT  
CHEVROLET TAHOE  
BARRIER  
B5702T21  
B5705T21**

**Pro-gard<sup>TM</sup>**  
PRODUCTS LLC.

**STRONG. RELIABLE. SECURE.**

**THESE COMPONENTS ARE REQUIRED  
TO INSTALL THE BARRIER**

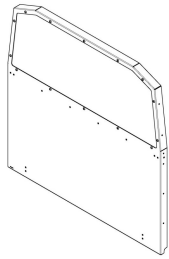

4BAR572100 /  
4BAR572101

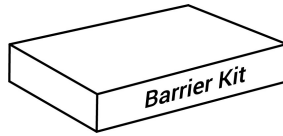

4BAK572100



4WIK572110

**I. The following tools will be required to complete the installation**

- |                            |                  |                  |
|----------------------------|------------------|------------------|
| A. 7/16" Socket            | D. 3/16" Hex Key | G. 3/8" Socket   |
| B. 1/2" Socket             | E. 5/32" Hex Key | H. Utility Knife |
| C. 1/2" Combination Wrench | F. 8mm Hex Key   | I. Torx T50      |

**II. Read all instructions and refer to the Parts List to ensure all parts were received.**

---

**WARNING:** *Locate all wiring, fuel lines, brake lines, coolant lines, and refrigerant lines before drilling any holes or installing any self-drilling fasteners.*

---

**III. Cargo Area Preparation**

- Locate the points where the barrier will mount. Figure 1 shows the brackets in their locations on the sheet metal floor pan - the floor covering is not shown.
- Using a utility knife, slit the floor covering such that it can be folded out of the way for bracket installation and then trimmed and replaced at the end of the installation.
- All brackets must be fully seated on the sheet metal of the vehicle to be properly installed.

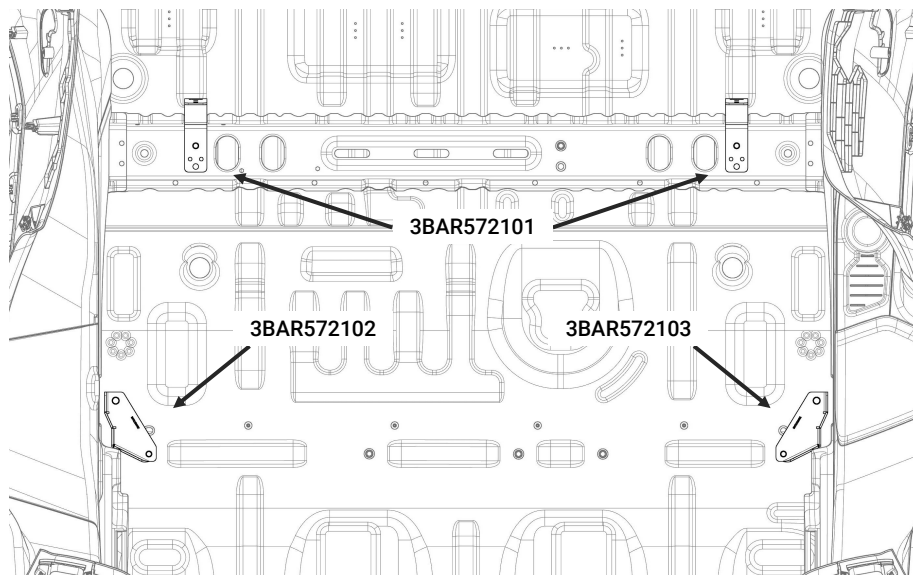

**Figure 1**

## IV. Install Rear Barrier Brackets

- A. Using a T50, remove the OEM 3rd row seatbelt fastener.
- B. Place the Driver Lower Barrier Bracket [3BAR572102] into position with the flanges towards the outside of the vehicle.
- C. Start the OEM bolt removed in step A. back into the hole it was removed from and start (1) of the M10 socket cap screws [3X254] into the corresponding hole in the floor (Figure 2).
- D. Use a T55 and an 8mm hex key to tighten the fasteners.
- E. Repeat steps A. - D. for the passenger side using the Passenger Lower Barrier Bracket [3BAR572103] and another (1) M10 socket cap screw [3X254].

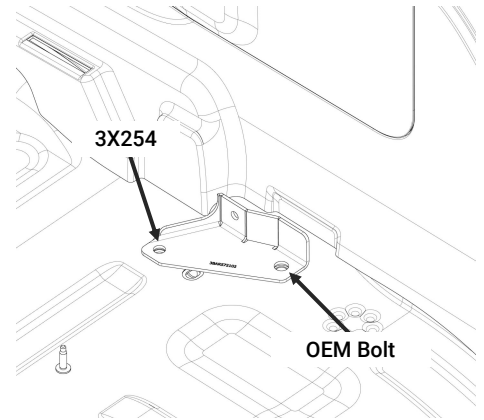

Figure 2

## VI. Prepare the Barrier

- A. Locate the (2) Lower Barrier Brackets [3BAR572101], the (4) carriage bolts [3X36], and the (4) 1/4-20 whiz nuts [3X612].
- B. Align the Lower Barrier Brackets with the square holes in the bottom of the barrier. The brackets should be nearly touching the bottom flange of the barrier.
- C. Loosely secure the Lower Barrier Brackets in place by inserting the (4) carriage bolts [3X36] through the square holes in the barrier and finger tightening the (4) whiz nuts [3X612] onto the bolts. The nuts should be on the back side of the barrier against the brackets. Figure 3 shows an installed driver side Lower Barrier Bracket.
- D. Locate the (2) Barrier L-Brackets [3BAR572104], the (2) Barrier Support Bars [3BAR572105], (6) 5/16-18 button head screws [3X149], and (6) 5/16-18 whiz nuts [3X619].
- E. Identify the 5/16" hole in the left flange on the barrier and insert (1) of the button head screws [3X149] then slide the support bar and the L-bracket onto the bolt. Loosely thread (1) whiz nut [3X619] onto the nut. Figure 4 shows the correct orientation of the brackets and fasteners.
- F. Repeat step E. on the right side of the barrier.
- G. If installing a Pro-gard Transport Seat, attach the OSB / Seat Support Bar to the barrier at this time using the center (4) holes on the barrier and the hardware included with the seat kit.
- H. Insert the remaining (4) button head screws [3X149], (2) per side, from the front side of the barrier through the L-Brackets. Loosely thread a whiz nut [3X619] onto each of the (4) screws.
- I. All fasteners installed in this section should still be loose. They will all be tightened in a later section.

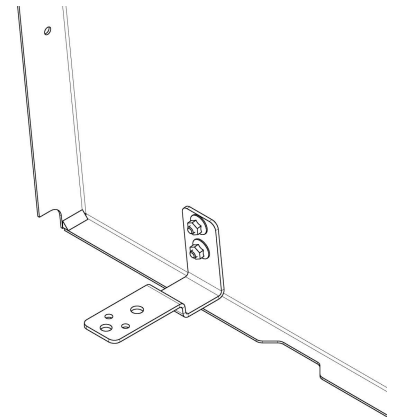

Figure 3

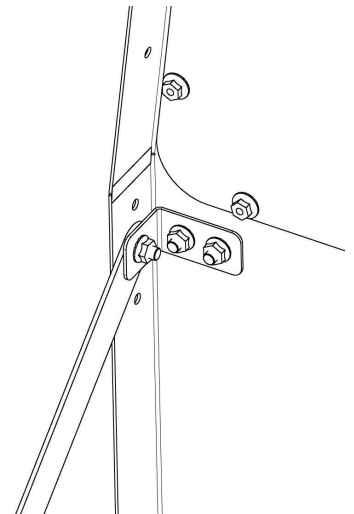

Figure 4

## VII. Barrier Installation

**NOTE:** Due to the size of the barrier it is recommended that two people lift and position the barrier in the vehicle.

- A. Lean the barrier forwards such that the front side is facing the ground.
- B. Bring the barrier assembly created in section VI into the vehicle through the cargo area.

- C. Once in the vehicle, rotate the barrier up and into position. Ensure the Lower Barrier Brackets are properly seated on the sheet metal crossmember behind the second row seats. The barrier should sit about 6° leaned back from vertical.
- D. Position the Support Bar on the driver side to line up with the Driver Lower Barrier Bracket and then insert (1) 5/16-18 button head screw [3X149] into the support bar and loosely attach (1) 5/16-18 whiz nut [3X619]. Repeat for the passenger side Support Bar with the remaining button head screw and whiz nut.
- E. Locate the (2) remaining M10 socket cap screws [3X254] and the (4) self drilling hex head screws [3X162].
- F. Starting on the driver side, align the large hole closest to the barrier in the Lower Barrier Bracket with the threaded hole in the OEM crossmember. Loosely thread (1) M10 socket cap screw [3X254] through the hole. Repeat on the passenger side with the remaining M10 screw.
- G. Again starting on the driver side, align the rear hole in the Lower Barrier Bracket with the corresponding hole in the OEM crossmember. A 3/8" bolt (not included) can be used to align these holes.
- H. Making sure the bracket stays aligned, use a 3/8" socket to drive (1) self drilling screw [3X162] into each of the (2) small holes on the Lower Barrier Bracket. Remove the 3/8" alignment bolt if one was used. Figure 5 shows a fully fastened Lower Barrier Bracket.
- I. Use an 8mm hex key to tighten the socket cap screw [3X254].
- J. Repeat steps G. - I. for the passenger side Lower Barrier Bracket using the remaining fasteners.

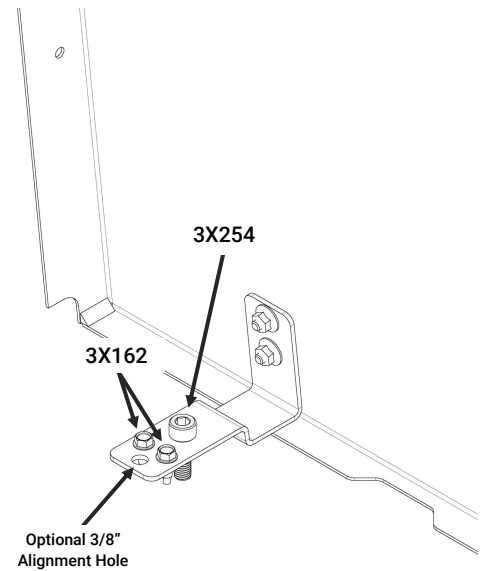

**Figure 5**

## **VIII. Tighten the Bolts**

- A. Ensure that the barrier is straight and in the proper position.
- B. Tighten the (4) 1/4-20 whiz nuts [3X612] at the bottom of the barrier using a 7/16" socket.
- C. Using a 3/16" hex key and a 1/2" wrench and socket, start by gently tightening the fasteners going left and right through the barrier flanges, Support Bars, and the L-Brackets until the parts can just barely move. Then tighten the fasteners that are going front to back that are holding the L-Brackets to the back of the barrier. Finally, fully tighten the fasteners going left and right that were partially tightened previously. This technique will prevent the barrier flanges from being warped.
- D. Tighten the fasteners attaching the Support Bars to the Lower Barrier Brackets.
- E. All fasteners should now be tight.

## **IX. Install the Wings**

- A. Remove the (5) bolts from the top of the barrier window.
- B. Place the Barrier Top Wing [3WIN572114] against the front of the barrier and align the holes in the wing with the top holes in the barrier. Secure in place with the hardware removed in step A.
- C. Locate the Driver Upper Barrier Wing [3WIN572112] and align the holes in the wings flange with the corresponding holes on the upper driver side of the barrier flange.
- D. Secure the upper wing in place using (3) 1/4-20 button head screws [3X258] and (3) 1/4-20 whiz nuts [3X612]. Orient the fastener such that the nuts are contacting the wing.
- E. Locate the Driver Lower Barrier Wing [3WIN572113] and align the holes in the wings flange with the corresponding holes on the lower driver side of the barrier flange.
- F. Secure the lower wing in place using (3) button head screws [3X258] and (3) 1/4-20 whiz nuts [3X612] with the nuts contacting the wing.
- G. Repeat steps C. - F. for the passenger side using the Passenger Upper Barrier Wing [3BAR572110], the Passenger Lower Barrier Wing [3WIN572111], and the remaining (6) button head screws [3X258] and (6) whiz nuts [3X612].

### **Installation complete**

If you have any problems with this installation or have any questions please call (800-480-6680) and ask for technical assistance.

PARTS LIST			
ITEM	QTY	PART NUMBER	REVISION NUMBER
1	1	4BAR572100	A
1.1	1	3BAR572110	A
1.2	14	3X03	
1.3	14	3X612	
1.4	1	3BAR572100	C
1.5	1	3G540	
2	1	4BAK572100	B
2.1	2	3BAR572105	B
2.2	2	3BAR572104	B
2.3	2	3BAR572101	C
2.4	1	4BAK572101	A
2.4.1	8	3X149	
2.4.2	8	3X619	
2.4.3	4	3X612	
2.4.4	4	3X36	
2.4.5	4	3X254	--
2.4.6	4	3X162	
2.5	1	3BAR572102	D
2.6	1	3BAR572103	D
3	1	4WIK572110	A
3.1	1	3WIN572111	A
3.2	1	3WIN572111	A
3.3	1	3WIN572112	A
3.4	1	3WIN572113	A
3.5	1	3WIN572114	A
3.6	1	4WIK572111	A
3.6.1	12	3X258	
3.6.2	12	3X612	

