

INSTALLATION GUIDE

**2020+ UTILITY INTERCEPTOR
FENDER WRAPS
4BFW47UINT20**

Pro-gardTM
PRODUCTS LLC.

STRONG. RELIABLE. SECURE.

**THESE COMPONENTS ARE REQUIRED
TO INSTALL THE OUTBOARD SEATBELTS**

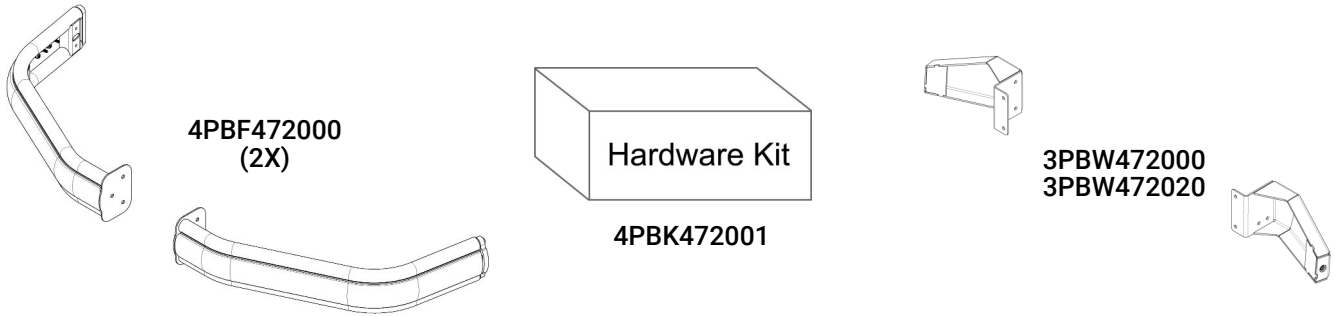

I. The following tools will be required to complete the installation

- | | | |
|------------------------------|----------------------------|------------------------|
| A. 7/16, 9/16, & 5/8 Sockets | C. 15mm Deep Well Socket | E. 13mm & 18mm Sockets |
| B. 5/32 Allen Wrench | D. 5/32, 3/16 Allen Wrench | F. 1/2, 3/4 Wrenches |

II. Read all instructions and refer to last page to ensure all parts were received

WARNING: *Locate All wiring, fuel lines, brake lines, coolant lines, or refrigerant lines before drilling any holes or installing any self-drilling fasteners.*

III. Remove Push Bumper and Fascia

- A. Disassemble push bumper and outer brackets. (Fig. 1) **NOTE: Push bumper is required for wrap installation. If you haven't installed the push bumper please refer to the instructions for PB47UINT20HD.**

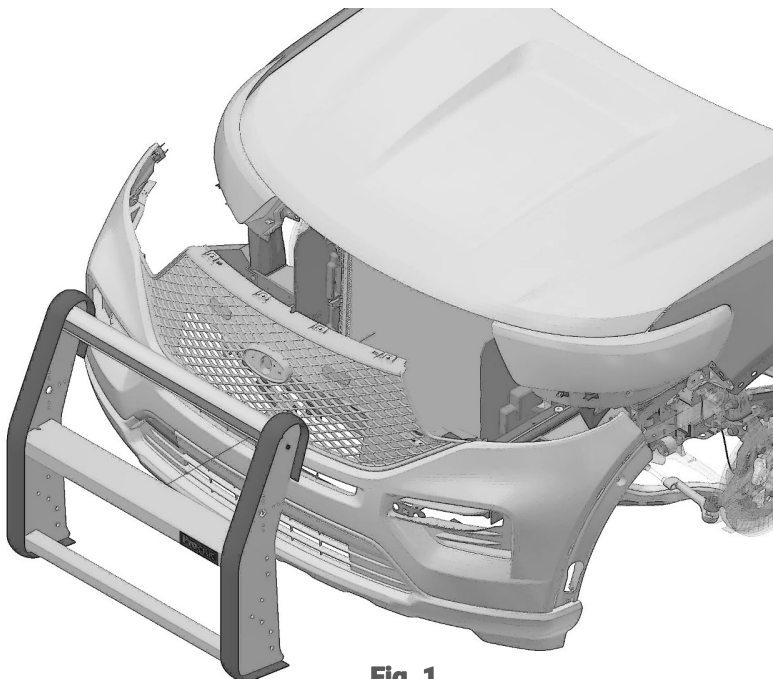

Fig. 1

- B. Using a 10mm socket, remove the (4) bolts, located underneath the hood, from the top of the grille.
- C. Using a 7mm socket, remove the (12) fasteners, (6) per side, holding the inner fender liners to the fascia.
- D. Continuing with the 7mm socket, remove the (7) fasteners along the bottom of the fascia.
- E. Using a 10mm socket, remove the (4) bolts, (2) per side, located inside the front portion of the front fenders. Increased access to these fasteners can be gained by removing additional fasteners from the inner fender liners.
- F. Unclip the fender trim on both sides from the fascia using a trim tool if necessary. The rear portion of these plastic trim pieces can remain attached to the metal fenders.
- G. The front fascia will now be held on with a couple of clips located underneath the headlights and two tabs on the top of the grille near the bolts removed in step (A). Lift the top edge of the grille over the two tabs and gently pull to release the fascia from the vehicle. Unplug or remove any wiring as the fascia is removed. NOTE: do not allow the fascia to hang from any wiring.

IV. Install Rear Outboard Brackets

- A. Remove OEM fasteners at forward surface of the outboard horns. (Fig. 2)
- B. Install (3) Interior Standoffs [2PBW4721001] and Outboard Bracket [3PBW472000] to outboard frame horns, re-using OEM fasteners. (Fig. 2)
- C. Fasten remaining mounting holes using (3) M8x1.25x80mm socket head cap screws and (3) M8 washers and tighten all.. (Fig. 2)

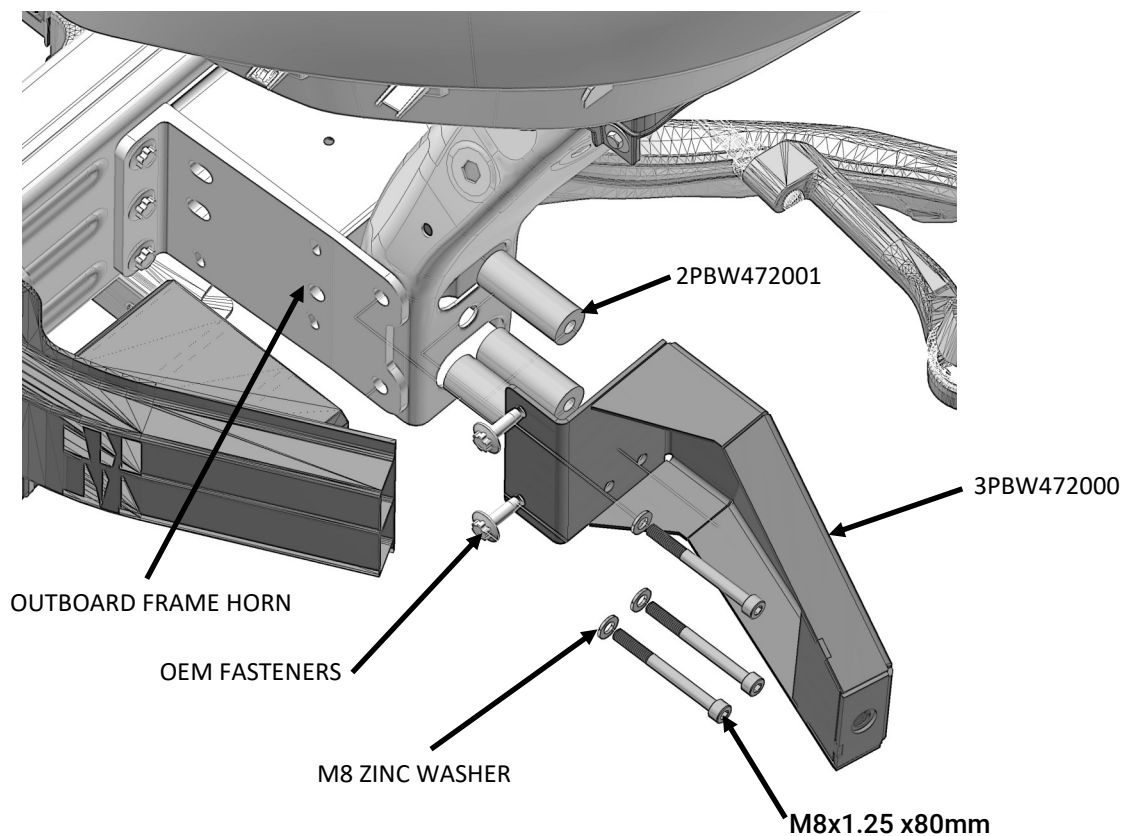

Fig. 2

V. Re-install the Fascia

A. Re-installation will be the reverse of step III. (Fig. 3)

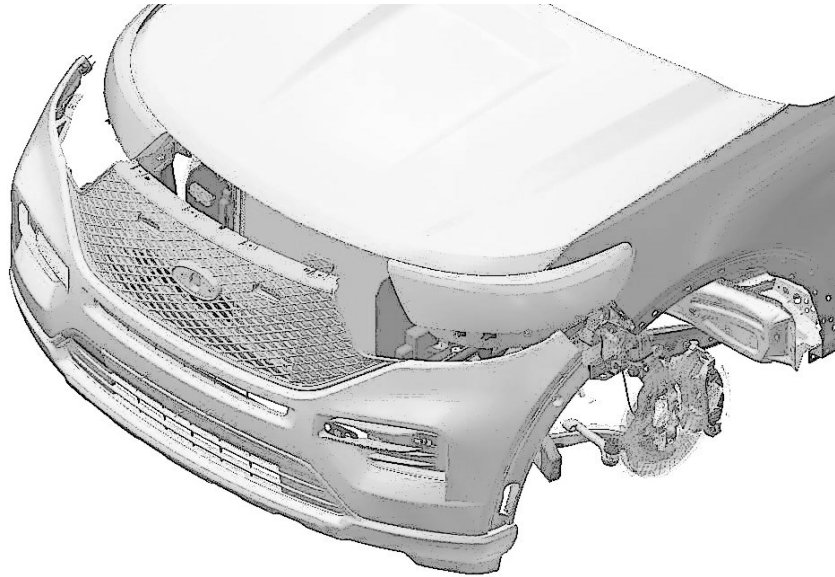

Fig. 3

VI. Re-install the Push Bumper

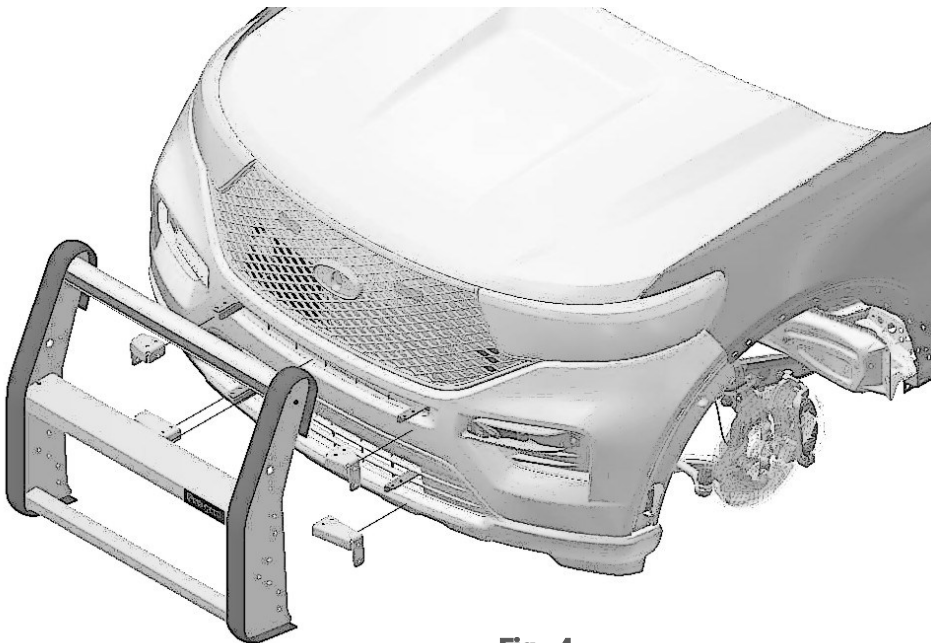
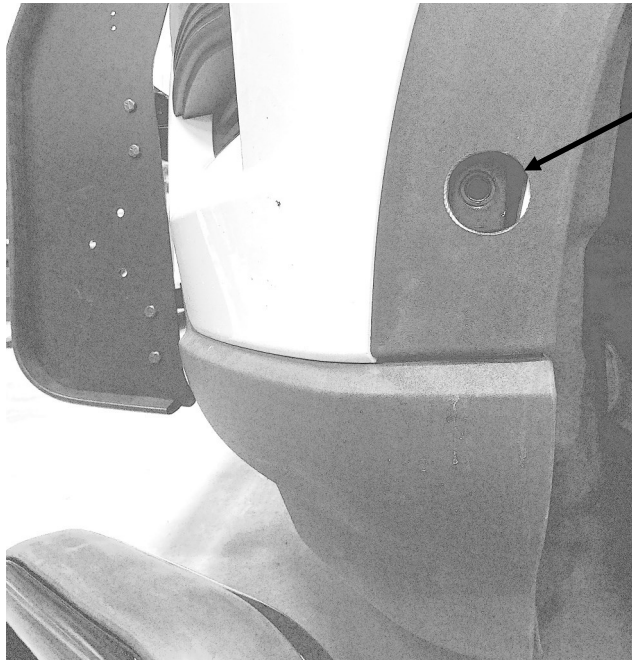

Fig. 4

VII. Drill Wheel-Fender Trim

- A. Wheel-fender trim must be drilled before re-installing on the vehicle.
- B. On the last page of these instructions you will find a template to locate where to drill the hole for the stand-off that supports the wrap assembly.
- C. Once hole position is are marked, use a 1-1/2" diameter hole saw and drill hole through wheel-fender trim. (Fig. 5)



WHEEL-FENDER TRIM AFTER DRILLING

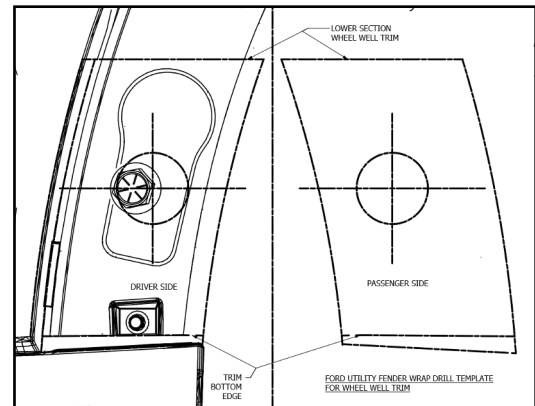

SEE LAST PAGE FOR THIS DRILL TEMPLATE

Fig. 5



NOTE: ALL SUBSEQUENT CAD ILLUSTRATIONS WILL NOT SHOW THE WHEEL-FENDER TRIM

VIII. Fender Wrap Installation

- A. Loosely assemble the wrap to the push bumper using (3) 3/8-16 x .875 black hex hd bolts [3X603] and (3) 3/8 nuts [3X601]. (Fig. 6)

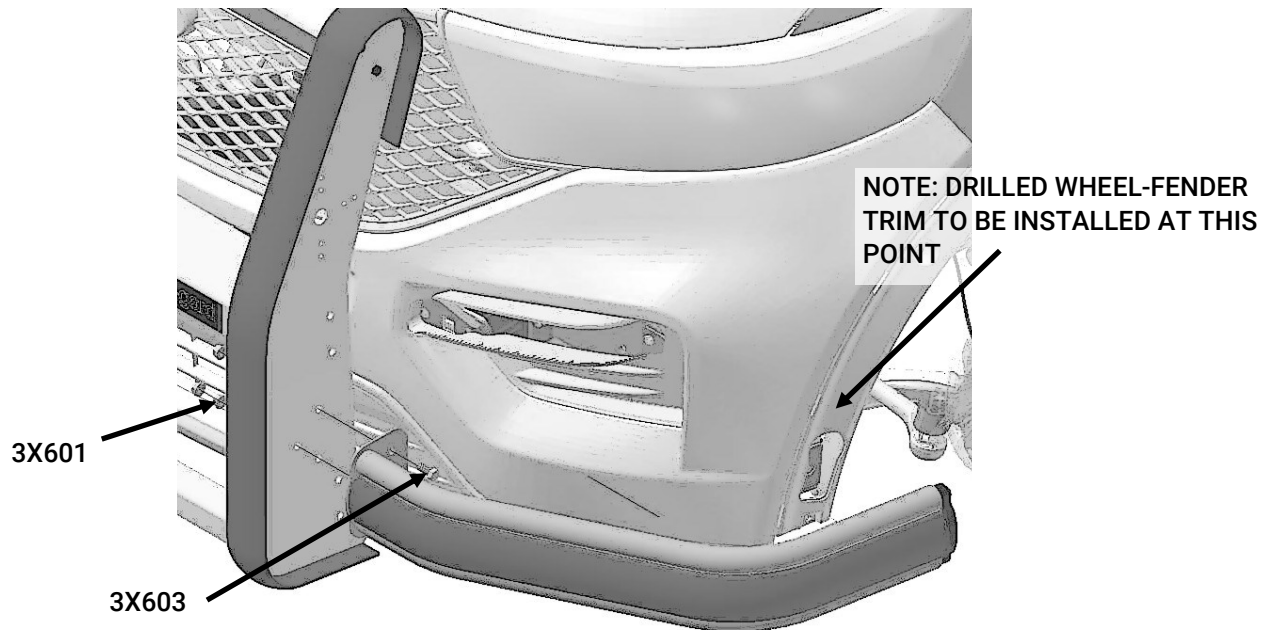

Fig. 6

- B. Using a 5/16" hex wrench, remove 2 bolts attaching the black end cap and remove the cap. (Fig. 7)
- C. Using a 7/16" socket, remove 2 nuts from the rubber bumper nut plate next to the cap that was just removed and pull the rubber strip, along with the retainer, out of the way to expose the wrap rear mounting hole. (Fig.7)

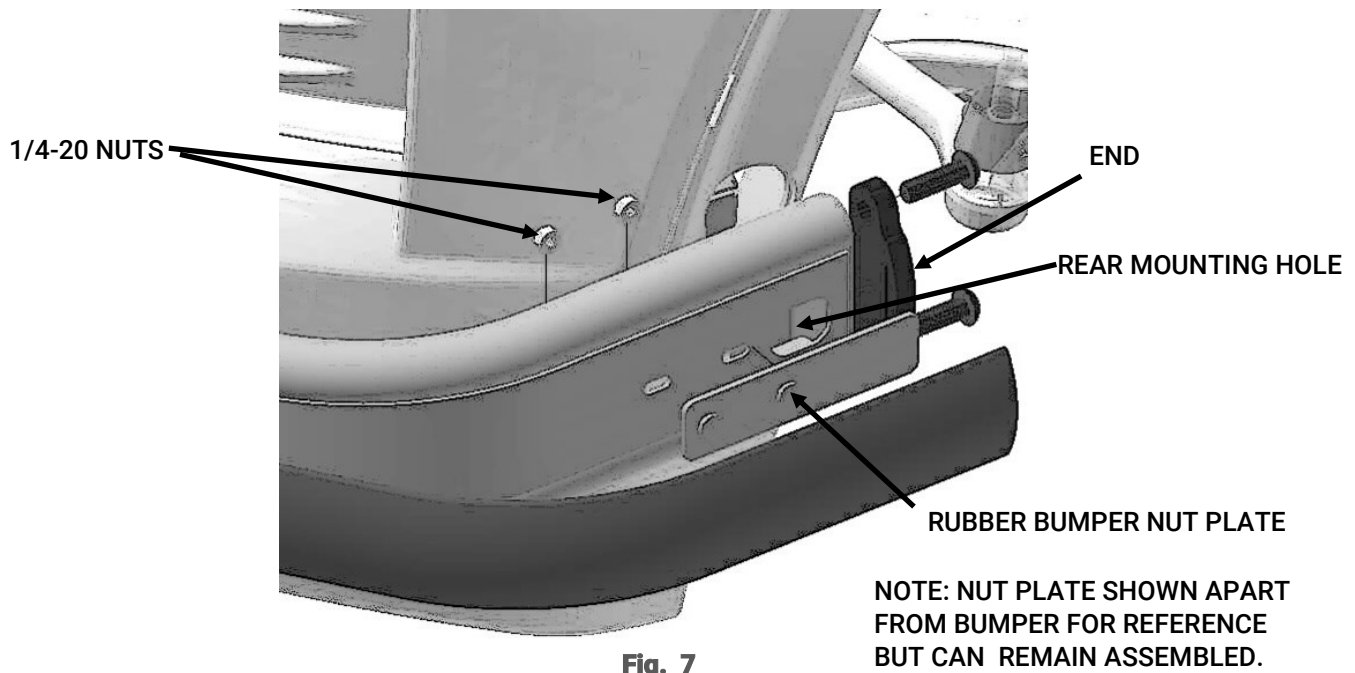

Fig. 7

- D. Assemble the outboard spacer [3PBW472001] thru drilled wheel-fender trim hole, against outboard bracket under the fascia (Fig. 8)
- E. Insert the 1/2-13 x 3" flanged hex bolt [90409A155] , thread into the support bracket behind the fascia and tighten with socket. (Fig. 8)

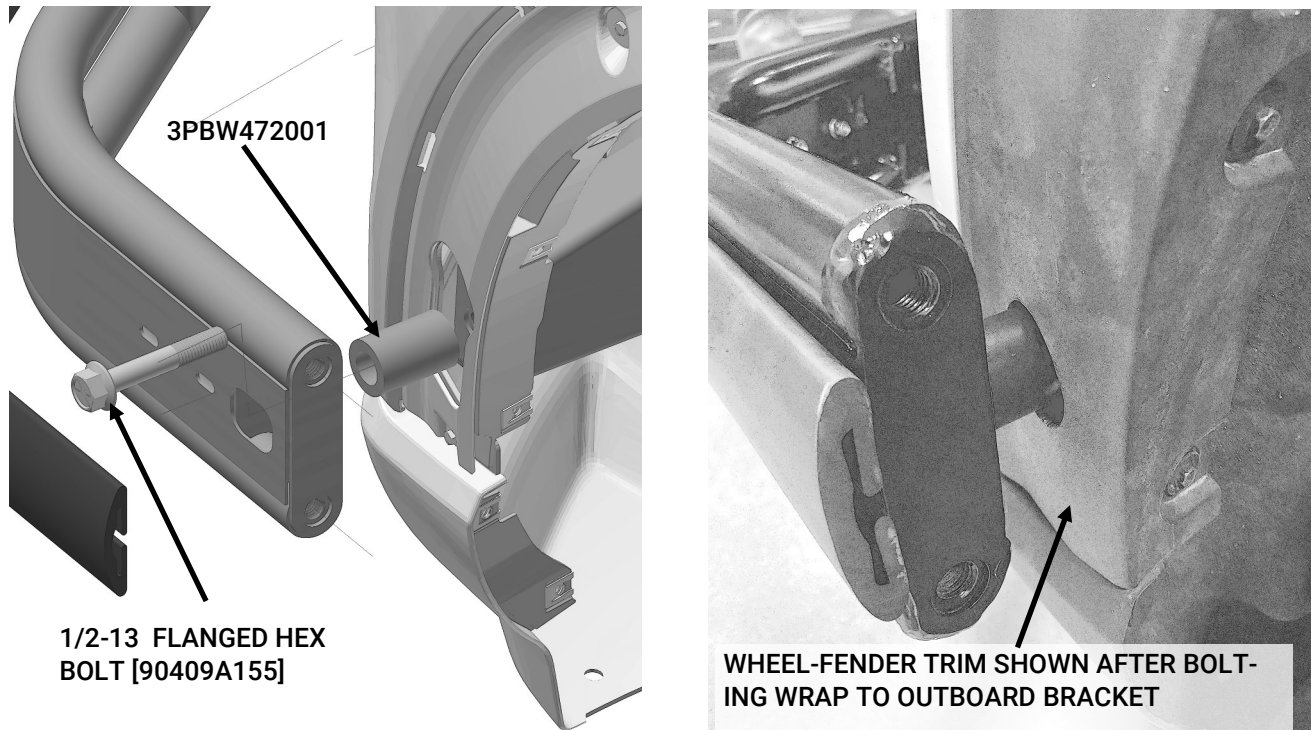

Fig. 8

- F. Re-assemble the rubber bumper and then the end cap. (Fig. 9)

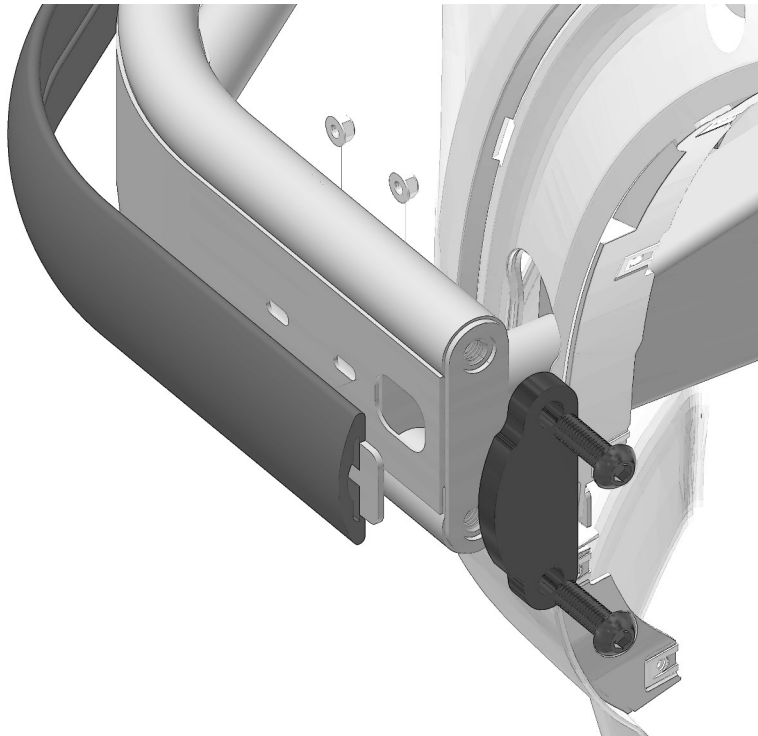

Fig. 9



Installation complete

If you have any problems with this installation or have any questions please call (800-480-6680) and ask for technical assistance.

PARTS LIST				
ITEM	QTY	PART NUMBER	REVISION NUMBER	DESCRIPTION
1	1	3PBW472000	C	DRIVER WRAP OUTBOARD BRACKET WELDMENT
2	1	3PBW472020	C	PASSENGER WRAP OUTBOARD BRACKET WELDMENT
3	2	4PBW472000	D	PUSH BUMPER WRAP ASSEMBLY
4	1	4PBK472001	B	PUSH BUMPER WRAP HARDWARE KIT
4.1	2	3PBW472001	B	WRAP OUTBOARD SPACER
4.2	2	90409A155 (MCMMASTER)	ANY	1/2-13 X 3.0" GR 8 FLANGE HEX SCREW
4.3	6	3X603	A	3/8-16 X 0.875" HEX HEAD BOLT, BLACK ZINC
4.4	6	3X601	A	3/8-16 SERRATED FLANGE HEX NUT, BLACK ZINC
4.6	6	91455A130_CLASS 10.9 STEEL FLAT WASHER		M8 WASHER ZINC
4.7	6	90128A282_ZNC-PLTD ALLOY STL SCKT HEAD CAP SCREW		M8 X 1.25 X 80mm SOCKET CAP SCREW ZINC
4.5	6	2PBW472001	A	WRAP BRACKET INTERIOR STANDOFF

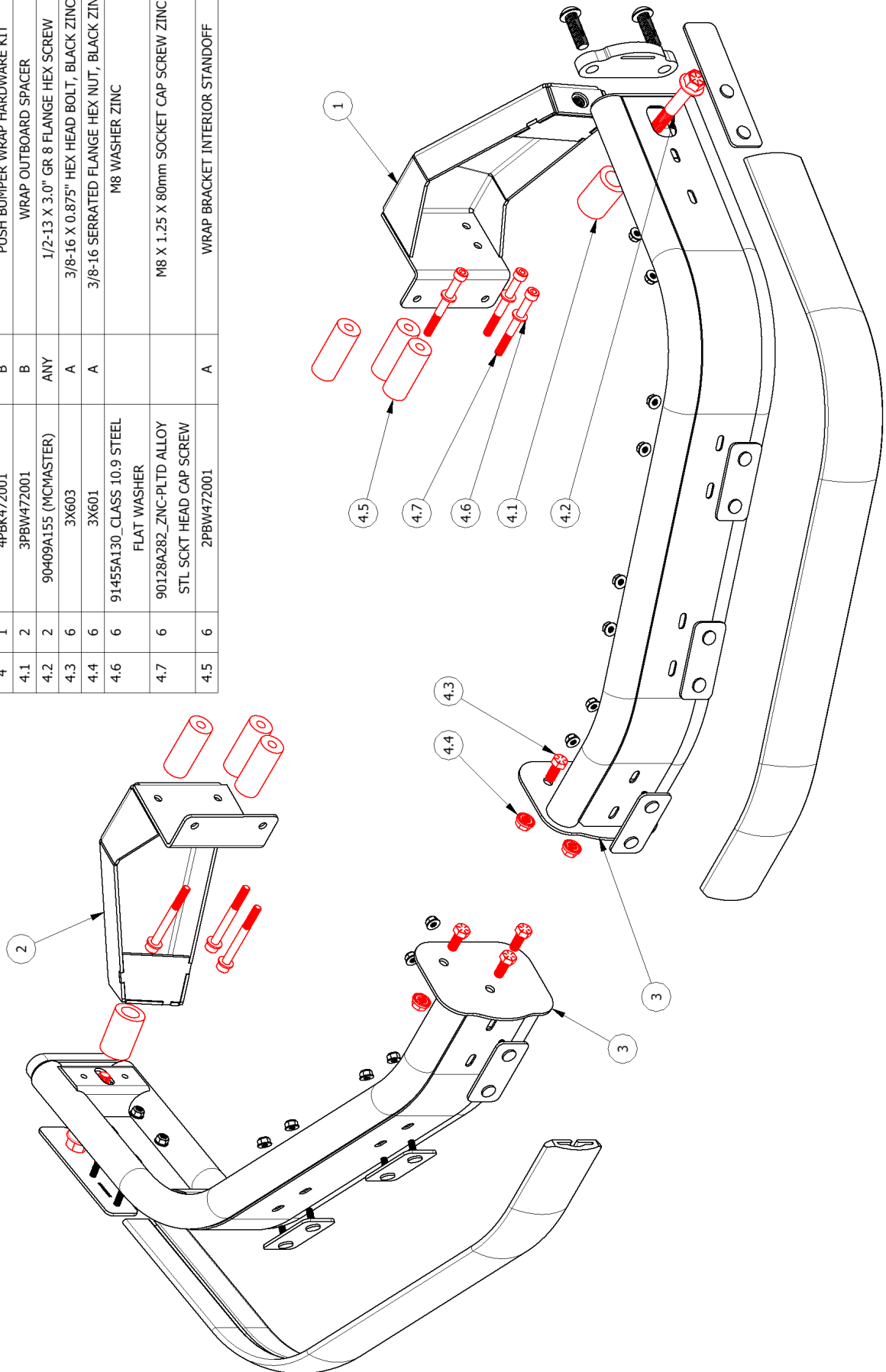

LOWER SECTION
WHEEL WELL TRIM

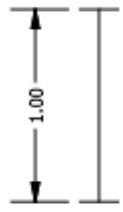

CHECK SCALE

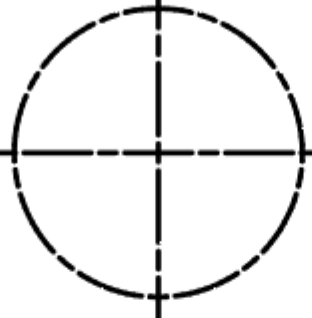
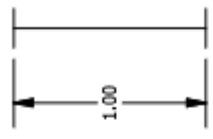

PASSENGER SIDE

FORD UTILITY FENDER WRAP DRILL TEMPLATE
FOR WHEEL WELL TRIM

TRIM
BOTTOM
EDGE

DRIVER SIDE

