

# **INSTALLATION GUIDE**

**2015 - 2020 CHEVY TAHOE  
SPACE SAVER PLUS VIPER SHIELD  
PARTITION  
PVSSP57XXT15A**

**Pro-gard™**  
PRODUCTS LLC.

**STRONG | RELIABLE | SECURE**

**pro-gard.com  
800.480.6680**

THESE COMPONENTS ARE REQUIRED  
TO INSTALL THE PARTITION

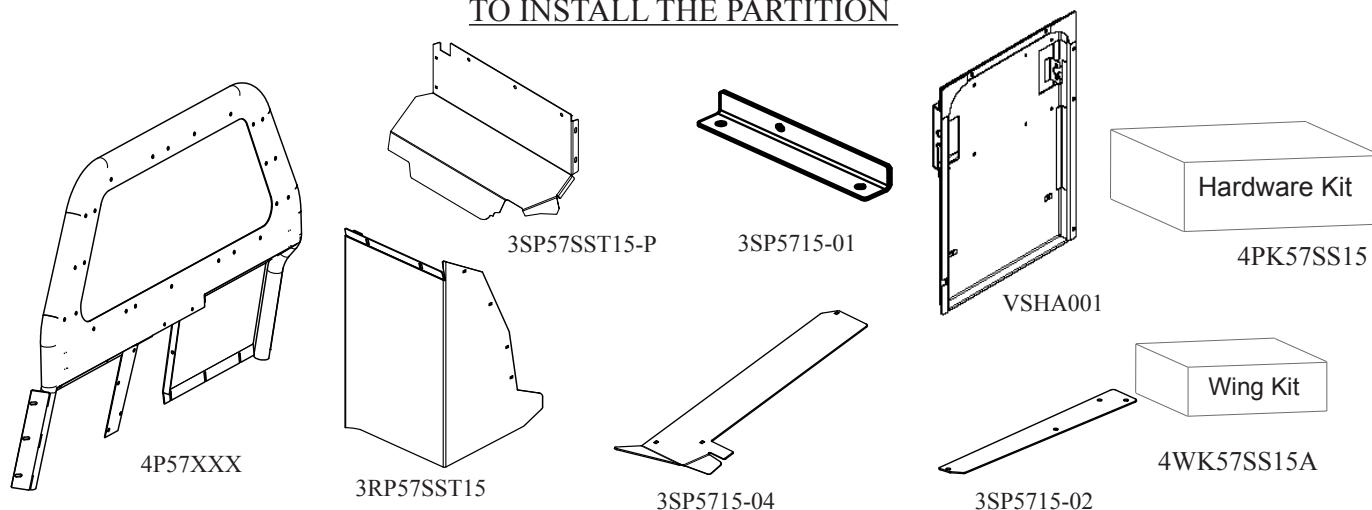

**I. The following tools will be required to complete the installation.**

- A. 7/16" Socket & Ratchet
- B. 7/16" Open ended Wrench
- C. 3/16" Allen Wrench
- D. 3/8" Socket & Ratchet
- E. 3/16 "Drill Bit
- F. 1" Hole Saw & Drill Bit

**II. Read all instructions carefully and refer to pages 7 to ensure all parts were received.**

**WARNING:** *Locate All wiring, fuel lines, brake lines, coolant lines, or reffridgerant lines before drilling any holes or installing any self-drilling fasteners.*

**III. Preparing the B-Pillar.**

- A. Locate and remove the lower part of the b-pillar trim to access the sheet metal body. After the trim is removed put the 3PK5715-01D & 3PK5715-01P b-pillar brackets in location and mark the 4 holes to drill a pilot (with 3/16" drill bit) for the self tapping screws (3X162). The b-pillar bracket is located when the tab is all the way down on the slot as shown in fig. 1. Secure the b-pillar brackets to the driver & passenger sides of the vehicle with the self-tapping screws.

- B. Use the supplied b-pillar templates on the last 2 pages to mark the three holes in the lower b-pillar trims and drill out the 1" holes so the standoffs can fit through and re-install the trim. **Proceed to step VI. to Prepare the driver-side mounting plate (3PK5715-02D) to be installed.**

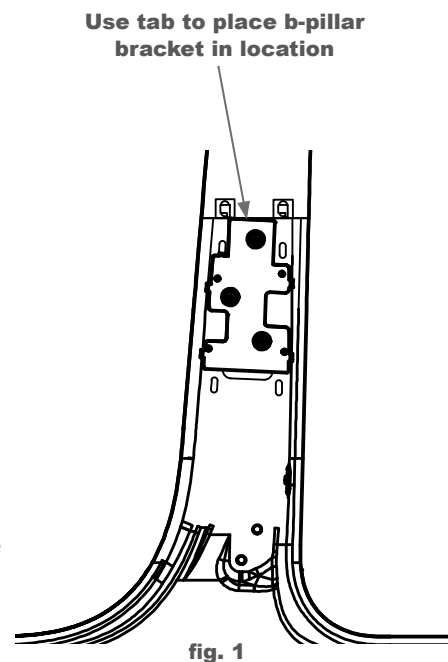

## IV. Bracket Installation.

- A. When b-pillar bracket installation is completed and the trim is reinstalled, then the driver-side mounting plate (3PK5715-02D) can be installed.
- B. Also at this time install the passenger-side mounting plate (3PK57SS15-02P) using three (3X149) screws leaving bolts loose until the partition is installed. (See fig. 2 and 3)

**NOTE:** *The recess panel must be placed in the vehicle before the partition with the OEM second row seating!*

Install the lower sheet metal panels to b-pillar brackets

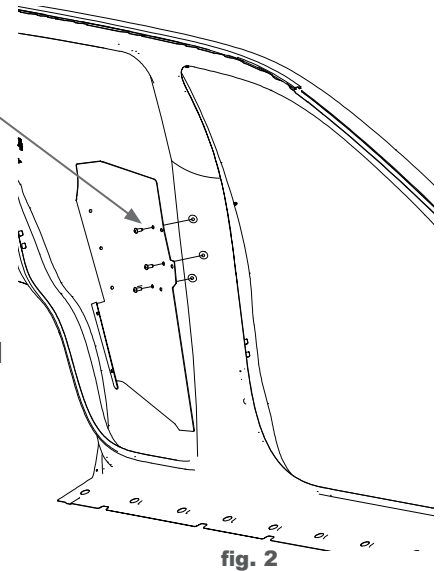

## V. Seat Protector & Recess Panel Installation

- A. Place the 3SP5715-02 Panel on the Driver's side, against the partition. Insure that the panel goes in front of the partition's plate on the driver's side. Align the holes in the Panel with the Partition and secure using the supplied 1/4-20 x 5/8" (3X36) bolts and whiz nuts (3X16Z). (See fig. 4)
- B. At this point the partition and the recess panel can be installed in the vehicle. Place the recess panel loosely in the vehicle just behind the center console. We recommend that two people lift the partition in place. Carefully lift the partition with another person thru the second row doors. Rest the partition on top of the second row seat and lift the bottom part of the partition up over the side panels towards the front as shown in fig. 5. Start the three (3X36) bolts and (3X16Z) whiz nuts on the side tabs of the partition to hold it in place.

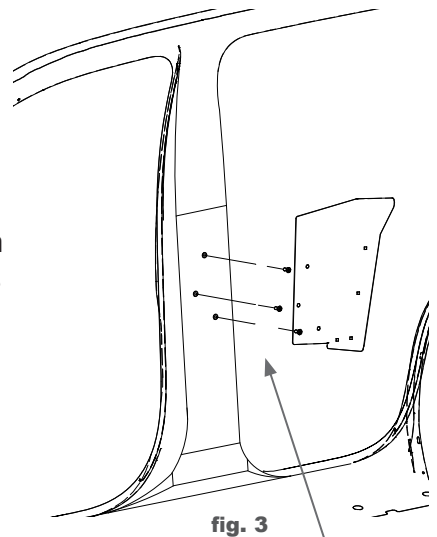

Set recess panel in vehicle before partition installation

Place 3X36 bolt into hole at this time. Access will be restricted later.

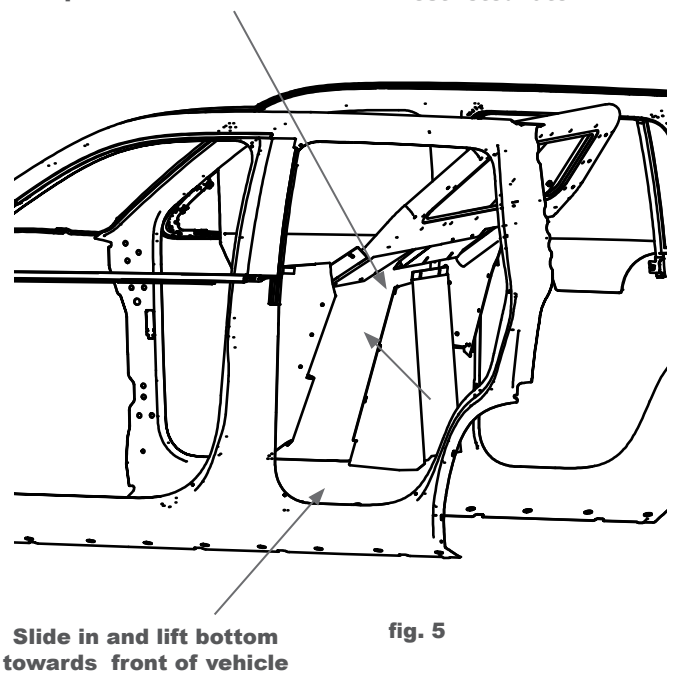
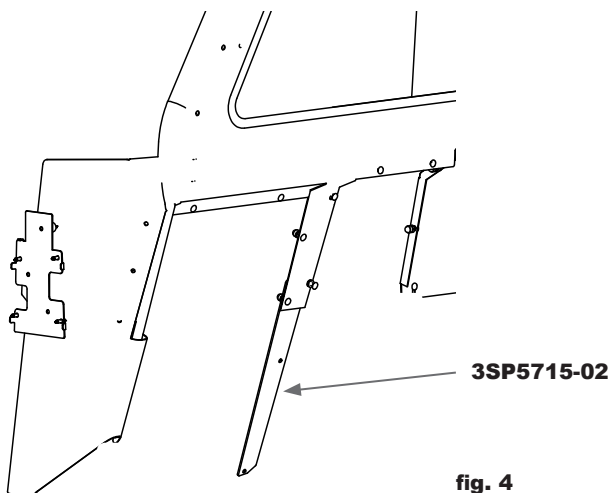

Slide in and lift bottom towards front of vehicle

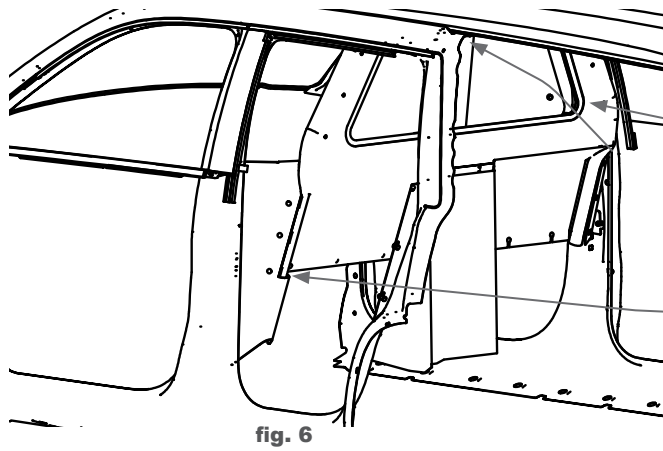
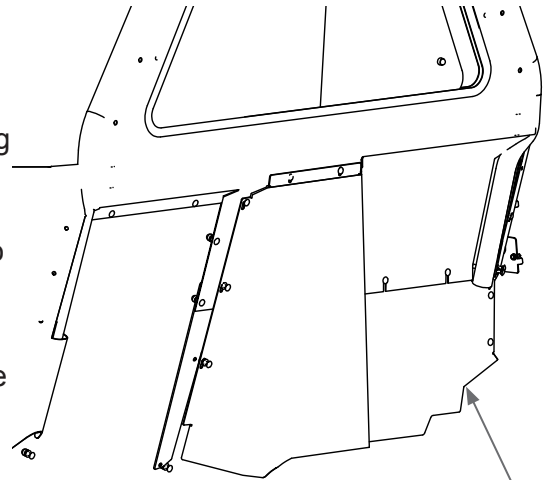

fig. 6

C. Have one person hold the partition tight to the ceiling of the vehicle while the other person tightens all the loose mounting screws on the panels. Be sure the roll bar fits tight inside the sheet metal panels with no gaps. (Refer to fig. 6 )

D. Now with the partition installed in the vehicle and the recess panel (3RP57SST15) loosely in place, install the two (3X36) bolts and (3X16Z) whiz nuts on the top of the recess panel and partition.



3SP57SST15-P

fig. 7

E. Place the passenger's side bucket seat protector (3SP57SST15 - P) in the vehicle from the front and set in location. Get all bolts started and tighten to secure. (See main diagram on page 7 and fig. 7)

F. Install the (3PK57SST15) filler panel on the passenger side lower b-pillar area. (As shown in fig. 8 and main diagram)

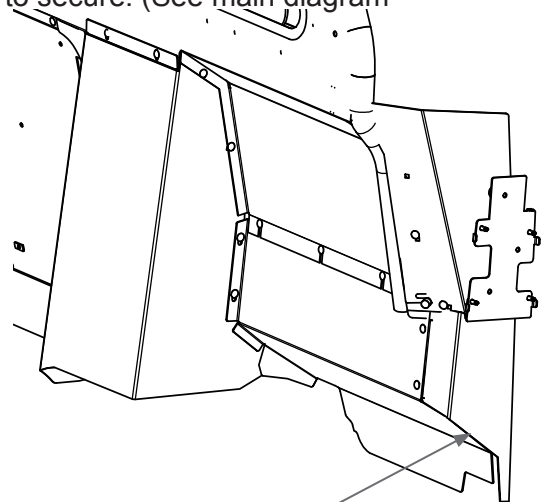

3PK57SST15

fig. 8

G. Place the Viper Shield Housing in the partition cutout location. Align the holes in the panel with the partition and 3SP5715-02 panel. Align the housing making sure all holes are aligned, and get the bolts started. Then, align the seat protector starting those bolts as well. Leave all bolts hand tight until all panels are installed, then tighten securely. (See Fig. 9)

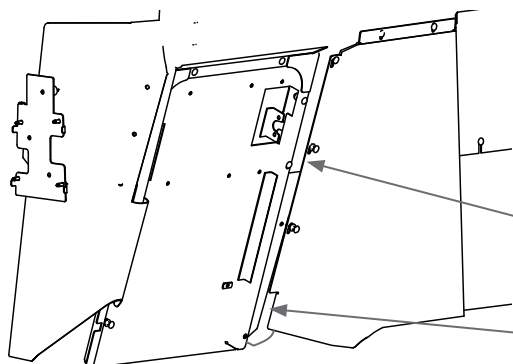

VSHA001

3SP5715-02

fig. 9

H. Place the 3SP5715-04 bottom panel against the Viper Shield Housing and Partition. Align the holes in the panel with the Partition and VSHA001 Housing. First install the top bolt on the left edge of the panel through the partition and the housing, securing it with the supplied 1/4-20 x 5/8" (3X36) carriage bolt and whiz nut (3X16Z). Next install the remaining bolts securing the panel to the VSHA001 Housing using whiz nuts to secure the bolts. (See Fig. 10)

I. Place the 3SP5715-01 support bracket aligning the holes against the VSHA001 Housing and the 3PK5715-02D side panel, then using the provided 3X36 bolts and 3x16Z nuts secure it. (See fig. 11)

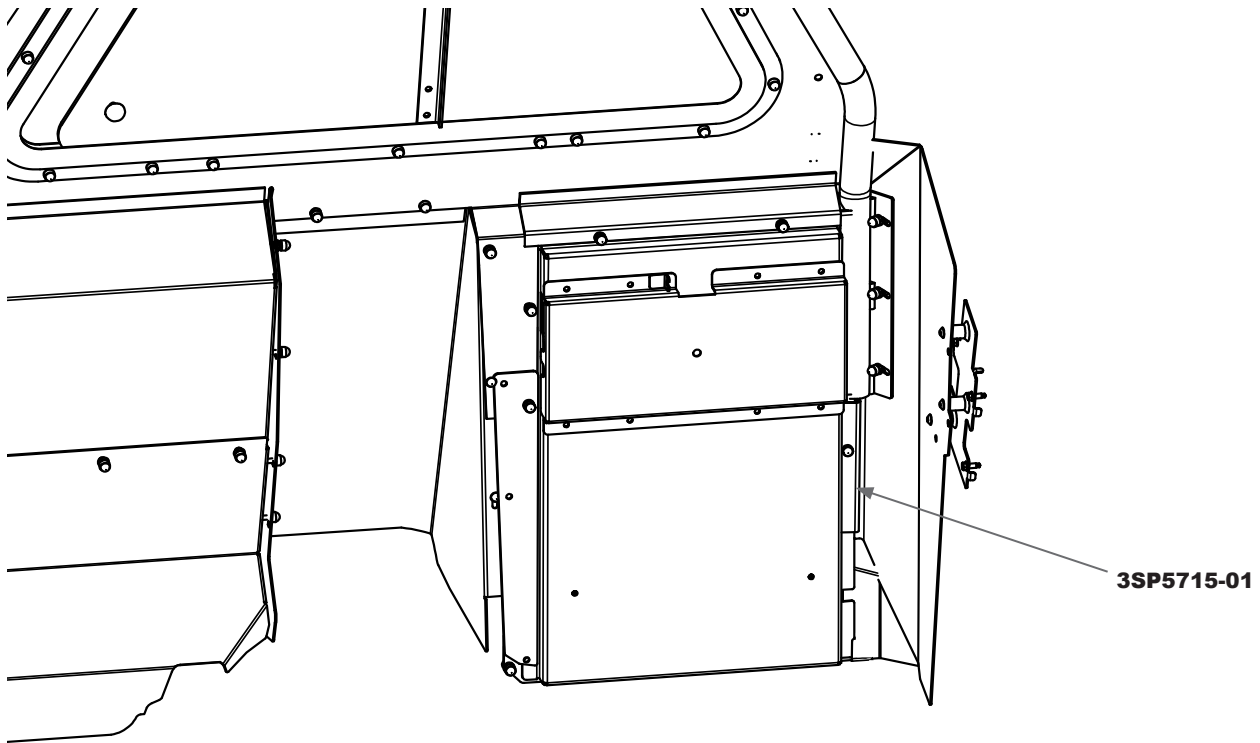
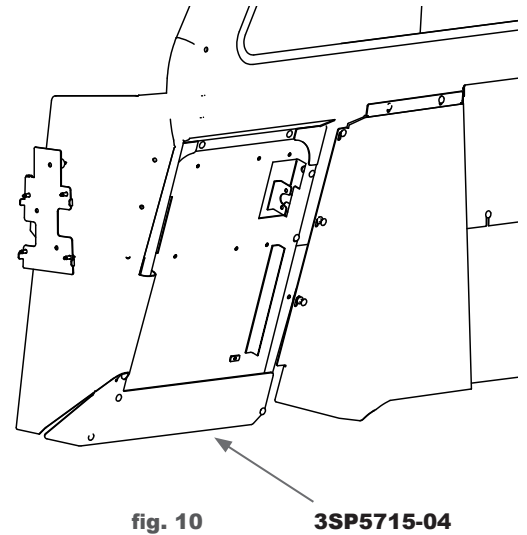
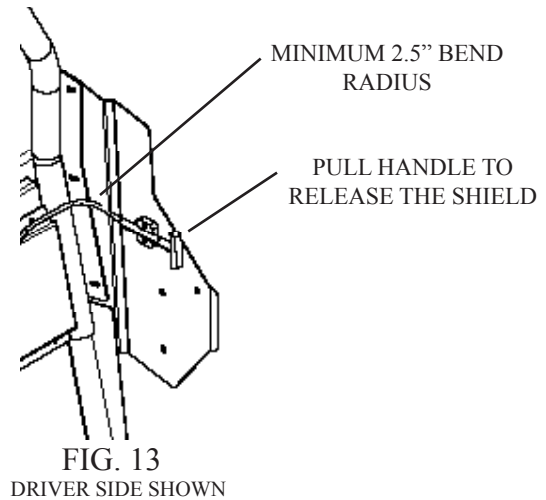
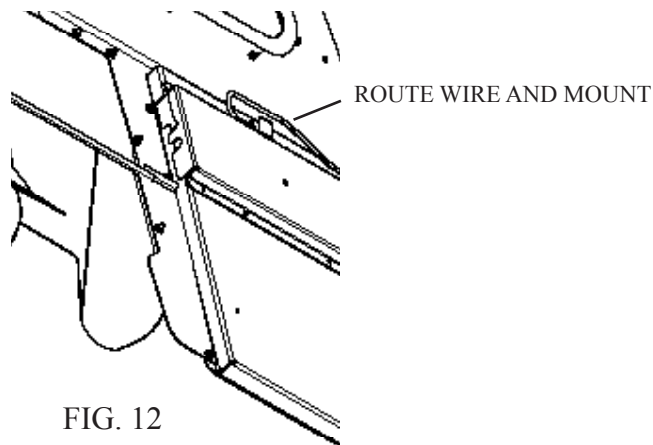

fig. 11



## VI. Pull Handle Installation.

- A. Find a easy and quick mounting location for the pull handle that ensures a minimum bend radius of 2.5" when routing the cable. The pull handle will release the viper shield latch when needed. We recommend mounting to the Driver-side Mounting Plate (3PK5715-02D) as shown in Fig. 13 using our provided template.
- B. Mark and drill hole in the Driver-side Mounting Plate (3PK5715-02D) for mounting, and attach with the supplied hardware.

## VII. Releasing Operation

- A. Test and ensure the pull mechanism releases properly. To place the shield back in place firmly push it back in the housing until you hear the latch lock.

## VIII. Finishing The Installation.

- A. Adjust the overall installation for fit and function of all components. Once satisfied, ensure all fasteners are tight. Make sure all (3X16Z) Whiz Nuts are fitted with (3X145) plastic caps.

**Installation complete!**

**If you have any problems with this installation then call the toll free number (800-480-6680) and ask for technical assistance.**

PARTS LIST			
ITEM	QTY	PART NUMBER	DESCRIPTION
1	1	3PK57SS15-02P	SHEET METAL SIDE PANEL
2	1	3RP57SST15	RECESS PANEL
3	1	3PK5715-02D	LOWER SHEET METAL PANEL
4	1	3PK5715-01D	B-PILLAR BRACKETS
5	1	3PK5715-01P	B-PILLAR BRACKET
6	1	3PK57SST15	FILLER PANEL BRACKET
7	1	4P8106XXX	2015 TAHOE SPACE SAVER PARTITION (VARIES)
8	1	3SP57SST15- P	SEAT PROTECTOR PASSENGER SIDE
9	1	3SP5715-02	VIPER SEAT PROTECTOR PART 1
10	1	3PVSH15	UNIVERSAL VIPER SHIELD HOUSING
11	1	3SP5715-04	VIPER SEAT PROTECTOR PART 2
12	1	3SP5715-01	VIPER SHIELD MOUNTING BRACKET
13	1	3SP5715-03	SEAT PROTECTOR BRACE

HARDWARE LIST			
ITEM	QTY	PART NUMBER	DESCRIPTION
14	31	3X36	1/4-20 X 5/8 CARRIAGE BOLT
15	6	3X149	5/16-18 X 3/4 BSHCS, BK
16	8	3X162	#14 X 3/4" SELF DRILLING HEX HEAD SCREW
17	31	3X145	BLACK PLASTIC CAP
18	31	3X16Z	1/4-20 WHIZ NUT

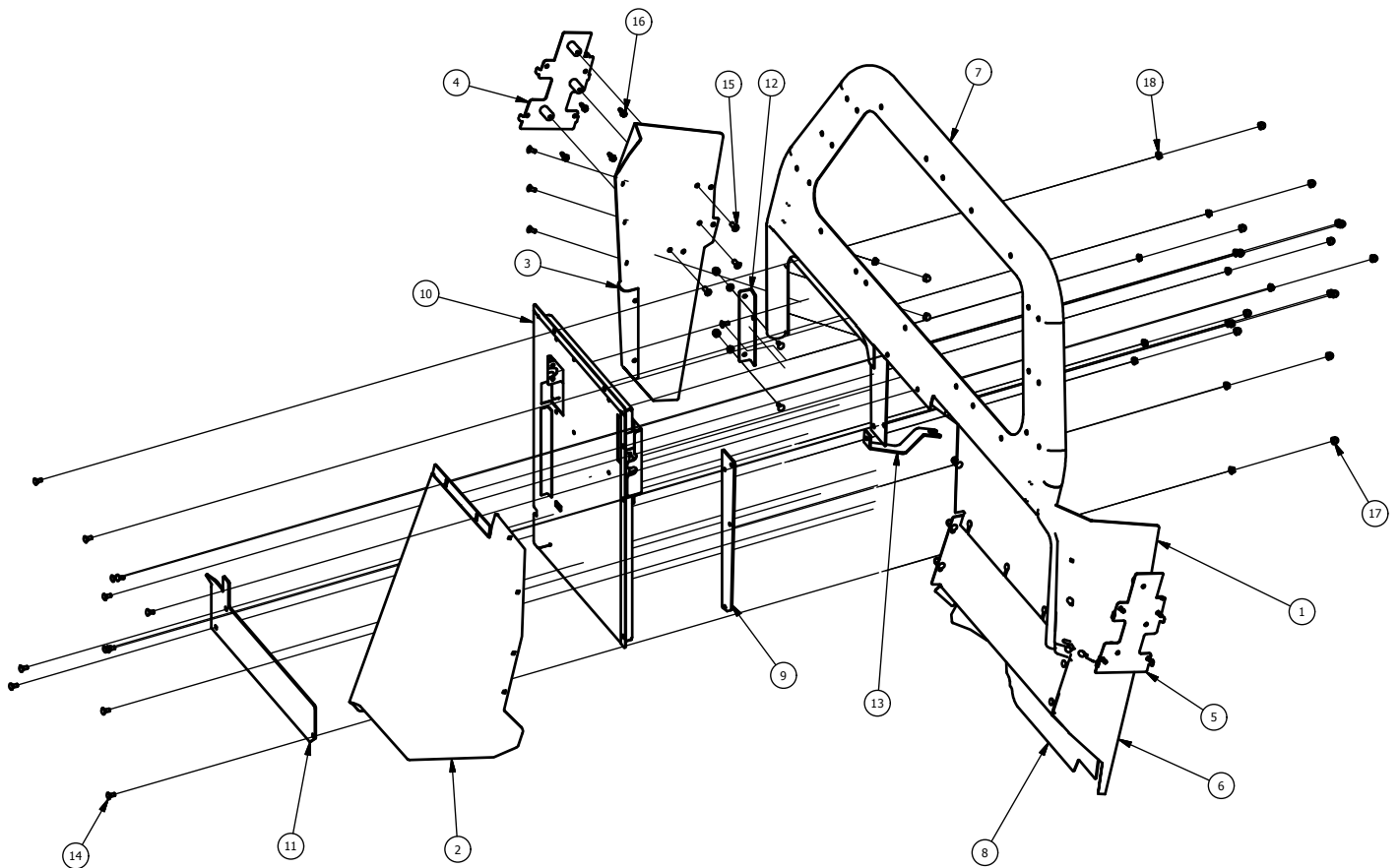

- DIRECTIONS**
1. CUT ALONG THE DASHED LINES
  2. REMOVE THE B-PILLAR TRIM AND PLACE TEMPLATE INSIDE ALIGNING CUT OUT AREAS WITH THEIR CORRESPONDING FEATURES ON THE OEM TRIM PANEL
  3. CENTER PUNCH 3 HOLE LOCATIONS THRU TEMPLATE & DRILL/CUT 1" DIA. HOLE
  4. REINSTALL TRIM PANELS OVER TOP OF THE B-PILLAR BRACKETS

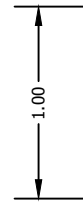
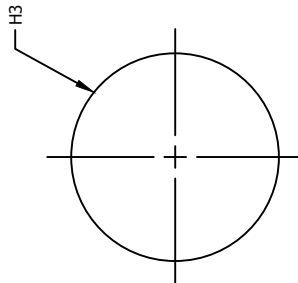
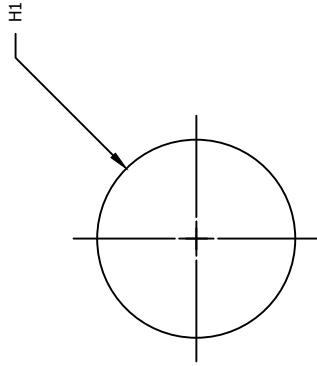

CHECK SCALE  
SELECT NONE FOR PAGE SCALING  
WHEN PRINTING FROM .pdf FILE

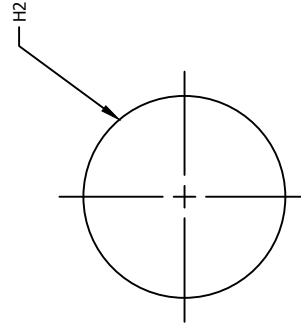
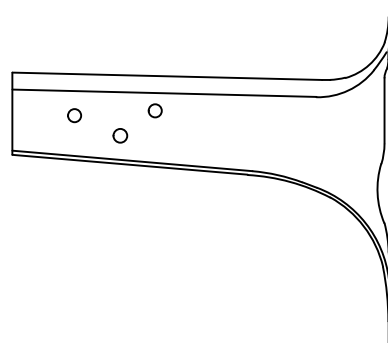

2015-CURRENT  
CHEVROLET TAHOE PPV  
B-PILLAR TRIM TEMPLATE PASSENGER



- DIRECTIONS**
1. CUT ALONG THE DASHED LINES
  2. REMOVE THE B-PILLAR TRIM AND PLACE TEMPLATE INSIDE ALIGNING CUT OUT AREAS WITH THEIR CORRESPONDING FEATURES ON THE OEM TRIM PANEL
  3. CENTER PUNCH 3 HOLE LOCATIONS THRU TEMPLATE & DRILL/CUT 1" DIA. HOLE
  4. REINSTALL TRIM PANELS OVER TOP OF THE B-PILLAR BRACKETS

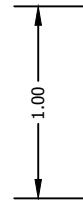
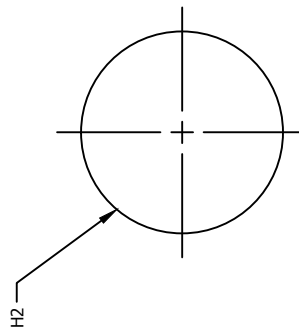
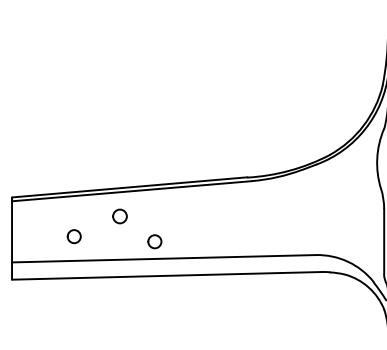
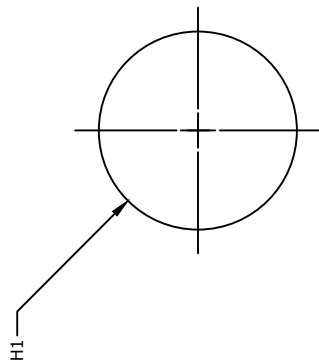

CHECK SCALE  
SELECT NONE FOR PAGE SCALING  
WHEN PRINTING FROM .pdf FILE

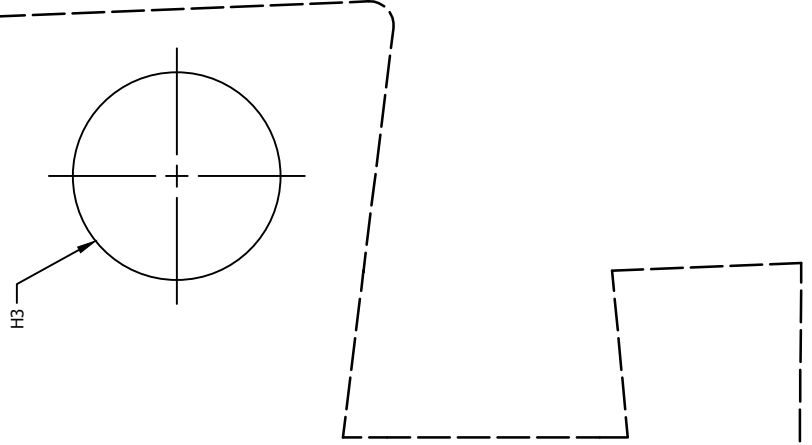

2015-CURRENT  
CHEVROLET TAHOE PPV  
B-PILLAR TRIM TEMPLATE DRIVER



#### DIRECTIONS

1. CUT ALONG THE OUTER EDGE
2. LINE THE CUT OUT AREAS WITH THEIR CORRESPONDING FEATURES ON THE MOUNTING PLATE
3. CENTER PUNCH 2 HOLE LOCATIONS THRU THE TEMPLATE & DRILL 5/16" DIA. HOLES
4. CAREFULLY REMOVE ANY BURRS

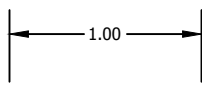

CHECK SCALE  
SELECT NONE FOR PAGE SCALING  
WHEN PRINTING FROM .pdf FILE

2015-CURRENT  
CHEVROLET TAHOE PPV  
PULL HANDLE MOUNTING TEMPLATE