

# **INSTALLATION GUIDE**

**2021+ F-150  
SPACE SAVER PARTITION  
PRPSP8100FT21A**

**Pro-gard**<sup>TM</sup>  
PRODUCTS LLC.

**STRONG. RELIABLE. SECURE.**

**THESE COMPONENTS ARE REQUIRED  
TO INSTALL PARTITION**

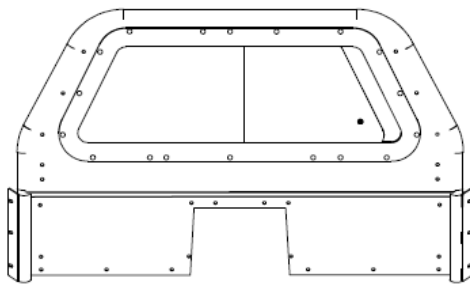

3P8103

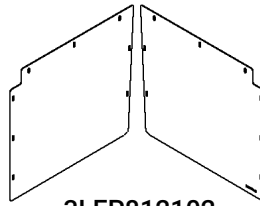

3LEP812102

(X2)

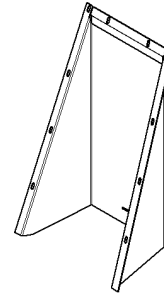

3REP812102



3PAK81210



3WIK812100

**I. The following tools will be required to complete the installation**

- |                       |                |                       |
|-----------------------|----------------|-----------------------|
| A. 3/16" drill bit    | C. 3/8" socket | E. 7/16" Socket       |
| B. 3/16" Allen Wrench | D. 1" hole saw | F. Trim removal tools |

**II. Read all instructions and refer to last page to ensure all parts were received.**

---

**WARNING:** *Locate All wiring, fuel lines, brake lines, coolant lines, or refrigerant lines before drilling any holes or installing any self-drilling fasteners.*

---

**III. B-pillar Bracket Installation**

- Locate and remove the lower part of the B-pillar trim to access the sheet metal body.
- Locate the B-pillar brackets [3P8116D and 3P8116P]. Rearward flanges will wrap around B-pillar and top of bracket will be up against the upper trim (Figure1).
- Drive in (4) self-tapping screws [3X162]. If required, use a 3/16" drill bit for pilot hole.
- Repeat for opposite side.

**IV. B-pillar Trim Modification and Re-installation**

- Use the template supplied on the last page to mark the three hole locations in each of the trim panels.
- Using 1" hole saw, drill the holes marked in the previous step.
- Re-install the B-pillar trim.

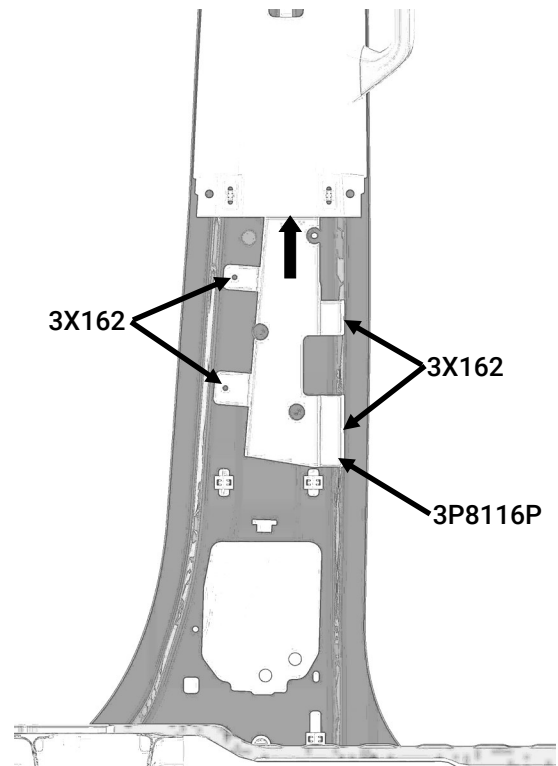

**Fig. 1**

## V. Mounting Plate Installation

- A. Locate passenger mounting plate [3PAK812102] aligning the (3) plate holes the (3) standoffs protruding through the B-pillar trim and loosely fasten with (3) 5/16-18 button head screws [3X149] (Figure 2).
- B. Repeat on the driver side mounting plate [3PAK812101].

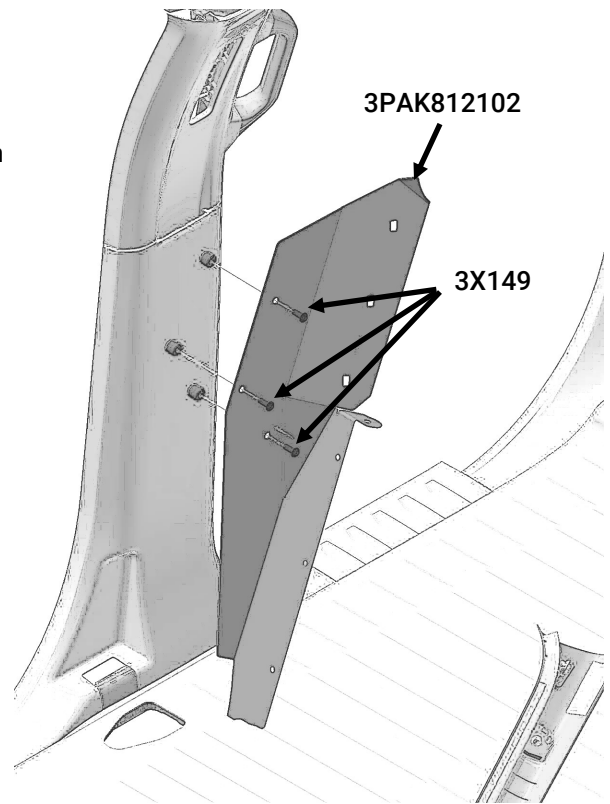

Fig. 2

## VI. Partition Installation

**NOTE:** Due to the size and weight of the partition it is recommended that two people lift and position the partition in the vehicle.

- A. Prepare (3) carriage bolts [3X36] and (3) whiz nuts [3X16Z] on each side of the vehicle.
- B. To position the partition [3P8103], skew the partition such that one end is near either the driver or passenger front door completely in front of the mounting plate. Then bring the other end to the front side of the mounting plate as well. Finally, move the partition rearward in the vehicle. The partition will sit on the shelf flanges that are part of the mounting plates. The retaining screws installed in section "V" will serve as pins to help the partition stay in place during assembly.
- C. Align the three uppermost holes in each of the mounting plates with the respective slots on the partition. Loosely secure in place with the fasteners prepared in step A. Install the fasteners such that the smooth head of the carriage bolt is facing towards the outside of the vehicle (Figure 3). The fasteners will be tightened in a later section.

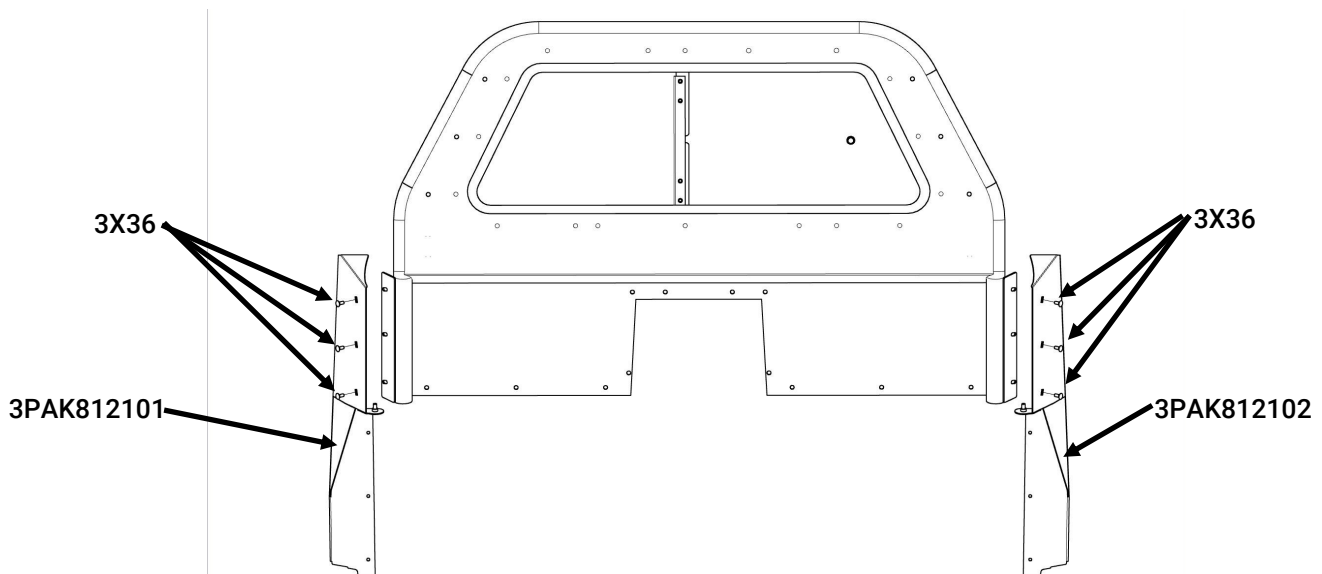

Fig. 3

## VII. Lower Extension Panels

- A. Place one of the Lower Extension Panels [3LEP812102] against the partition and slide the panel towards the outside and under the roll bar. Align the (3) holes at the top of the panel and the (3) holes along the outside of the panel with their respective holes in the partition and the mounting plate (Figure 4).
- B. Loosely install a carriage bolt [3X36] with whiz nut [3X16Z] into each of the (6) holes identified in the previous step. Install the fasteners such that the smooth head of the carriage bolt is facing towards the rear of the vehicle.
- C. Repeat on the driver side using (6) more carriage bolts [3X36], and (6) more whiz nuts [3X16Z].

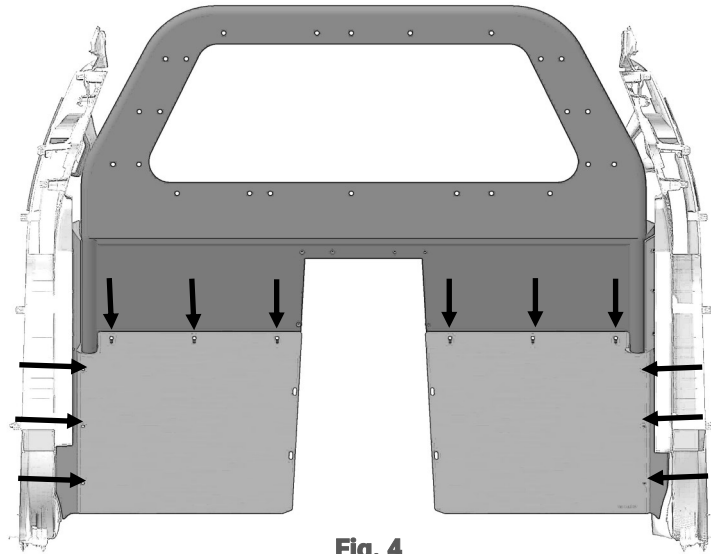

Fig. 4

## VIII. Recess Panel

- A. Set the Recess Panel [3REP812100] into the vehicle.
- B. Align the (10) slots on the Panel with the (10) corresponding slots on the partition and the Lower Extension Panels (Figure 5).
- C. Loosely fasten the Recess Panel to the partition using (10) carriage bolts [3X36] and (10) whiz nuts [3X16Z] to fasten.

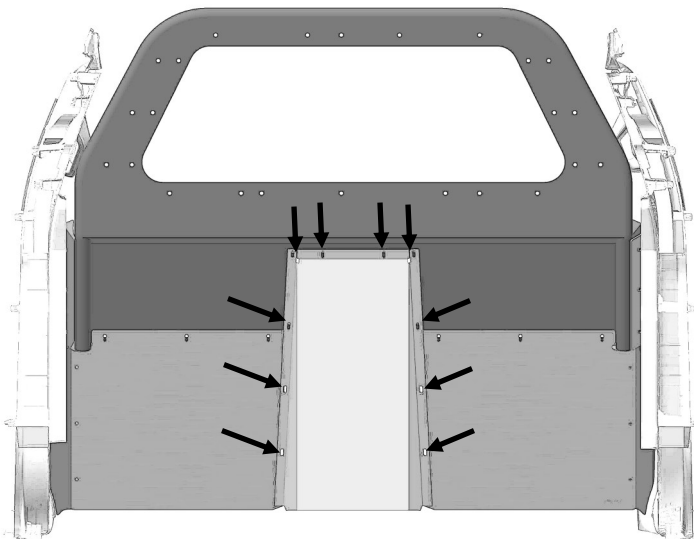

Fig. 5

## **IX. Tightening the Bolts**

- A. Adjust the partition forwards or backwards until the tube is concentric with the shelf flange on both sides. Tighten the (6) fasteners holding the partition to the mounting plates using a 7/16" socket. These are the fasteners that were loosely installed in section "VI, step C".
- B. Have a second person push forward on the top of the partition while the first person uses a 3/16" Hex wrench to tighten the (6) button head screws holding the mounting plates to the B-pillar brackets. These are the fasteners that were loosely installed in section "V, step C". This step will slightly rotate the partition causing it to fit tighter against the headliner.
- C. Adjust the Lower Extension Panels to achieve the desired fitment and then tighten all the relevant fasteners using a 7/16" socket.

## **X. Finishing Steps**

- A. Ensure all fasteners are tight and all panels secure.
- B. Install the wings according to the instructions included with them.
- C. Place plastic caps [3X145] over all fasteners protruding from the partition.

### **Installation complete**

If you have any problems with this installation or have any questions please call (800-480-6680) and ask for technical assistance.

PARTS LIST				
ITEM	QTY	PART NUMBER	REVISION NUMBER	DESCRIPTION
1	2	3LEP812102	B	SEAT PROTECTOR
2	1	3P8103		2015 TAHOE PARTITION
3	1	3REP812100	A	RECESS PANEL
4	1	4PAK812100	A	PARTITION KIT 2021 F150
5	1	4WIK812101	A	21' F150 FULL WIDTH PARTITION WING KIT

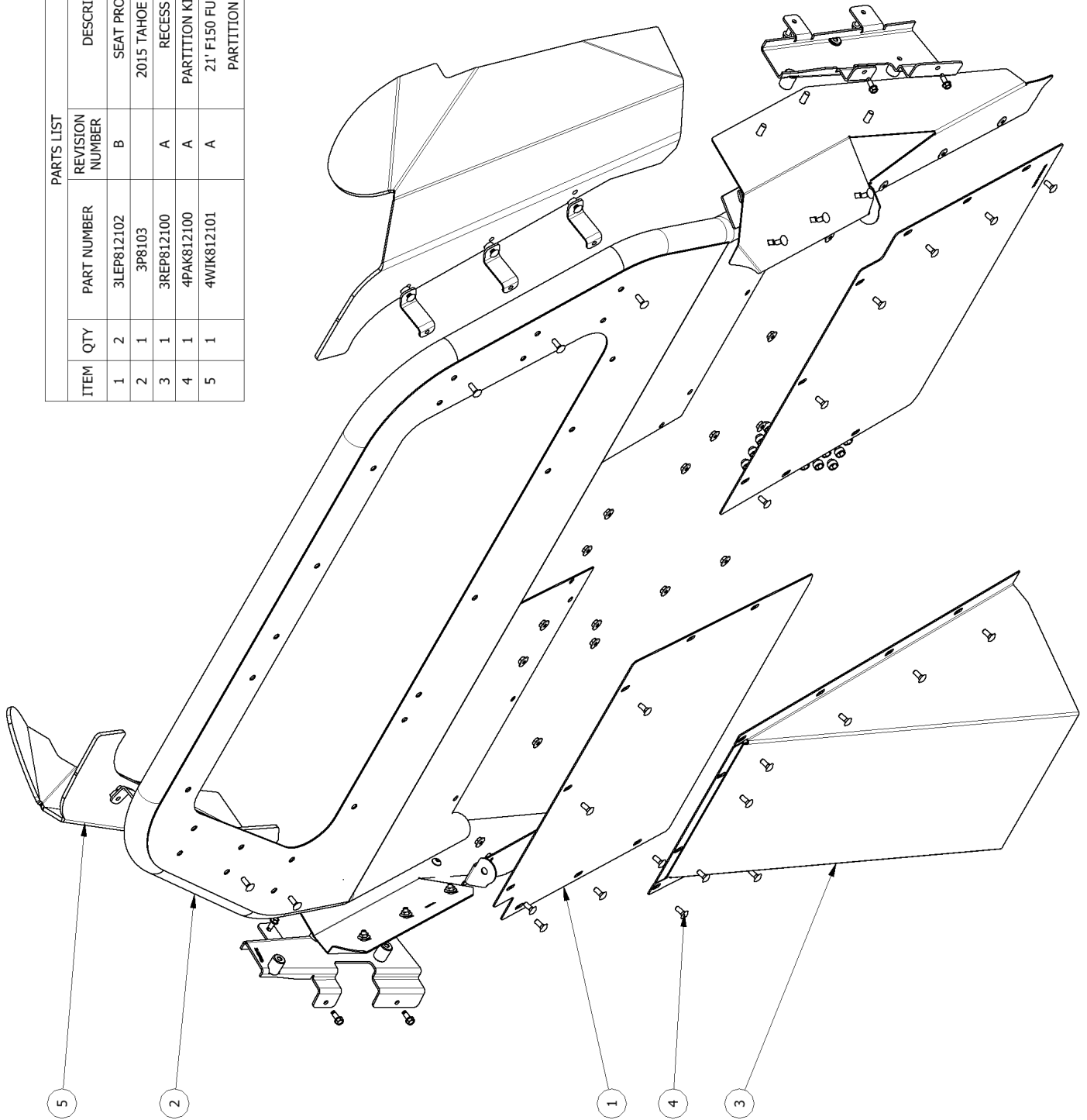

ALIGN CUT OUTS HERE

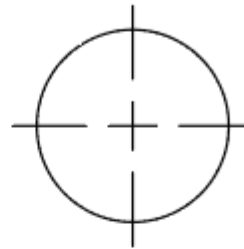
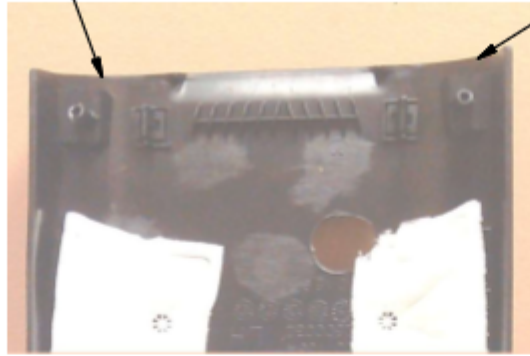

#### DIRECTIONS

1. CUT ALONG DASHED LINES

2. REMOVE THE B-PILLAR TRIM AND PLACE TEMPLATE INSIDE, ALIGNING CUT-OUT AREAS WITH THE CORRESPONDING FEATURE SHOWN

3. CENTER PUNCH 3 HOLE LOCATIONS THRU TEMPLATE AND DRILL/CUT 1" DIA HOLE

4. REINSTALL TRIM PANELS OVER TOP OF THE B-PILLAR BRACKETS

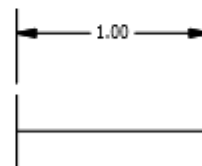
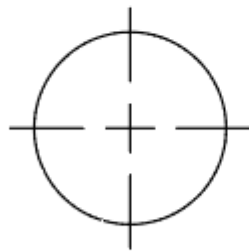

CHECK SCALE

SELECT NONE FOR PAGE SCALING  
WHEN PRINTING FROM .pdf FILE

2016+ F-150  
B-PILLAR TRIM TEMPLATE  
DRIVER SIDE

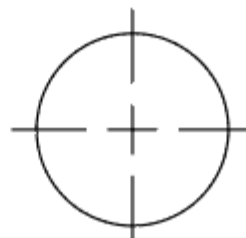

SEE NEXT PAGE FOR PASSENGER TEMPLATE



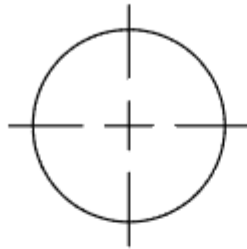

#### DIRECTIONS

1. CUT ALONG DASHED LINES

2. REMOVE THE B-PILLAR TRIM AND PLACE TEMPLATE INSIDE, ALIGNING CUT-OUT AREAS WITH THE CORRESPONDING FEATURE SHOWN

3. CENTER PUNCH 3 HOLE LOCATIONS THRU TEMPLATE AND DRILL/CUT 1" DIA HOLE

4. REINSTALL TRIM PANELS OVER TOP OF THE B-PILLAR BRACKETS

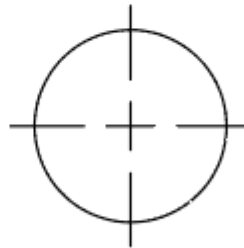
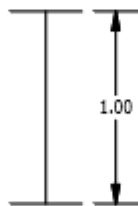
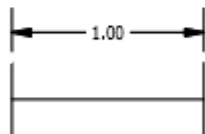

CHECK SCALE

SELECT NONE FOR PAGE SCALING  
WHEN PRINTING FROM .pdf FILE

2016+ F-150  
B-PILLAR TRIM TEMPLATE  
PASSENGER SIDE

