

INSTALLATION GUIDE

**2021+ DODGE DURANGO PURSUIT /SSV
PB67D21HD PUSH BUMPER**

Pro-gardTM
PRODUCTS LLC.

STRONG. RELIABLE. SECURE.

**THESE COMPONENTS ARE REQUIRED
TO INSTALL THE PUSH BUMPER**

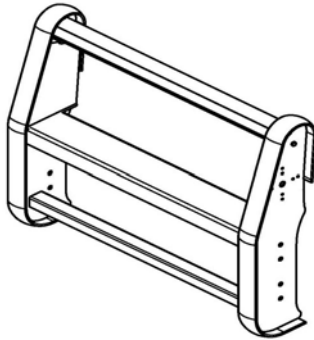

4PBDHD



4PBK672100

I. Refer to the diagram above and on last page to verify all parts were received.

II. The following tools will be required to complete the installation:

7/16" Socket w/ driver
13mm Open end wrench
10mm Socket

7/16" Open end wrench
3/4" Socket
5.5mm Socket

13mm Socket
3/4" Open end wrench
8mm Socket

III. Read all instructions carefully before starting the assembly process.

WARNING: *Locate all wiring, fuel lines, brake lines, and /or cooling lines before drilling any holes or installing any fasteners.*

IV. Fascia Removal

- A. Using a trim tool, carefully release the seven clips (2) attaching the flare (1) to the fender and remove the flare. (Fig. 1)
- B. Remove the fasteners (3) that secure the wheel liners to the fascia. (Fig. 1)

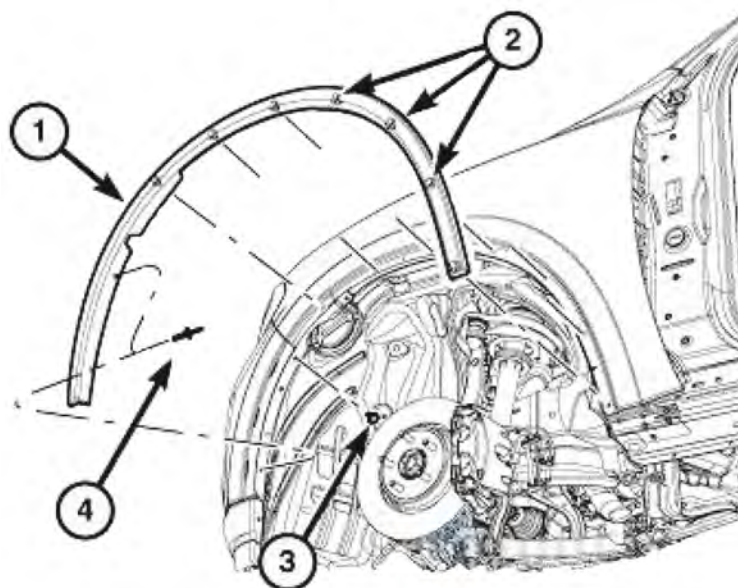

Figure 1

- C. Remove the four lower retainers (4). (Fig. 2)
- Release the integral latches at the wheel well openings (2) and the radiator grille assembly.
 - Disconnect the fog lamp electrical connectors (3), if equipped.
- D. Carefully remove the fascia from the vehicle, remove/disconnect any wiring.

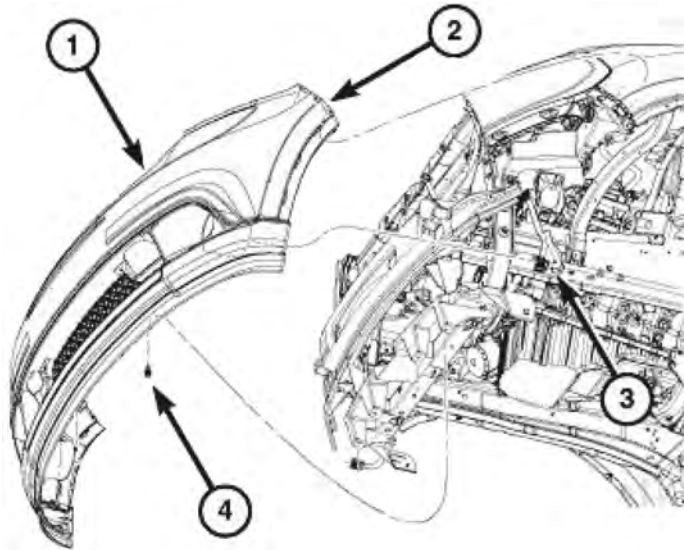

Figure 2

V. Push Bumper Bracket Installation

- A. On underside of vehicle, align holes of lower mounting bracket [3PBP672100] to frame rail and fasten using (2) serrated flange bolts [3X445]. (Fig. 3)
- B. Repeat for passenger lower mounting bracket [3PBP672101].

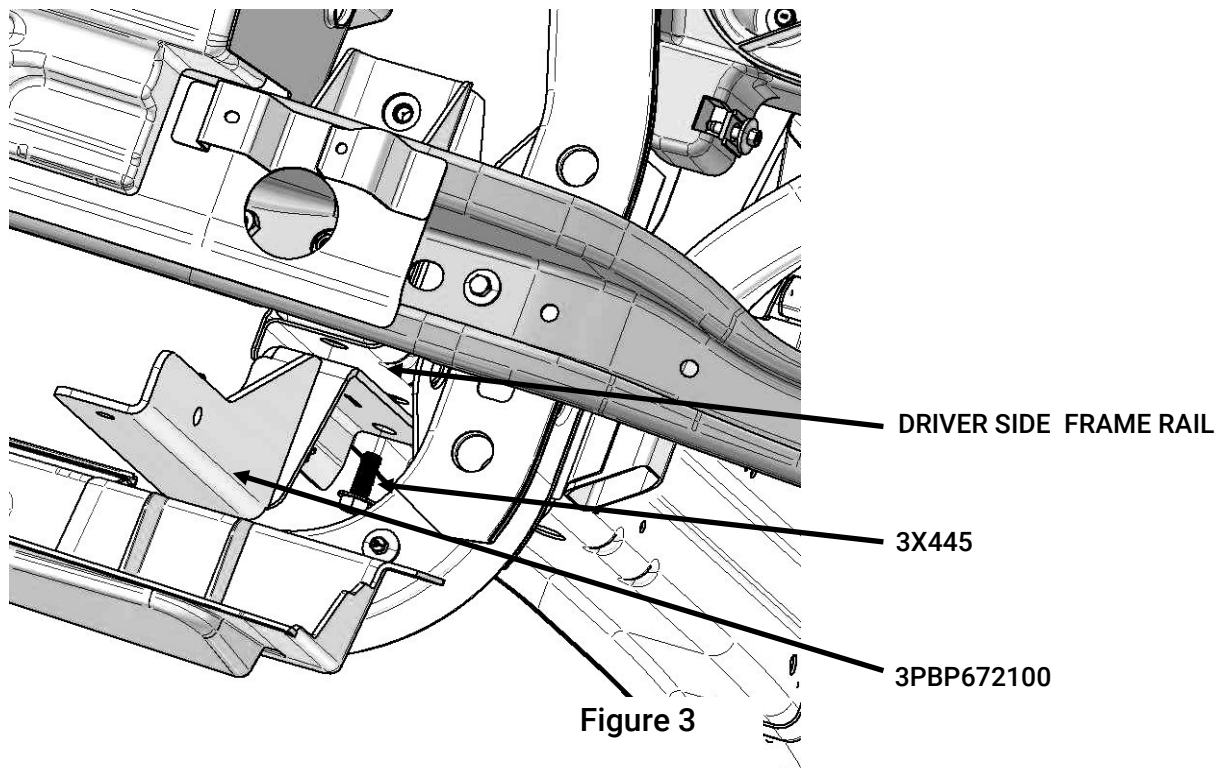

Figure 3

- C. Install upper mounting brackets by removing OEM bolts on the front bumper beam and re-use to fasten bracket [3PB6718-08D]. (Fig. 4)
- D. Repeat for passenger side upper bracket [3PB6718-08P].
- E. Trim fascia to allow upper and lower brackets to protrude through. (see last page for dimensions)

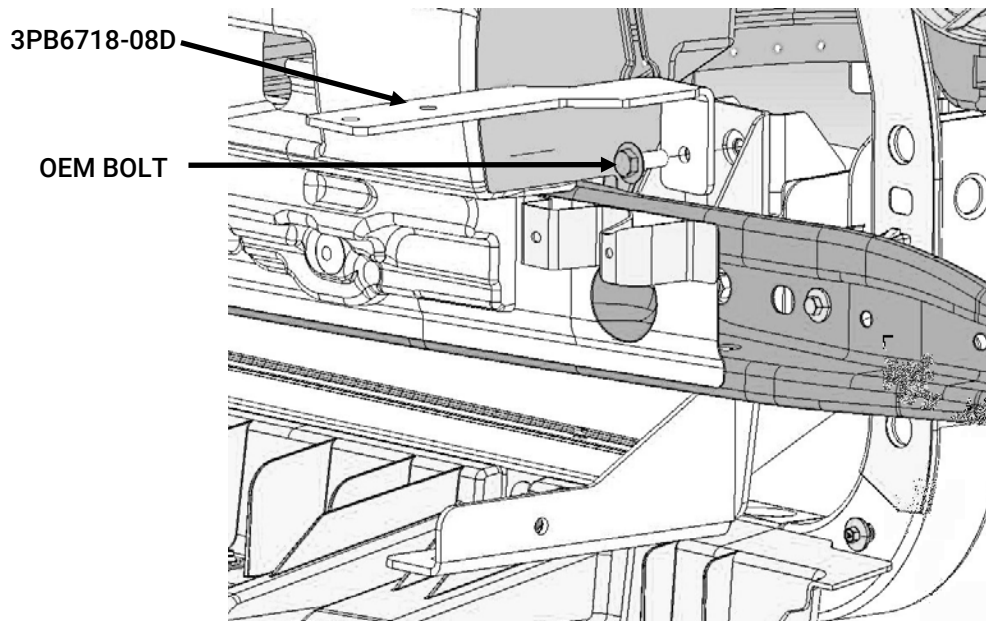

Figure 4

- F. Re-Install the trimmed fascia to the front of the vehicle ensuring that the upper and lower mounting points protrude through. (Fig. 5)

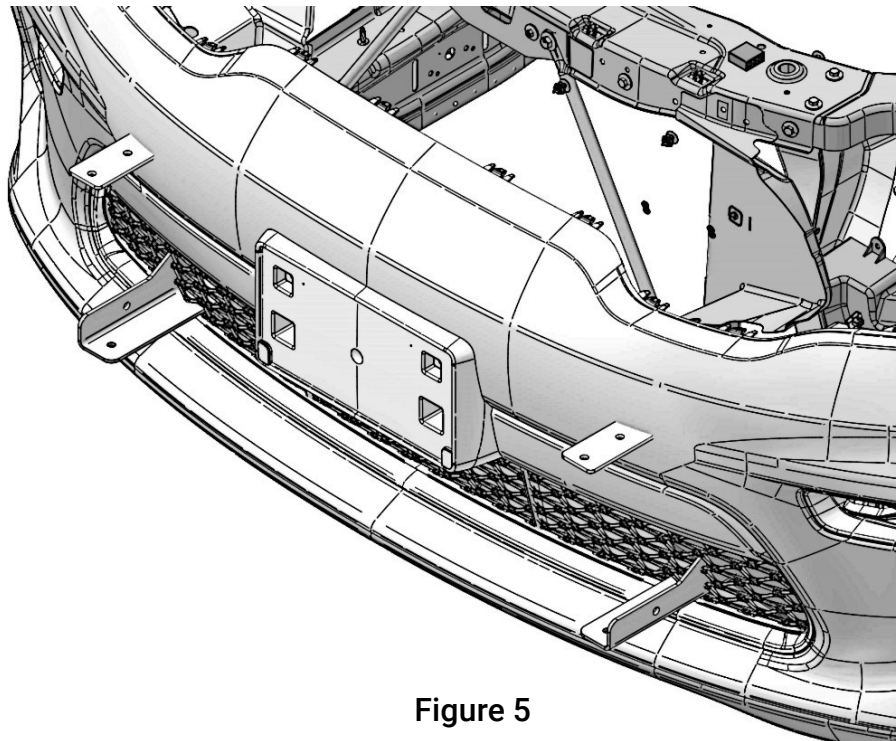

Figure 5

- G. Install upper bracket [3PBP672105] and lower bracket [3PBP672103] to passenger side using (2) hex bolts [3X603] and (2) flange nuts [3X601]. Leave loose for adjustment. (Fig. 6)
- H. Repeat for driver side upper bracket [3PBP672104] and lower bracket [3PBP672102].

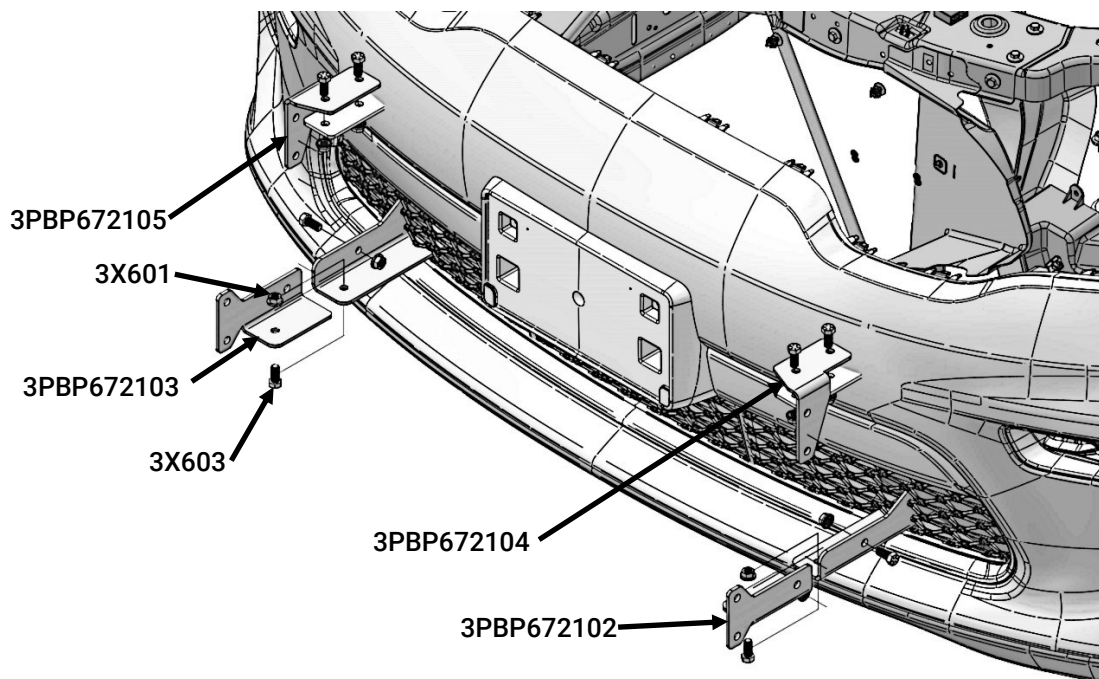

Figure 6

VI. Push Bumper Installation

- A. Lift the push bumper [4PBDHD] into place aligning the two upper holes of the push bumper with the bracket holes and secure using (4) 3/8-16 bolts [3X603] and (4) serrated flange nuts [3X601]. (Fig. 7)

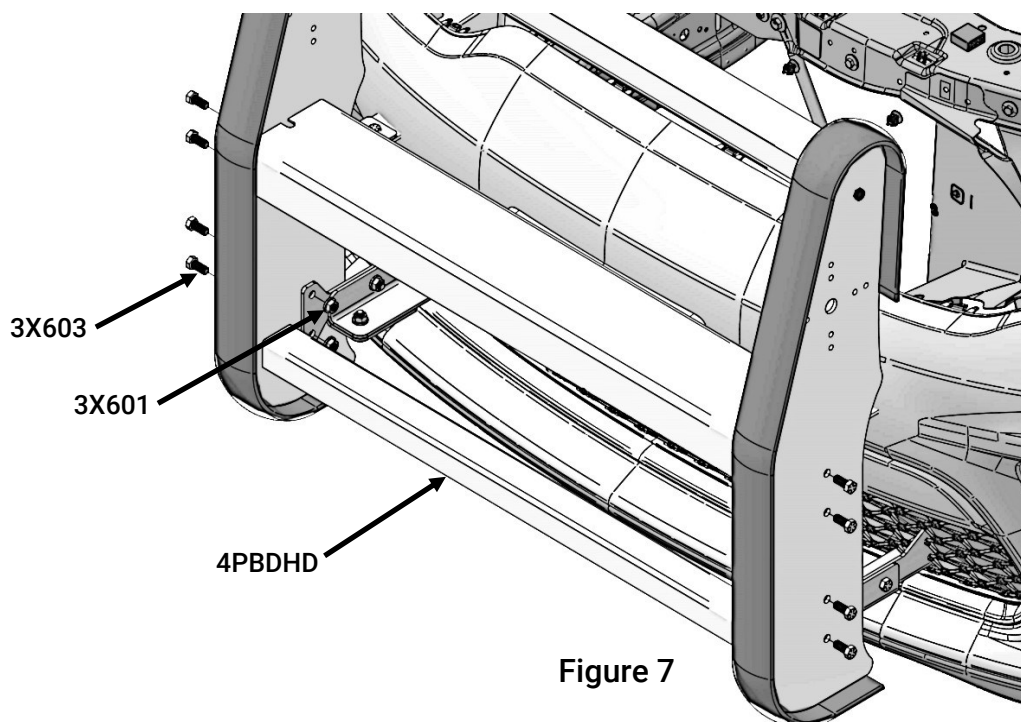
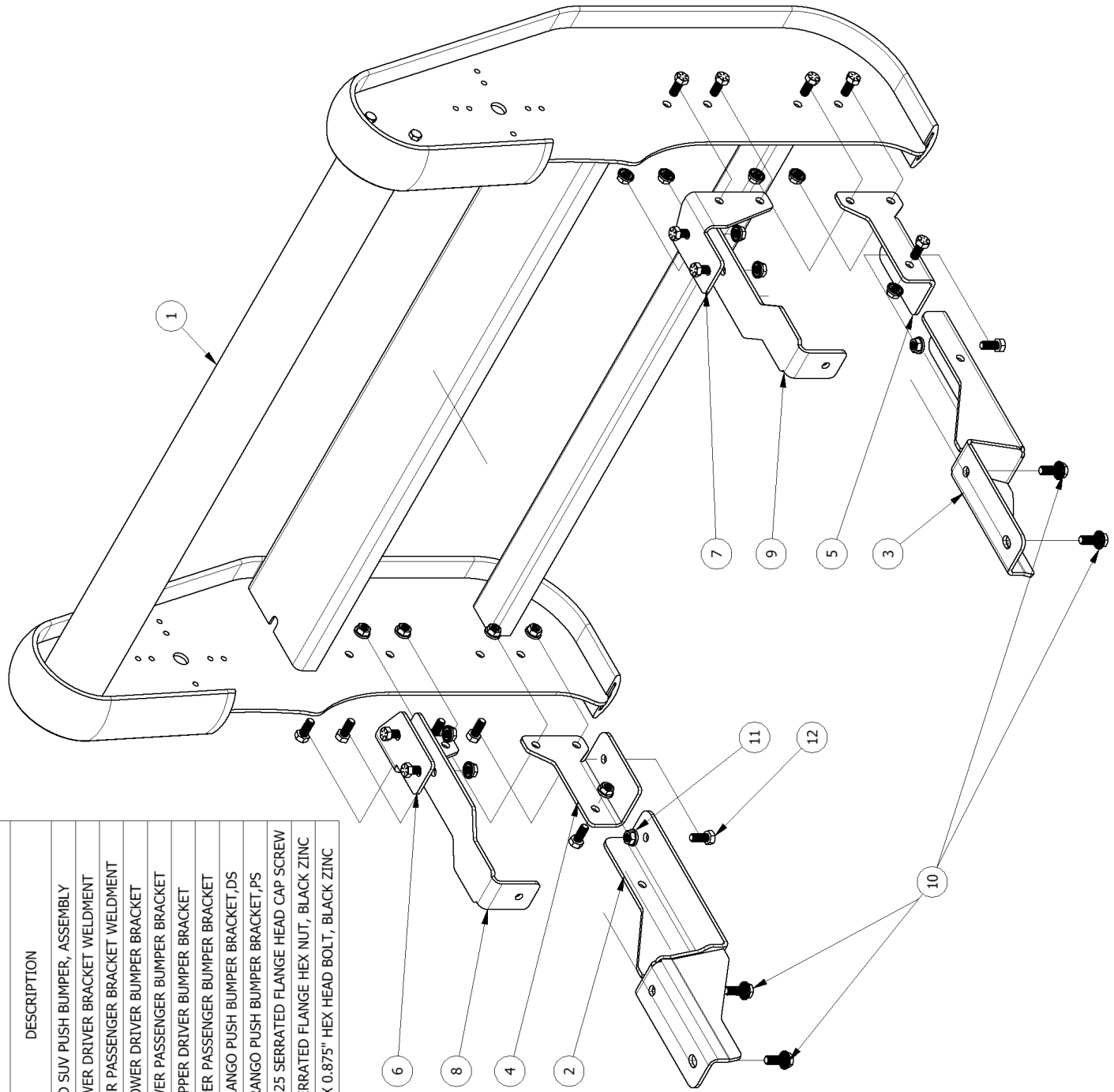

Figure 7

- B. Align push bumper with lower brackets and secure using (4) 3/8-16 bolts [3X603] and (4) serrated nuts. [3X601]. (Fig. 7)
- C. After adjusting push bumper, tighten all fasteners and ensure that push bumper is properly secured.

Installation complete

PARTS LIST			
ITEM	QTY	PART NUMBER	REVISION NUMBER DESCRIPTION
1	1	4PBDHD	A HD SUV PUSH BUMPER, ASSEMBLY
2	1	3PBP672100	A LOWER DRIVER BRACKET WELDMENT
3	1	3PBP672101	A LOWER PASSENGER BRACKET WELDMENT
4	1	3PBP672102	A LOWER DRIVER BUMPER BRACKET
5	1	3PBP672103	A LOWER PASSENGER BUMPER BRACKET
6	1	3PBP672104	A UPPER DRIVER BUMPER BRACKET
7	1	3PBP672105	A UPPER PASSENGER BUMPER BRACKET
8	1	3PB6718-08D	B DURANGO PUSH BUMPER BRACKET, DS
9	1	3PB6718-08P	B DURANGO PUSH BUMPER BRACKET, PS
10	4	3X445	A M10-1.5 X 25 SERRATED FLANGE HEAD CAP SCREW
11	16	3X601	A 3/8-16 SERRATED FLANGE HEX NUT, BLACK ZINC
12	16	3X603	A 3/8-16 X 0.875" HEX HEAD BOLT, BLACK ZINC



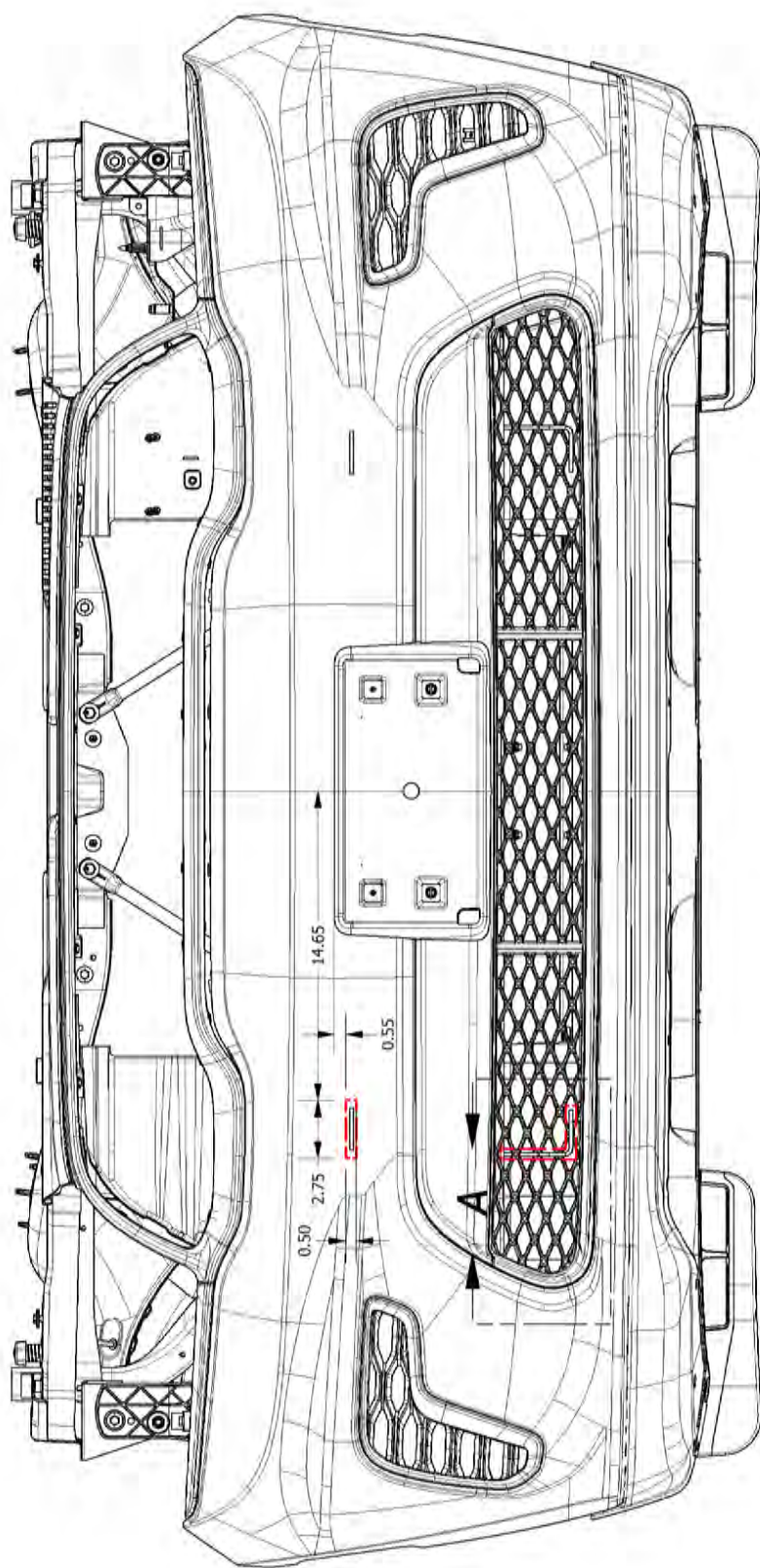

2021 DURANGO FASCIA TRIM LOCATIONS

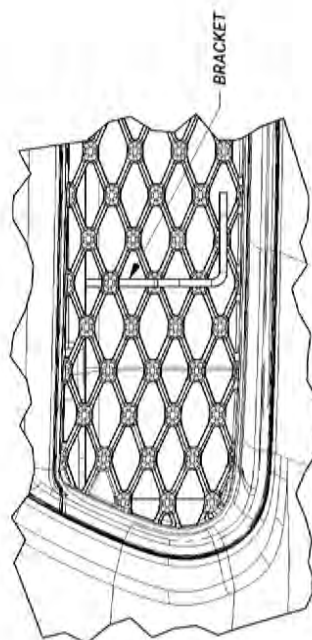

DETAIL A