

4K52I06
INSTALLATION INSTRUCTIONS
2006 - CURRENT CHEVY IMPALA
PARTITION INSTALL

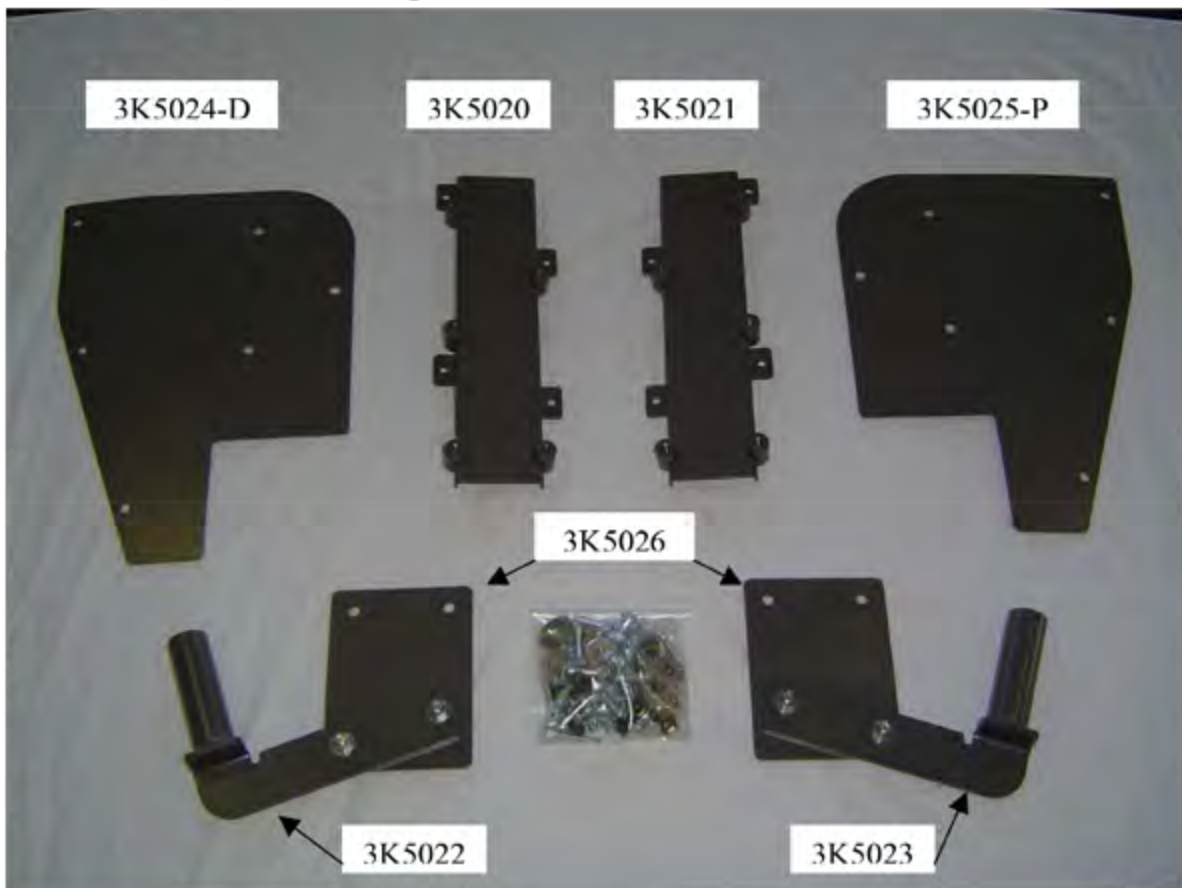

- **BE SURE TO CAREFULLY REVIEW ALL INSTRUCTIONS BEFORE INSTALLATION.**
- **BEFORE DRILLING HOLES INTO THE VEHICLE, BE SURE TO LOCATE ANY BRAKE LINES, FUEL LINES, OR ANY OBJECT THAT MAY BE IN THE WAY**
- **NOT COMPATIBLE WITH SIDE CURTAIN AIRBAGS**
- **PARTITION IS DESIGNED TO BE USED IN '06-'08 CHEVY POLICE IMPALA ONLY**

NOTE: Carefully review the parts list below. If there are any missing parts, please call (317)-579-6680 and ask for "Customer Service" or circle the missing part on this sheet and fax to (317) 579-6681. Be sure to locate important vehicle components: wires, fuel lines, brake lines, etc., before drilling holes



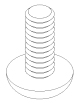

3X36
1/4-20 X 1/2 CARRIAGE
BOLT
(6)

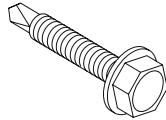

3X110
1/4-14 X 1 SLF DRL,
WASHER HD. ZN
(8)



3X16
1/4-20 WHIZ
WASHER HEX
NUT
(6)

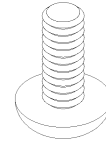

3X149
5/16-18 X 3/4\"
BUTTON
SOCKET HEAD SCREW
(10)

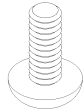

3X61
1/4-20 X 3/4 CARRIAGE
BOLT
(6)

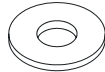

3X12
1/4\"
STANDARD
BLACK FLAT WASHER
(10)



3X16Z
1/4-20 WHIZ
BLACK WASHER
HEX NUT
(6)

Note: Read all instructions carefully before installing the partition.

I. B-Pillar Bracket Installation

- A. Begin by removing the middle B-pillar section. (Fig. 1)
This will be reinstalled after drilling holes into the cover. Use the template provided as a guide for drilling 1" holes. Remove the four material tabs that are located near the top and the bottom of the cover (fig. 2). This will allow the paper template to lie flat on the inside surface (fig. 3). Notice that there are two smaller holes at the top of the template. These holes will align with the two existing material bosses at the top of the cover. See the following

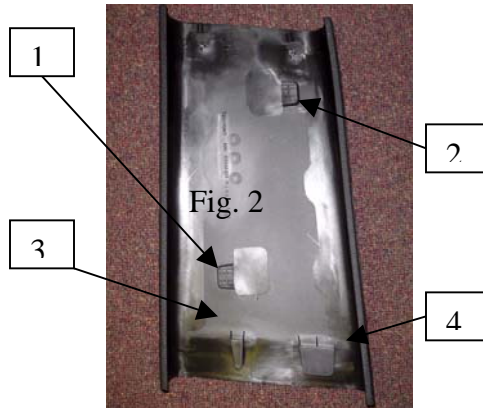

Fig. 4



OEM
Vertical
Slots

Fig. 5



- B. Install the B-pillar bracket (3K5020 driver & 3K0521 passenger). Using the bracket side hooks as guides, insert the bracket into the OEM vertical slots in the b-pillar frame (fig. 4). Once you have inserted the bracket into position, locate the four tabs and secure it with four of the 3X110 self-drilling screws (fig. 5). Repeat on the opposite side. You can now replace the b-pillar covers.





Fig. 6



Fig. 7



Fig. 8

II. Partition Installation

- A. Using the assembled brackets (3K5022/3K5023 and 3K5026), mount them to the lower studs protruding through the b-pillar cover (fig.6). **Mount the bolt to the rear of the vehicle first.** (See fig. 6). Make sure that the brackets are mounted in the same manner on both sides.

- B. You will now insert the partition into the vehicle. Due to the weight and size of the partition, assistance from another party is highly recommended. Insert the partition tubes onto the tubes of the brackets you just installed. (See fig. 7) Now, you can easily lift and position the partition so that the other bolt can be inserted into the stud toward the front of the vehicle. Once the partition is set into position, install the mounting plates: 3K5024 driver & 3K5025 passenger, using the 3X149 button head bolts and 3X12 flat washers. To mount the partition to the rear of the plate, use the 3X61 carriage bolts and the 3X16 whiz nuts. **(See fig. 8)**

Fig.9

Optional Components

These are the optional components also available for the '06-'08 Impala partition

SP52FW06 Full width seat protector

SP52BS06 Bucket Seat Protector

RP52I06 Recessed Panel Kit (space-saver panel)

IF YOU HAVE ANY QUESTIONS OR CONCERNS PLEASE CONTACT

PRO-GARD PRODUCTS, LLC
PHONE: 317-579-6680