

INSTALLATION GUIDE
P1000RT18A
P1000 PRO-CELL
2018 - CURRENT DODGE RAM 1500 SSV TRUCK

Pro-gardTM
PRODUCTS LLC.

STRONG. RELIABLE. SECURE.

**THESE COMPONENTS ARE REQUIRED
TO INSTALL THE PARTITION**

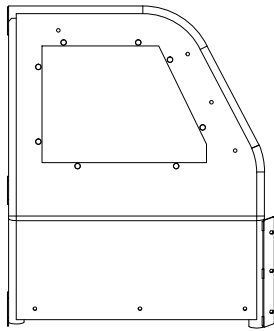

4P1000RAM
1/2 Cage Partition

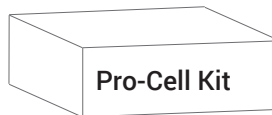

4PK1000RT18

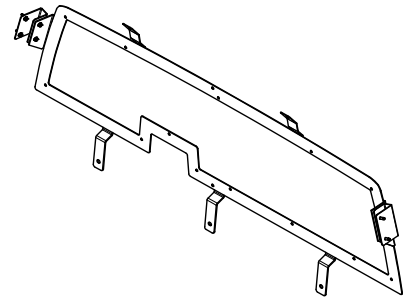

RWG59RT18
Window Guard



4WK5918RTA-P

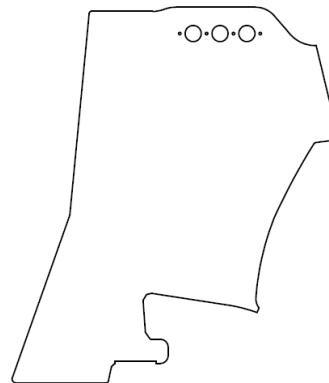

3P5918
Divider

I. The following tools will be required to complete the installation.

- A. 7/16" Socket & Ratchet
- B. 7/16" Open ended Wrench
- C. 3/16" Allen Wrench
- D. 3/8" Socket & Ratchet
- E. 3/16" Drill Bit
- F. 1" Hole Saw & Drill Bit
- G. 5/16" Drill Bit

II. Read all instructions carefully before starting the assembly process.

WARNING: *Locate All wiring, fuel lines, brake lines, coolant lines, or refrigerant lines before drilling any holes or installing any self-drilling fasteners.*

III. Install B-pillar Bracket

- A. Locate and remove the lower part of the B-pillar trim to access the sheet metal body (Fig. 1).
- B. After the trim is removed, locate B-pillar bracket 3PRT5918-01P and mark the 4 holes to drill pilots with 3/16" drill bit. The B-pillar bracket flanges wrap around the pillar and is located vertically by the bracket tab and B-pillar cut-out (Fig. 2). Secure the B-pillar brackets to the driver & passenger sides of the vehicle with the self-tapping screws (3X162) (Fig. 2).

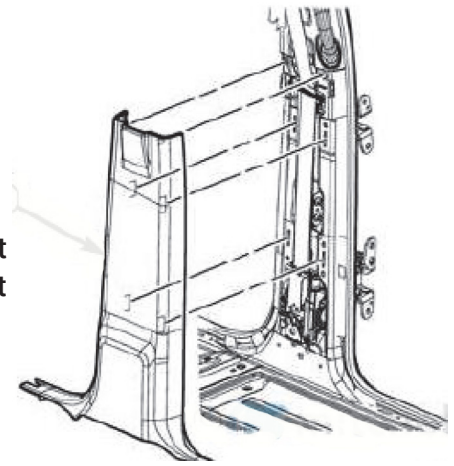

Fig. 1

- C. Use the supplied B-pillar templates on the last page to mark the three holes in the B-pillar trim and drill out the 1" holes so the standoffs can fit through and re-install the trim.

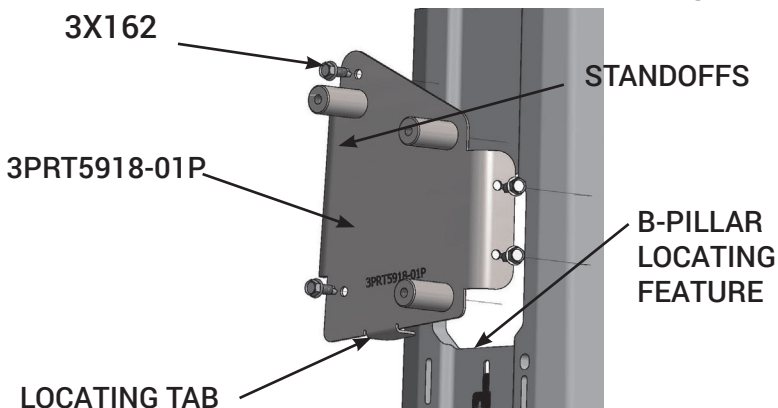

Fig. 2

IV. Install Partition Mounting Plate

- A. When B-pillar bracket installation is complete and the trim is re-installed, then the partition mounting plate (3PK5918-03P) can be installed.
- B. Use three (3X149) screws to bolt the passenger side panel into place leaving bolts loose until the partition is installed. (See Fig. 3)

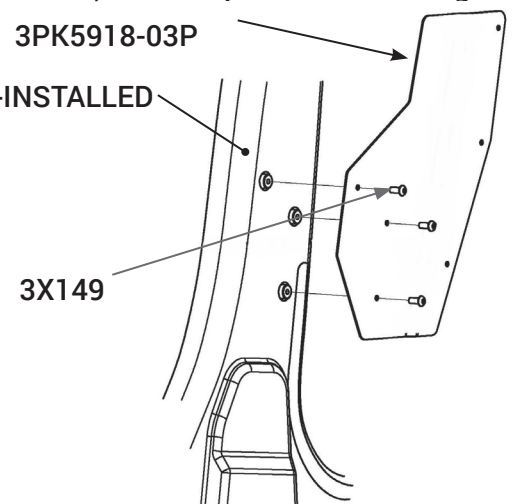

Fig. 3

V. Install Seat Protector

- A. Loosen the back OEM bolts of the passenger seat rails, then push and lift on backside of the seat to slide the (3SP5918-01) seat protector floor bracket underneath the seat aligning the slots with the OEM bolts before tightening them back in place. (See Fig 4)
- B. Attach (3SP5918-02) seat protector from the backside of the partition. Align lower mounting holes and bolt together with (3X36) and (3X16Z) whiz nuts. (See Fig. 5)

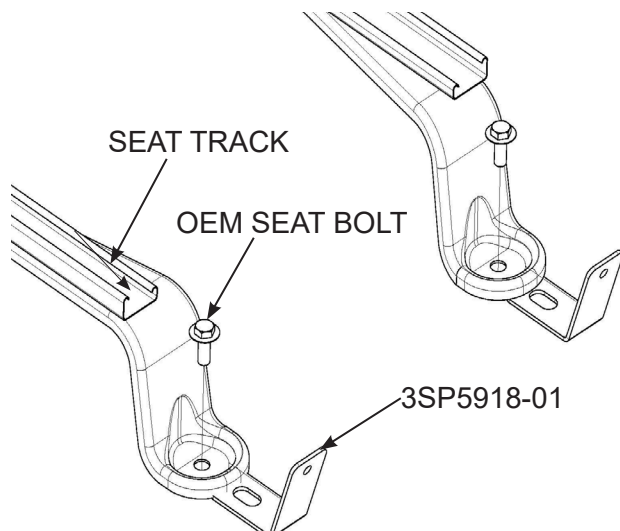

Fig. 4

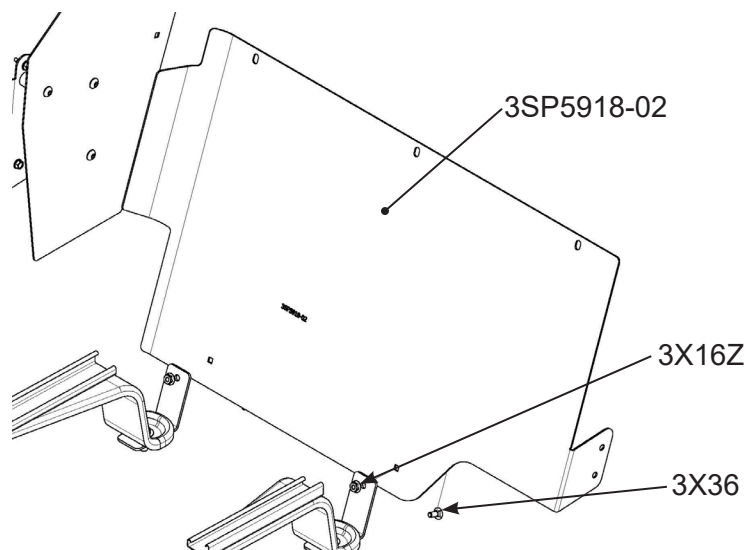

Fig. 5

VI. Install Partition

- A. Place the (4P1000RT18) half cage partition in the vehicle and bolt (3X36) screws and (3X16Z) whiz nuts to partition mounting plate on the passenger side and the seat protector panel. (See Fig. 6) Make sure to lift the partition tight to ceiling while securing the bolts.

VII. Install Rear Window Guard

- A. Remove rear seats.
- B. Remove rear C-pillar trim on both sides
- C. Remove and retain fasteners from plastic clip at headliner and cable loop hardware below back window. Five fasteners total. (Fig. 7)
- D. Pull out wiring harness retaining clip and locate C-pillar bracket (3RWG5918-08) as shown in Fig. 8.

Vertically, bracket is 1/4" from the top of the shoulder sash guide anchor point. Fore and aft the front bracket edge is and aligned with the vertical feature embossed area near door.

Bracket will be roughly parallel with back window.

Fasten by driving self-tapping screws (3X162) into C-pillar sheet metal.

Bracket provides material to drive self-tapping screws for final window frame fastening at both C-pillar sides after trim is re-installed.

- E. Fasten rear center bracket (3RWG5918-04) to frame using socket head cap screw (3X184) and nut (3X16Z). (See Fig. 9)

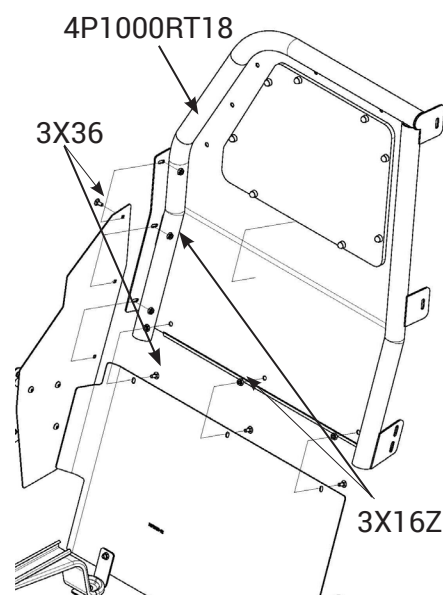

Fig. 6

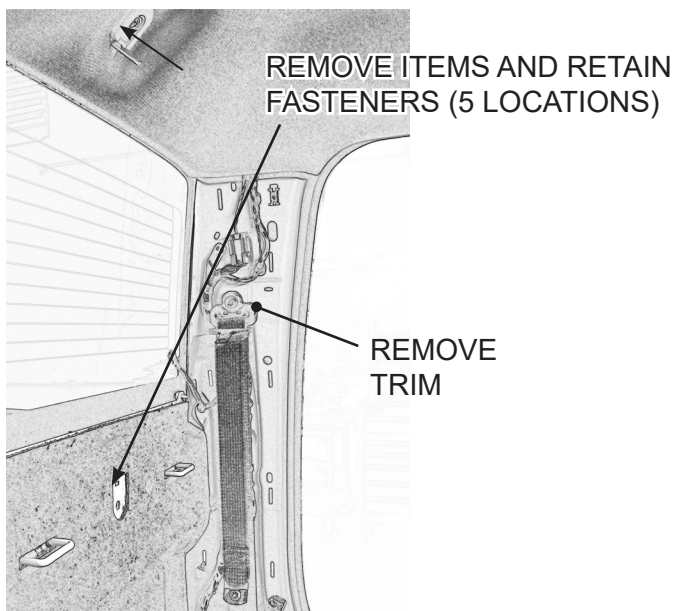

Fig. 7

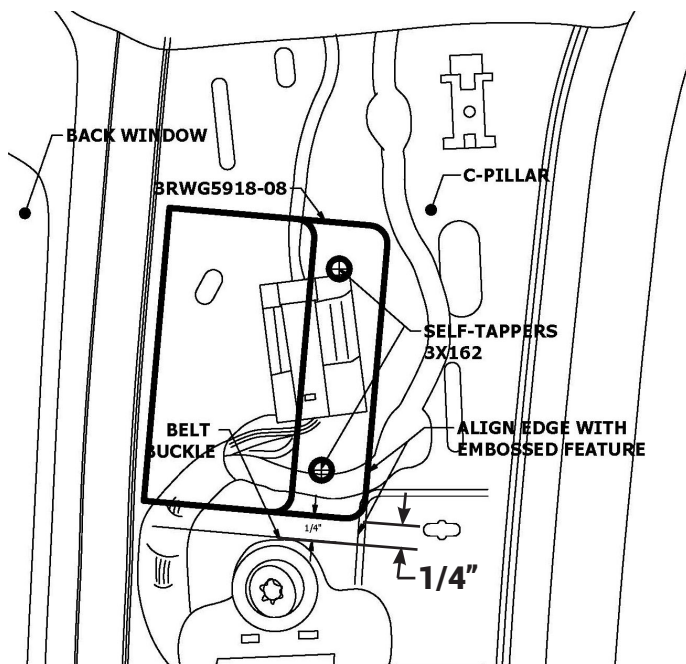

Fig. 8

F. Locate rear window frame (3RWG5918-01) by aligning to OEM threaded mounting holes and fasten at upper and lower locations using OEM bolts. (Fig. 10)

G. Push wiring into C-pillar pocket and secure where needed.

H. Return C-pillar trim to both sides.

I. Finish fastening frame by driving self-tappers (3X162) through trim and into C-pillar bracket. (Fig. 10)

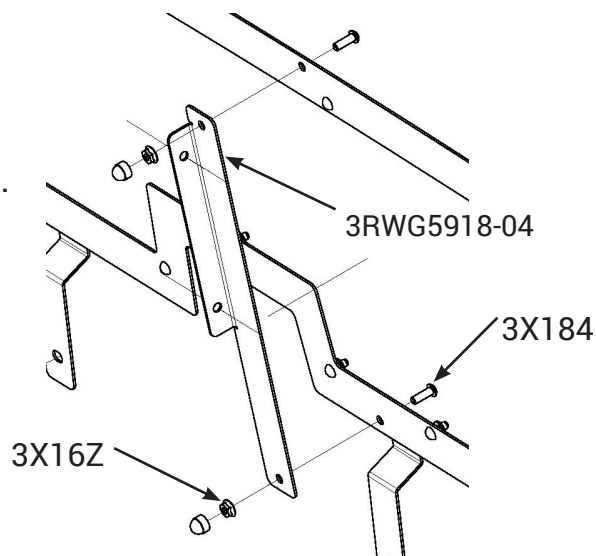

Fig. 9

PILLAR TRIM (NOT SHOWN HERE) BUT MUST BE RE-INSTALLED BEFORE THIS STEP

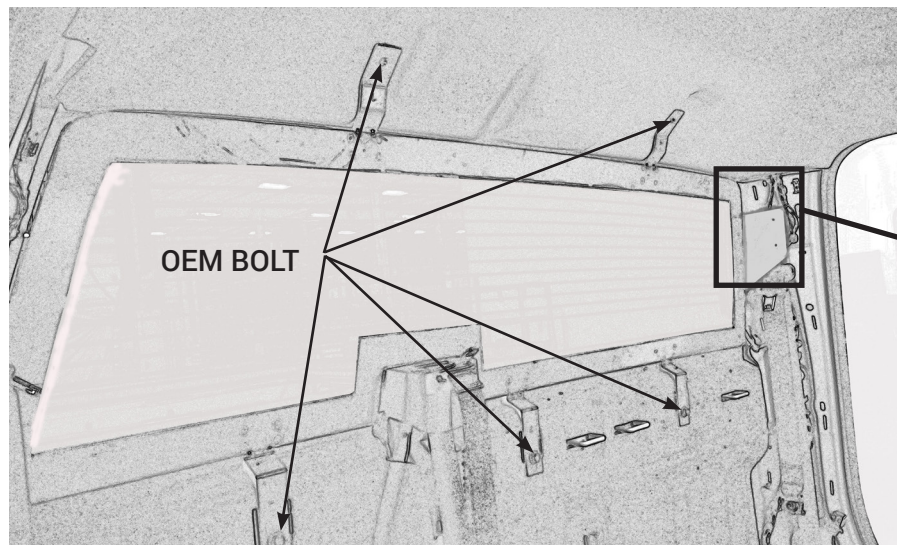
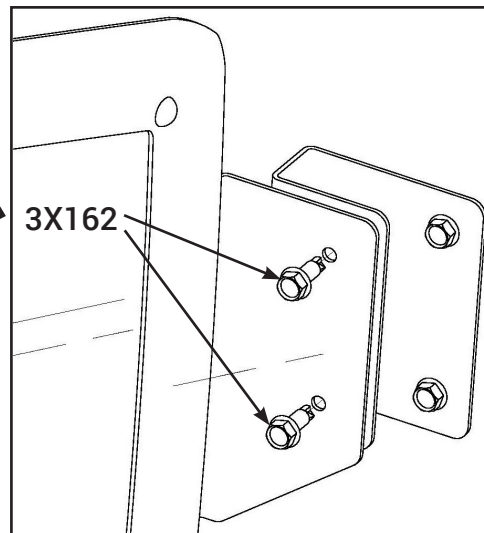
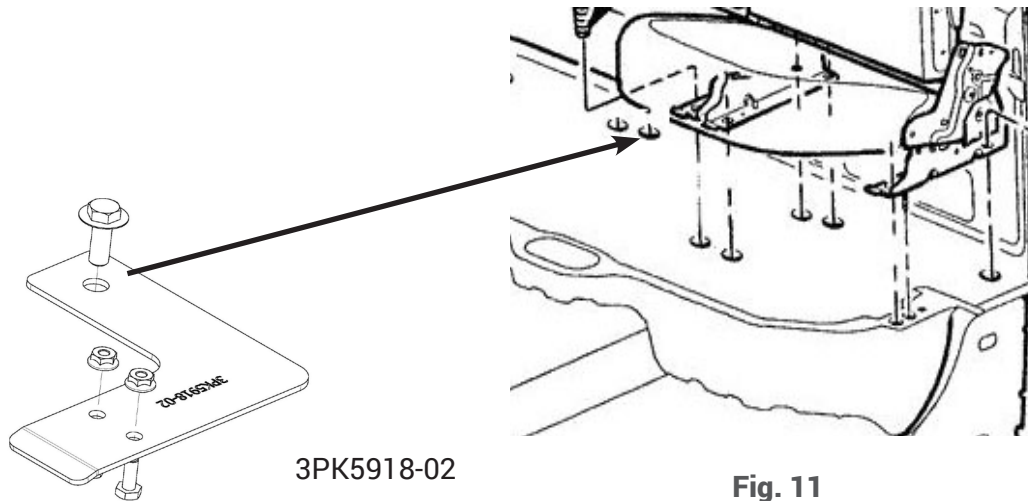

Fig. 10



VII. Install Divider

- A. Place lower rear floor bracket (3PK5918-02) on floor. insert hex head bolts (3X04) underneath and start nuts (3X16Z) 3-4 threads. Align 1/2" mounting hole with first threaded hole left of center (passenger side) and fasten with OEM bolt (Fig. 11).



- B. Return seats with seat folded up.

- C. Insert lower seat mounting bracket (3PK5918-01) in between seat and seat back. Bracket slots should be aligned with the floor bracket bolts assembled in the previous step (Fig. 12).

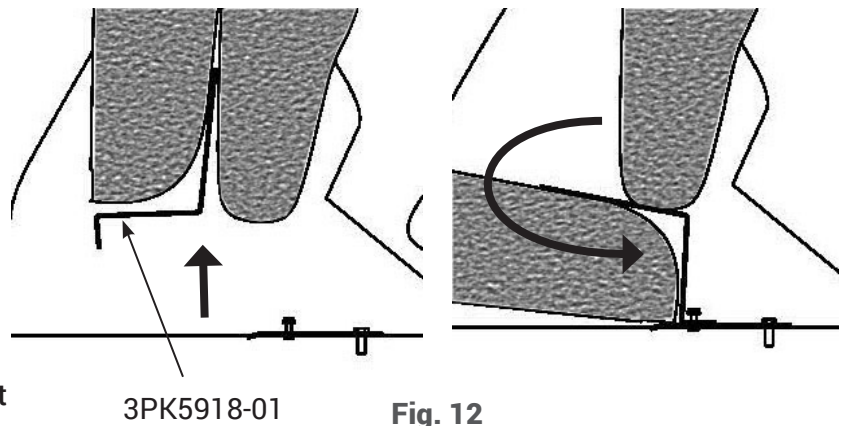

- D. Fold seat down while verifying alignment of seat and floor bracket. While folding, the inserted seat bracket slots will cam into the upright bolts of the floor bracket. Assure slots have engaged bolts, then tighten nuts.

- E. Insert 2 bolts (3X04) under seat bracket just installed, place angle bracket (3PK8116-11) over bolts and assemble with whiz nuts (3X16Z) (Fig. 13)

- F. Attach vent plate (3P8010) to the divider (3P5918) as shown in Fig. 14 using the supplied spacers, bolts, and nuts.

- G. Insert the divider assembly through the passenger side door and place in position. Examine the alignment of the profile and adjust to fit.

- H. Hold the divider securely and mark hole locations at the bracket mounting points. Drill 5/16" thru holes and insert (3X82) screws and (3X16Z) whiz nuts. Tighten all divider bolts to secure in position. (Fig. 15)

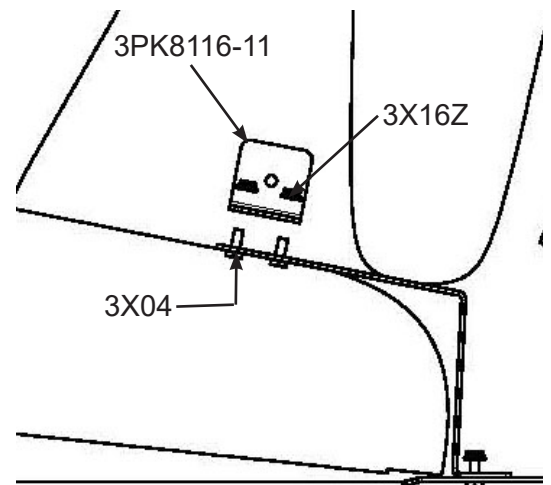

Fig. 13

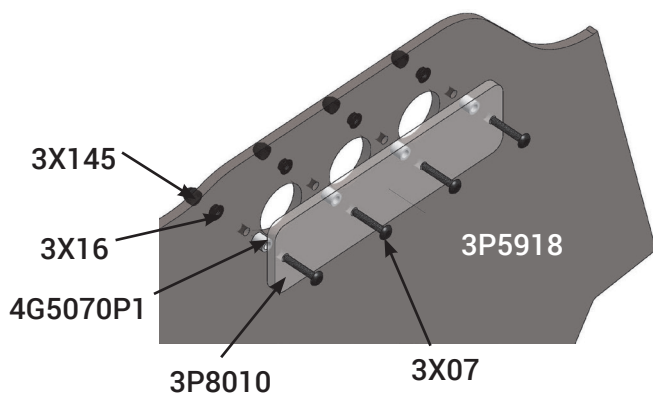

Fig. 14

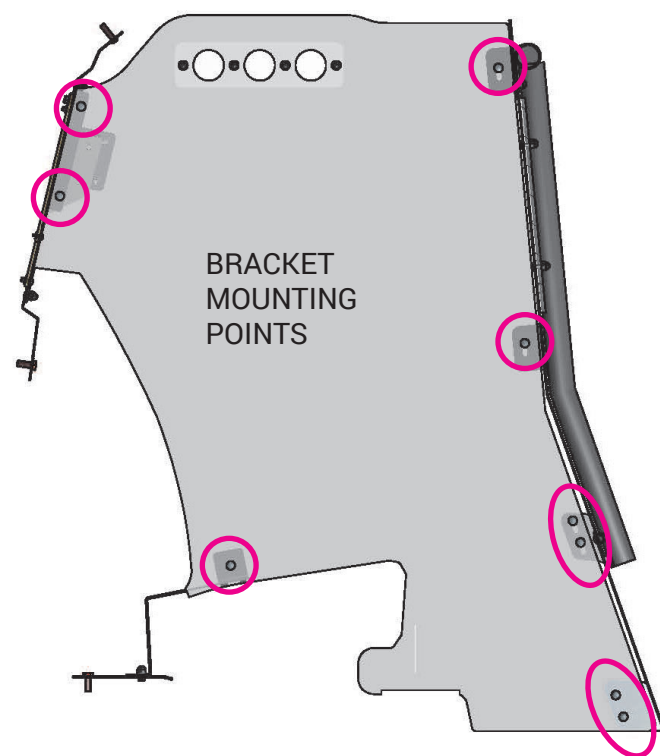

Fig. 15

IX. Install Wings and Headliner

A. Assemble all 3P928 Wing Mounting Brackets to the 4W5918-P wing by placing the long leg of the bracket against the inside surface of the wing so the bracket wraps around the edge of the wing. Start the 3X92 (1/2") bolts from the opposite side of the wing and out through the bracket so the 3X16Z nut will tighten against the bracket. (Fig. 16)

B. When complete, mount the assemblies to the front side of the partition with the remaining 3X92 bolts and 3X16Z nuts. Be sure the wing is free to flex inward toward the center of the vehicle. (Fig. 16)

C. Install the Headliner Wing (3PK5918-04) as shown (Fig. 16)

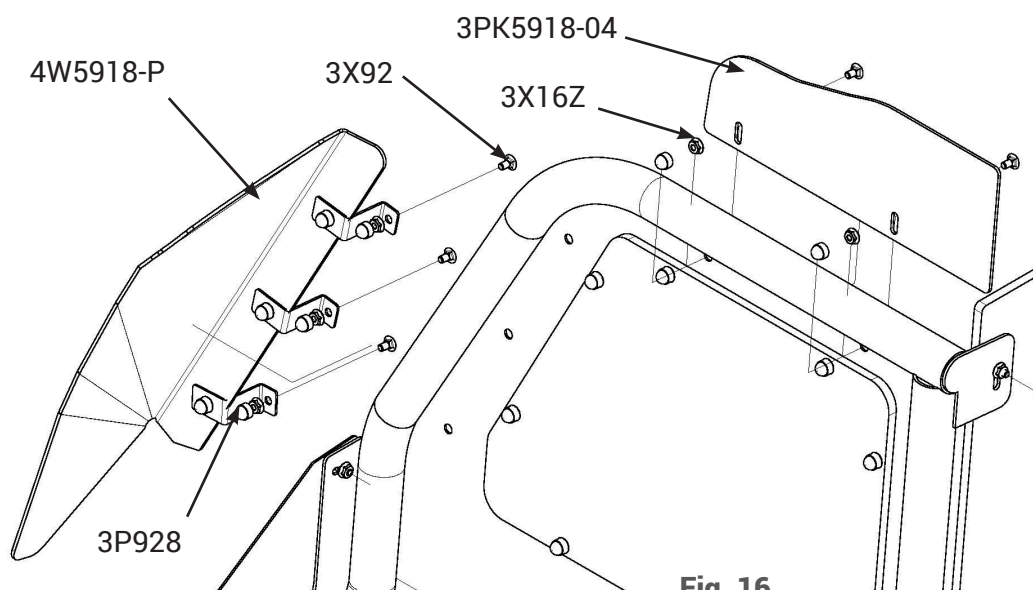

Fig. 16

X. Finish

A. Place (3X145) black plastic caps on all exposed nuts to finish installation.

Installation complete!

If you have any problems with this installation then call the toll free number (800-480-6680) and ask for technical assistance.

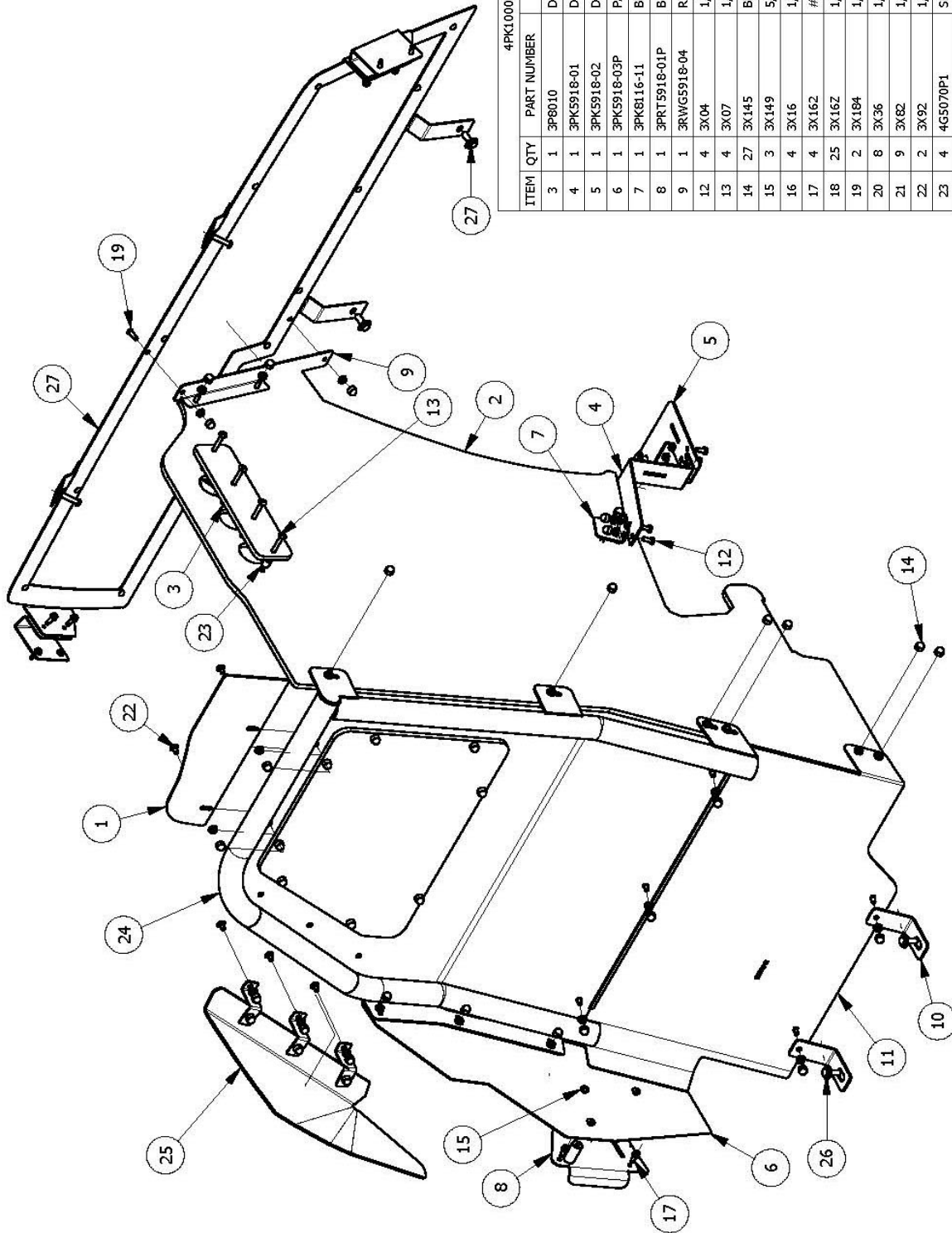

4PK1000RT18 PRO CELL KIT			DESCRIPTION
ITEM	QTY	PART NUMBER	
3	1	3P8010	DIVIDER VENT PLATE
4	1	3PK5918-01	DIVIDER SEAT MOUNTING BRKT
5	1	3PK5918-02	DIVIDER FLOOR MOUNTING BRKT
6	1	3PK5918-03P	PARTITION MOUNTING PLATE, PS
7	1	3PK8116-11	BRACKET ANGLE DIVIDER F150
8	1	3PRT5918-01P	B-PILLAR BRACKET, PASSENGER SIDE
9	1	3RWG5918-04	REAR CENTER BRACKET RAM
12	4	3X04	1/4-20 X 5/8" HHMS, BLK
13	4	3X07	1/4-20 X 1-1/2 PHIL TRUSS HD MS
14	27	3X145	BLACK PLASTIC CAP
15	3	3X149	5/16-18 X 3/4 BSHCS, BK
16	4	3X16	1/4-20 WHIZ NUT
17	4	3X162	#14 X 3/4" SELF DRILLING HEX HEAD SCREW
18	25	3X16Z	1/4-20 WHIZ NUT
19	2	3X184	1/4-20x0.75, SHCS, BLACK OXIDE
20	8	3X36	1/4-20 X 5/8 CARRIAGE BOLT
21	9	3X82	1/4-20 X 1 CARRIAGE BOLT
22	2	3X92	1/4-20 X 1/2 CARRIAGE BOLT
23	4	4G5070P1	SPACER, DIVIDER VENT PLATE

ADDITIONAL PARTS			DESCRIPTION
ITEM	QTY	PART NUMBER	
1	1	3P5916-04	HEADLINER WING
2	1	3P5918	PRO-CELL DIVIDER RAM 18
10	2	3SP5918-01	PRO-CELL SEAT PROTECTOR FLOOR BRACKET
11	1	3SP5918-02	PRO-CELL SEAT PROTECTOR
24	1	4PK1000RT18	PARTITION PRO-CELL RAM 18
25	1	4WK5918RTA-P	PRO-CELL WING KIT RAM 18
26	3	OEM BOLT	DODGE OEM BOLT
27	1	RWG59RT18	REAR WINDOW GUARD RAM 18

TRIM PANEL TEMPLATE FOR PARTITION INSTALL ON 2013+ DODGE RAM PASSENGER SIDE

CHECK SCALE



SELECT "NONE" FOR PAGE
SCALING WHEN PRINTING
FROM .pdf FILE

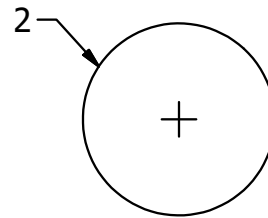
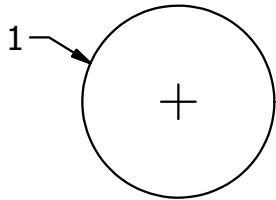

- A. CUT OUT CROSS HATCHED
AREAS AND ALONG DASHED LINES
- B. LINE UP CUT OUTS WITH
TABS ON TRIM PANEL
- C. CENTER PUNCH THREE HOLE
LOCATIONS THRU TEMPLATE &
DRILL/CUT 1" DIA HOLE

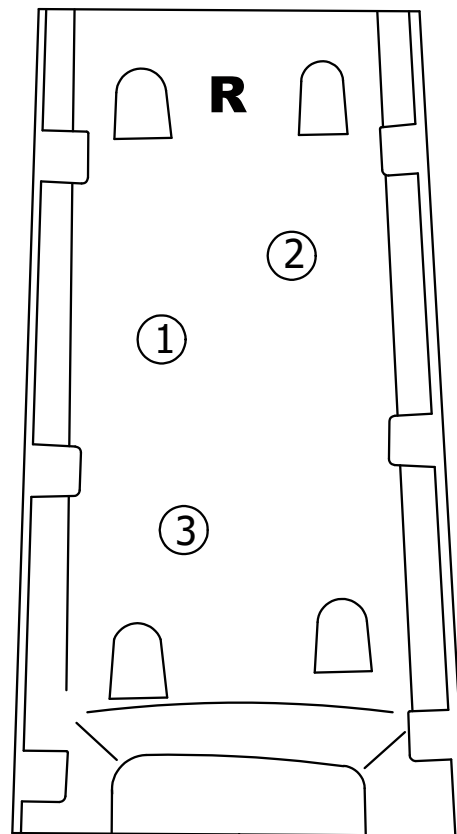
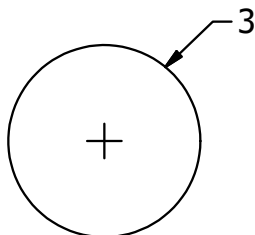

View from rear
of B-Pillar Trim