

INSTALLATION GUIDE

**2021+ F-150 SuperCrew
P1000 PRO-CELL
P1000FT21A**

Pro-gardTM
PRODUCTS LLC.

STRONG. RELIABLE. SECURE.

**THESE COMPONENTS ARE REQUIRED
TO INSTALL PARTITION**

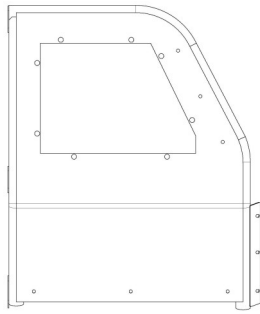

4P1000T15

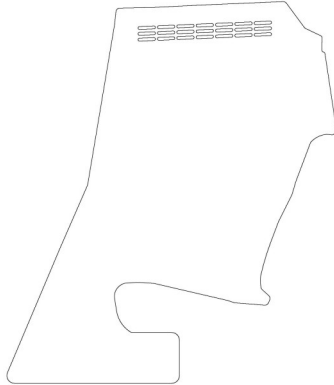

3DIV812100

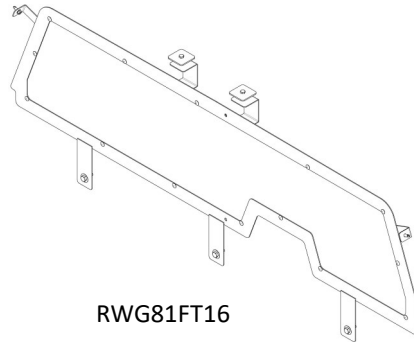

RWG81FT16



4PK1000FT16



Wing Kit

4WIK812100

I. The following tools will be required to complete the installation

- | | | |
|-----------------------|----------------|-----------------------|
| A. 3/16" drill bit | C. 3/8" socket | E. 7/16" Socket |
| B. 3/16" Allen Wrench | D. 1" hole saw | F. Trim removal tools |

II. Read all instructions and refer to last page to ensure all parts were received.

WARNING: *Locate All wiring, fuel lines, brake lines, coolant lines, or refrigerant lines before drilling any holes or installing any self-drilling fasteners.*

III. B-Pillar Bracket Installation

- Locate and remove the lower part of the B-pillar trim to access the sheet metal body.
- Locate the B-pillar bracket [3P8116P]. Rearward flanges will wrap around B-pillar and top of bracket will be up against the upper trim (Figure1).
- Drive in (4) self-tapping screws [3X162]. If required, use a 3/16" drill bit for pilot hole.

IV. B-Pillar Trim Modification and Re-installation

- Use the template supplied on the last page to mark the three hole locations in each of the trim panels.
- Using 1" hole saw, drill the holes marked in the previous step.
- Re-install the B-pillar trim.

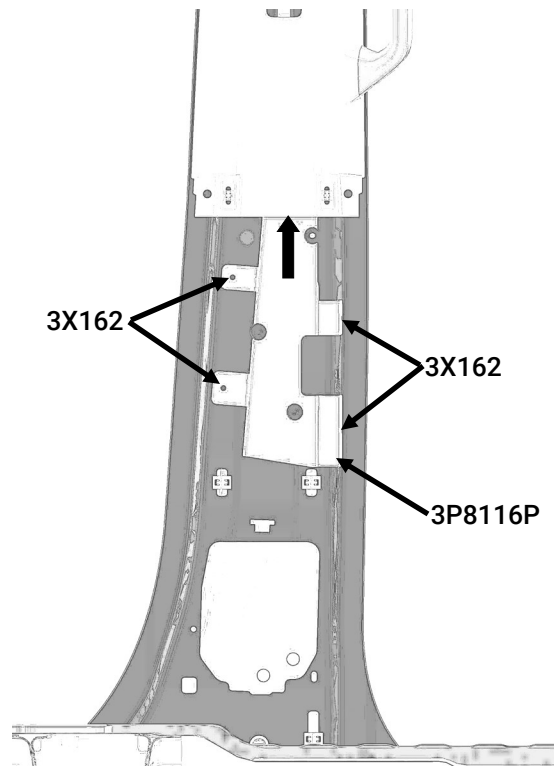

Fig. 1

V. Mounting Plate Installation

- A. Locate passenger mounting plate [3PK8116-02P] aligning the (3) plate holes the (3) standoffs protruding through the B-pillar trim and loosely fasten with (3) 5/16-18 button head screws [3X149] (Figure 2).

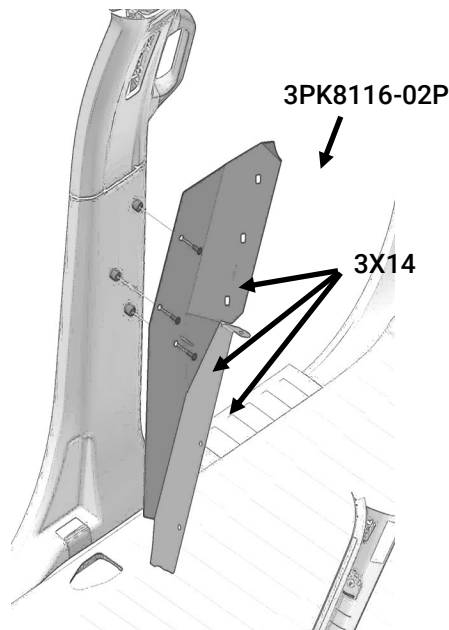

Fig. 2

VI. Install Center Bracket and Partition

- A. Loosen back the two OEM bolts at the rear of the center console, then push and lift on backside of the console to slide center bracket [3PK8116-14] to engage console bolts, then tighten. (Figure 3)
- B. Place the partition [4P1000T15] into vehicle and fasten to mounting plate using [3X36] screws and [3X16Z] whiz nuts. (Figure 4) NOTE: Partition window portion will be at an angle of approximately 10 degrees.
- C. Fasten partition to center support [3PK8116-14] using [3X82] screws and [3X16Z] whiz nuts. These fasteners will be removed when installing the divider.

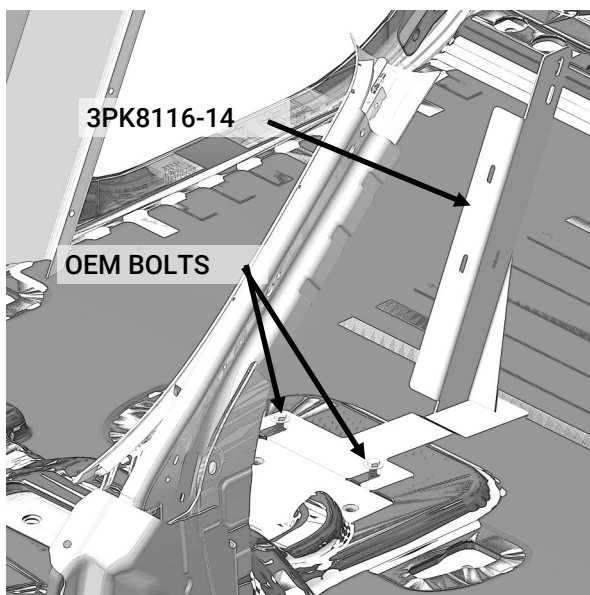

Fig. 3

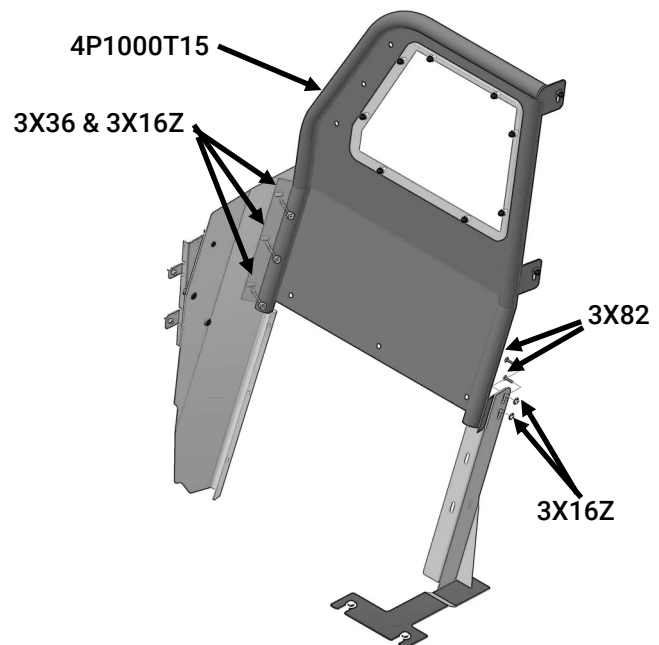

Fig. 4

VII. Lower Extension Panel

- A. Install lower extension panel [3SP8116-01] to backside of partition and fasten to partition, center mounting bracket and partition mounting plate using (8) [3X36] carriage bolts and (8) [3X16Z] whiz nuts. (Figure 5)

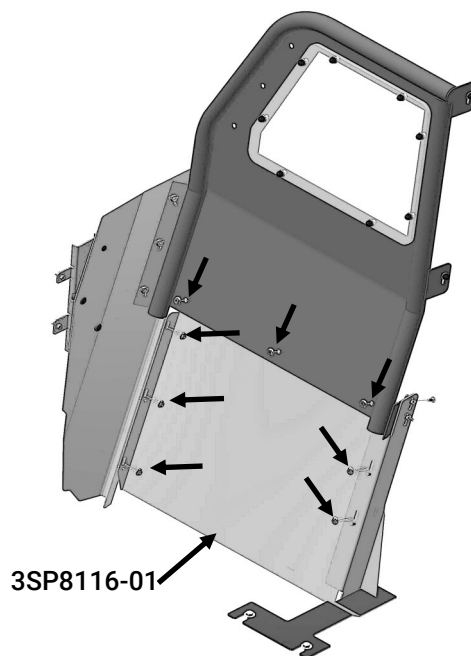

Fig. 5

VIII. Window Guard and Seat Bracket Installation

- A. Remove rear seats and install the rear window guard [3RWG8116] per instructions provided. (Figure 6)
- B. Install seat bracket [3PK8116-10] by inserting it between the rear seat and seatback and fasten to the floor using the OEM seat stud. (Figure 6)
- C. With seat returned and seatback up, fasten divider angle bracket [3PK8116-11] using (2) 1/4-20 x 5/8" machine screws [3X04] against seat and up through bracket and (2) 1/4-20 whiz nuts [3X16Z] (Figure 7)

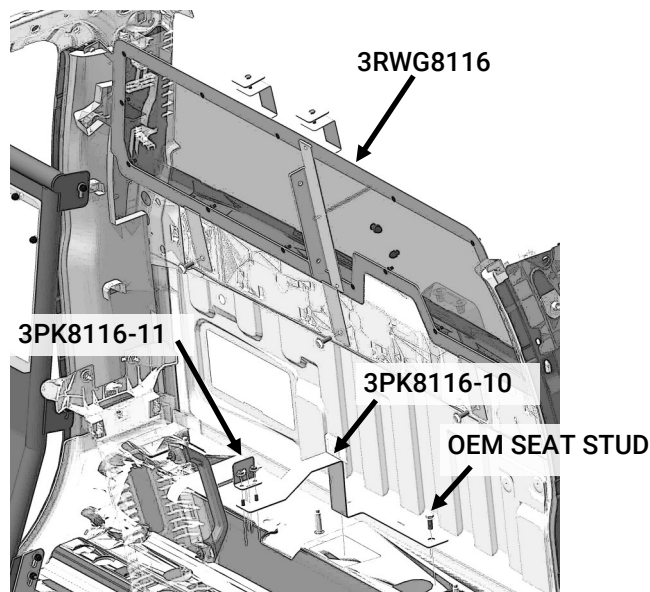

Fig. 6

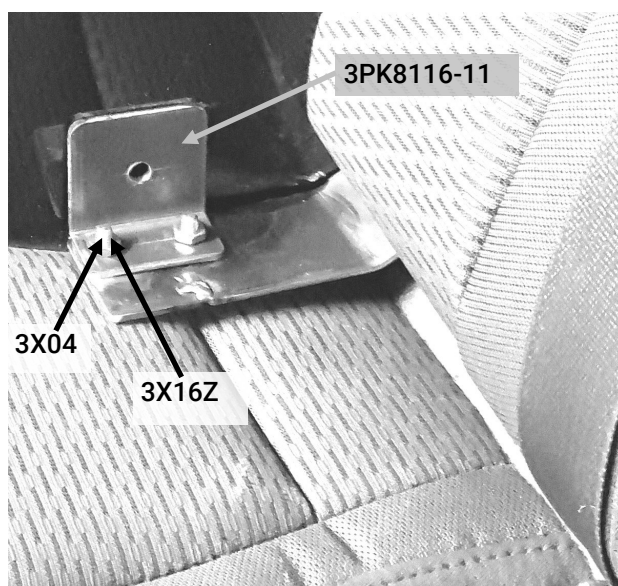

Fig. 7

IX. Partition Adjustment

- A. Adjust the partition forwards or backwards until in position. Tighten the (3) fasteners holding the partition to the mounting plates using a 7/16" socket. These are the fasteners that were loosely installed in section "VI, step C".
- B. Have a second person push forward on the top of the partition while the first person uses a 3/16" Hex wrench to tighten the (3) button head screws holding the mounting plates to the B-pillar brackets. These are the fasteners that were loosely installed in section "V, step C". This step will slightly rotate the partition causing it to fit tighter against the headliner.
- C. Adjust the Lower Extension Panels to achieve the desired fitment and then tighten all the relevant fasteners using a 7/16" socket.

X. Install Divider

- A. Insert divider [3DIV812100] through passenger door and position.
- B. Examine alignment of the profile and adjust to fit.
- C. Transfer drill through bracket mounting holes and divider at the (7) locations shown (Figure 8)
- D. Fasten using [(7) 3X82] screws and (7) [3X16Z] whiz nuts.

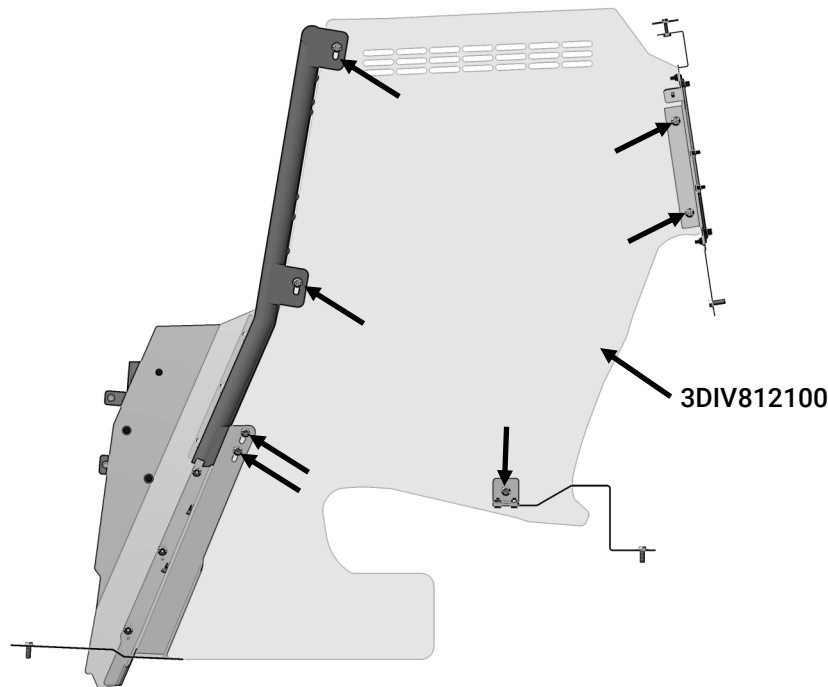

Fig. 8

XI. Finishing Steps

- A. Ensure all fasteners are tight and all panels secure.
- B. Install the wings according to the instructions included with them.
- C. Place plastic caps [3X145] over all fasteners protruding from the partition.

Installation complete

If you have any problems with this installation or have any questions please call (800-480-6680) and ask for technical assistance.

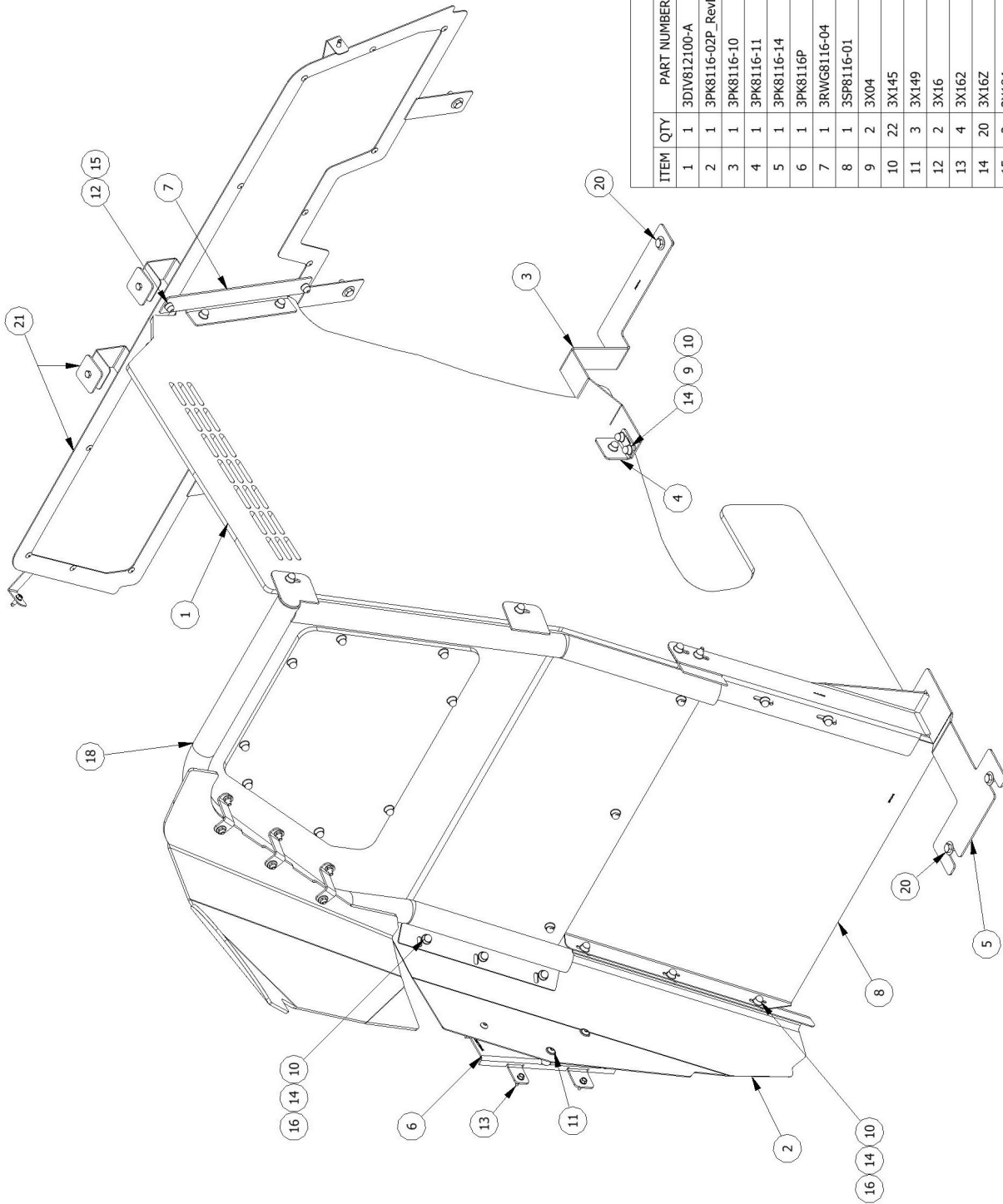

PARTS LIST			DESCRIPTION
ITEM	QTY	PART NUMBER	
1	1	3DIV812100-A	PRO-CELL DIVIDER, WINDOW GUARD
2	1	3PK8116-02P_RevD	MOUNTING PLATE F150 16
3	1	3PK8116-10	BRKT LOWER REAR F150
4	1	3PK8116-11	BRACKET ANGLE DIVIDER F150
5	1	3PK8116-14	CENTER SUPPORT WELDMENT
6	1	3PK8116P	B-PILLAR BRACKET ASSY, PS
7	1	3RWG8116-04	CENTER BRACKET
8	1	3SP8116-01	SEAT PROTECTOR, PRO-CELL
9	2	3X04	1/4-20 X 5/8 HEX HD CAP SCR, BLK
10	22	3X145	BLACK PLASTIC CAP
11	3	3X149	5/16-18 X 3/4 BSHCS, BK
12	2	3X16	1/4-20 HEX WHIZ NUT - BLACK
13	4	3X162	#14 x 3/4" SELF DRILLING HEX HEAD SCREW
14	20	3X162	1/4-20 LARGE HEX WHIZ NUT-ZINC
15	2	3X184	1/4-20X0.75, BHS CS, BLACK OXIDE
16	10	3X36	1/4-20 X 5/8 CARRIAGE BOLT
17	7	3X82	1/4-20 X 1 CARRIAGE BOLT
18	1	4P1000T15	PARTITION PRO-CELL TAH 15
19	1	4WIK812100	P1000 Wing Kit
20	3	FORD OEM BOLT	VARIOUS
21	1	RWG81FT16	REAR WINDOW GUARD F-150 16

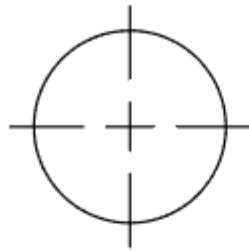

DIRECTIONS

1. CUT ALONG DASHED LINES

2. REMOVE THE B-PILLAR TRIM AND PLACE TEMPLATE INSIDE, ALIGNING CUT-OUT AREAS WITH THE CORRESPONDING FEATURE SHOWN

3. CENTER PUNCH 3 HOLE LOCATIONS THRU TEMPLATE AND DRILL/CUT 1" DIA HOLE

4. REINSTALL TRIM PANELS OVER TOP OF THE B-PILLAR BRACKETS

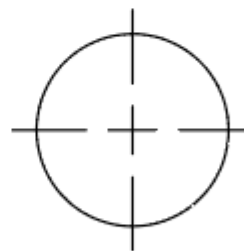
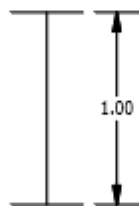
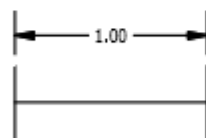

CHECK SCALE
SELECT NONE FOR PAGE SCALING
WHEN PRINTING FROM .pdf FILE

2016+ F-150
B-PILLAR TRIM TEMPLATE
PASSENGER SIDE

