

INSTALLATION GUIDE

P1000DUR18AOSB

P1000 PRO-CELL

2018+ DODGE DURANGO

Pro-gard[™]
PRODUCTS LLC.

STRONG. RELIABLE. SECURE.

**THESE COMPONENTS ARE REQUIRED
TO INSTALL THE PRO-GARD PARTITION SYSTEM**

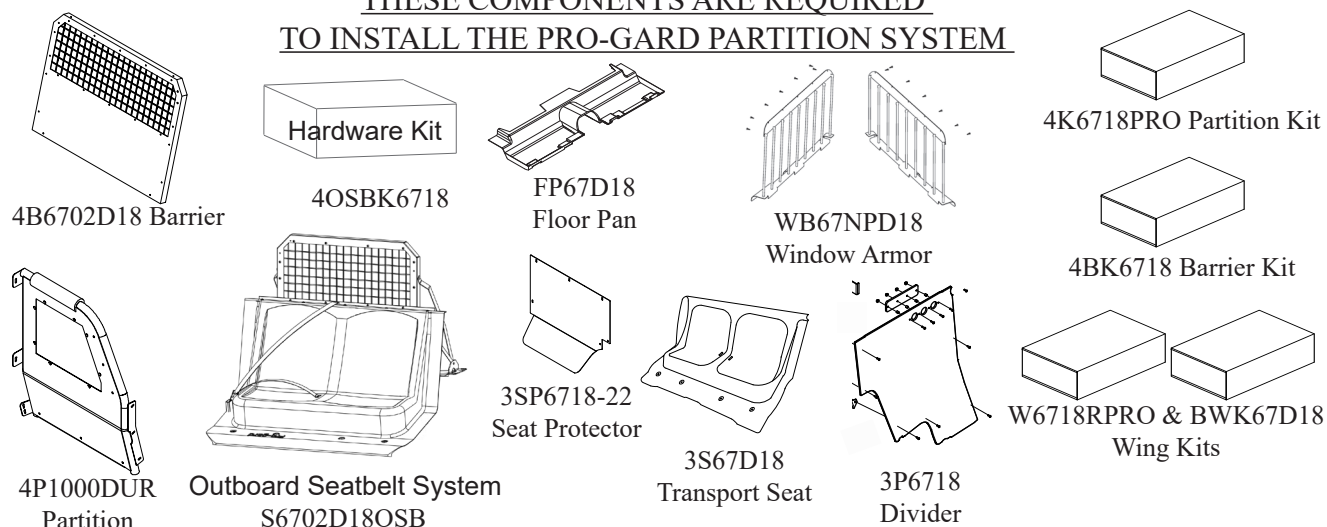

I. Refer to the diagram on the last page of these instructions to verify all parts were received.

II. The following tools will be required to complete the installation.

| | | |
|-------------------------------|---|----------------------------|
| 1/4" & 3/8" Drive Ratchet | Phillips Screw Driver | 5/32" & 3/16" Allen Wrench |
| 6" Extension | 11/16", 7/16", 9/16", 11/16" & 3/4" Sockets | 1" Hole Saw |
| 3/16", 5/16" & 1/2" Drill Bit | T-45 Torx Bit | 7/16" End Wrench |

III. Read all instructions carefully before starting the assembly process.

NOTE: *Locate all Wiring, Fuel lines, Brake lines, Coolant lines and Refrigerant lines before drilling holes or installing self-drilling fasteners.*

IV. Install Barrier, Seat Support and Floor Pan

- A. Install Barrier (4B6702D18) per instructions provided.
- B. Install Floor Pan (FP67D18) per instructions provided.
- C. Install OSB System (4OSBK6718) per instructions provided, stopping at Step IV. H. just before the seat installation.

V. Partition Installation - B-pillar Bracket Installation

- A. Remove the B-pillar trim to access the sheet metal body. After the trim is removed, locate B-pillar bracket (3PRT6718-01P).

The B-pillar bracket is located under and against the seat belt guide and the side flanges locate in the b-pillar body recessed contours (Fig. 1).

Using the bracket, mark the (4) mounting hole locations and drill 3/16" dia. pilot holes on each mark. Secure the B-pillar bracket with self-tapping screws (3X162).

- B. Use the supplied B-pillar template on the last page to mark the three hole locations in the B-pillar trims. Using hole 1" hole saw, drill out the holes for the standoffs and re-install the trim.

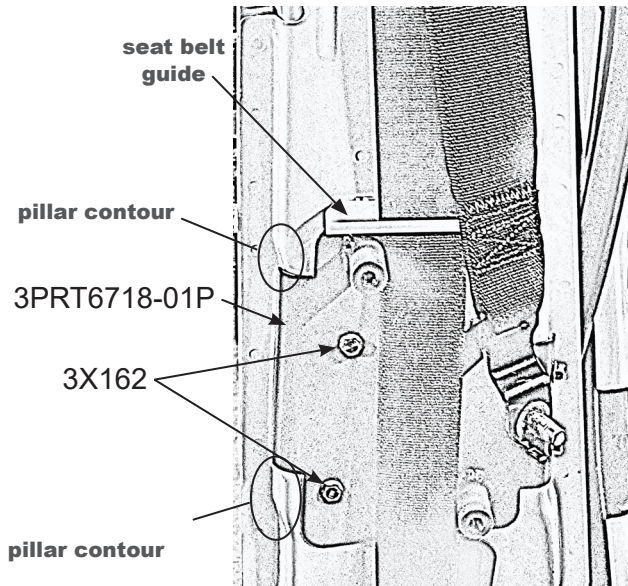
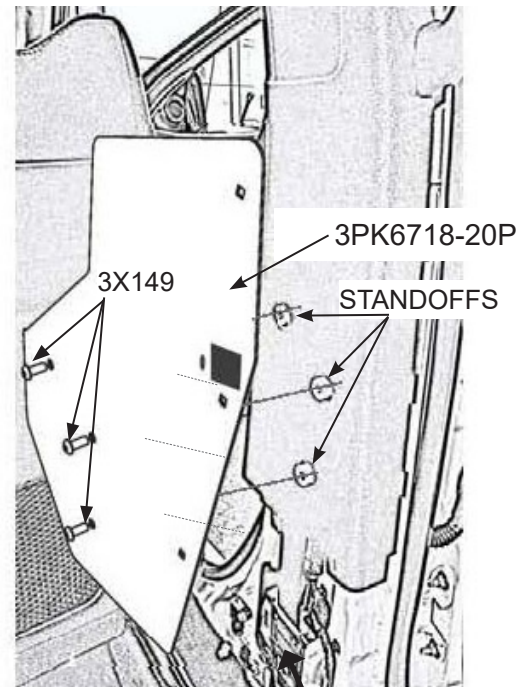

Fig. 1



Lower trim to be re-installed here (not shown)

Fig. 2

VI. Install Partition Mounting Plate

- A. When B-pillar bracket installation is complete and the trim is reinstalled, then the partition mounting plate (3PK6718-20P) can be installed.
- B. Fasten mounting plate to B-pillar bracket threaded standoffs using three (3X149) bolts. (Fig. 2) Leave bolts loose until the partition is installed.

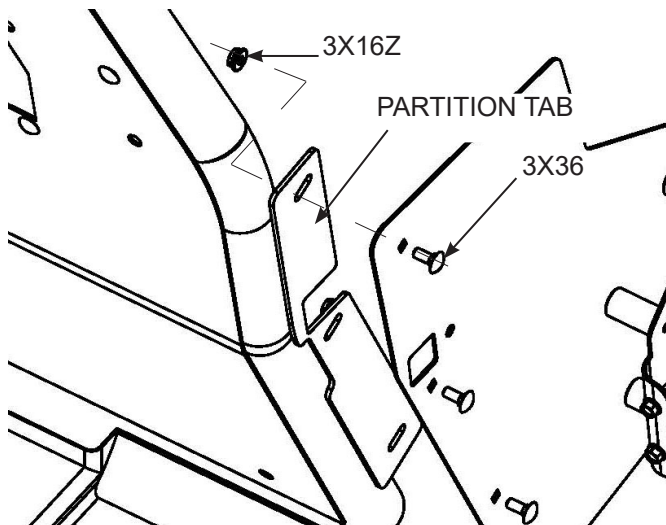

Fig. 3

VII. Install Partition and Center Bracket

- A. At this point the partition can be installed in the vehicle. You'll need a second person.
- Carefully lift the partition through the vehicle. Align the partition tab with the (3) square holes in the mounting plate.
- Start the three (3X36) bolts and (3X16Z) whiz nuts on the partition tab to hold in place. (Fig. 3)
- B. With one person holding the partition level, fasten the center bracket (3PK6718-21) to the partition and tighten bolts and nuts. (Fig. 4)

- C. Check that the partition is level, adjust where necessary, then tighten all loose screws on the mounting plate and center bracket. (Fig. 4)

VIII. Install Center Floor Bracket

- A. Fasten center floor bracket 3PK6718-24 to OSB front bracket re-using existing fasteners. (Fig. 5)
- B. Align center bracket (3PK6718-24) holes with center bracket (3PK6718-21) and fasten using bolts (3X82) and whiz nuts (3X16Z). (Fig. 5)

NOTE: Fasteners for center bracket are temporarily installed. Must be removed to install the center divider.

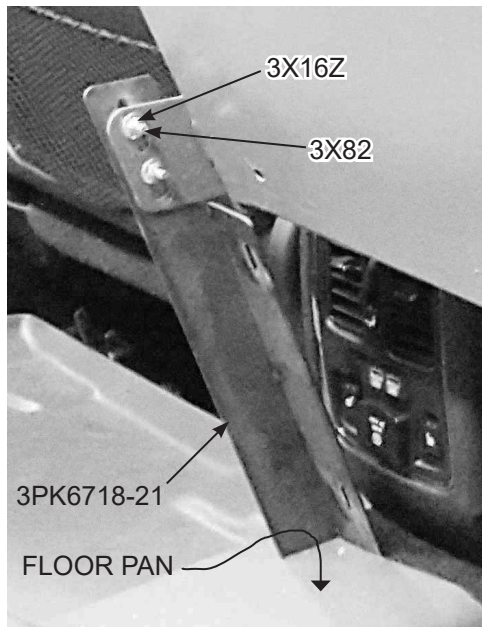

Fig. 4

CUT-OUTS - SEE FLOOR PAN INSTRUCTIONS FP67D18

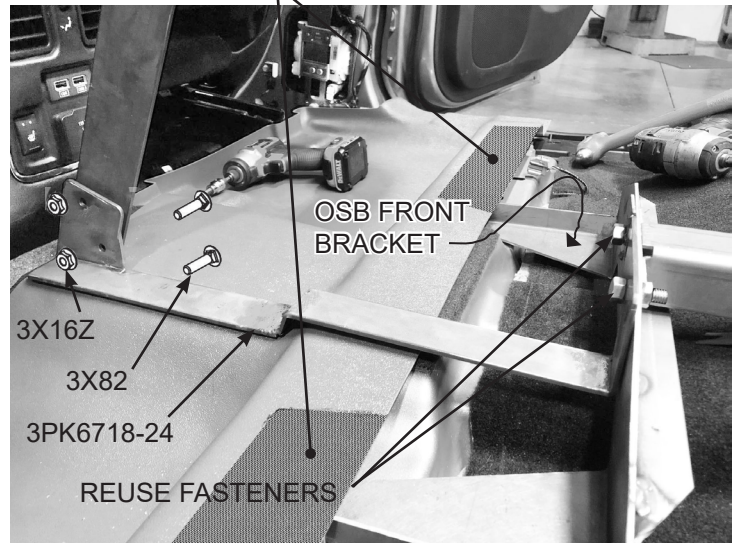

Fig. 5

IX. Install Seat Protector

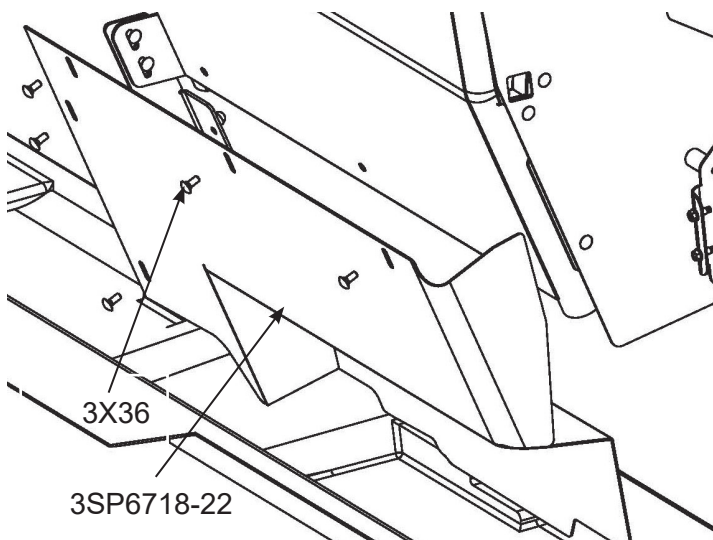
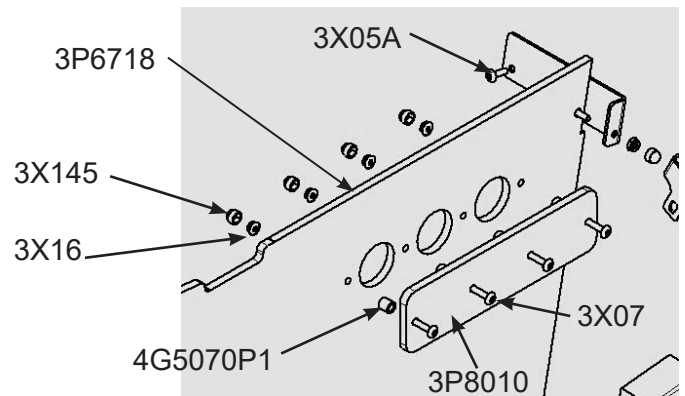
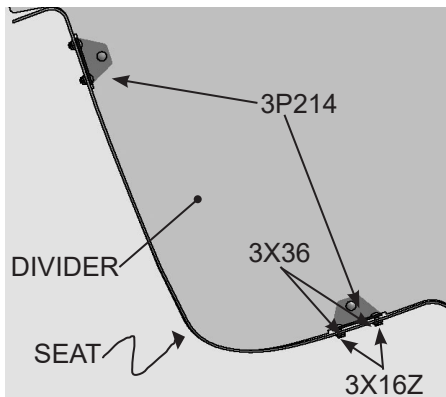
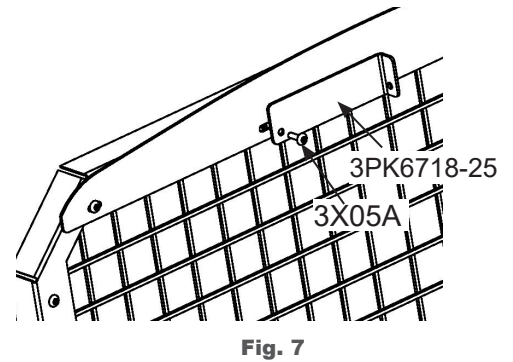

Fig. 6

- A. Next, install the seat protector (3SP6718-22) by aligning holes with the partition and center bracket (3PK6718-21) and fasten using (3X36) bolts and (3X16Z) whiz nuts. (Fig. 6)

X. Temporary Seat & Divider Install to Locate Seat Brackets

- A. Install the seat using enough fasteners to sufficiently affix.
- B. Fasten divider barrier bracket (3PK6718-25) at top of barrier as shown, by removing supplied bolt and replacing with longer kit bolt (3X05A). (Fig. 7)
- C. Bring the divider in top first from the passenger side. Now slide the divider toward the center of vehicle and locating against the top divider barrier bracket, 3 partition tabs and center support bracket.
- D. Fasten divider to hold in place while marking divider bracket hole locations, using bolts (3X82) and whiz nuts (3X16Z).
- F. Locate divider mounting brackets (3P214) with the two clearance notches at seat bottom and back with flange toward the passenger side and mark mounting hole locations on the seat.
- G. Remove divider and seat and drill the marked hole locations on the seat.
- H. Attach the (3P214) divider mounting brackets using (3X36) bolts and (3X16Z) whiz nuts. (Fig. 8)



XI. Install Seat and Seat Belt

- A. Following instructions for OSB Seat and Seat Belt (4OSBK6718) as outlined in Step V.

NOTE: Instructions will be for driver and passenger belts but kit (4OSBK6718PRO) will only have passenger belts.

XII. Install Center Divider

- A. Assemble vent plate over three large diameter air holes. Use (4G5070P1) spacers between plate and center divider. Secure using the long, phillips head screws (3X07), black whiz nuts (3X16), and black caps (3X145). (Fig. 9)

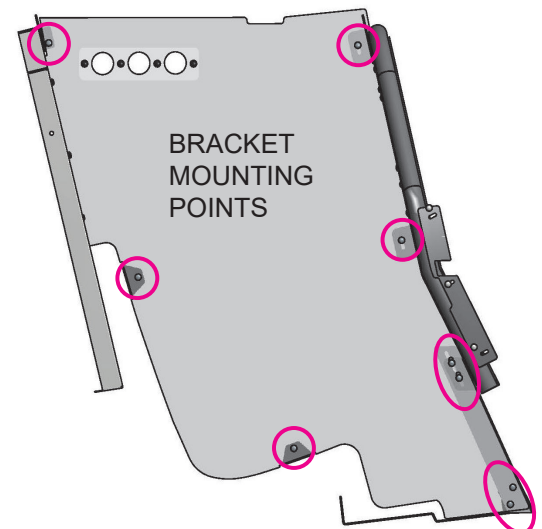

- B. Re-install divider as in above Step X.C. and secure using the carriage bolts (3X82) and whiz nuts (3X16Z) provided. (Fig. 10)

XIII. Install Partition Filler Wing

- A. Locate partition filler wing (3W6718-23) against divider and ceiling, then mark hole locations. Drill 5/16" holes and fasten using bolts (3X36) and whiz nuts (3X16Z). (Fig. 11)

XIV. Install Partition Wing

- A. Install per instructions found in kit (W6718RPRO) (Fig. 11)

NOTE: *Installation of the Filler Wings according to these instructions is critical in their ability to function properly in the event of Side Air Bag deployment.*

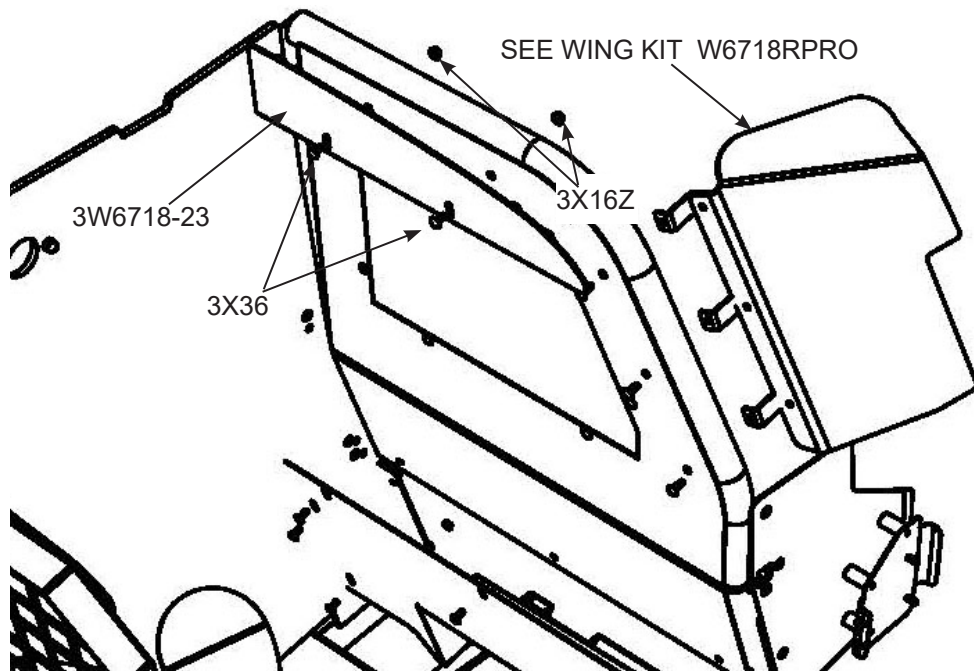

Fig. 11

XV. Install Window Armor

- A. Install window armor per instructions provided.

XVI. Finish

- A. Place (3x145) black plastic caps on all exposed nuts to finish installation.

Installation complete!

If you have any problems with this installation then call the toll free number (800-480-6680) and ask for technical assistance.

| PARTS LIST | | | |
|------------|-----|-----------------|---|
| ITEM# | QTY | PART NUMBER | DESCRIPTION |
| 1 | 2 | 3P214 | BRACKET, MOUNTING |
| 2 | 1 | 3P6718 | DIVIDER PRO-CELL DUR. 18 |
| 3 | 1 | 3P8010 | DIVIDER VENT PLATE |
| 4 | 1 | 3PK6718-002 | DOOR HANDLE POCKET |
| 5 | 1 | 3PK6718-20P | MOUNTING PLATE PRO-CELL DUR. 18 |
| 6 | 1 | 3PK6718-21 | CENTER SUPPORT BRACKET |
| 7 | 1 | 3PK6718-24 | CENTER FLOOR BRACKET |
| 8 | 1 | 3PK6718-25 | DIVIDER BARRIER BRACKET |
| 9 | 1 | 3PRT6718-01P | B-PILLAR BRACKET PASSENGER DUR.18 |
| 11 | 1 | 3SP6718-22 | SEAT PROTECTOR PRO-CELL DUR. 18 |
| 12 | 1 | 3W6718-23 | TOP FILLER PANEL PRO-CELL DUR.18 |
| 13 | 1 | 3K05A | 1/4-20 X 7/8 PHIL TRUSS HD MS |
| 14 | 4 | 3K07 | 1/4-20 X 1-1/2 PHIL TRUSS HD MS |
| 15 | 22 | 3K145 | BLACK PLASTIC CAP |
| 16 | 3 | 3K149 | 5/16-18 X 3/4 BSHCS, BK |
| 17 | 4 | 3K16 | 1/4-20 WHIZ NUT |
| 18 | 4 | 3K162 | #14 X 3/4" SELF DRILLING HEX HEAD SCREW |
| 19 | 20 | 3K162 | 1/4-20 WHIZ NUT |
| 20 | 11 | 3K36 | 1/4-20 X 5/8 CARRIAGE BOLT |
| 21 | 9 | 3K82 | 1/4-20 X 1 CARRIAGE BOLT |
| 22 | 4 | 4G5070P1 | SPACER, DIVIDER VENT PLATE |
| 23 | 1 | 4P1000DUR | FRAME PRO-CELL |
| 24 | 1 | 4W6718R-P-P1000 | WING 1/4" AB DUR. 18 |
| 25 | 1 | FP67D18 | FLOOR PAN DUR. 18 |
| 26 | 1 | 5G70SD1805B | SEAT BARRIER OSB DUR. 18 |
| 27 | 1 | WB67NPD18 | WINDOW BAR STEEL OEM DUR. 18 |

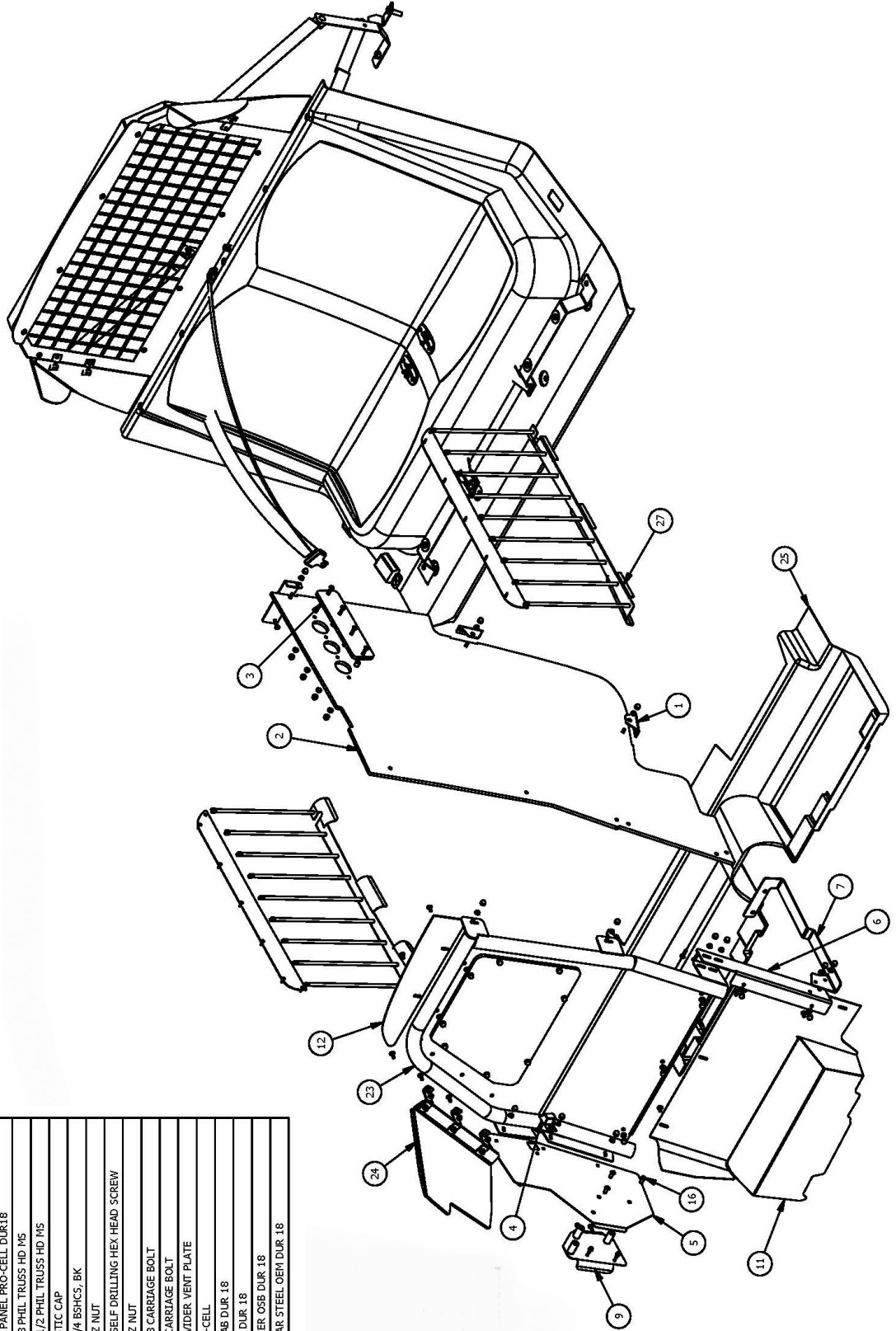

TRIM PANEL TEMPLATE FOR PARTITION INSTALL ON 2018 DODGE DURANGO PASSENGER SIDE

PLASTIC MOLD FEATURE

- A. CUT OUT CROSS HATCHED AREAS AND ALONG DASHED LINES.
- B. LINE UP CUT OUTS WITH TRIM PANEL FEATURES
- C. CENTER PUNCH THREE HOLE LOCATIONS THRU TEMPLATE & DRILL/CUT 1" DIA HOLES

CHECK SCALE

SELECT "NONE" FOR PAGE
SCALING, OR SELECT "ACTUAL SIZE"
WHEN PRINTING FROM .pdf FILE