

INSTALLATION GUIDE

**2018+ DURANGO
P1000 OEM PRO-CELL
P1000DUR18AOEM**

Pro-gardTM
PRODUCTS LLC.

STRONG. RELIABLE. SECURE.

**THESE COMPONENTS ARE REQUIRED
TO INSTALL THE PRO-CELL OEM SYSTEM**

This system requires the barrier to be installed.

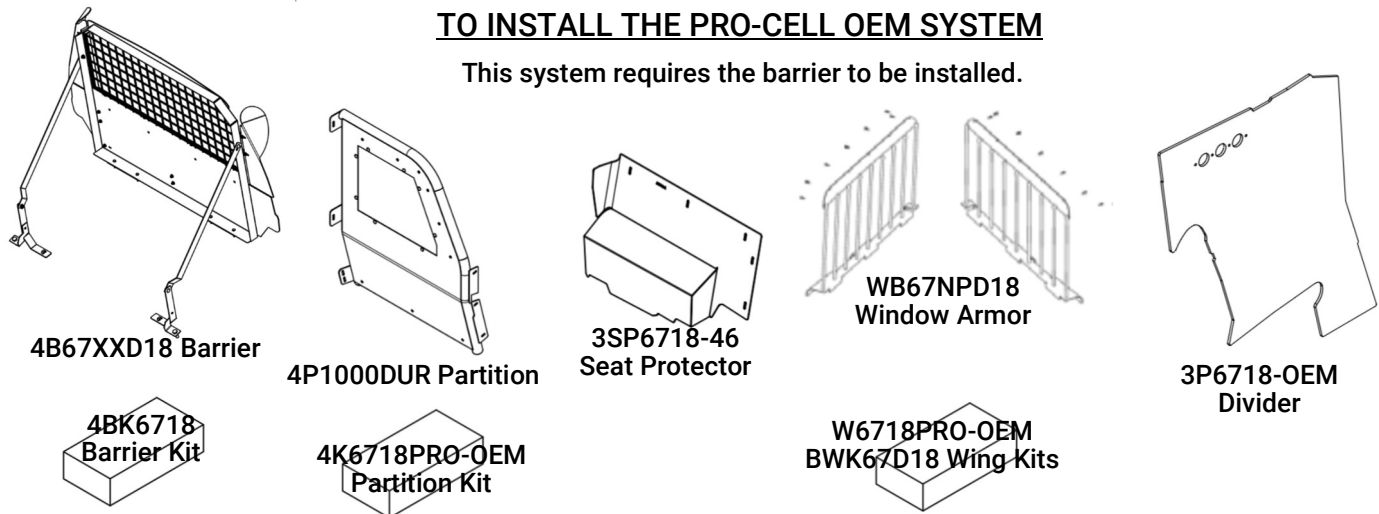

I. The following tools will be required to complete the installation

II. Read all instructions and refer to last page to ensure all parts were received

- | | | |
|------------------------------|--------------------------|----------------------------|
| A. 7/16, 9/16, & 3/8 Sockets | C. 15mm Deep Well Socket | E. 3/16", 5/16" Drill Bits |
| B. Phillips Screw Driver | D. 3/16 Allen Wrench | F. 1" Hole Saw |

NOTE: The Durango barrier must be installed along with the Outboard Seat Belt System.

WARNING: Locate All wiring, fuel lines, brake lines, coolant lines, or refrigerant lines before drilling any holes or installing any self-drilling fasteners.

III. Install Barrier (4B6702D18) per instructions provided

IV. Install Window Guard (WB67NPD18) per instructions provided.

V. Partition Installation—B-Pillar and Mounting Plate

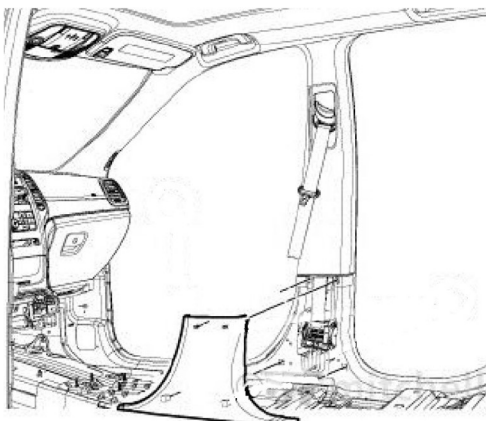

A. Remove lower B-pillar trim.

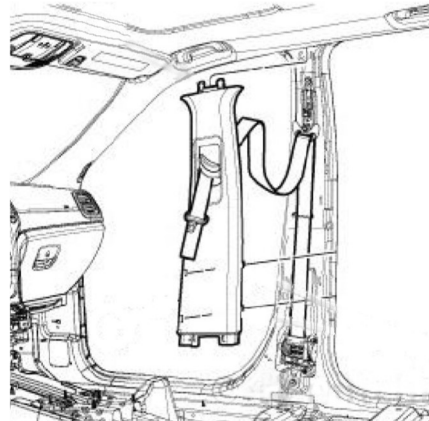

B. Remove upper B-pillar trim.

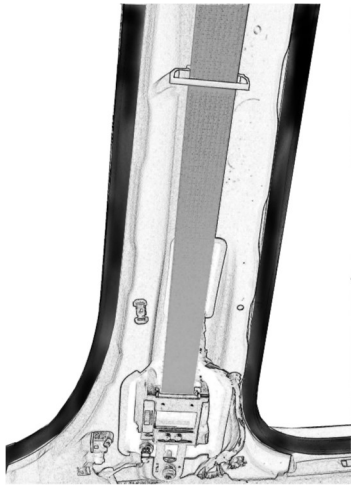

C. B-pillar with trim removed.

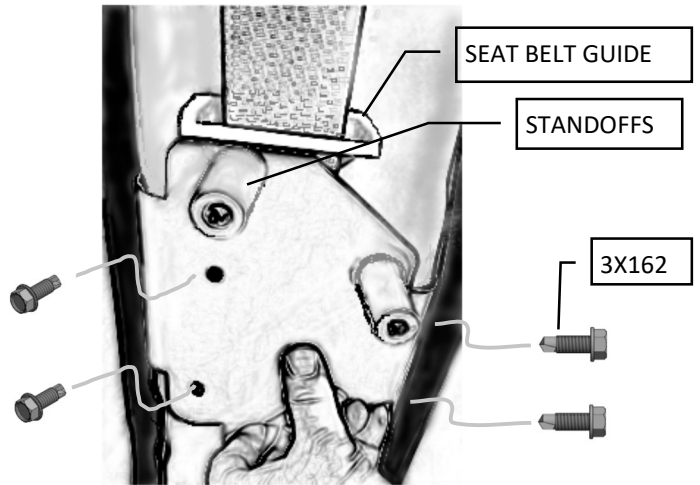

D. Locate B-pillar bracket up against seat belt guide. Mark hole locations. Pre-drill using 3/16" drill bit.

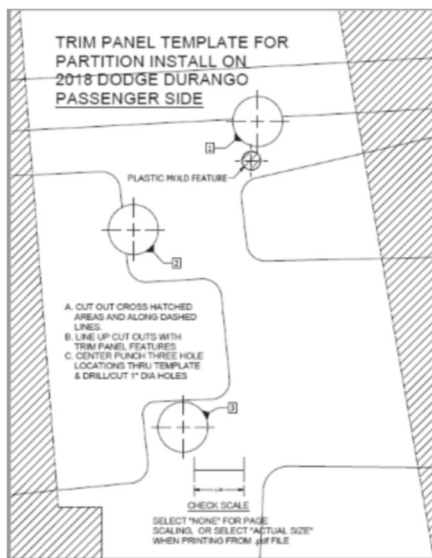

E. Use paper template (last page) and mark and drill hole locations on B-pillar trim using 1" dia hole saw.

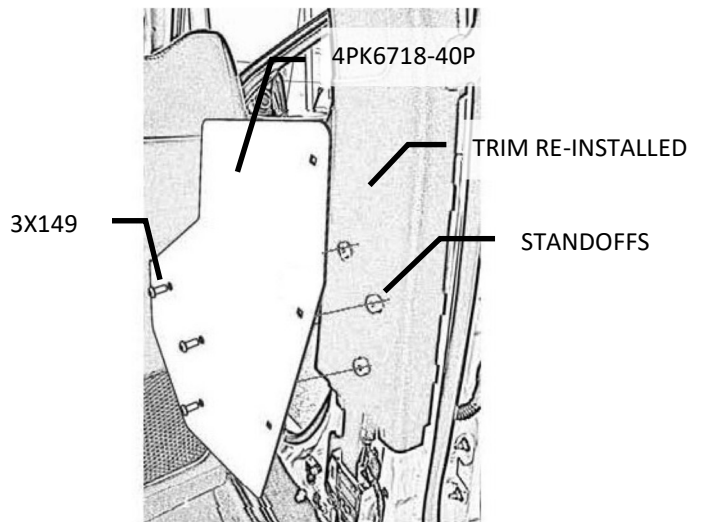

F. Re-install B-pillar trim and fasten mounting plate using (3X149) screws.

VI. Install Partition and Center Support.

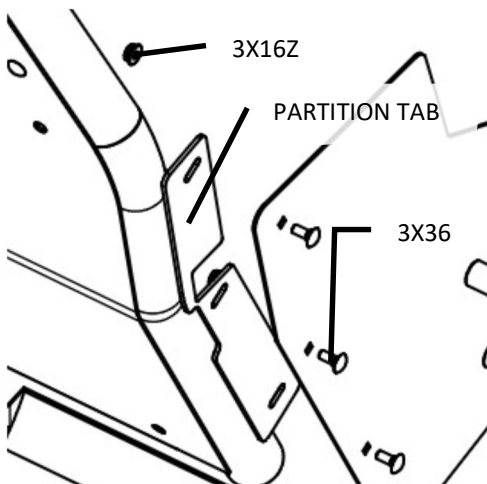

A. With assistance, bolt partition to mounting plate as shown.

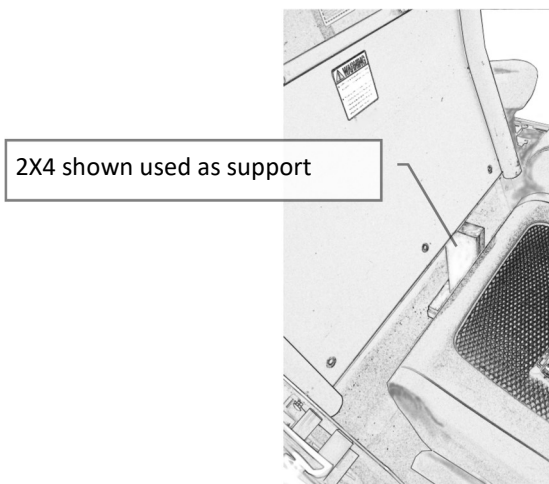

B. Prop up unsupported end as needed.

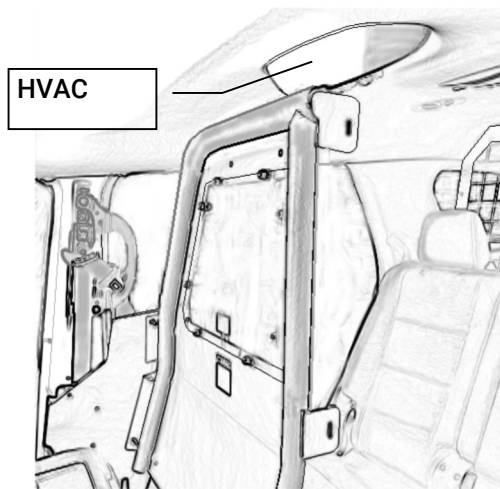

Note: partition will be just forward of the HVAC ceiling controls.

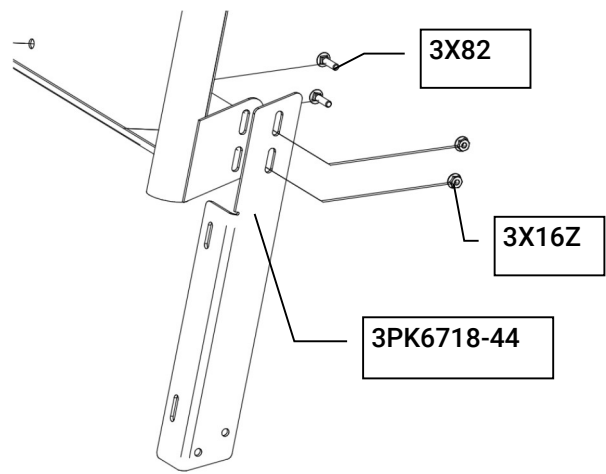

C. Install center support bracket (3PK6718-44) . Note: fasteners will be removed and re-fastened when installing divider.

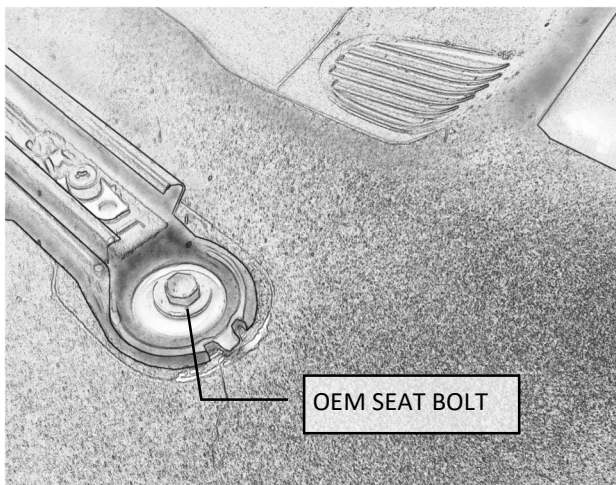

D. Remove OEM bolt from driver side seat track.

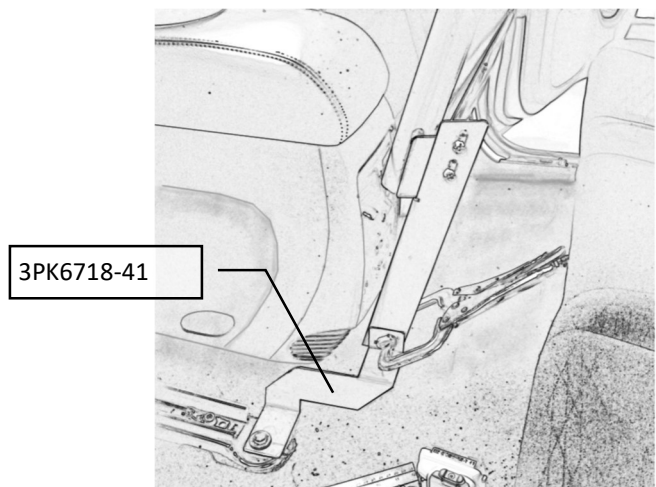

E. Install center support floor bracket (3PK6718-41) and fasten to center support using OEM bolt and (2) [3X82] bolts and (2) [3X16Z] nuts.

VII. Install Seat Protector and Divider Brackets

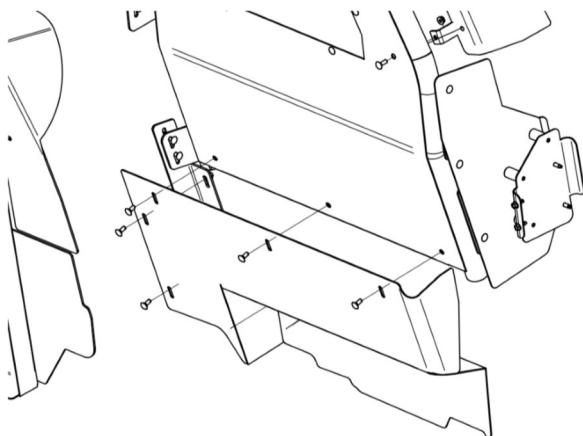

A. Install seat protector (3SP6718-46) using (3X36) bolts and (3X16Z) nuts. The wrap-around flange will tuck behind the mounting plate.

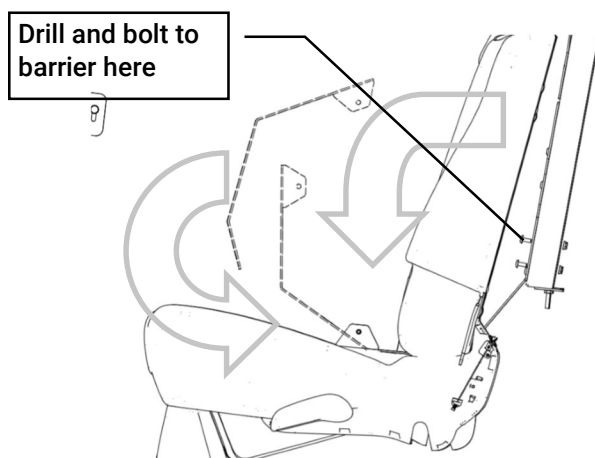

B. Insert lower support bracket (3PK6718-42) between seat and seat back, rotating upward and against barrier. Fold seat back down. Mark and drill mounting hole locations through barrier. Fasten bracket using (3X03) bolts and (3X16Z) nuts.

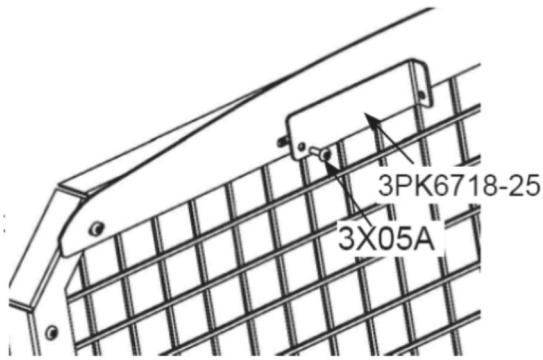

C. Fasten divider barrier bracket (3PK6718-25) by replacing existing screw with (3X05A) as shown.

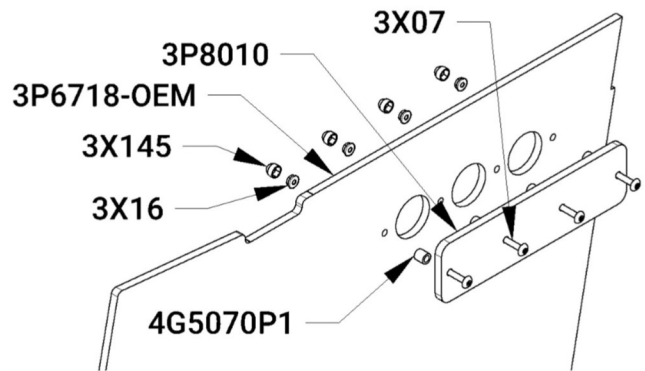

D. Sub-assembly vent to divider as shown.

VIII. Install Center Divider and Wings

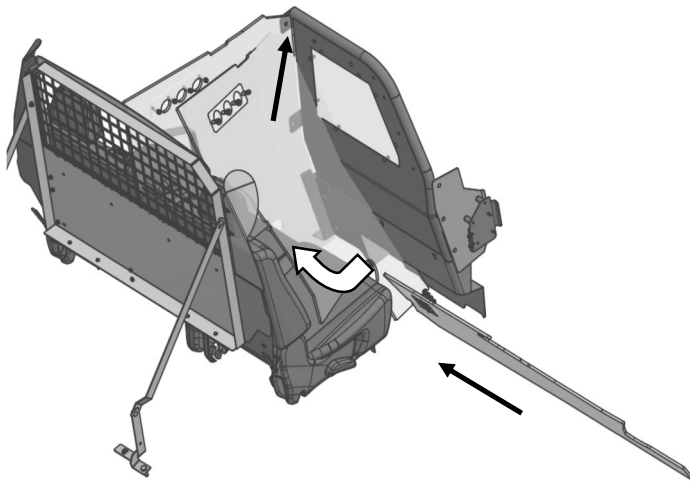

A. Bring divider in through the passenger side, top first, angle to center, pivot to rear and slide against mounting surfaces.

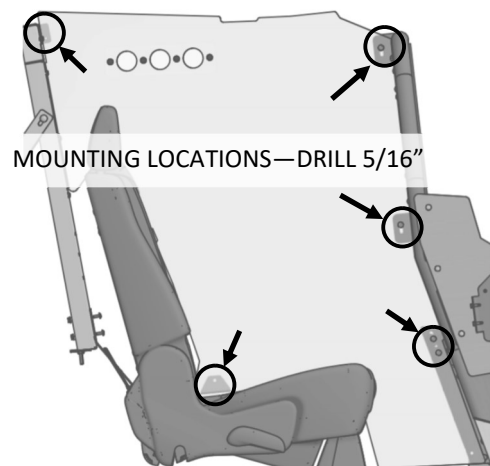

B. At mounting points, mark hole locations and drill holes using 5/16" drill bit. Fasten divider using (3X82) bolts and (3X16Z) whiz nuts.

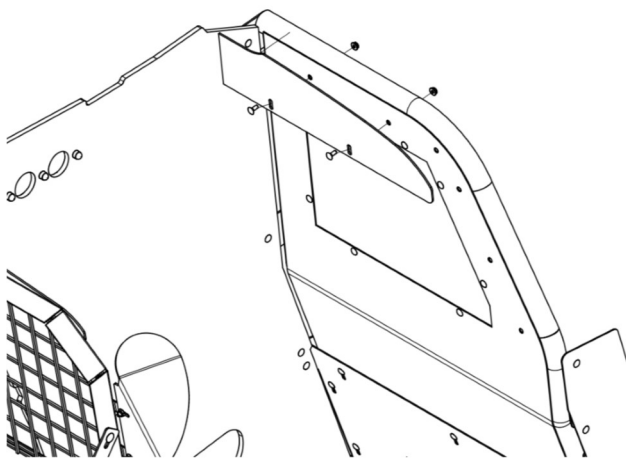

C. Locate top filler (3W6718-43) against ceiling and divider, then mark. Drill 5/16" mounting holes and fasten using (3X36) bolts and (3X16Z) whiz nuts.

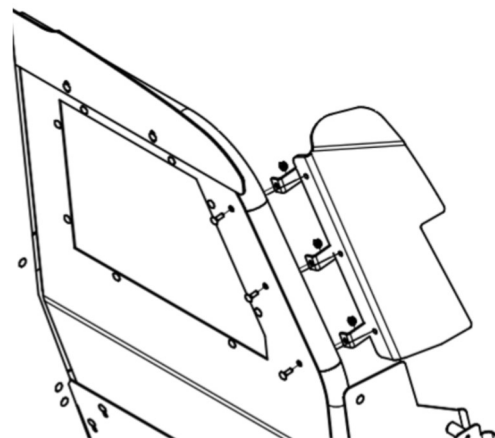

D. Sub-assembly wing and install to partition per instructions found in wing kit (W6718PRO-OEM).

Installation complete

If you have any problems with this installation or have any questions please call (800-480-6680) and ask for technical assistance.

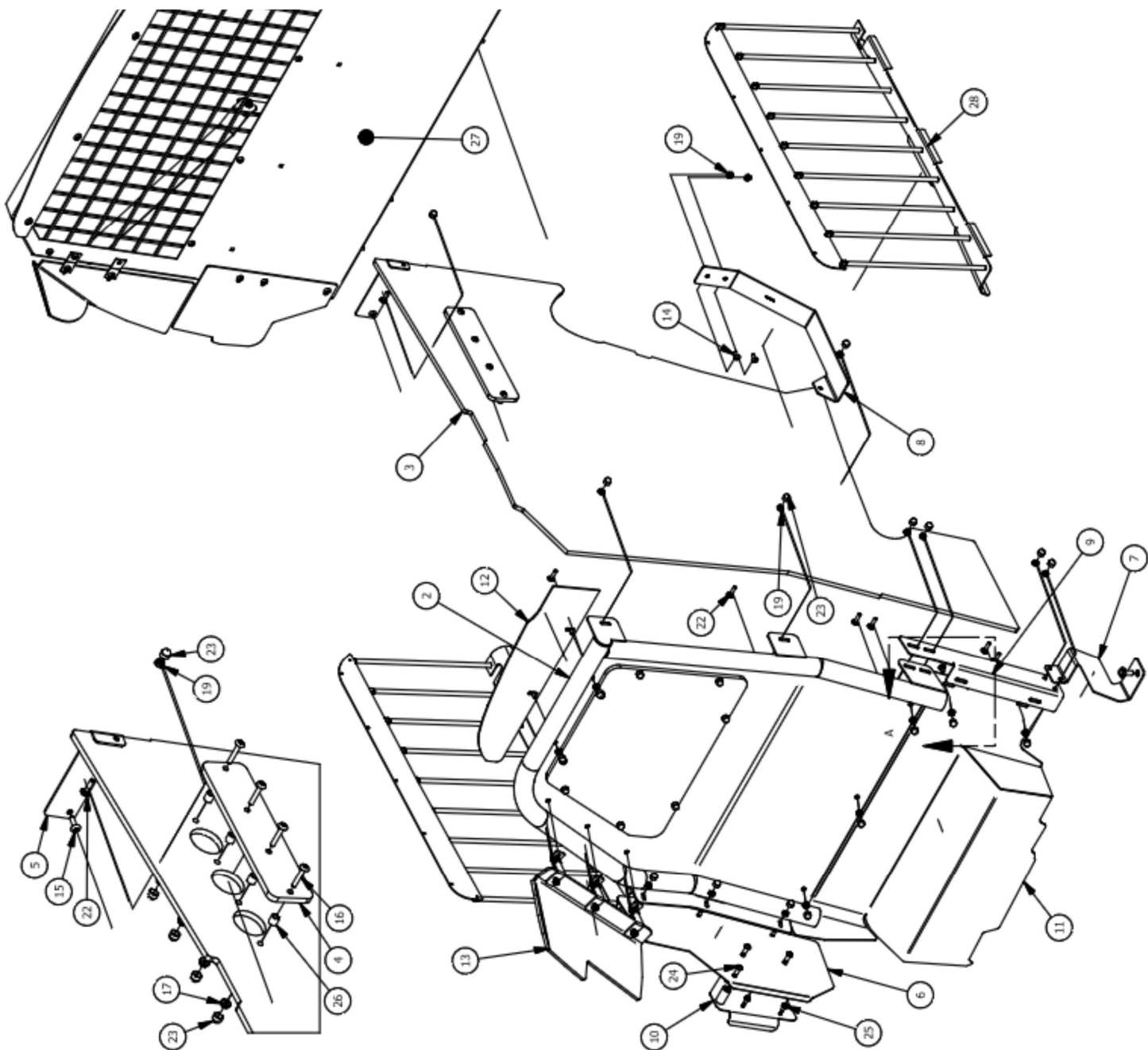

4K6718PRO-OEM KIT PRO-CELL 1/2 CAGE DUR 18*		
ITEM	QTY	PART NUMBER DESCRIPTION
4	1	3PR8010 DIVIDER VENT PLATE
5	1	3PK6718-25 DIVIDER BARRIER BRACKET
6	1	3PK6718-40P MOUNTING PLATE OEM PRO-CELL DUR 18
7	1	3PK6718-41 CENTER SUPPORT FLOOR BRACKET
8	1	3PK6718-42 LOWER REAR BRACKET
9	1	3PK6718-44 CENTER SUPPORT BRACKET
10	1	3PRT6718-01P B-PILLAR BRACKET PASSENGER DUR18
11	1	3SP6718-46 SEAT PROTECTOR OEM PRO-CELL DUR 18
14	2	3X003 1/4-20 X 5/8 PHIL TRUSS HD MS
15	1	3X005A 1/4-20 X 7/8 PHIL TRUSS HD MS
16	4	3X007 1/4-20 X 1-1/2 PHIL TRUSS HD MS
17	4	3X16 1/4-20 HEX WHIZ NUT - BLACK
19	18	3X16Z 1/4-20 LARGE HEX WHIZ NUT-ZINC
20	8	3X36 1/4-20 X 5/8 CARRIAGE BOLT
22	8	3X82 1/4-20 X 1 CARRIAGE BOLT
23	22	3X145 BLACK PLASTIC CAP
24	3	3X149 5/16-18 X 3/4 BSHCS, BK
25	4	3X162 #14 X 3/4" SELF DRILLING HEX HEAD SCREW
26	4	4G5070P1 SPACER, DIVIDER VENT PLATE

W6718PRO-OEM 1/4" AB WING KIT PRO CELL DUR 18		
ITEM	QTY	PART NUMBER DESCRIPTION
1	3	3P932 Z-BRACKET, AIRBAG WING 11GA
12	1	3W6718-43 TOP FILLER PANEL OEM PRO-CELL DUR18
13	1	3W6718PRO-OEM WING 1/4" AB DUR 18
18	3	3X16SZ 1/4-20 SMALL WHIZ NUT-ZINC
19	18	3X16Z 1/4-20 LARGE HEX WHIZ NUT-ZINC
20	8	3X36 1/4-20 X 5/8 CARRIAGE BOLT
21	6	3X61 1/4-20 X 3/4 CARRIAGE BOLT

ADDITIONAL PARTS AND ASSEMBLIES		
ITEM	QTY	PART NUMBER DESCRIPTION
2	1	3P5100 FRAME PRO-CELL
3	1	3PK6718 OEM DIVIDER OEM PRO CELL DUR 18
11	1	3SP6718-46 SEAT PROTECTOR OEM PRO-CELL DUR 18
27	1	B67X018 2018 DURANGO BARRIER
28	1	WB67NFD18 WINDOW BAR STEEL OEM DUR 18

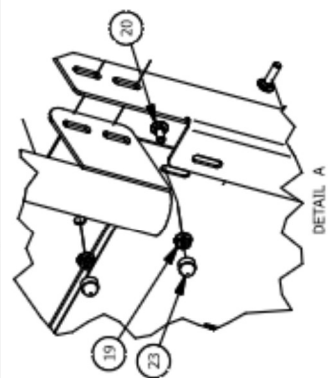

TRIM PANEL TEMPLATE FOR PARTITION INSTALL ON 2018 DODGE DURANGO PASSENGER SIDE

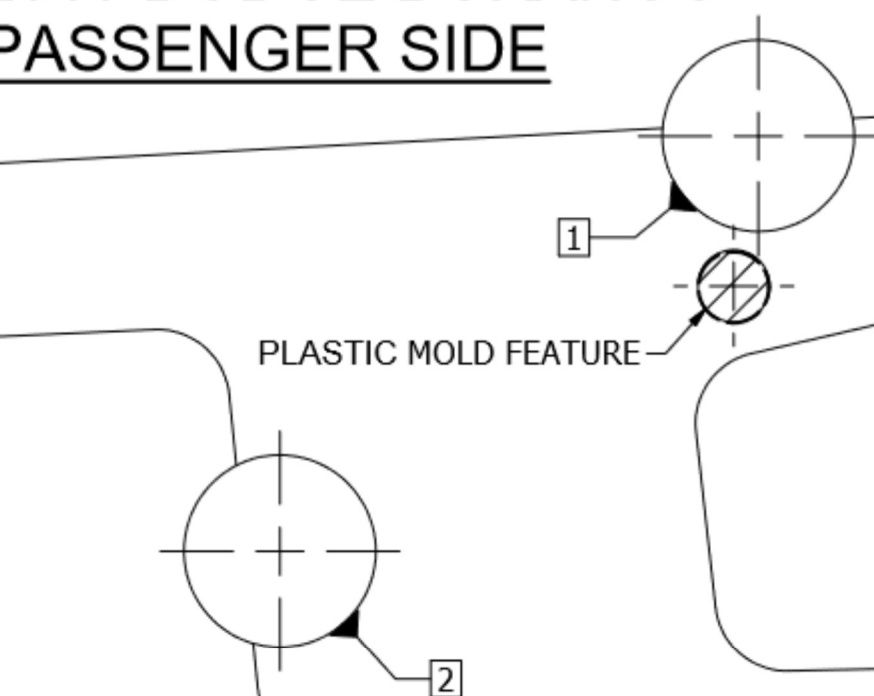

- A. CUT OUT CROSS HATCHED AREAS AND ALONG DASHED LINES.
- B. LINE UP CUT OUTS WITH TRIM PANEL FEATURES
- C. CENTER PUNCH THREE HOLE LOCATIONS THRU TEMPLATE & DRILL/CUT 1" DIA HOLES

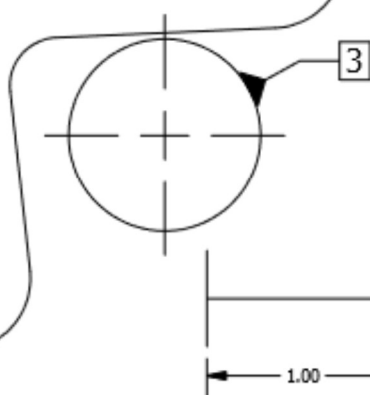

CHECK SCALE

SELECT "NONE" FOR PAGE
SCALING, OR SELECT "ACTUAL SIZE"
WHEN PRINTING FROM .pdf FILE