

INSTALLATION GUIDE

**GTM012 OR GTM015
TRUNK MOUNTED GUN RACK
2014-2017
DODGE CHARGER**

Pro-gardTM
PRODUCTS LLC.

STRONG. RELIABLE. SECURE.

THESE COMPONENTS ARE REQUIRED
TO INSTALL THE PRO-GARD GTM012 OR GTM 015 GUN RACK

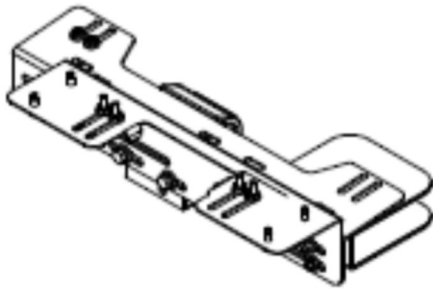

Gun Rack



4GKTM5614
GUN RACK LOWER
TRUNK MT KIT

I. Refer to the diagram on the last page of these instructions to verify all parts were received.

II. Tools required:

A. 7/16" or 11 mm wrench

B. Box Cutter

NOTE: This gun rack is designed for a weapon that is no longer than 36" in overall length.

II. Read all instructions carefully before beginning the installation process.

III. Mounting Instructions for Trunk Mounted Gun Rack Brackets.

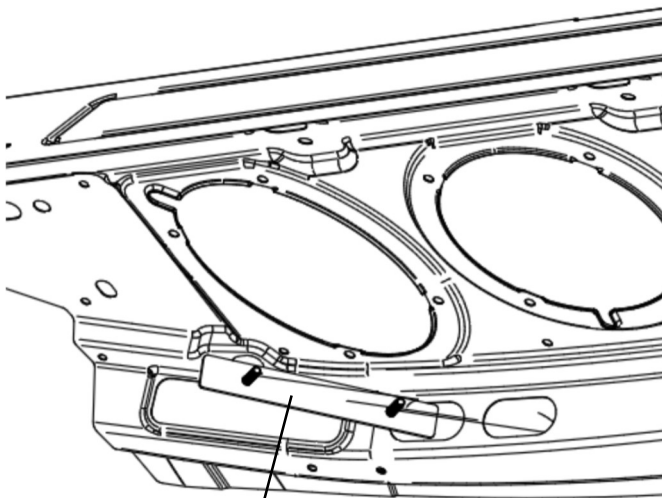

3GTM5617-01

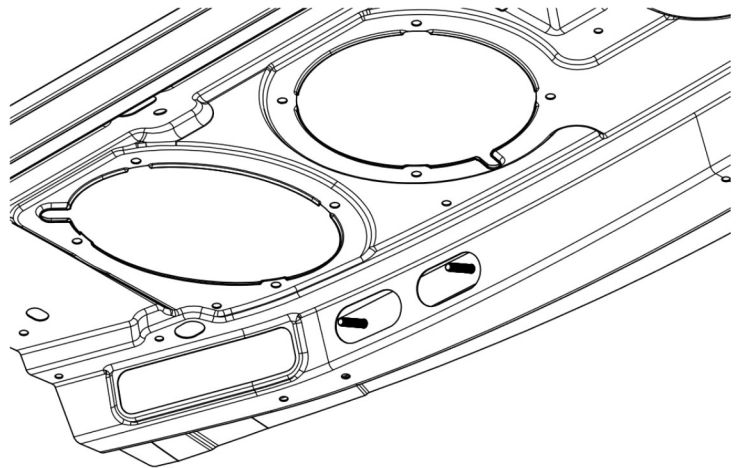
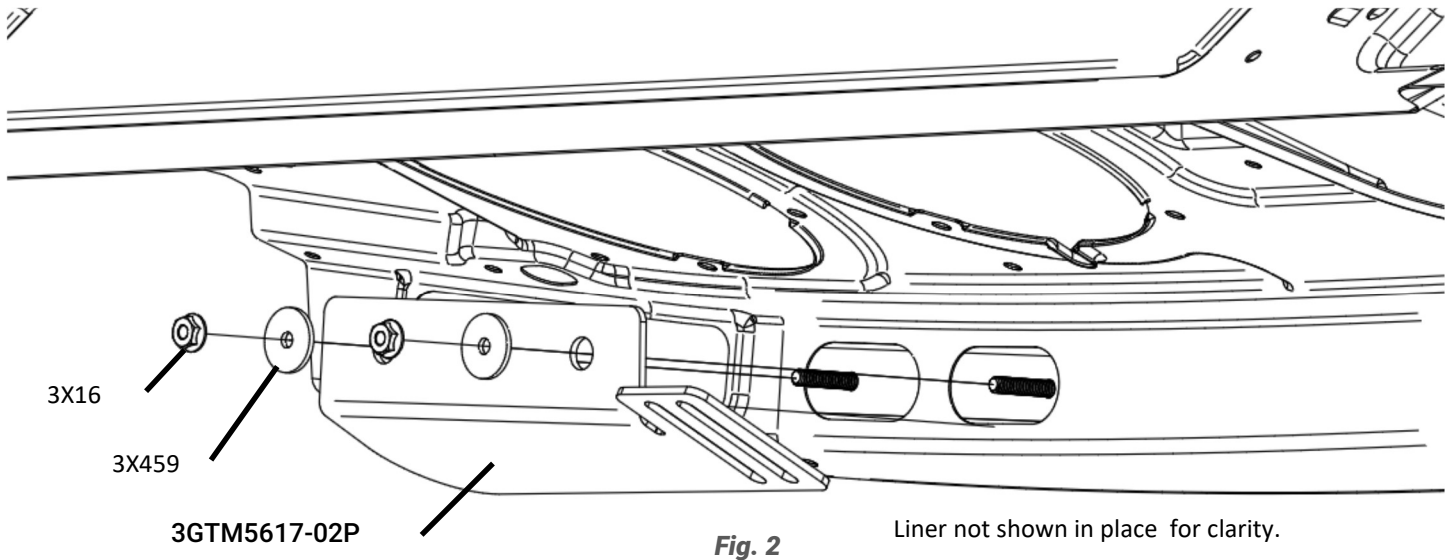

Fig. 1

- A. Drop trunk liner at rear deck. Slide the two brackets (3GTM5617-01) into the correct slots. Slide one end of the bracket through the first slot, towards the trunk center, fishing the bracket stud through the second slot. Refer to Fig 1. for bracket locations.
- B. Holding trunk liner up, locate and cut slits in liner and pull studs through. Holding the liner, place bracket 3GTM5617-02P over the studs and secure it loosely in place with the 3X459 washers and 3X16 nuts.

Repeat on the passenger side. Tighten hardware down securely on both brackets and secure the liner. Refer to Fig. 2. .

- C. Place the 3X36 bolts into the slots in the brackets. Now, lift the pre-assembled gunrack into place aligning



the slots in the brackets with the slots in the gunrack. Once the bolts studs are through the slots, then tighten the rack into place using the 3X16 nuts. Once tighten cover all exposed nuts with the 3X145 acorn caps. Refer to Fig. 3.

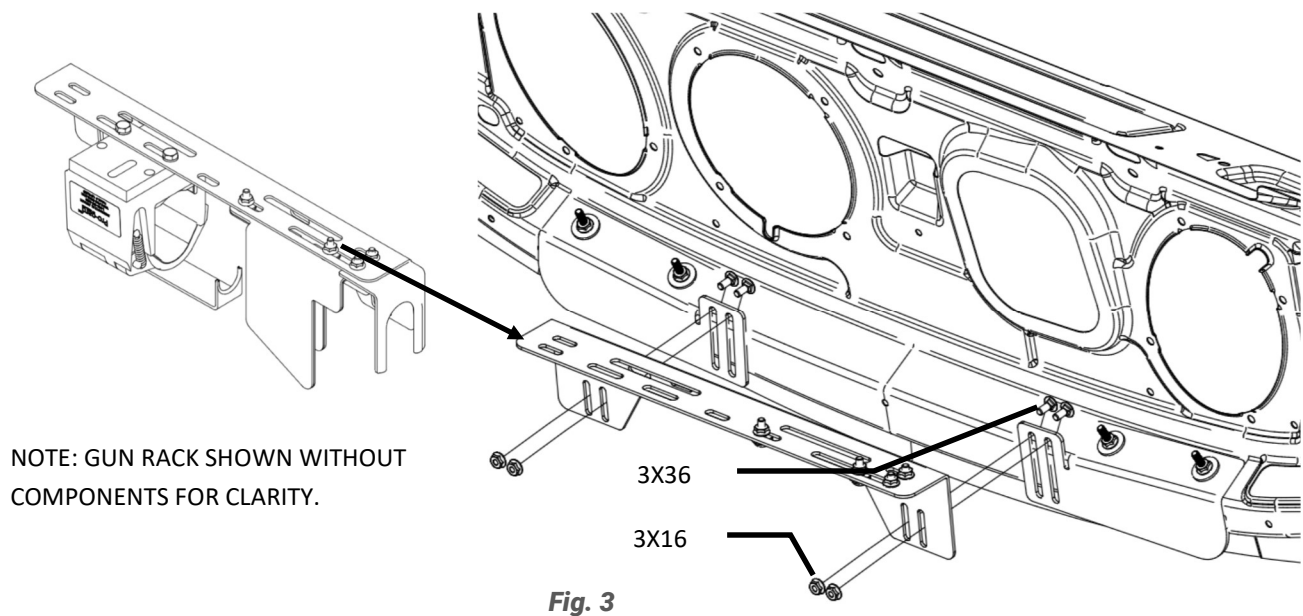

IV. Gun Lock Momentary Switch and Timer Installation

- Mount the release button (momentary switch) in a concealed location that can be reached easily by the officer, while holding on to the weapon.
- Connect the red lead of the gun lock to one side of the release button (momentary switch) and the green wire from the timer. It will be necessary to add appropriate gauge wire to accomplish this.
- Connect a wire lead from the other side of the release button (momentary switch) to the red wire from the

timer and either a switched or un-switched power source on the fuse block. This will allow the lock to operate with the ignition key on, or off, respectively.

- D. Pro-Gard requires the use of a 10 AMP fuse between the power source and the gun lock otherwise it will void the warranty!
- E. Connect the blue lead of the gun lock to AC chassis ground. DO NOT connect to the factory aftermarket grounding post with other auxiliary equipment. It will be necessary to add wire to accomplish this.

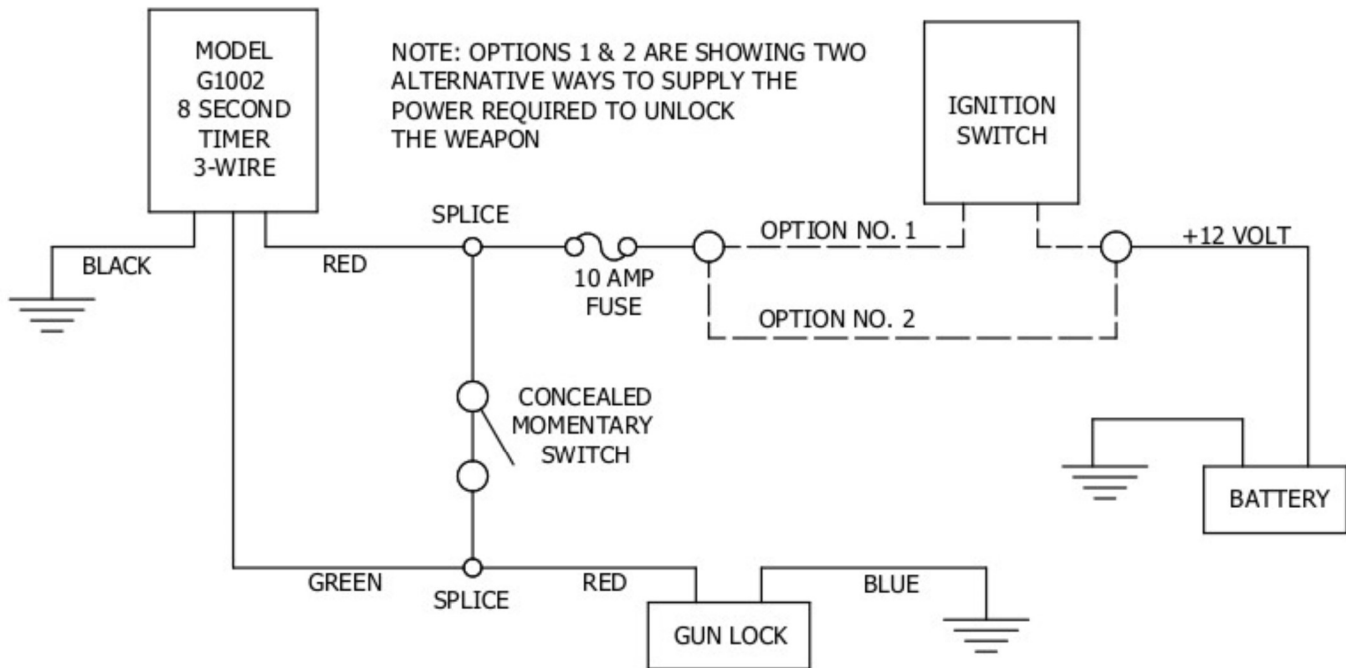

Fig. 4

VI. Install Optional 8 Second Timer (3-wire)

- A. See schematic (Fig. 4)
- B. Note: If for any reason the gun lock momentary switch remains activated, such as, the button is damaged, and/or shorted, the unit will time out in 8 seconds and can not be operated again until the defective switch is repaired, thus saving the gun lock solenoid. DO NOT connect gun lock directly to power for more than 20 seconds!

V. Lock Head Operation Instructions

TO REALEASE THE WEAPON:

- A. Grasp the weapon, but do not pull it against the lid of the gun lock.
- B. While depressing and holding the release button (momentary switch), push and then pull the weapon towards the lid of the gun lock to release it from the lock.
- C. NOTE: One handed operation is possible utilizing the optional 8 second timer. The timer will unlock the lock for 8 seconds following activation of the momentary switch. If the gun is not pulled out of the lock within 8

seconds after activation of the momentary switch, the lock will auto re-lock.

- D. **IMPORTANT:** If lid of the lock does not release, press in on the lid to release tension and reactivate the release button (unless timer is still active).

SECURING THE WEAPON:

- A. Push weapon firmly and completely into the lock mechanism and firmly close lid.
- B. Check to insure that the lid is locked.
- C. If the lid does not lock, re-seat the weapon firmly and completely into the lock assembly and again apply firm pressure to the lock lid to seat and re-lock it.

TO OPEN THE LOCK WITH THE MANUAL OVERRIDE KEY:

- A. Fully insert the handcuff key into the hole provided in the lock head. Turn the key 1/4 turn to the left (counter-clockwise). Pull open the lid or pull on the weapon to open it.
- B. **Important:** Return the key to its original position or remove key completely to close and re-lock the lock.

Installation complete

If you have any problems with this installation or have any questions please call (800-480-6680) and ask for technical assistance.

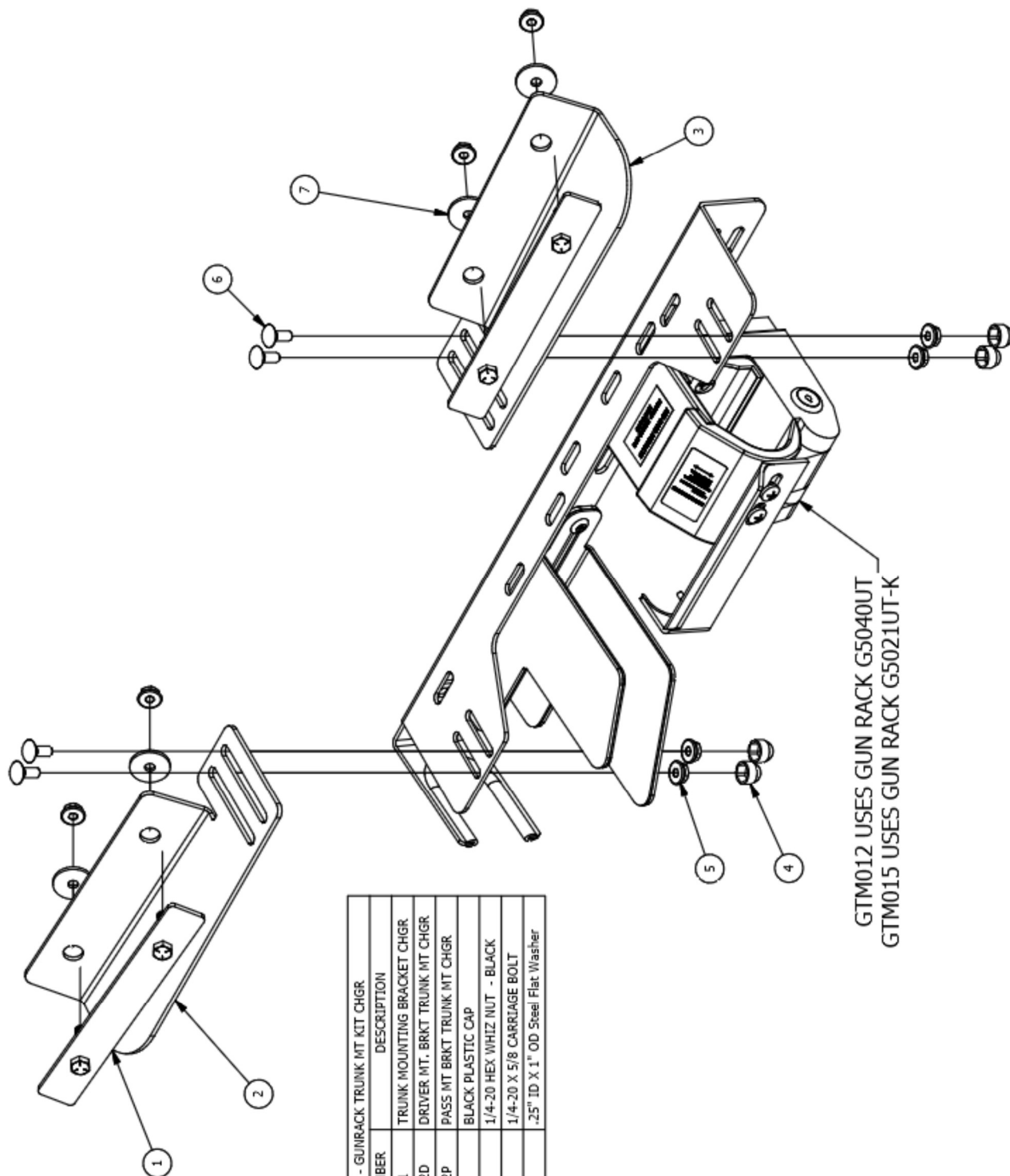

4GKT5614 - GUNRACK TRUNK MT KIT CHGR		
ITEM	QTY	DESCRIPTION
1	2	TRUNK MOUNTING BRACKET CHGR
2	1	DRIVER MT. BRKT TRUNK MT CHGR
3	1	PASS MT BRKT TRUNK MT CHGR
4	8	BLACK PLASTIC CAP
5	8	1/4-20 HEX WHIZ NUT - BLACK
6	4	1/4-20 X 5/8 CARRIAGE BOLT
7	4	.25" ID X 1" OD Steel Flat Washer