

**INSTALLATION GUIDE**  
**G5000 SERIES WEAPON**  
**MOUNTING SYSTEM**

**Pro-gard**<sup>™</sup>  
PRODUCTS LLC.

STRONG | RELIABLE | SECURE

**pro-gard.com**  
**800.480.6680**

THESE COMPONENTS ARE REQUIRED  
TO INSTALL THE PARTITION

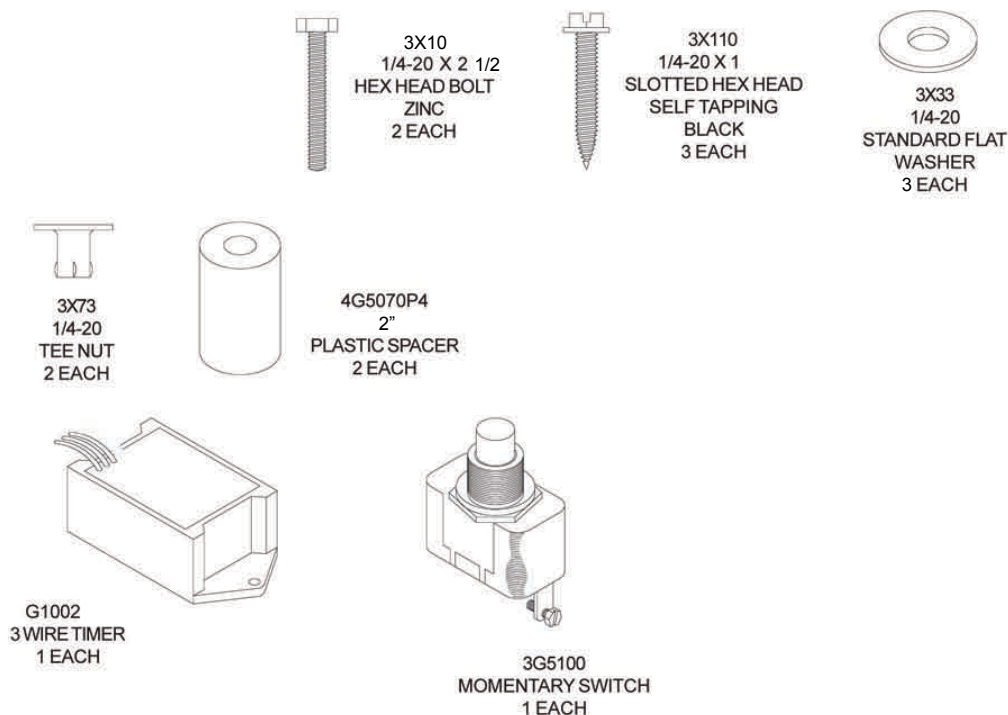

**The following tools will be required to complete the installation.**

A. 7/16" Wrench or Socket

B. 1/2" Wrench or Socket

**NOTE:** This package contains hardware for mounting the gunrack to a Pro-Gard Partition, Screen or flat surface. Hardware for each application varies, don't worry if you have hardware left over.

Flat Surface Mounting.....Page 3  
Pro-Gard Partition Mounting.....Page 4  
Screen Mounting.....Page 5  
Wiring & Testing Instructions.....Page 6

## FLAT SURFACE MOUNTING

- Step 1      The mounting bracket should appear as it does below.
- Step 2      Temporarily place the unloaded, clear chambered weapon in the gunrack. This will help you center the weapon and determine the best location for mounting.
- Step 3      Find a location where the unit can be securely mounted using the three 1/4-20 x 1" Self tapping screws (3X110)
- Step 4      Once the location is found and marked, remove the weapon and start the 1" self tapping screws with corresponding washers as indicated in the illustration below.
- Step 5      Complete the installation by following the wiring instructions at the end of this document.

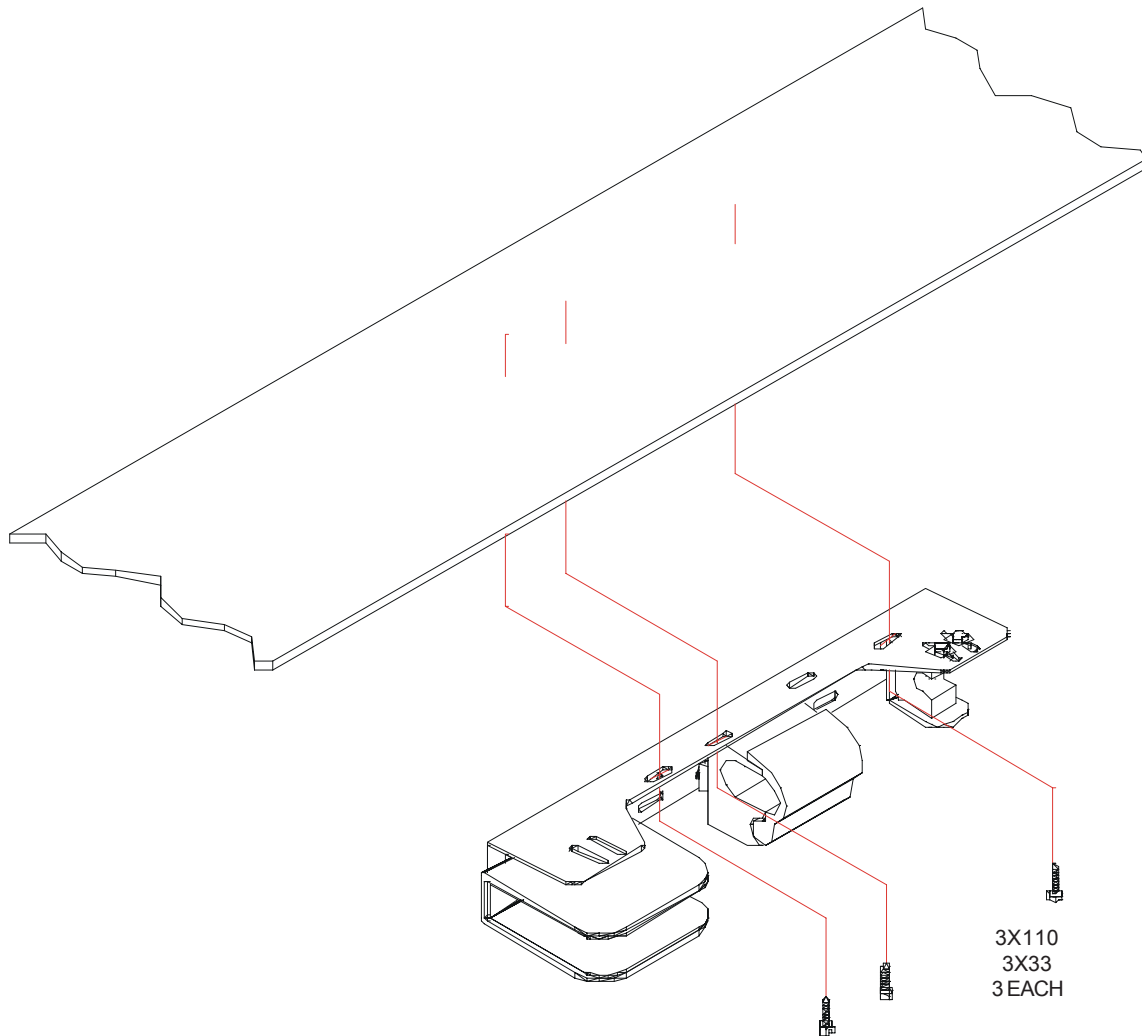

## PRO-GARD PARTITION MOUNTING

- Step 1 Remove the two nuts and bolts on either side of the center mounting bolt of the Pro-gard Partition that hold the aluminum window frame to the partition.
- Step 2 Place the spacers on the back side of the G5000 main frame and the T-nuts through the slots as shown below.
- Step 3 Replace the bolts you removed from the Pro-Gard Partition with two new bolts (3X10, 1/4-20 x 2 1/2"). Push the bolts through the partition and the 2" spacers from the prisoner's side and loosely tighten them into the T-nuts.
- Step 4 Place your unloaded and clear chambered, weapon in the gunrack and center the assembly. Tighten all the bolts now.
- Step 5 Complete the installation by following the wiring instructions at the end of this document.

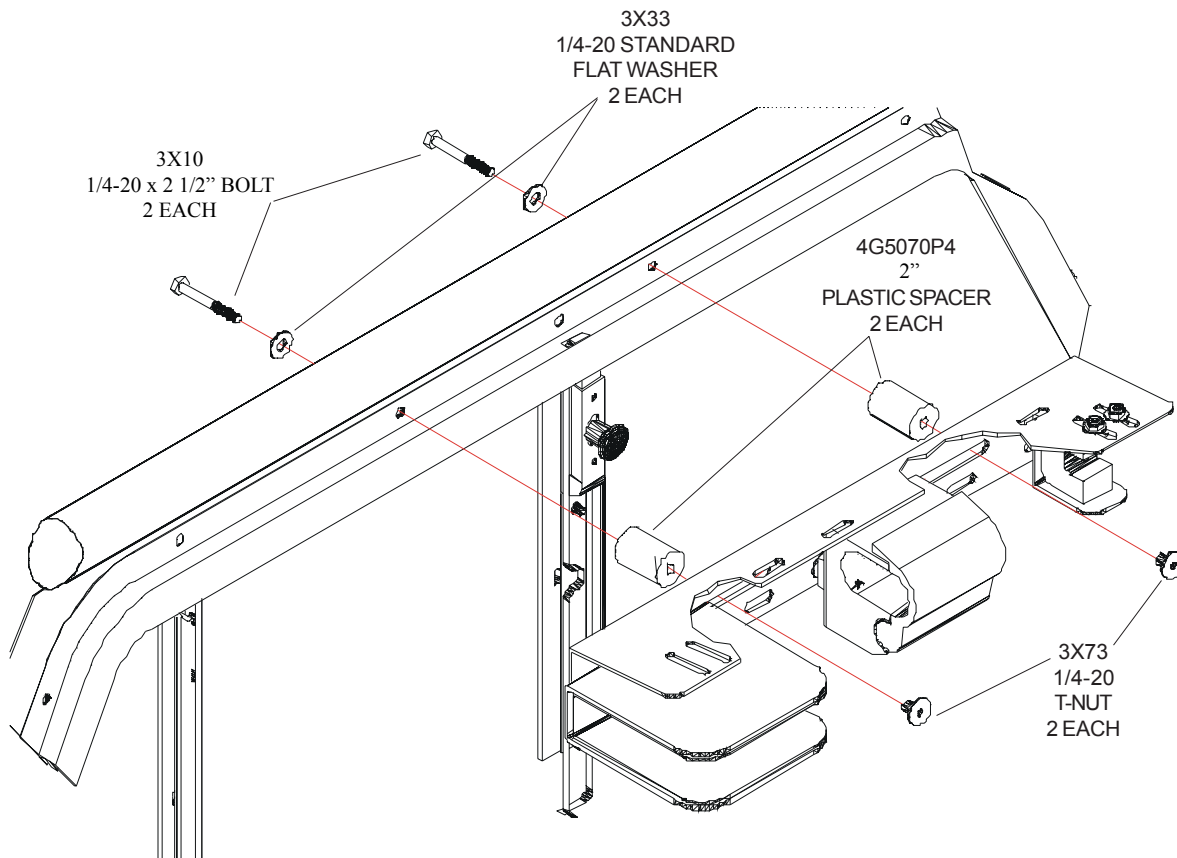

## GUN LOCK SWITCH AND TIMER INSTALLATION

**Step 1** We suggest mounting the momentary release button in a concealed location that can be easily reached by the officer, but would be hidden in case an unauthorized entry occurs.

**Step 2** Connect the gun lock wiring as shown in the diagram below.

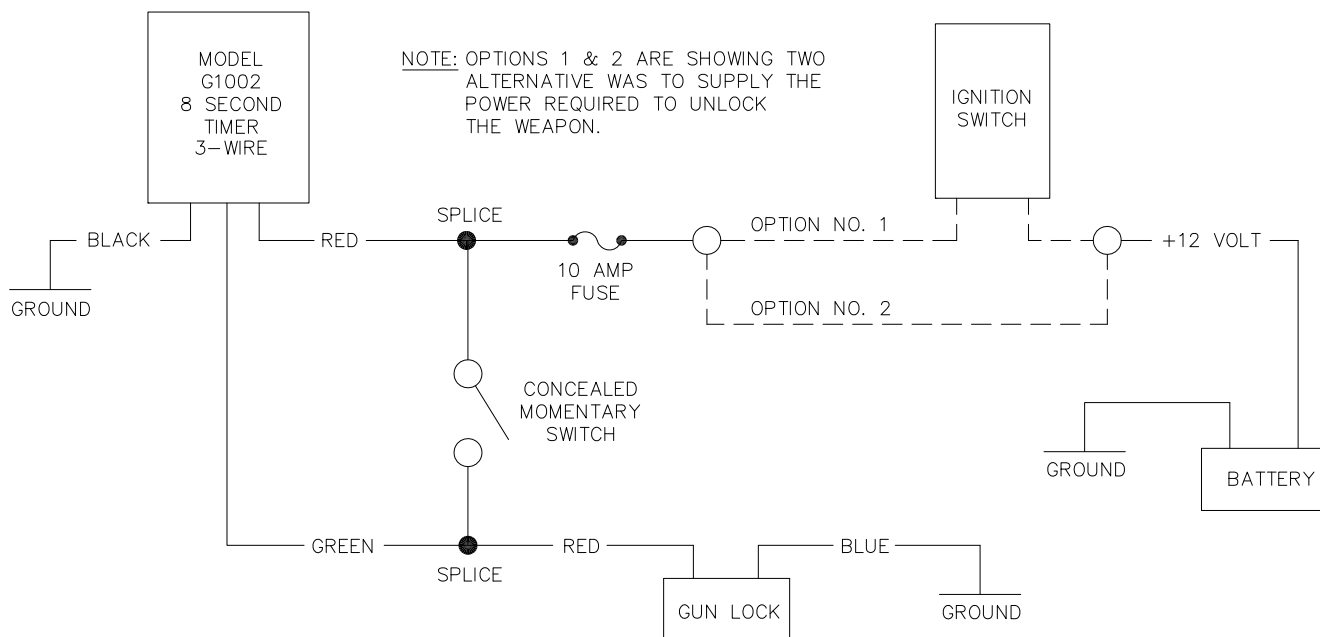

**NOTE:** *Pro-gard requires the use of a 10 AMP fuse between the power source and gun lock circuit or the warranty will be voided!*

## LOCK HEAD OPERATING INSTRUCTIONS

**Step 1** To release, grasp the weapon, but do not pull it against the lid of the gun lock.

**Step 2** While depressing and holding the release button (momentary switch), push and then pull the weapon towards the lid of the gun lock to release it from the lock.

**NOTE:** *One handed operation is possible utilizing the optional 8 second timer. The timer will unlock the lock for 8 seconds following activation of the momentary switch. If the gun is not pulled out of the lock within 8 seconds after activation of the momentary switch, the lock will automatically re-lock.*

**TIP:** *If lid of the lock does not release, press in on the lid to release tension and reactivate the release button (unless timer is still active).*

**Installation Complete!**

**Call Pro-gard technical support if assistance is needed. 1-800-480-6680**