

INSTALLATION GUIDE

**2018+ DURANGO
OUTBOARD SEAT BELTS
4OSBK6718**

Pro-gardTM
PRODUCTS LLC.

STRONG. RELIABLE. SECURE.

**THESE COMPONENTS ARE REQUIRED
TO INSTALL THE OUTBOARD SEATBELTS**

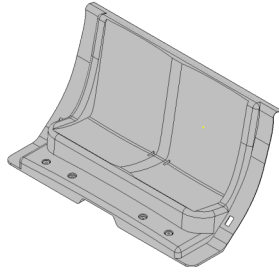

Seat
3S67D18



Barrier
4B67XXD18

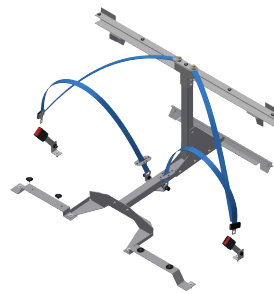

Outboard Seat Belt System
4OSBK6718

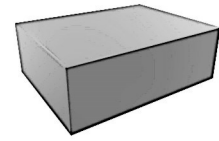

OSB Barrier Wing Kit
4BWK67D18

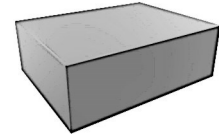

Barrier Kit
4BK6718

I. The following tools will be required to complete the installation

- | | | |
|------------------------------|----------------------------|------------------------|
| A. 7/16, 9/16, & 5/8 Sockets | C. 15mm Deep Well Socket | E. 13mm & 18mm Sockets |
| B. 5/32 Allen Wrench | D. 5/32, 3/16 Allen Wrench | F. 1/2, 5/8 Wrenches |

II. Read all instructions and refer to last page to ensure all parts were received

NOTE: *The barrier and seat must be installed along with the Outboard Seat Belt System.*

WARNING: *Locate All wiring, fuel lines, brake lines, coolant lines, or refrigerant lines before drilling any holes or installing any self-drilling fasteners.*

III. Remove Seats and Cargo Floor

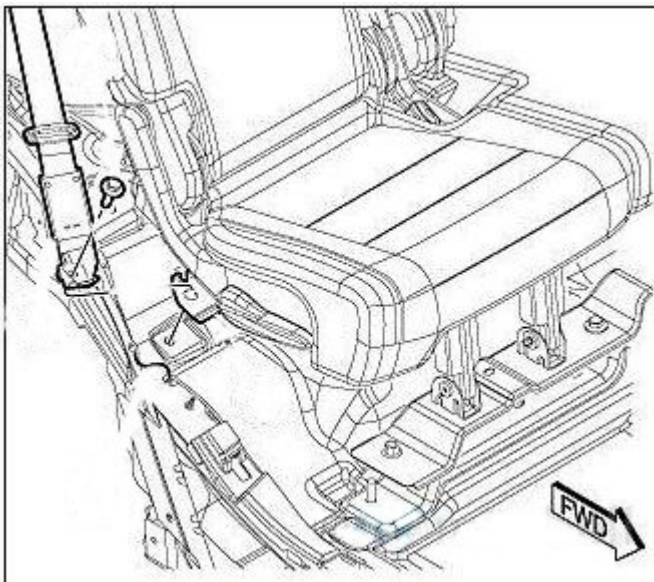

A. Remove 2nd row OEM seat from the vehicle. Find the mounting bolts on the floor, remove with a 18mm socket, and lift seat away from the vehicle.



B. Remove cargo compartments and load floor. Cut and remove two section forward flap along hinge point.

IV. Install Barrier Rear Brackets

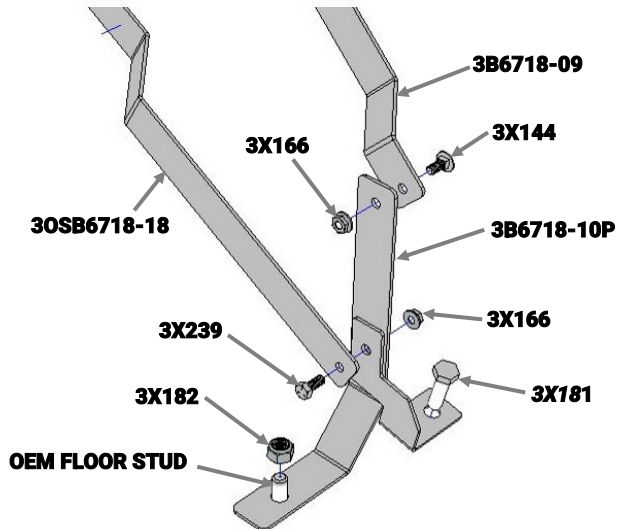

A1. Install rear mounting brackets at cargo floor and angled braces for both sides. . See barrier instructions for more de-

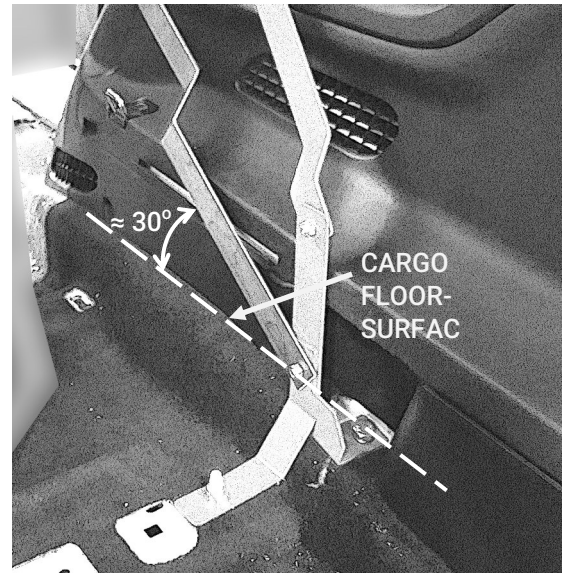

A2. Set lower brackets at approx. 30° to provide clearance notch as detailed in step V.B..

V. Install Rear OSB Bracket and Modify Cargo Compartment

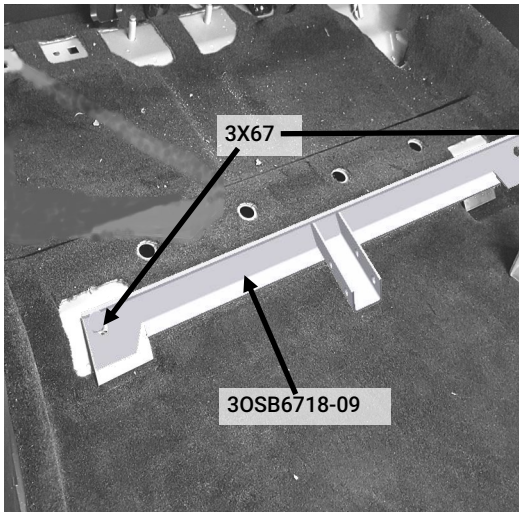

A. Install (30SB6718-09) Rear OSB Bracket to floor, using (3X67) bolts.



B. Trim rectangular opening in center front edge of cargo compartment load-floor 4" back and 3" across to clear 30SB6718-13 upright when installed. Trim slotted locations to clear (2) barrier braces 30SB6718-18.

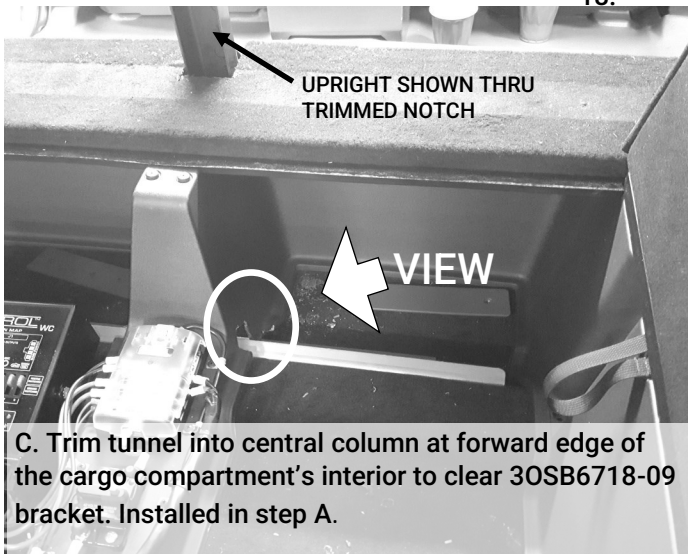

C. Trim tunnel into central column at forward edge of the cargo compartment's interior to clear 30SB6718-09 bracket. Installed in step A.

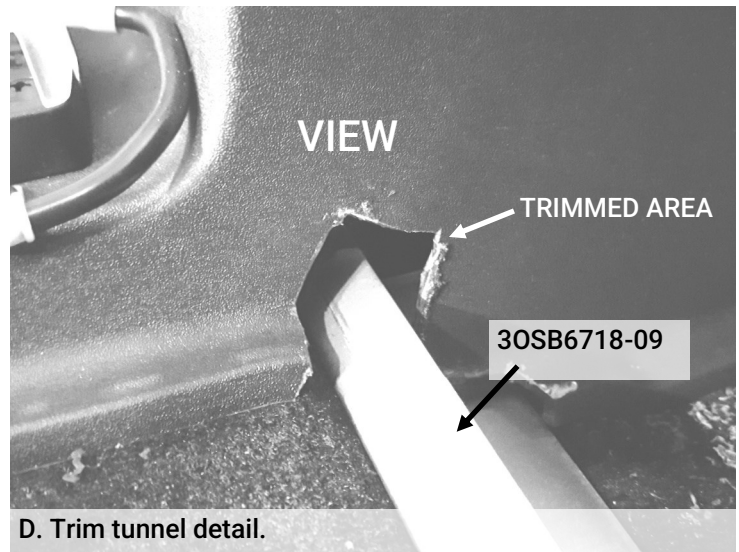

D. Trim tunnel detail.

VI. Install OSB and Seat Support Brackets

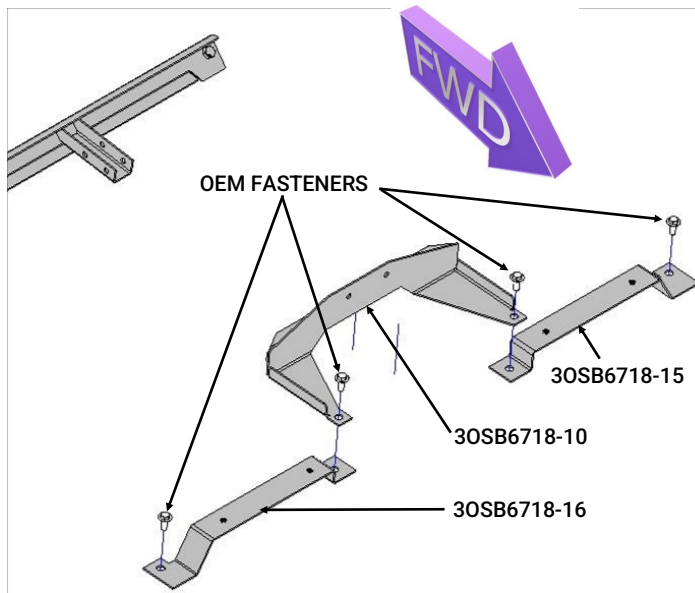

A. Place (in order) passenger (30SB6718-16) and driver side (30SB6718-15) Seat Brackets, and Front OSB Bracket (30SB6718-10) using OEM fasteners.

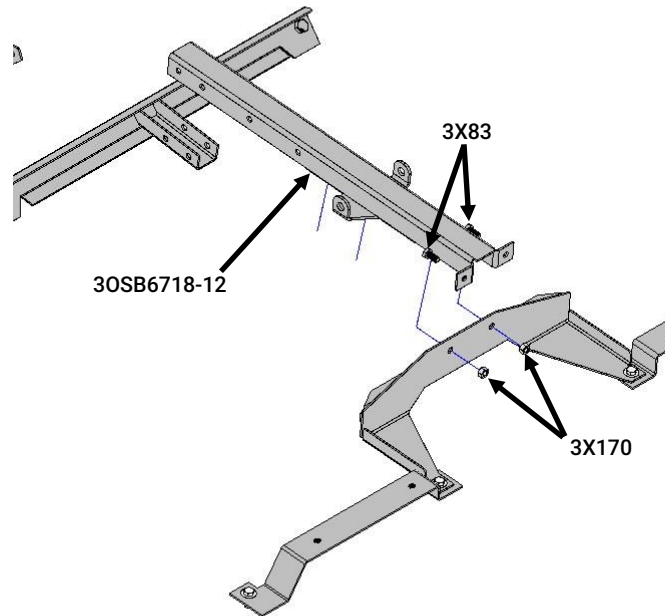

B. Place Middle Bracket (30SB6718-12) using two (3X83) bolts and (3X170) nuts.

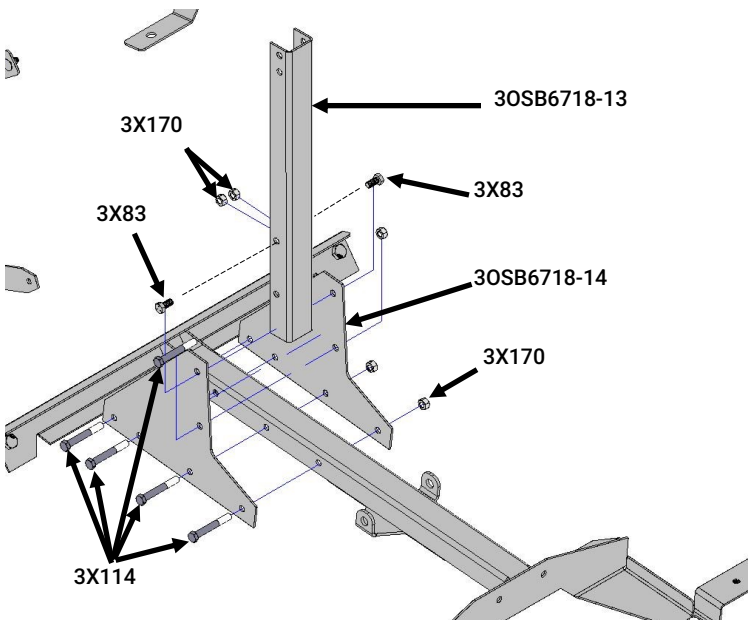

C. Assemble upright and gussets as shown. Please note that the gussets [30SB6718-14] are assembled to upright using 3/8-16 x 2-3/4" bolts [3X114] but one location uses 3/8-16 x 3/4" [3X83] for part clearance. Keep assembly



D. Assembly shown before compartments re-installed.



E. Re-install trimmed front cargo compartment rear compartment and load floor.

VII. Install Barrier (See Instructions) .

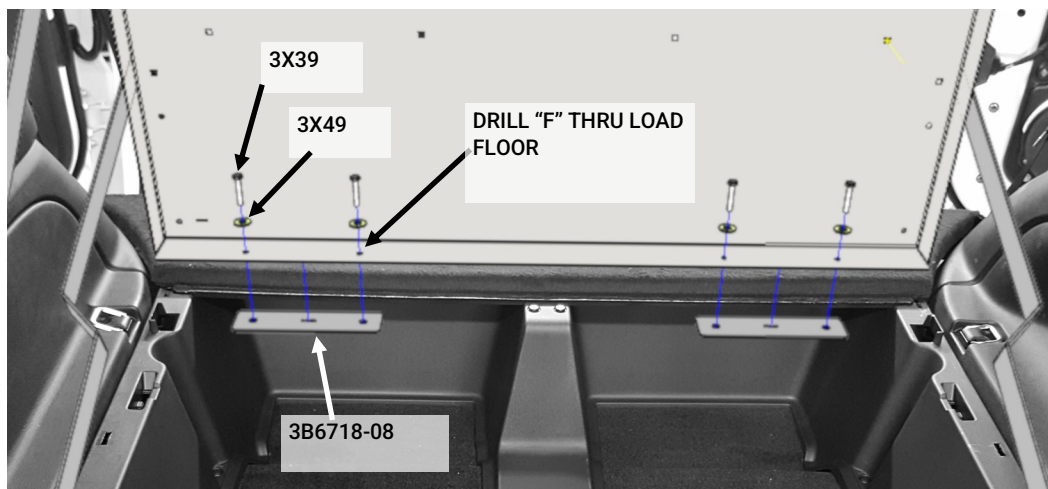

VIII. Install Seat and Seat Belts .

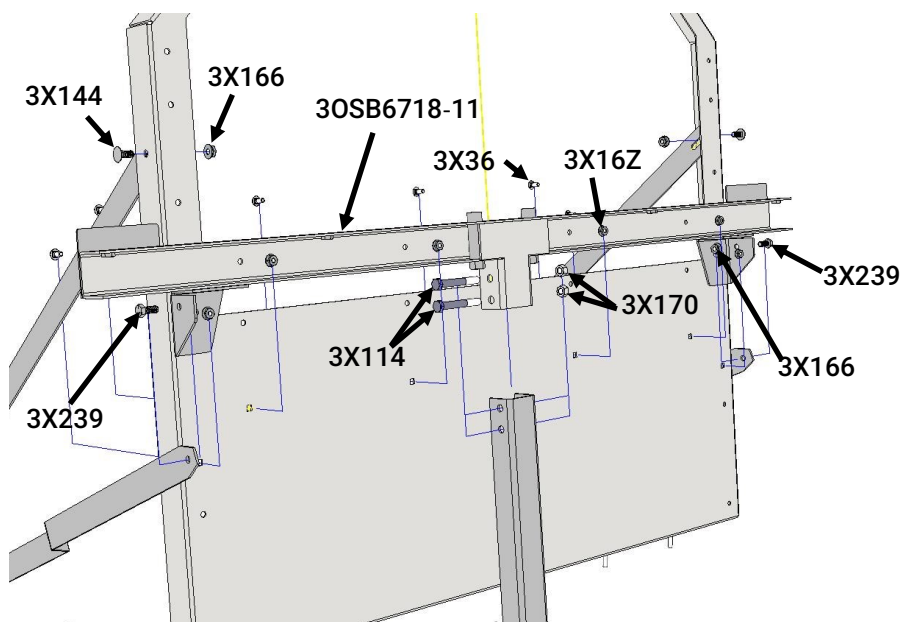

A. Install Main Crossbar (30SB6718-11) to barrier using six sets of (3X36) carriage bolts and (3X16Z) whiz nuts. Attach Rear Braces (30SB6718-18) to ends of (30SB6718-11) Main Crossbar with (3X239) bolts and (3X166) whiz

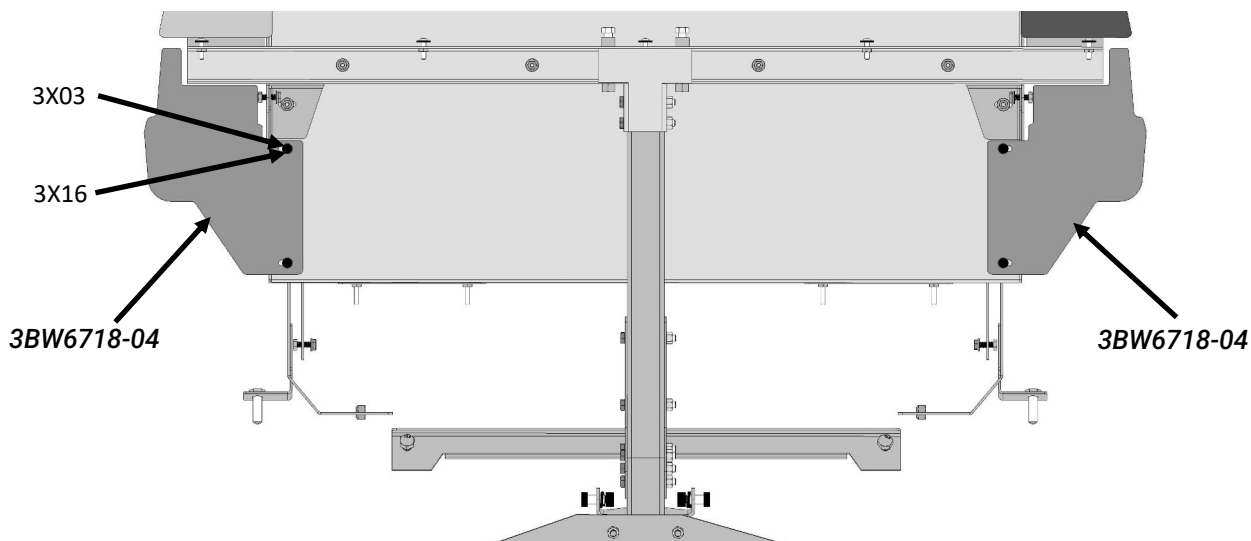

B. Install lower wings 3BW6718-04 and fasten using four sets of (3X03) bolts and (3X16) nuts.



C. Place the seat loosely inside the vehicle. Pass the seat belt through the (3S5003) seat belt bezels, then through the rectangular holes in the middle of the seat.

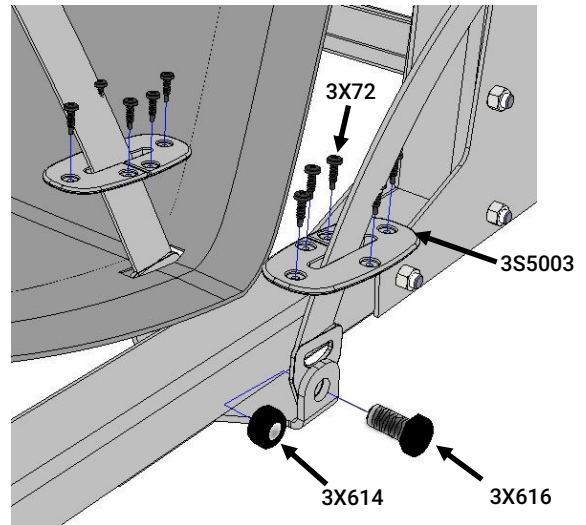

D. Bolt the seat belts in place on the middle brace using (3X616) bolt and (3X614) nut.

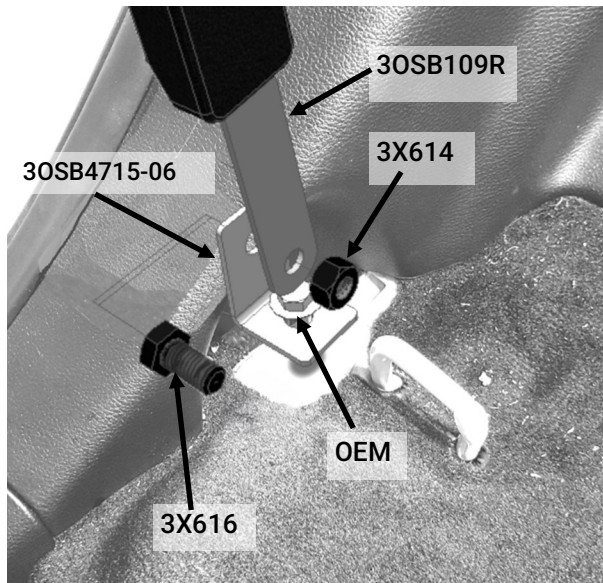

E. Bolt end release buckle using side L-brackets and OEM fasteners

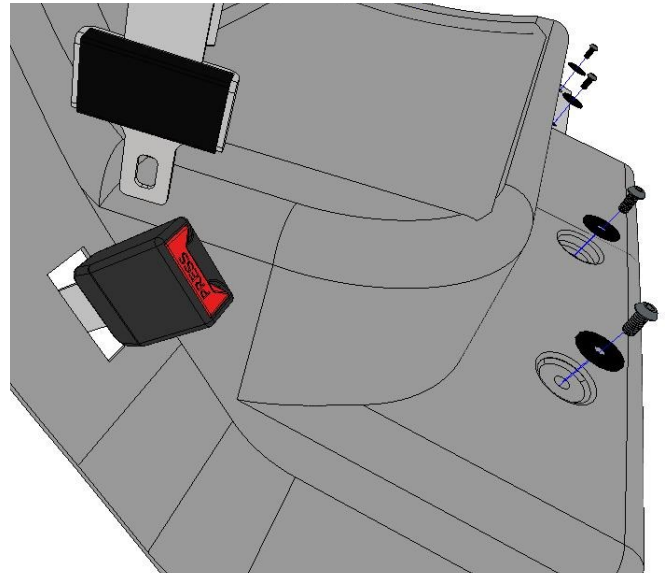

F. Tilt seat into place, ensuring the buckles project through the openings at outer ends.

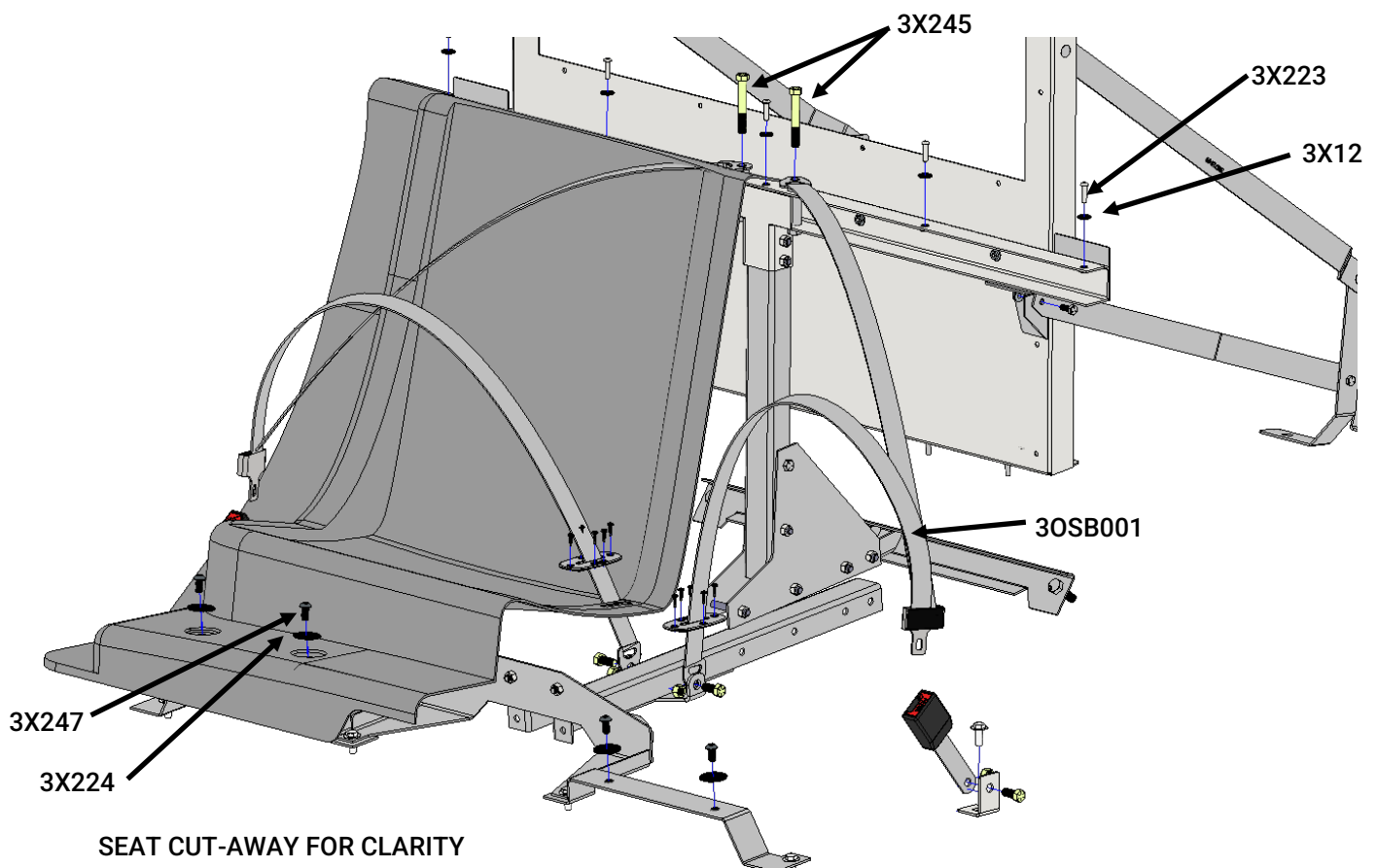

G. Secure seat at top and floor as shown. Bolt seat belts at center top of seat. Quickly test the seat belts and do any adjustments needed, making sure the belt pull straps go down over the chest when installed.

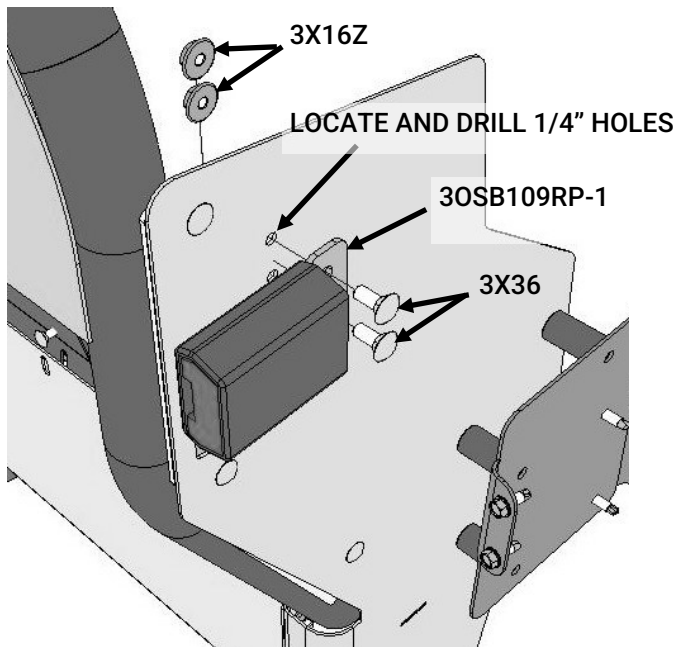

H. Locate belt buckles (30SB109RP-1) on partition mounting panels. Location is approximate.



I. OSB system fully installed.

Installation complete

If you have any problems with this installation or have any questions please call (800-480-6680) and ask for technical assistance.

PARTS LIST		
ITEM	QTY	PART NUMBER DESCRIPTION
1	1	30S86718-11 Main Weldment, Durango OSB
2	1	30S86718-13 Durango OSB Upright
3	2	30S86718-14 Gusset, Durango OSB
4	1	30S86718-12 Weldment, Durango OSB Mid Belt
5	1	30S86718-10 Weldment, Durango OSB Front Bracket
6	1	30S86718-09 ASSY, DURANGO OSB REAR BRACKET
7	1	30S86718-15 BRACKET ASSY, DURANGO LWR SEAT MNT DS
8	1	30S86718-16 BRACKET ASSY, DURANGO LWR SEAT MNT PS
9	8	3X114 3/8-16x2.75, HEX CAP SCREWS, GR 8, YZ
10	11	3X170 3/8-16 HEX NUT YZD
11	2	3X245 7/16-20X3 HEX CAP SC GR8 PLTD
12	5	3X12 1/4 FLAT WASHER, BLACK
13	5	3X223 1/4-20 X 1 BHCS
14	4	3X224 3/8 x 1 1/2 Washer
15	4	3X83 3/8-16 x 3/4" HHCS G5 ZN
16	4	3X247 3/8-16 x 3/4" BHCS BO
17	10	3X36 1/4-20 X 5/8 CARRIAGE BOLT
18	10	3X162 1/4-20 LARGE HEX WHIZ NUT-ZINC
19	2	SEATBELT UTILITY/DURANGO
20	1	3667D18 SEAT, DURANGO
21	2	30S8109RP CUSTOM SEATBELT BUCKLE FOR OSB KITS
23	2	30S86718-18 BRACE, DURANGO OSB REAR
24	4	3X239 5/16-18 X .75 HHCS GR5 ZN
25	4	3X166 5/16-18 LARGE HEX WHIZ NUT-ZINC
26	2	30S84715-06 SIDE L BRACKET
30	2	35S003 TRANSPORT SEAT BEZEL
31	10	3X72 #8 X 5/8 PHILIPS TRUSS HD
32	2	3X67 M12 x 1.75 x 40mm, Class 10.9 Zn
33	4	3X616 7/16-20 X 1" GRADE 8 BOLT
34	4	3X614 7/16-20 GRADE 8 LOCK NUT
36	2	30S8001 3-POINT BELT
37	2	30S8109RP-1 PARTITION BUCKLE

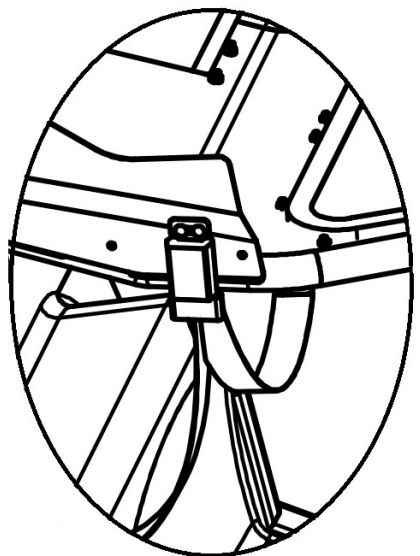

DETAIL A - ASSEMBLED

