

INSTALLATION GUIDE

**2015-2020 CHEVY TAHOE
OUTBOARD SEAT BELTS
4OSBHK5715**

Pro-gard[™]
PRODUCTS LLC.

STRONG. RELIABLE. SECURE.

**pro-gard.com
800.480.6680**

THESE COMPONENTS ARE REQUIRED
TO INSTALL THE OUTBOARD SEAT BELTS

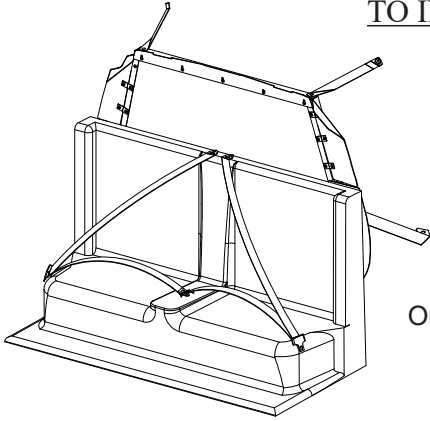

Outboard Seat Belt System
Part # 4OSBK5715

This system requires the barrier and transport seat to be installed.



Part # 4OSBHK5715

I. The following tools will be required to complete the installation.

7/16 Socket

9/16 Socket

18mm Socket

T-50 Torx Bit

Phillips Screwdriver

5/32 Allen Wrench

1/16 Socket

II. Read all instructions carefully and refer to BOM on page 6 to ensure all parts were received.

NOTE: *The standard transport seat can be upgraded with the Outboard Seat Belt System by ordering the 4OSBK5715 kit. Remove the standard seat, upper seat support bar, and seat belt brackets from the vehicle and proceed by following the instructions to complete the OSB installation.*

CAUTION: *The Tahoe barrier must be installed before the Outboard Seat Belt System.*

III. Seat Belt Support Bracket & Cross Bar Installation.

- A. Remove the 2nd row OEM seat from the vehicle. Find the mounting nuts on the floor board and remove with a 18mm socket. Remove the screws on the barrier that hold the bottom portion of the window. Place the support bar assembly into position on the bench (Fig. 1) and use the supplied (3X06) Phillips head screws to hold the outboard seat belt cross bar to the barrier. The two center bolts go in backwards and thread into weld nuts in the cross bar. Now install the barrier into the vehicle using the barrier install instructions provided with the barrier kit.

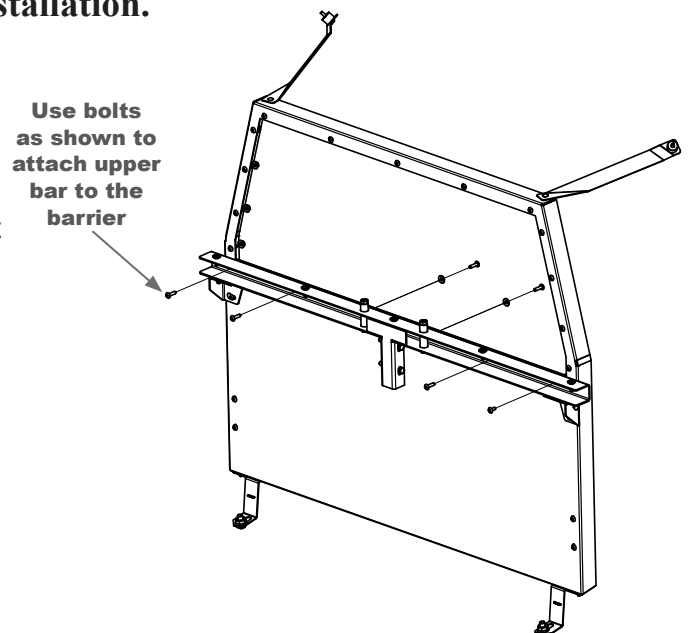
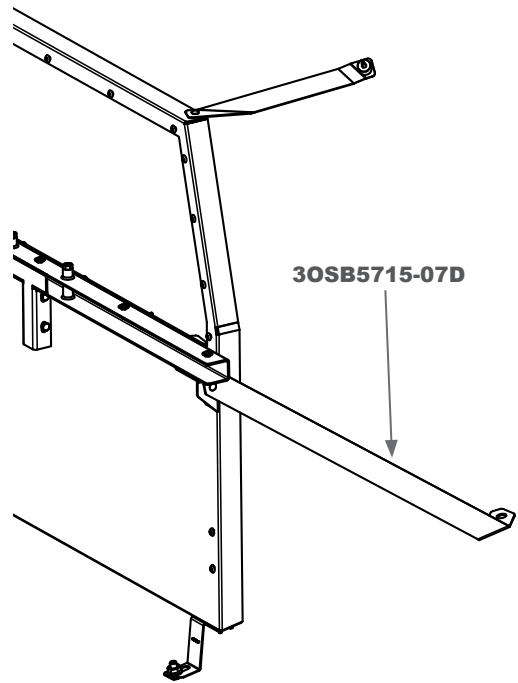
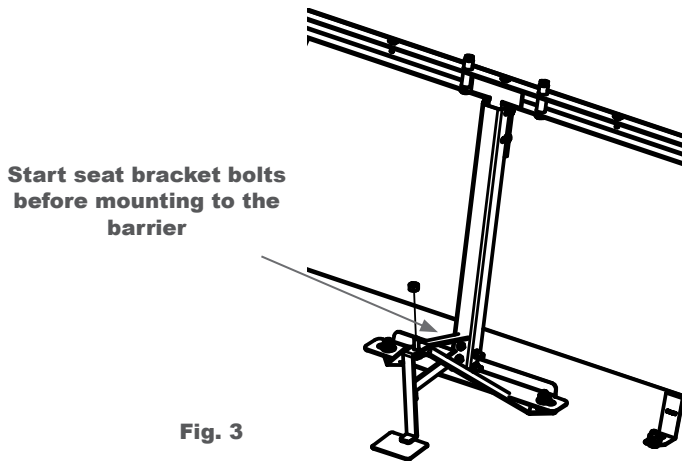
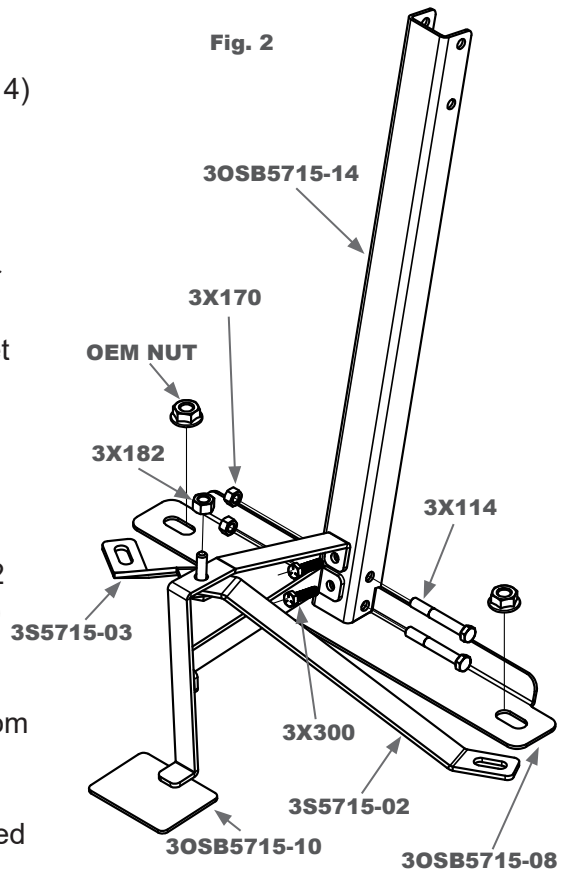

Fig. 1

B. Outside of the vehicle, assemble the lower portion of the support bar assembly. Connect the lower U-channel (3OSB5715-14) to the (3OSB5715-08) using the bolts (3X114) and nuts (3X170). Then attach 3S5715-02 & 03 to the seat belt mounting bracket (3OSB5715-10) by inserting the stud of (3S5715-03) through the holes on the other two brackets, and loosely securing the brackets together with a (3X182) nut. Now attach the seat belt mounting brackets to the lower support bar assembly using two (3X300) bolts. The bolts go through the two hole locations in the (3OSB5715-10) bracket and thread into the weld nuts on (3OSB5715-08). (Fig. 2)

C. Proceed by inserting the assembled Lower support bar assembly over the two middle OEM studs at the base of the barrier. The studs go through the corresponding holes of the 3OSB5715-08 bracket, then through the holes of 3S5715-02 & 03. (As shown in Fig. 3) Use the two 3/8-16 bolts (3X114) and nuts (3X170) to secure the support bars together. The OEM nuts are reused on the OEM studs. Now tighten all of the fasteners securely, except 3X182, starting from the bottom to the top.

D. Now the side brackets (3OSB5715-07 D & P) can be attached to the cross bar and barrier. Use the provided carriage bolts (3X36) and whiz nut (3X16Z) to secure brackets. (Fig. 4) The other end of this bracket will line up with 12 mm OEM holes in the floor board in the cargo area. Tighten all fastener to secure parts in location.



E. At this point, the barrier wings should be installed starting with the bottom wings 4BW5715-03 & 04, which slide over the support bar assembly attached to the barrier. The two bottom hole locations utilize 3X03 bolts, however the top hole locations use a 3X05A bolt to attach the wings to the barrier with 3X12 washers and 3X16 nuts. The Upper wings are attached to 3B929 brackets using 3X03 bolts and 3X16 nuts. The other end of the brackets are attached to the barrier using 3X05A bolts, 3X12 washers and 3X16 nuts. The headliner wing 4BW5715-05 is attached to the barrier using 3X05A bolts, 3x12 washers and 3X16 nuts. (Fig. 5)

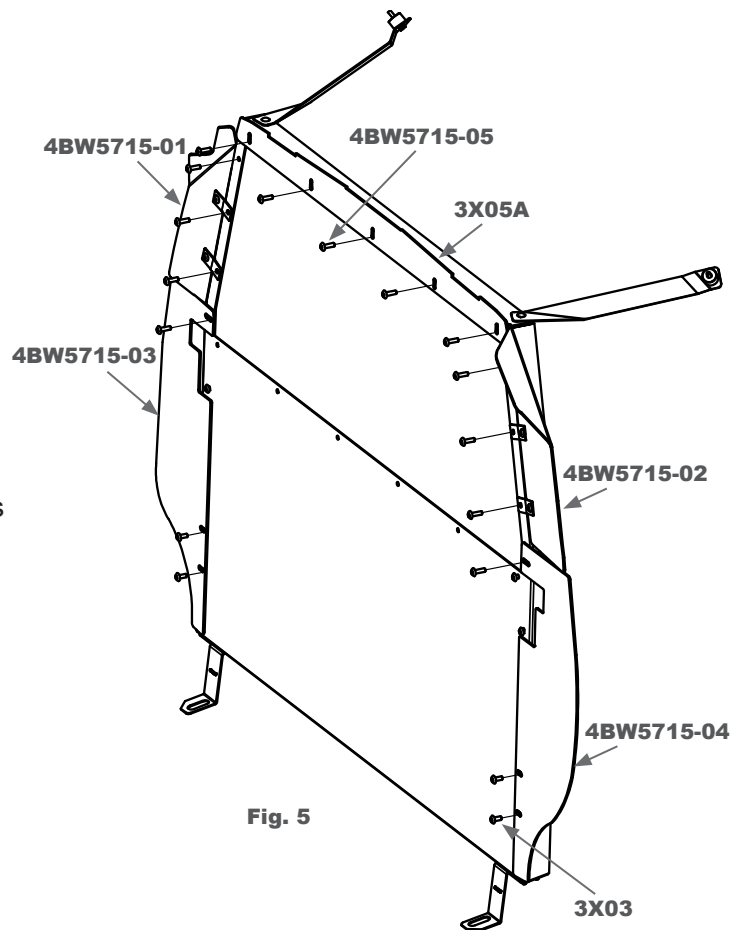

Fig. 5

F. The lower seat belt buckle should be installed at this time and before seat installation. Remove the OEM seat belt by using a torx bit driver and feed the belt behind the trim hidden away. The new lower buckles bolt right into these OEM belt locations on the passenger and driver side C-pillars using the OEM fasteners as shown in figure 6 and the main BOM diagram.

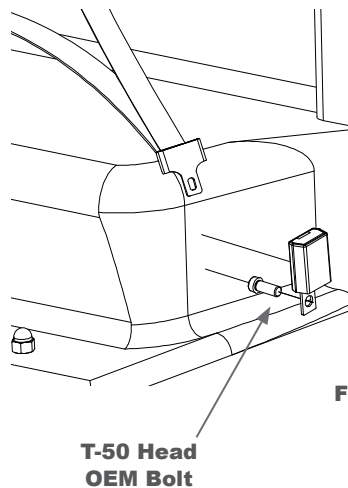

Fig. 6

IV. Seat and Seat Belt Installation.

A. First, use the provided template on the last page to cutout the seat for the outboard seat belt standoffs. Remove the 3X182 nut before installing the seat, and then place the seat loosely inside the vehicle. Place bolts through the seat belt mounting points to see how they line up with the seat. Quickly test the seat belts and do any adjustments needed before bolting in place. Make sure the belt pull straps go down over the chest when installed.

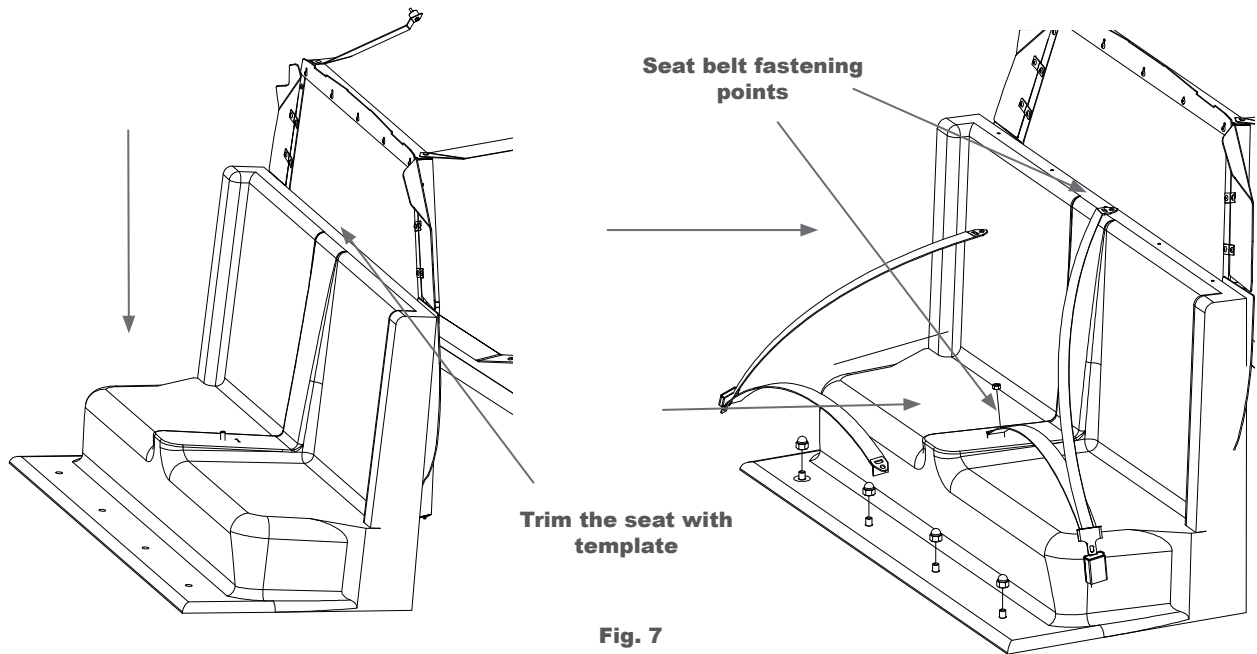

Fig. 7

- B. The seat belts are mounted in two places by the supplied bolts (3X238) and (3X182) nut. One mounting point is in the center of the vehicle coming off of the middle of the transport seat. The other is at the top of the cross bar where the standoffs are located. It is only necessary to start the fasteners at this point and move onto fastening the seat in place. (Fig. 7)
- C. Insert the 1/2" plastic spacers (4S5070P1) underneath the seat to allow the acorn nuts to properly tighten. The seat is secured by installing the 5 bolts (3X223) and washers (3X12) at the top of the seat and the 4 acorn nuts (3X183) and washers (3X260) at the floor of the seat.
- D. Now the partition seat belt buckle bracket should be attached to a convenient place on the driver and passenger side panels allowing the seat belt to be placed in the open position. The open seat belt position allows the user easy access while loading passengers into the back seat belt system. (Fig. 8)

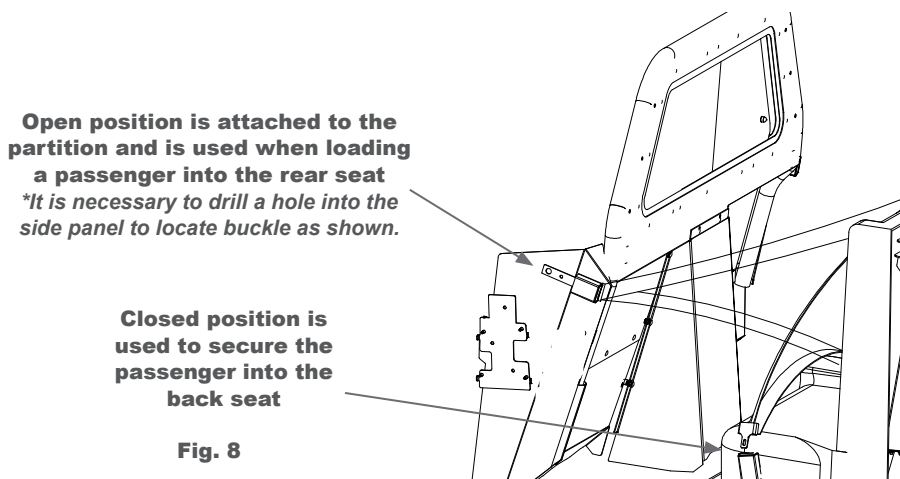

Fig. 8

Installation complete!

If you have any problems with this installation then call the toll free number (800-480-6680) and ask for technical assistance.

2015 Tahoe Outboard Seat Belts

OSB PARTS LIST			
ITEM	QTY	PART NUMBER	DESCRIPTION
1	1	3OSB5715-01	UPPER WELDMENT
2	1	3OSB5715-07D	DRIVER SIDE BRACKET
3	1	3OSB5715-07P	PASSENGER SIDE BRACKET
4	1	3OSB5715-08	LOWER WELDMENT
5	1	3OSB5715-10	SEAT BELT MOUNTING BRACKET
6	1	3S5715-02	SEAT SUPPORT BRACKET, DRIVER
7	1	3S5715-03	SEAT SUPPORT BRACKET, PASS
8	2	3OSB001	3 POINT SEAT BELT HARNESS
9	2	4OSB5715-15	LOWER BUCKLE
10	2	3OSB109RP-1	PARTITION BUCKLE
11	2	4OSB5715-16	PLASTIC COVERS
12	1	3OSB5715-14	LOWER U CHANNEL

ADDITIONAL REQUIRED ITEMS			
ITEM	QTY	PART NUMBER	DESCRIPTION
30	1	3S5715	TRANSPORT SEAT
31	1	4B57XXT15	BARRIER (PART NUMBER MAY DIFFER)
32	1	4BHK5715	BARRIER KIT

OSB FASTENER LIST			
ITEM	QTY	PART NUMBER	DESCRIPTION
13	6	3X170	3/8-16 Hex Nut
14	6	3X36	1/4-20 X 5/8 CARRIAGE BOLT
16	6	3X16Z	1/4-20 WHIZ NUT
17	4	3X183	M12 X 1.75 Hexagon Domed Cap Nut
18	1	3X182	M12 X 1.75 NYLON HEX NUT
19	4	3X114	3/8-16x2.75, HEX CAP SCR, GR8, YZ
20	7	3X12	1/4 FLAT WASHER, BLACK
21	5	3X223	1/4-20 X 1 BHCS
22	4	3X260	1/2 ID X 1 3/4" OD WASHER
23	4	4S5070P1	1" DIA X 3/8" BLACK SPACER
24	6	3X06	1/4-20 X 3/4 PHIL TRUSS HD MS
27	2	3X222	M10 X 1.5 X 35MM BHCS
28	2	3X224	3/8 x 1 1/2 Washer
29	8	3X72	8-32 X 5/8 PHIL PAN HD MS
33	2	3X245	7/16-20X3 HEX CAP SC GR8 PLTD
34	2	3X300	Zinc-Plated, 5/16"-18 Thread Size, 1-1/4" Long
35	2	3X25	5/16-18 X 1/2 HEX HD CAP SCREW
36	2	3X166	5/16-18 LARGE HEX WHIZ NUT-ZINC

The two plastic covers can be used to close the OEM seat belt opening in the c-pillars. Use the four screws to secure to c-pillar trim.

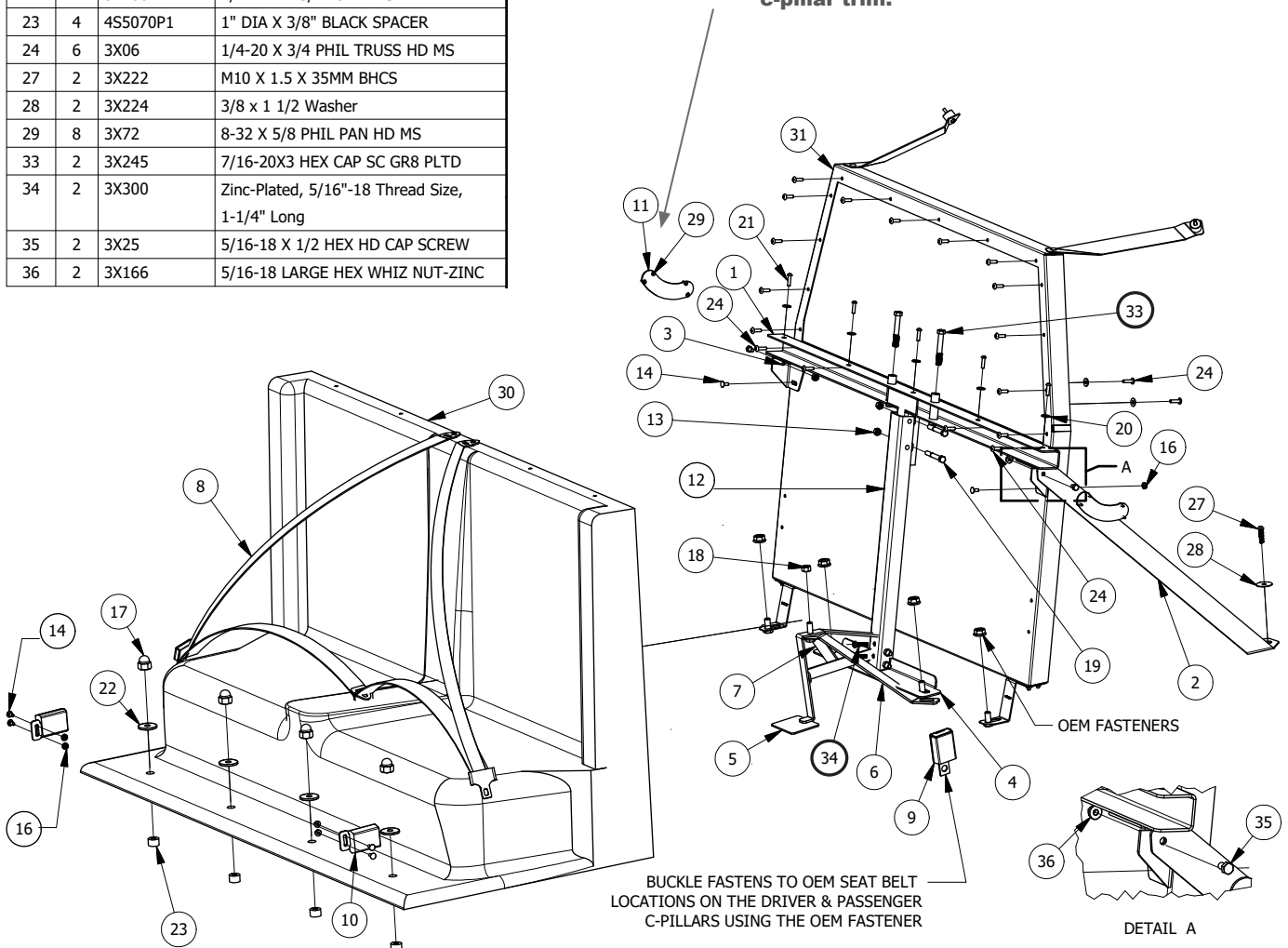

2015 Tahoe Outboard Seat Belt Template

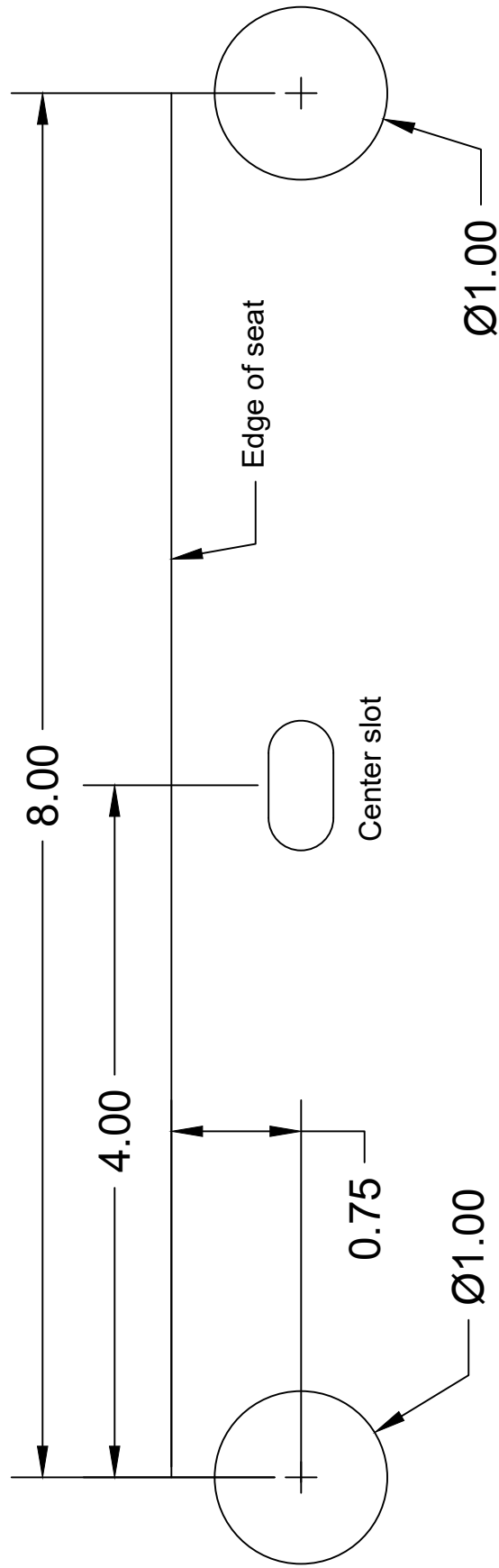

1. Locate the center slot at the top of the transport seat and align with template.
2. Mark the center points of the two 1.00" dia. holes as shown.
3. Use a 1.00" hole saw to make holes into the plastic seat for the seat belt standoffs.