

INSTALLATION GUIDE

2013 - CURRENT SEDAN

INTERCEPTOR

OUTBOARD SEAT BELTS

4OSBK3613

Pro-gard[™]
PRODUCTS LLC.

STRONG | RELIABLE | SECURE

pro-gard.com
800.480.6680

THESE COMPONENTS ARE REQUIRED
TO INSTALL THE OSB SEAT BELT

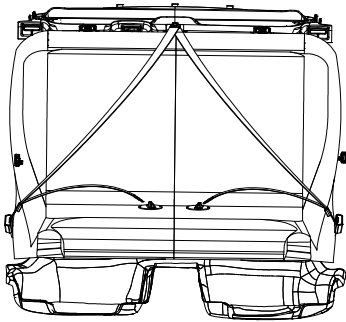

Outboard Seat Belt System

Part # 4OSBK3613

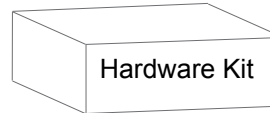

Part # 4OSBHK3613

I. The following tools will be required to complete the installation.

- | | | |
|-------------------------|----------------------|----------------|
| A. 3/8 Socket | E. 9/16 Socket | I. 3/4 Socket |
| B. 7mm Socket | F. T-15 Torx Bit | J. 15mm Socket |
| C. Phillips Screwdriver | G. 5/32 Allen Wrench | K. 13mm Socket |
| D. 7/16 Socket | H. 3/8 Socket | |

II. Read all instructions carefully and refer to the last page BOM to ensure all parts were received.

CAUTION: *Locate All wiring, fuel lines, brake lines, coolant lines, or reffridgerant lines before drilling any holes or installing any self-drilling fasteners.*

III. Removing The OEM Seat.

NOTE: *Before removing the seat and installing the floor pan, it would be beneficial to install the partition B-pillar brackets and trim pieces so no interference occurs with the floor pan installation. Refer to the partition kit instructions at this time.*

- A. Lift the lower seat cushion out from the rubber grommets in the floor board. Once the front of the seat is free, shove back on the seat to release from wire retainers holding the rear part of the seat in place. Remove the seat cushion from the vehicle.
- B. Remove the OEM seat belts by removing the OEM nuts from their mounting studs. The shoulder straps can be set aside until the rear deck trim removal step in a later section.
- C. Remove the OEM rear seat back cushion by removing four OEM fasteners from the lower mounting brackets near the outside of the reinforcement frame. Release the top rear seat from it's latching brackets by pulling the release cable located in the trunk.

D. Remove the OEM latching brackets from the rear deck face.

E. With the seat removed, the OEM child restraint loops are exposed. Remove the child restraint loops or bend them downward toward the floor.

NOTE: *This is necessary for the Pro-gard transport seat to fit properly in position.*

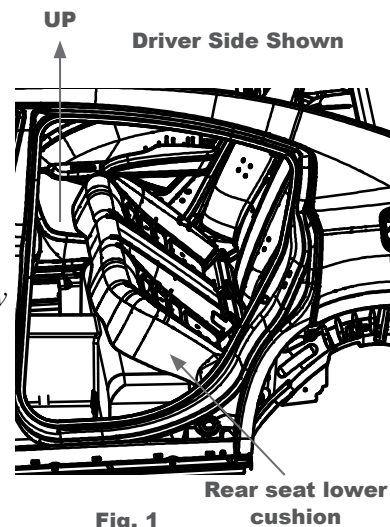

IV. Installing The ABS Floor Pan.

A. Place the ABS floor pan in the vehicle, making sure there are no objects underneath. Tuck the edges of the floor pan under the OEM B-pillar trim. The rear edges of the floor pan should be flush with the OEM scuff panels. Insure the floor pan is all the way back and down against the rear seat.

NOTE: *If using the OEM **Raceway** wiring cover: Remove the OEM **Raceway** and place the ABS floor pan underneath the vehicle wiring. (See seat with **Raceway** install note Sec. VI.) Alternatively, you may place the ABS floor pan over the vehicle wiring. This should be determined by installer guidelines and/ or end user request.*

V. Installing Drain Plugs in Floor Pan.

A. The *Optional* drain plugs can be installed at the customers discretion. (**Check for fuel lines and/ or wiring before you drill!**) To install the drain plug, mark the plug location from the vehicle onto the ABS floor pan. Use 1 1/2" hole saw to drill the plug hole. Reinstall the ABS floor pan into the vehicle, then install the rubber grommet through the vehicle and ABS floor pan.

VI. Installing The ABS Transport Seat and OSB Brackets.

A. Remove the rear deck trim cover to expose the sheet metal underneath as shown in Figure 2. Install the OSB upper bracket (3OSB3615-14) and OSB lower bracket (3OSB3615-12) by using the threaded studs, (3X120) nuts, and (3X121) washers to sandwich the two brackets between the vehicle rear deck sheet metal. (See Fig. 3)

B. Remove the lower C-pillar seat covers on the passenger and driver sides to exposes the under sheet metal. Install the upper

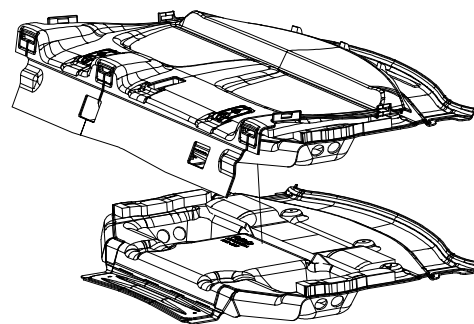

mounting clips (3S3611-21) by matching the bracket's circular edge to the rounded portion of the C-pillar trim with the bolt hole. The angle on the front of the bracket should align with the door seal. When the position is correct, use the 4 self tapping screws to secure to the C-pillar sheet metal. Do this for both sides. (See Fig. 4)

C. Remove or hide the OEM seat belt retractors on the rear deck area as these will not be needed. Reinstall deck trim cover over top of the OSB bracketry. The bracket should fit through the center child restraint trim. Remove the restraint plastic clip portion allowing the bracket to protude through the hole.

D. If the vehicle has the optional OEM Raceway wiring bracket, then flip the seat upside down to locate the cut line. The light cut line is at the bottom middle of the seat and fits the raceway when trimmed out.

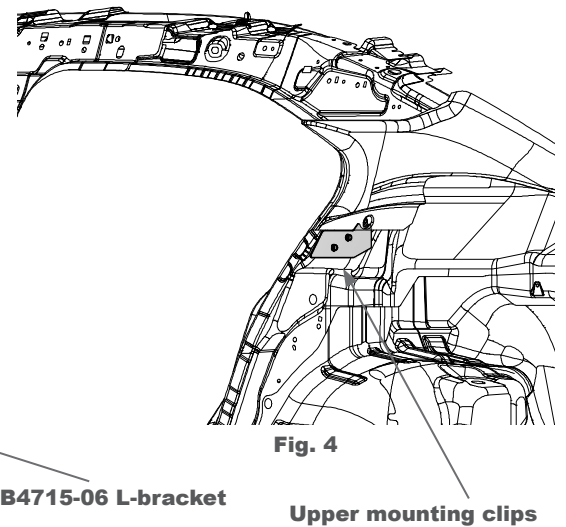
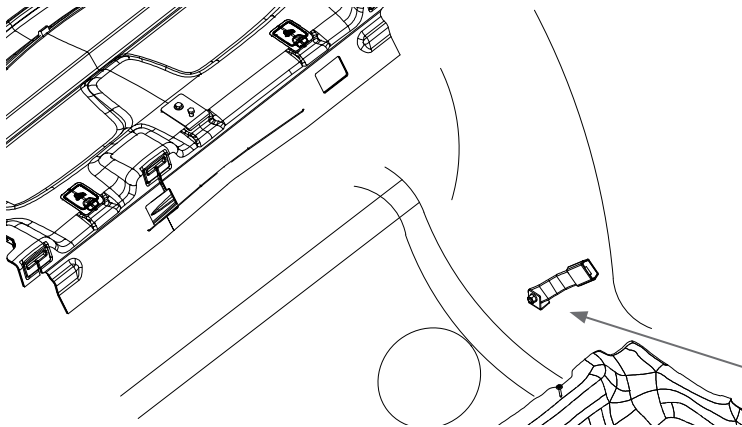
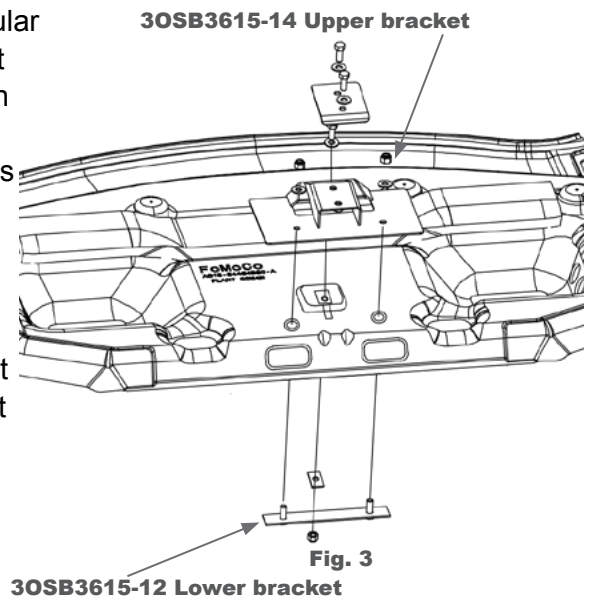

NOTE: *If installing in a 2017 - Current model Sedan Interceptor, then the lower seat belt buckles will need to be relocated due to a 2017 vehicle change.*

E. Lower Seat Belt Buckle Installation

2013 - 2016: At this time the lower seat belt buckles should be installed. Use the (3OSB4715-06) L-brackets to mount the buckles to the OEM fastener location at the bottom of the C-pillars. Reuse the OEM bolt from the previous seat belt removal step. (See Fig. 5)

2017 - CURRENT: Use the (3OSB4715-06) L-brackets to mount the buckles to the OEM fastener location at the bottom of the C-pillars. Reuse the OEM, self-threading bolt from the previous seat belt removal step by installing it with an **impact wrench**. (See Fig. 6)

Fig. 6
PASSENGER SIDE SHOWN

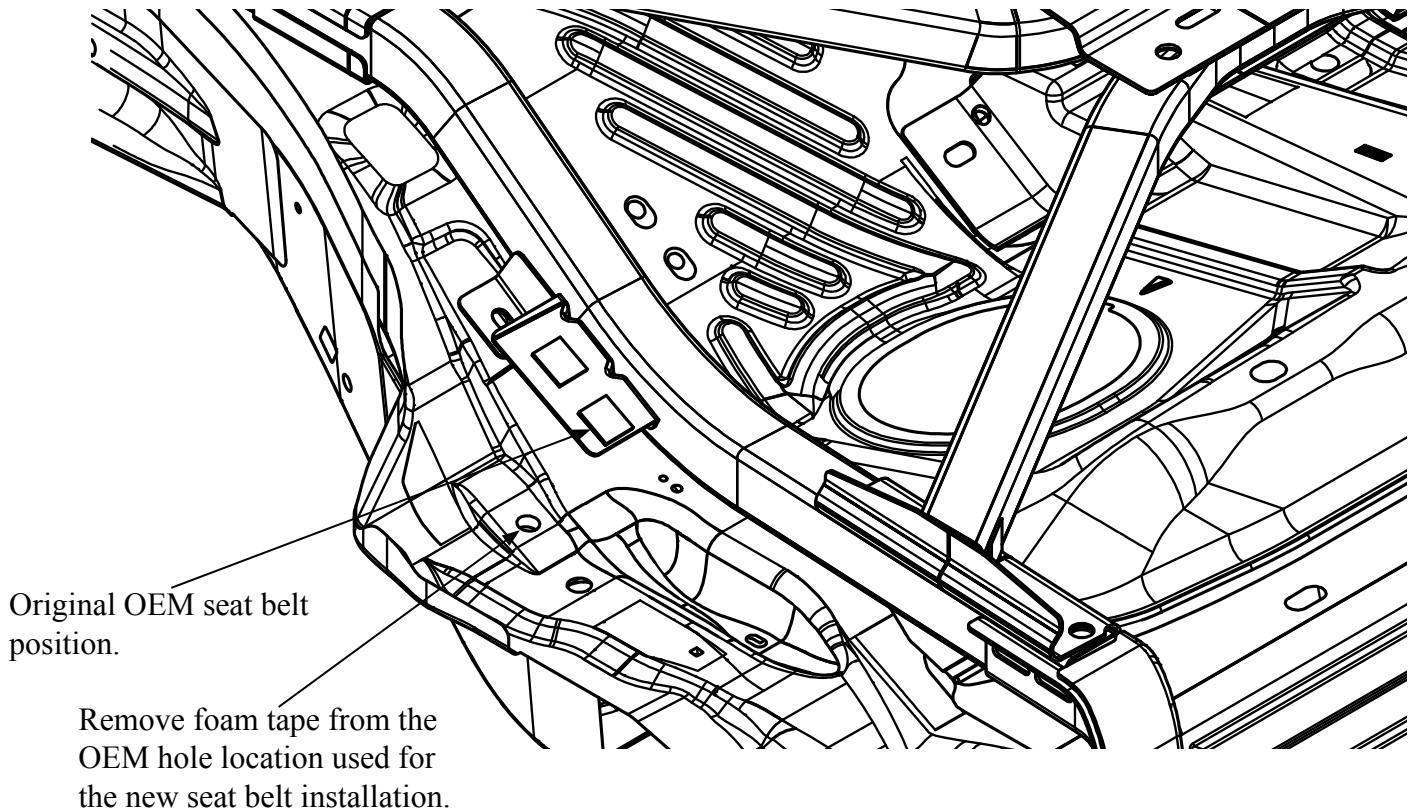

F. Now the seat will need cutouts for the lower buckles. The cutouts will allow the buckles to protrude through when installing the seat. Use the template on the last pages as a guide to locate cutouts. Use a marker to create a cut line. Drill out the four corners of the rectangular cutout and use a utility knife or cutting tool to remove cutout areas. Test to see if the buckles fit through and adjust the cutouts if needed.

G. After the seat has been cutout, then place the seat inside the vehicle. Place the seat onto rear seat area while feeding the lower buckles through the cutouts in the seat. Push the seat all the way toward the back of the vehicle and all the way up against the rear deck to the proper position. With the seat held in position, install the top four (3X77) screws and (3X78) finish washers through the seat and into the vehicle sheet metal. Install the four lower screws and finish washers to secure the bottom of the seat as shown in Figure 7.

**Buckle
Cutouts**

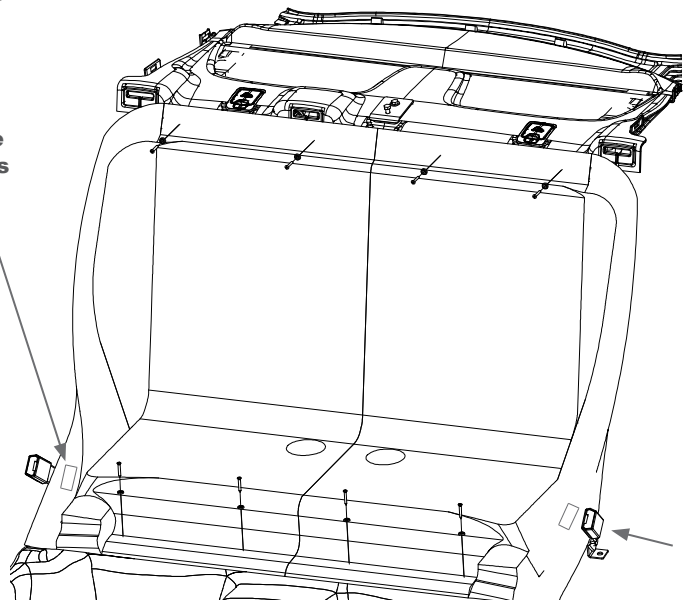

Fig. 7

VII. Installing The Outboard Seat Belts.

- A. Now install the (3OSB003) seat belt harness on the driver and passenger sides. Position the seat belts so the adjustment strap goes over the chest. Fasten the two seat belts at the top with the single 3/8" (3X131) bolt off the rear deck. Feed the seat belt rubber grommets and covers onto each of the lower portion of the belts and fasten at the bottom through the seat holes using the OEM threaded studs and nuts. Slide the black plastic covers and rubber grommets over top of the holes in the seat and use the 4 (3X72) screws to secure in place. (See Fig. 8)

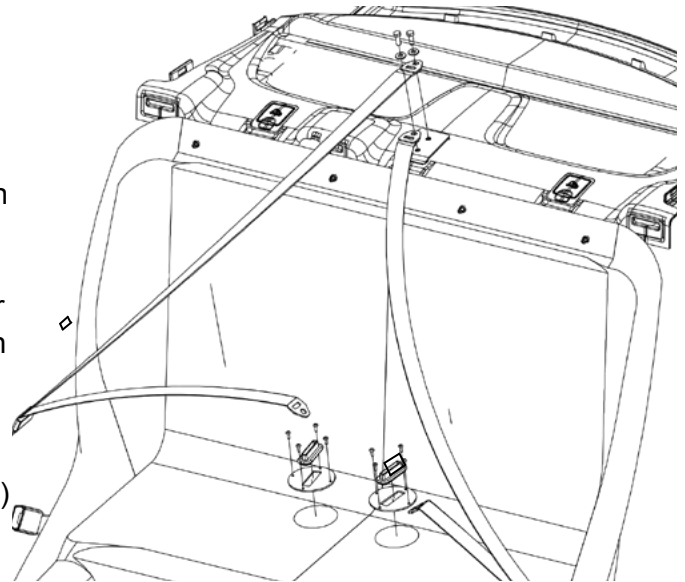

Fig. 8

- B. After the seat belts have been installed, then buckles can be attached to the partition. We recommend drilling holes in the B-pillar side sheet metal panel and attaching as shown in Figure 9. This buckle is used to hold the seat belts open for loading the prisoner.

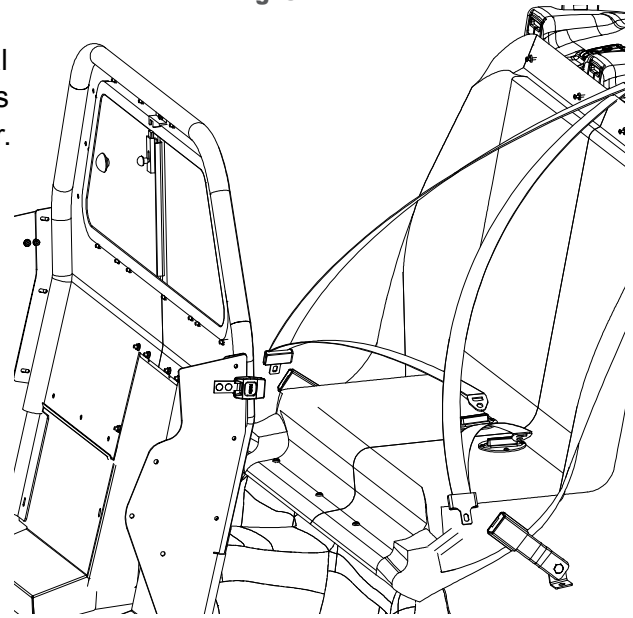

Fig. 9

VIII. Seat Belt Operation Procedures.

- A. The Pro-gard Outboard Seat Belt System has two positions. An open and a closed position allows for quick and easy use when transporting prisoners.
- B. The Open Position - Is buckled into the partition and used for loading the prisoner or storing seat belts in vehicle with no occupancy.
- C. The Closed Position - Is buckled into the lower floppy buckle and used for securing the prisoner safely for transportation. Prisoners should Only be transported with the seat belts closed and securely buckled.

Installation complete!

If you have any problems with this installation then call the toll free number (800-480-6680) and ask for technical assistance.

FABRICATED PARTS LIST			
ITEM	QTY	PART NUMBER	DESCRIPTION
1	1	3OSB3615-05	OSB Cover Plate
2	1	3OSB3615-07	OSB Rear Lower Washer
3	1	3OSB3615-12	OSB Lower Bracket
4	1	3OSB3615-14	OSB Upper Bracket
5	2	3OSB-01	BUCKLE MOUNTING TAB
6	2	3OSB4715-06	LOWER BUCKLE BRACKET
7	2	3OSB003	SEAT BELT HARNESS
8	2	3OSB002	LOWER FLOPPY BUCKLE
9	2	3OSB003-03	PARTITION BUCKLE
10	2	3S3611-21	UPPER MOUNTING CLIPS

ADDITIONAL REQUIRED ITEMS LIST			
ITEM	QTY	PART NUMBER	DESCRIPTION
27	1	4P36XXX	PARTITION ASSEMBLY (VARIES)
28	1	4K3613	PARTITION KIT
29	1	3S36INT13	TRANSPORT SEAT

HARDWARE LIST			
ITEM	QTY	PART NUMBER	DESCRIPTION
11	2	3S5001	RUBBER GROMMET
12	2	4S6000C	SEAT BELT COVER
13	3	3X131	3/8-16 x 1.00" HEX HD YELLOW ZINC
14	3	3X120	3/8-16, Hex Nylon Insert Locknuts, Grade 8, Yellow Zinc
15	4	3X36	1/4-20 X 5/8 CARRIAGE BOLT
16	4	3X16Z	1/4-20 WHIZ NUT
17	20	3X72	8-32 X 5/8 PHIL PAN HD MS
18	4	3X121	3/8 FLAT WSHR, YZ
19	8	3X77	#10-12 x 1-1/2" Oval Head Philips Sheet Metal Screw
20	8	3X78	#10 Finish Washer, Chrome
21	2	3X174	1/2-13 x 1" HHCS, GR8, Blk Zn/C
22	2	3X175	1/2" WSHR Split Lock, Blk Zn/C
23	2	3X176	1/2-13 NUT, GR8, Blk Zn/C
24	8	3X162	SELF TAPPING SCREW
25	2	3S601	FLOOR PAN RUBBER PLUG
26	3	3OSB3615-08	PLASTIC COVER

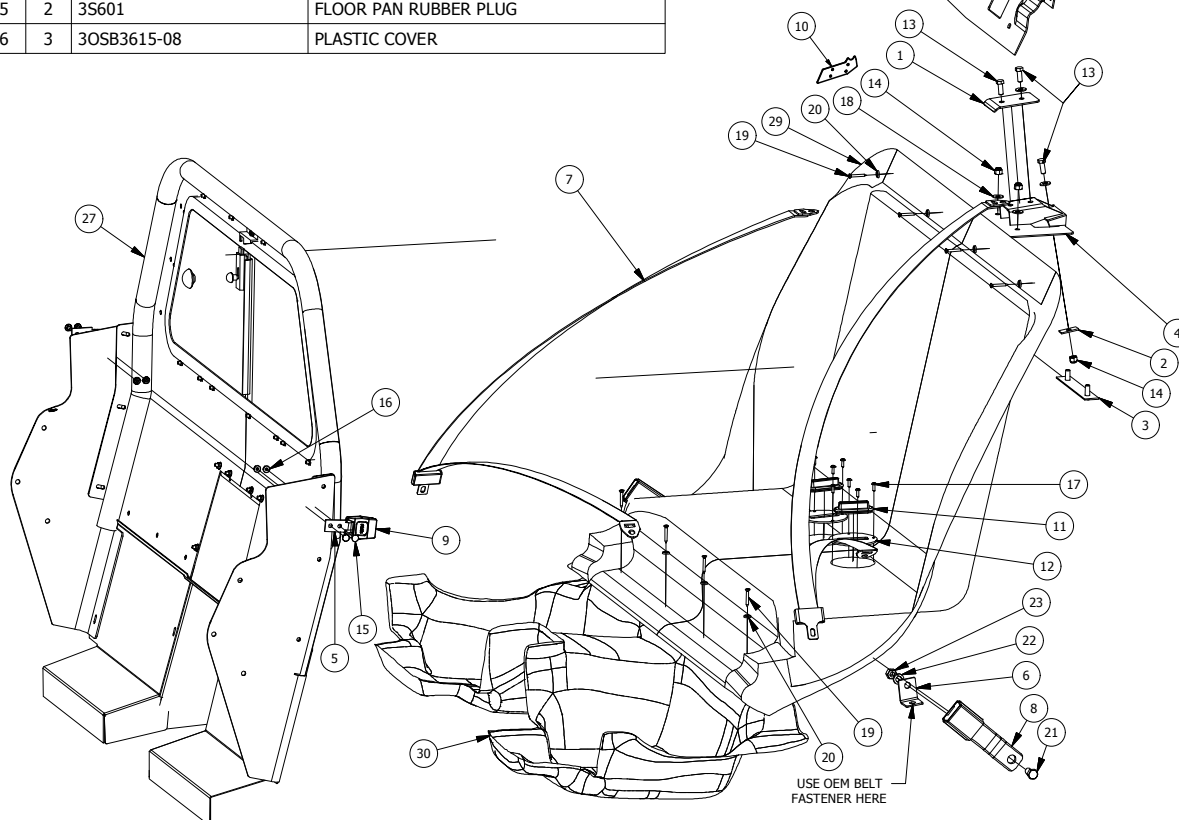
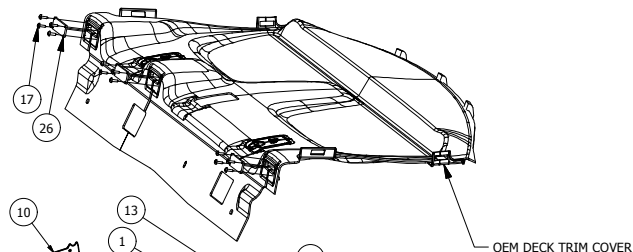

TOP

SEDAN OSB DRIVER'S SIDE TEMPLATE

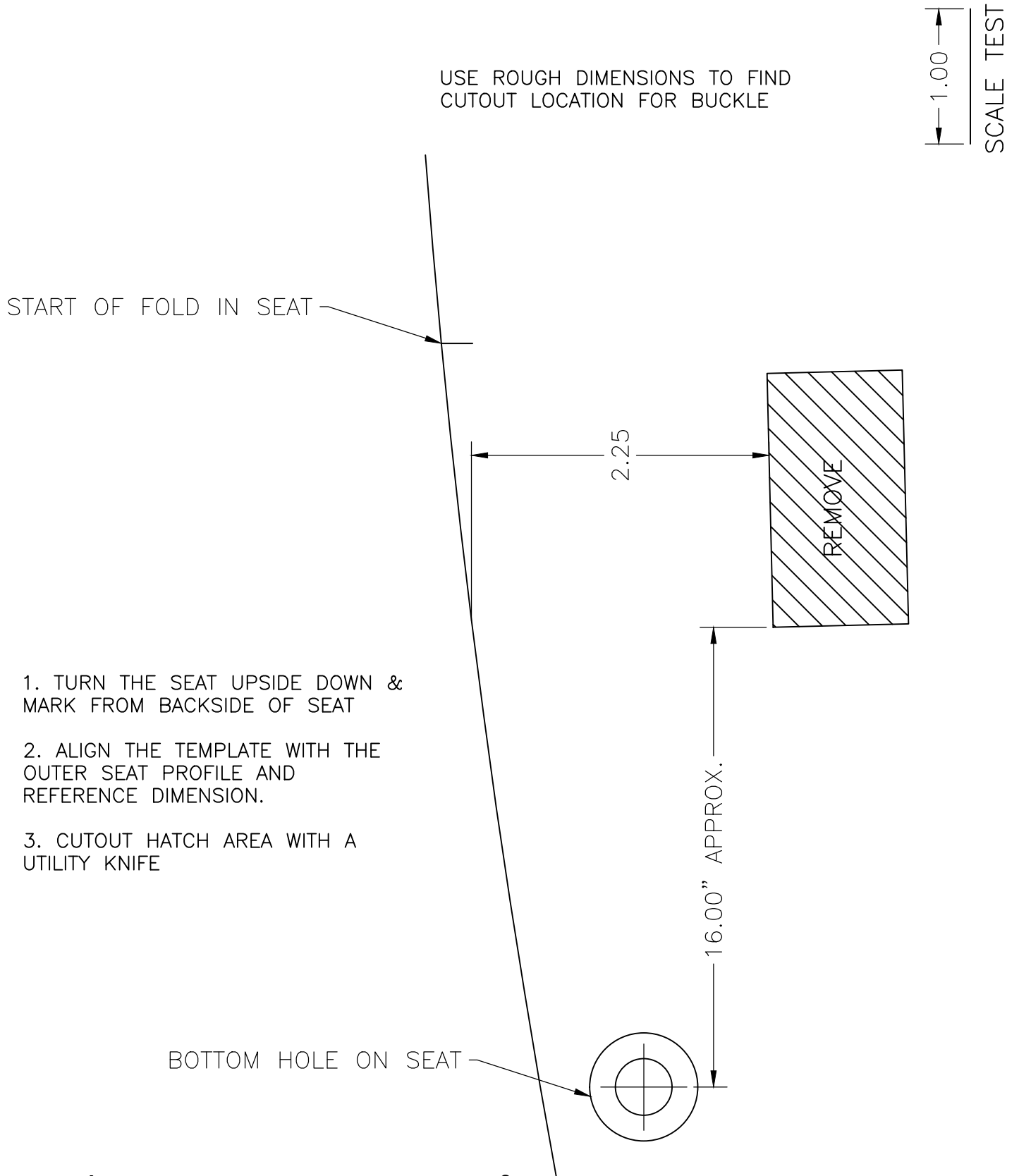

TOP

SEDAN OSB PASSENGER'S SIDE
TEMPLATE

USE ROUGH DIMENSIONS TO FIND
CUTOUT LOCATION FOR BUCKLE

1.00
SCALE TEST

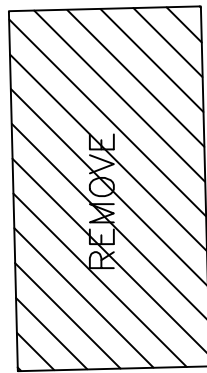

3.00

START OF BEND

16.00" APPROX.

1. TURN THE SEAT UPSIDE
DOWN & MARK FROM BACKSIDE
OF SEAT

2. ALIGN THE TEMPLATE WITH
THE OUTER SEAT PROFILE AND
REFERENCE DIMENSION.

3. CUTOUT HATCH AREA WITH A
UTILITY KNIFE

BOTTOM HOLE ON SEAT

