

INSTALLATION GUIDE
SELF SUPPORTING
GUN RACK FOR
2013+ FORD EXPEDITION

Pro-gard[™]
PRODUCTS LLC.

STRONG | RELIABLE | SECURE

pro-gard.com
800.480.6680

THESE COMPONENTS ARE REQUIRED
TO INSTALL THE PRO-GARD G7009 SERIES WEAPONS SYSTEM

3G7009A (weapon specific)
GUN RACK
&
3G5813 GUN RACK
MOUNT BASE

3G7009A GUN RACK

3G5813 MOUNT BASE

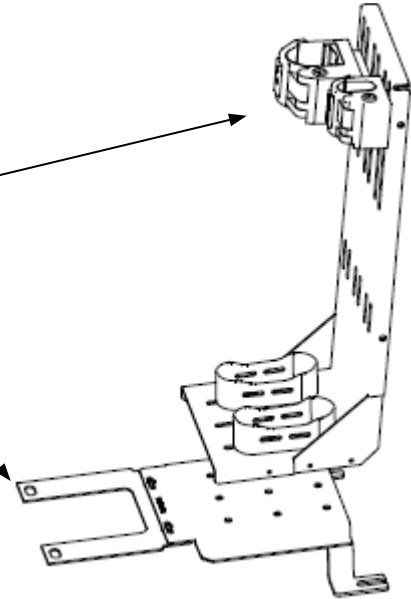

I. Refer to the diagram on the last page of these instructions to verify all parts were received.

II. The following tools will be required to complete the installation.

- 15mm open end wrench
- 5mm socket
- 3/8" Ratchet (Suggested)
- Phillips screw driver
- 18mm socket

III. Installing the Mount Base.

A. Remove the cup holder trim from the rear of the console. By gently applying an upward motion to the trim.

B. Remove the screws holding the rear panel of the console using a 5mm socket.

C. Remove the rear console panel and disconnect any wire connectors.

D. Using a 15mm open end wrench remove the (2) bolts located under the console.

E. Remove the discard the (2) trim 2nd row seating pieces, using a 18mm socket remove both bolts.

F. Gently lift up on the console and slide bracket 3G5813-02 under the console mounting bracket. Using the OEM bolts hand tighten the bracket down leaving loose for adjustment.

G. Place bracket 3G5813-01 on top of 3G5813-02 and align the (2) rear slots with the seat mounting holes, using the 2 OEM bolts hand tighten the bolts leaving loose for adjustment.

H. Using (2) 3X184 bolts, (2) 3X12 washers and (2) 3X16 nuts connect brackets 3G5813-01 and 3G5813-02 together. Adjust brackets so that 3G5813-01 is located as far back towards the rear of the vehicle as possible. Once this is complete tighten all bolts firmly.

I. Re-connect and install factory console panel and cup holders.

IV. Weapons Rack Assembly.

A. Assemble the gun rack unit as shown in (Fig. 4) leaving the plastic ABS backing off while making adjustments. Place butt plate holders 3G4962 at the bottom of the rack and adjust lock to fit weapon. The 3G4904 type gun locks have adjustment screws to fit each weapon's size. Adjust the screw through the back side of the lock and open and close the locking latch until weapon is snug when latch is in the closed position. After the weapons have been properly fitted, then the gun rack can be mounted.

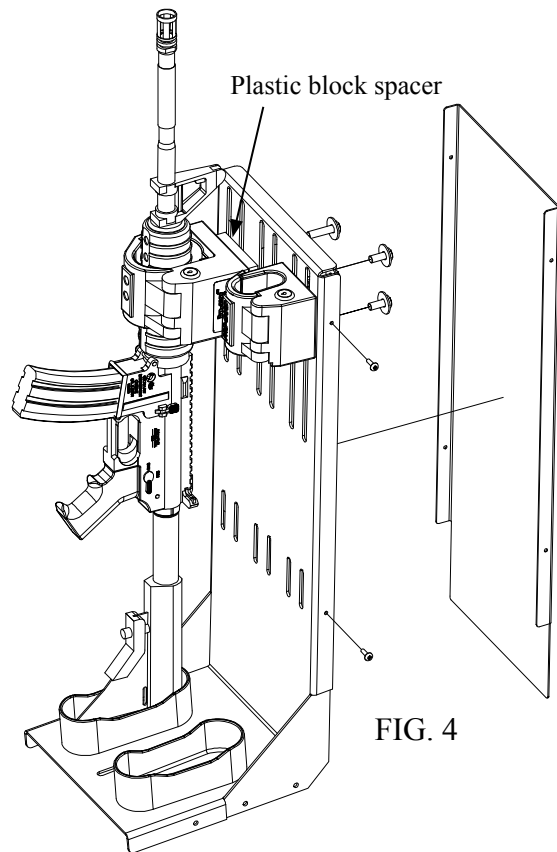

B. Remove weapons from gun rack and install gun rack onto the base mount with 3X74 screws through the Butt Plate Holder as shown in Fig. 5. and tighten. Place weapons in the gun rack and check if any final adjustments are needed to properly fit weapons. If gun rack have charging brackets and trigger guards, then they should also be adjusted to ensure the weapon cannot be discharged.

V. Final installation.

A. Wire electric gun locks per timer instructions. See page 6

B. Re-install the back onto the gunrack with the 4 screws that were removed earlier.

C. Install one foam pad into each butt plate bracket.

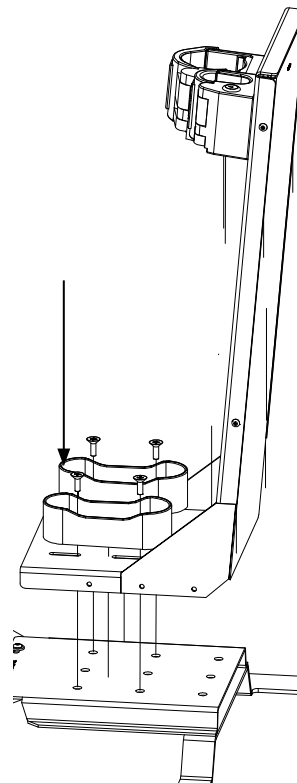

FIG. 5

VI. Lock Head Operating Instructions

To release the weapon:

A. Grasp the weapon, but do not pull it against the lid of the gunlock.

B. While depressing and holding the release button (momentary switch), push and then pull the weapon towards the lid of the gun lock to release it from the lock.

Note: One handed operation is possible utilizing the optional 8 second timer. The timer will unlock the lock for 8 seconds following activation of the momentary switch. If the gun is not pulled out of the lock within 8 seconds after activation of the momentary switch, the lock will automatically re-lock.

Important: If lid of the lock does not release, press in on the lid to release tension and reactivate the release button (unless timer is still active).

VII. Securing the Weapon:

- A. Push weapon firmly and completely into the lock mechanism and firmly close lid.
- B. Check to insure that the lid is locked.
- C. If the lid does not lock, re-seat the weapon firmly and completely into the lock assembly and again apply pressure to the lock lid to seat and re-lock it.

Note: The G4904 Series lock mechanism has a unique override. In the event of power failure, the lock can be opened using a standard handcuff key or other high security key.

VIII. To open the lock with the manual override key:

- A. Fully insert the handcuff key into the hole provided in the lock head. Turn the key 1/4 turn to the left (counter-clockwise). Pull open the lid or pull on the weapon to open it.

Important: Return the key to its original position or remove key completely to close and re-lock the lock.

IX. Installing Optional 8 second timer (3-Wire)

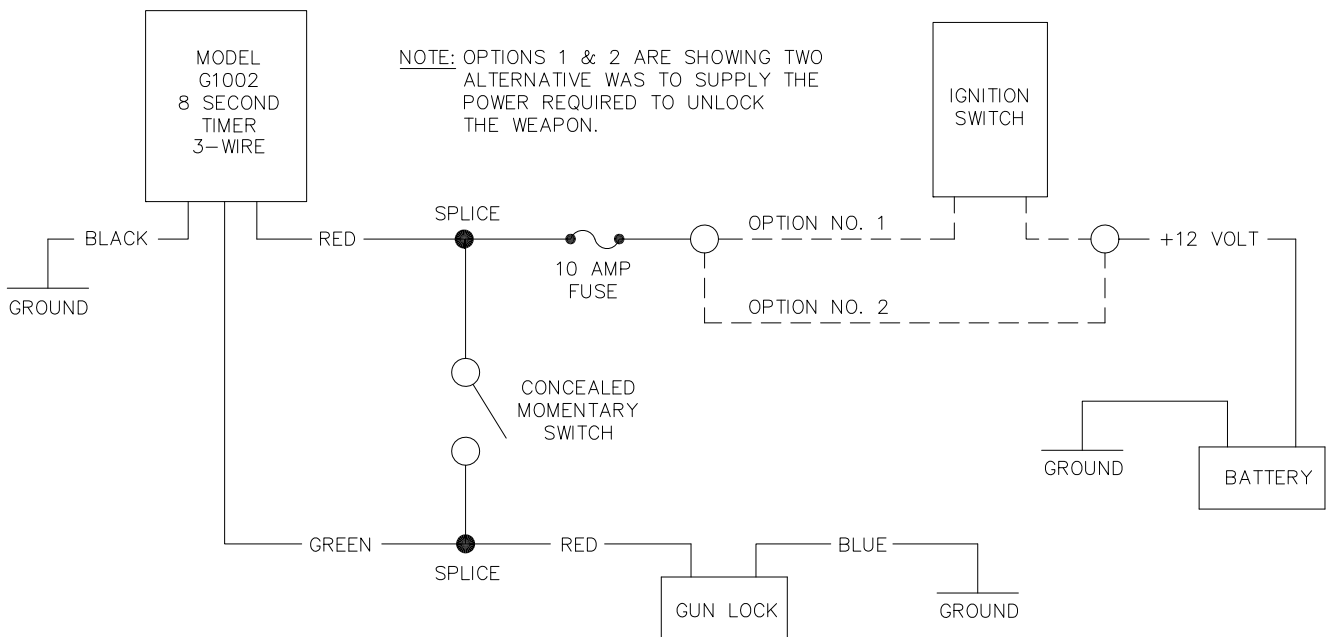

Note: If for any reason the gun lock momentary switch remains activated, such as, the button is damaged, and/or shorted, the unit will time out in 8 seconds and can not be operated again until the defective switch is repaired, thus saving the gun lock solenoid. Do not connect directly to power for more than 20 seconds!

X. Installation Complete

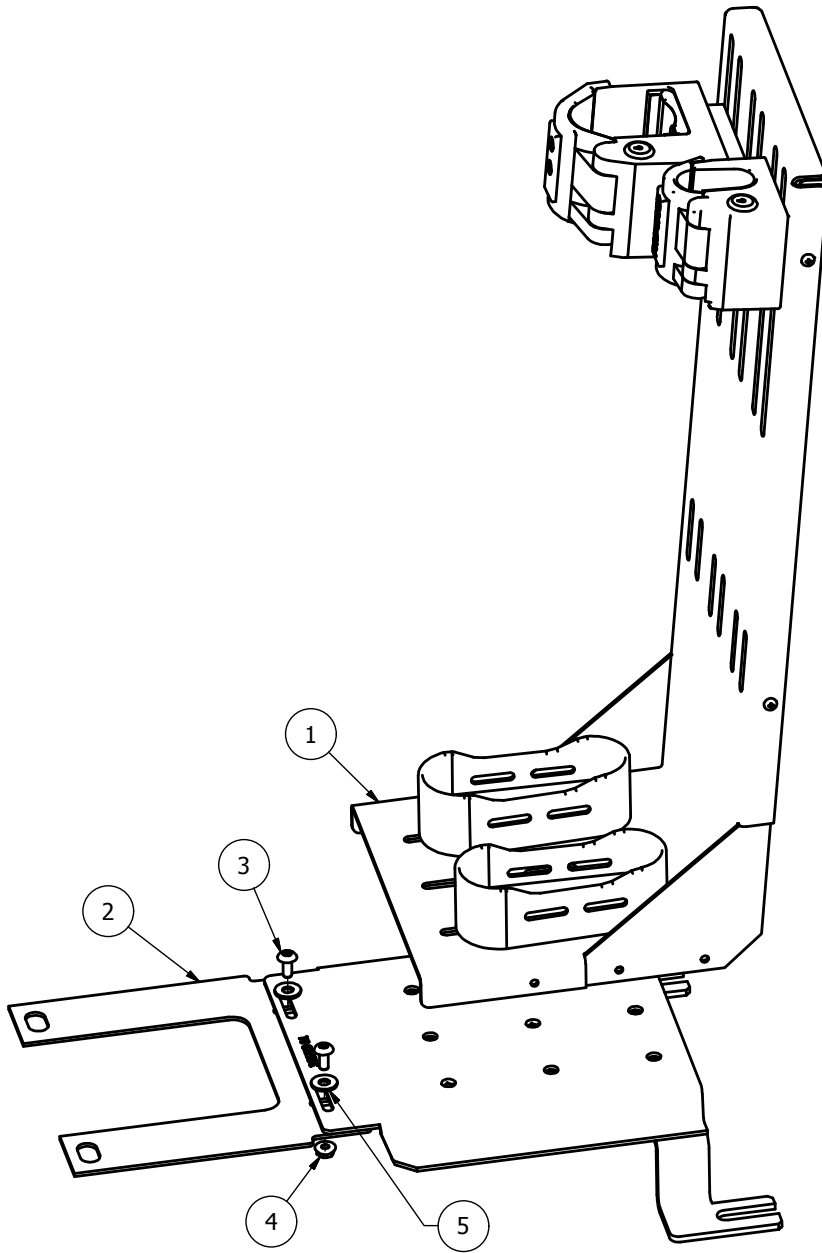

PARTS LIST			
ITEM	QTY	PART NUMBER	DESCRIPTION
1	1	3G7009A	Gun Rack Weapon Specific
2	1	3G5813-02	Expedition Gun Rack Bracket
3	2	3X03	1/4-20 X5/8 PHIL TRUSS HD MS
4	2	3X16	1/4-20 HEX NUT
5	2	3X12	1/4 FLAT WASHER, BLACK

* QTY MAY VARY DEPENDING ON CONFIGURATION
 ** ITEM MAY VARY DEPENDING ON CONFIGURATION