

INSTALLATION GUIDE

**2020 - CURRENT
FORD POLICE INTERCEPTOR UTILITY
PARTITION
PRPSP47XXUINT20
PFW47XXUINT20**

Pro-gardTM
PRODUCTS LLC.

STRONG. RELIABLE. SECURE.

**THESE COMPONENTS ARE REQUIRED
TO INSTALL THE PARTITION**

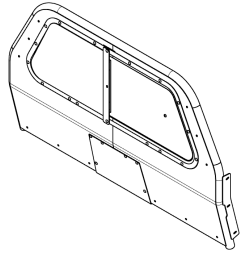

3P5000



4PAK472000

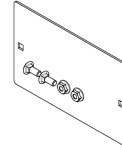

4LEK472003



4WIK472000

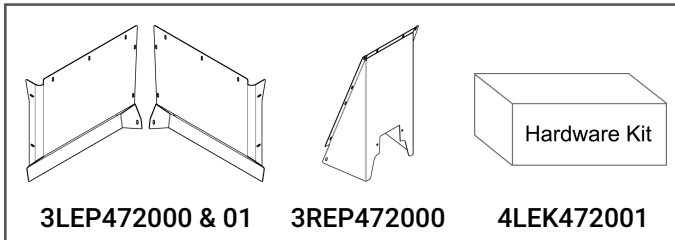

OR

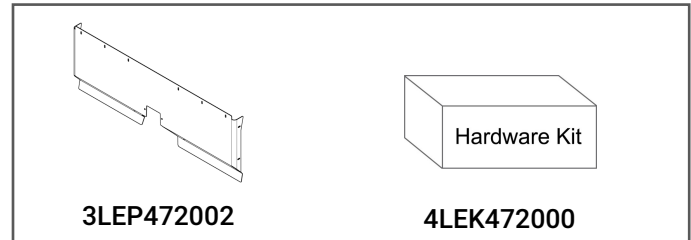

I. The following tools will be required to complete the installation

- | | | |
|--------------------|---------------------|----------------------------|
| A. 3/16" drill bit | D. 1" hole saw | G. 7/16" open ended wrench |
| B. 3/8" socket | E. 3/16" hex wrench | H. 13mm socket |
| C. Centering punch | F. 7/16" socket | I. Trim removal tools |

II. Read all instructions and refer to the Parts List to ensure all parts were received. If installing a Viper Shield Partition, locate and follow those instructions in place of these.

WARNING: *Locate all wiring, fuel lines, brake lines, coolant lines, and refrigerant lines before drilling any holes or installing any self-drilling fasteners.*

III. B-Pillar Preparation

- Remove the front and rear passenger door seal rubbers from the B-pillar and the front and rear sills.
- Remove the front and rear passenger door sill plates.
- Remove the driver lower B-pillar trim. There is (1) vertical clip in each of the front and rear sill areas. The remaining clips are horizontal on the B-pillar.
- Locate the bundle of wires that is routed up the B-pillar. Remove the uppermost clip from the B-pillar making note of the slot it was inserted in.
- Remove the clip from the wire bundle to prevent rattles.
- Repeat on the passenger side of the vehicle.

IV. B-Pillar Bracket Installation

- A. Place the Driver B-pillar Bracket [3PAK472000] against the vehicle B-pillar. Route the bundle of wires underneath the bracket and ensure that the seatbelt is on top of the bracket. The order from outside to inside should be: vehicle B-pillar, wire bundle, B-pillar bracket, seatbelt.
- B. (1) of the [3X162] self drilling screws is used to set the height of the bracket. Insert a screw through the lowest hole on the bracket (Fig 1a) and into the slot that the wire clip was removed from in section III step D (Fig 1b). The screw should be in the very bottom of the slot.

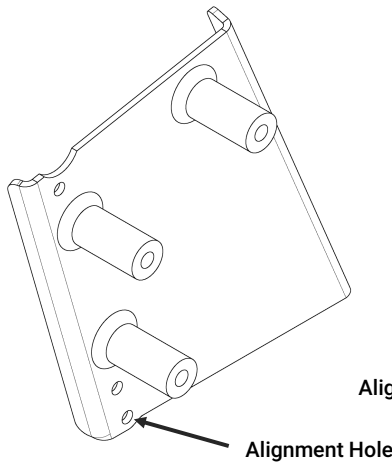

Figure 1a

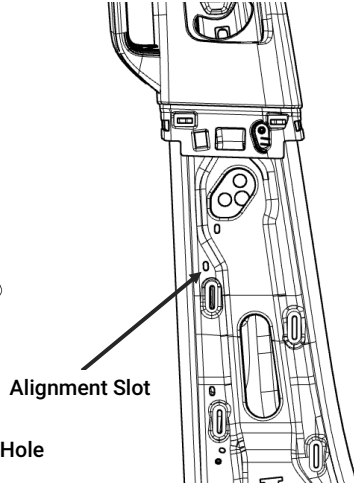

Figure 1b

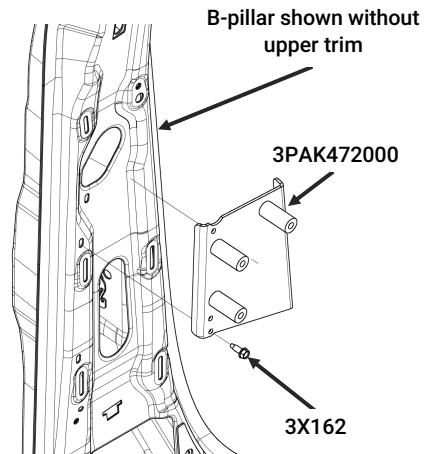

Figure 1c

- C. Verify that the B-pillar bracket is located correctly by checking that the notch on the top of the bracket is well-fit around one of the embossed areas for an upper B-pillar trim clip.
- D. Secure the B-pillar bracket in place with a 3/8" socket and (4) [3X162] self drilling screws. The holes can be pre-drilled with a 3/16" drill bit if necessary.
- E. Remove the locating screw that was used in step B.
- F. Repeat on the passenger side using the Passenger B-pillar Bracket [3PAK472001].

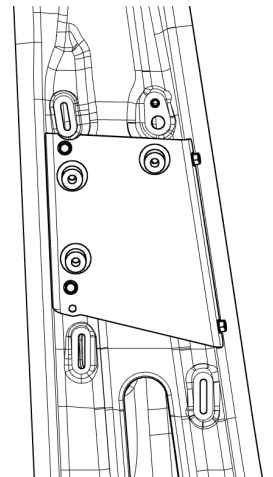

Figure 2

V. B-pillar Trim Modification and Reinstallation

- A. Use the template supplied on the last page to mark the three hole locations in each of the lower B-pillar trim panels.
- B. Using a 1" hole saw, drill the holes marked in the previous step.
- C. Reinstall the lower B-pillar trim followed by the front and rear door sill plates and the door seal rubber.
- D. The OEM components should now be fully reassembled.

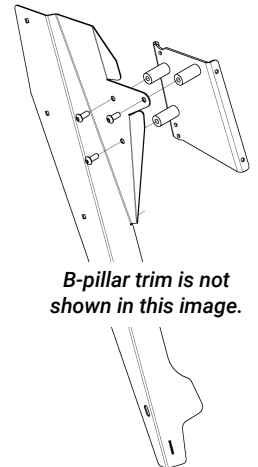

Figure 3

VI. Mounting Plate Installation

- A. Locate the Driver Mounting Plate [3PAK472010] and (3) button head screws [3X149].
- B. Align the (3) holes in the plate with the (3) standoffs protruding through the B-pillar trim and loosely secure with the button head screws. The fasteners will be tightened in a later section.
- C. Repeat on the passenger side using the Passenger Mounting Plate [3PAK472009].

VII. Partition Installation

NOTE: Due to the size and weight of the partition it is recommended that two people lift and position the partition in the vehicle.

- A. Prepare (3) carriage bolts [3X36] and (3) whiz nuts [3X16Z] on each side of the vehicle.
- B. Position the partition [3P5000] inside the vehicle and align the three uppermost holes in each of the mounting plates with the respective slots on the partition. The flanges on the partition go on the inside face of the mounting plates.
- C. Loosely secure in place with the fasteners prepared in step A. Install the fasteners such that the smooth head of the carriage bolt is facing towards the outside of the vehicle. The fasteners will be tightened in a later section.

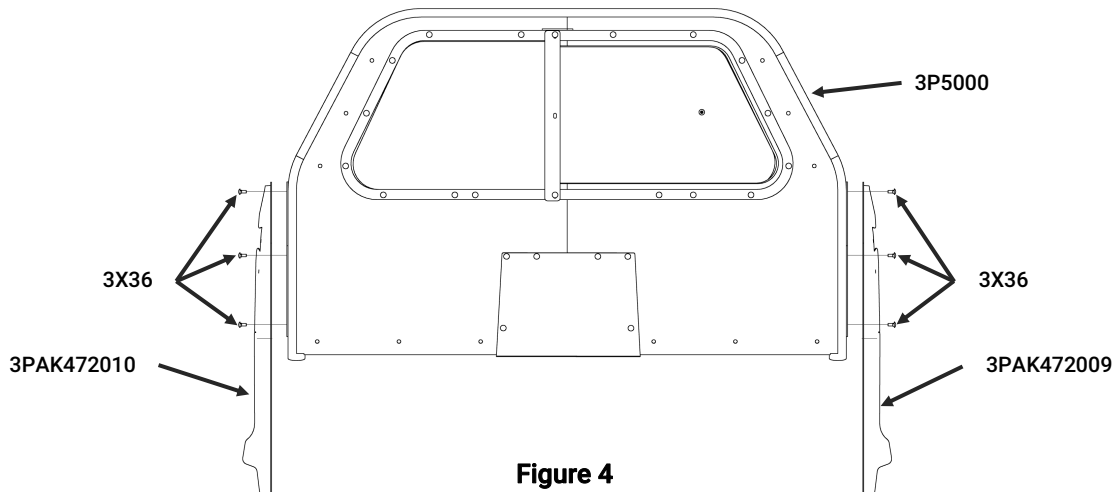

Figure 4

VIII. Wire Raceway Cover Kit

- A. Locate the Wire Raceway Cover Kit [4LEK472003] which consists of the Wire Raceway Cover Panel [3LEP472004], (2) carriage bolts [3X36], and (2) whiz nuts [3X16Z].
- B. If not using the OEM Wire Raceway, place the Wire Raceway Cover Panel on the inside of the corresponding Lower Extension Panel and secure with the (2) fasteners. If the OEM Wire Raceway is to be utilized, install only the fasteners in order to fill in the holes. Tighten the fasteners with a 7/16" socket.

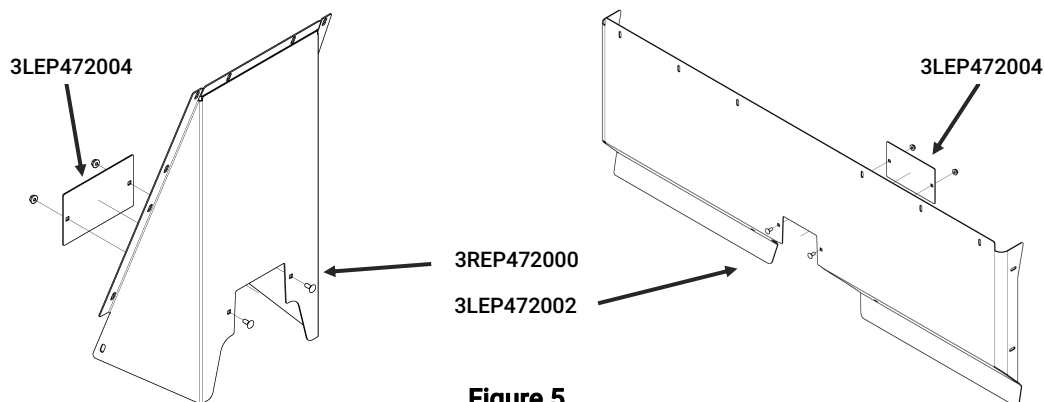

Figure 5

For the Full Width Lower Extension Panel [3LEP472002] proceed to section IX.

For the Lower Extension Panels with the Recess Panel [3LEP472000, 3LEP472001, and 3REP472000] proceed to section X.

If no Lower Extension Panels are being installed, proceed to section XI.

IX. Full Width Lower Extension Panel

- A. Position the Full Width Lower Extension Panel into the vehicle placing the bottom of the panel into the footwell.
- B. Slide the panel forward into position making sure that the flanges slide between the mounting plates and the partition on both sides of the vehicle (Fig 6a).
- C. Align the (10) holes in the Full Width Lower Extension Panel with the (6) in the partition and the (2) in each mounting plate (Fig 6b). Loosely install a carriage bolt [3X36] and a whiz nut [16Z] into each hole. Install the fasteners such that the smooth head of the carriage bolt is facing the rear of the vehicle.
- D. Proceed to section XI.

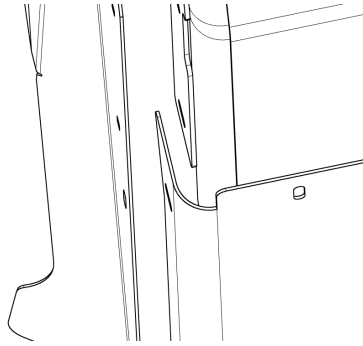

Figure 6a

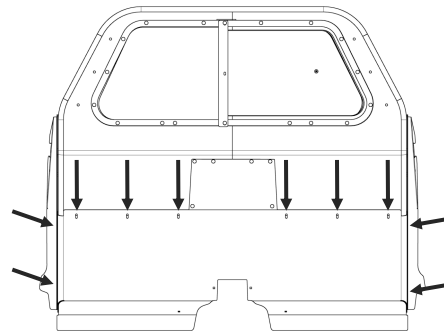

Figure 6b

X. Lower Extension Panels with the Recess Panel

- A. Remove the 6 fasteners holding the cover plate to the middle of the partition. Set the fasteners aside and discard the cover plate.
- B. Set the Recess Panel [3REP472000] into the vehicle with the flanges towards the front of the vehicle. Slide to the rear of the footwell.
- C. Place the Driver Lower Extension Panel [3LEP472000] into the vehicle and slide the outside flange between the partition and the mounting plate (Fig 7a). Align the three holes at the top of the panel and the two holes along the outside of the panel with their respective holes in the partition and the mounting plate (Fig 7b).
- D. Loosely install a carriage bolt [3X36] with whiz nut [3X16Z] into each of the (5) holes identified in the previous step. Install the fasteners such that the smooth head of the carriage bolt is facing towards the rear of the vehicle.
- E. Repeat for the passenger side with the Passenger Lower Extension Panel [3LEP472001].
- F. Slide the Recess Panel forward and align all (12) holes with their respective holes in the partition and lower extension panels (Fig 7c).
- G. Loosely install a carriage bolt [3X36] with whiz nut [3X16Z] into each of the (12) holes identified in the previous step. Reuse the fasteners that were removed from the cover plate in step (A). Install the fasteners such that the smooth head of the carriage bolt is facing the rear of the vehicle.

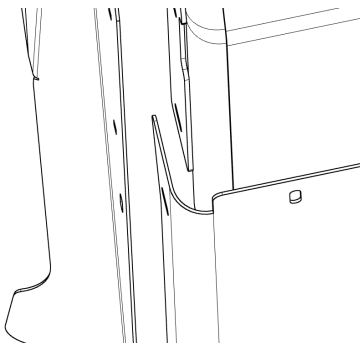

Figure 7a

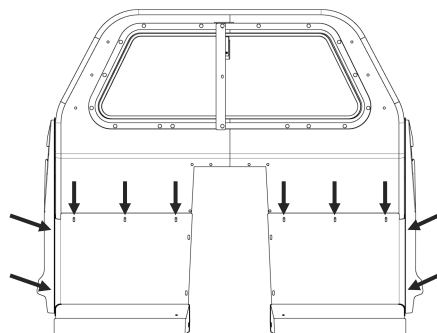

Figure 7b

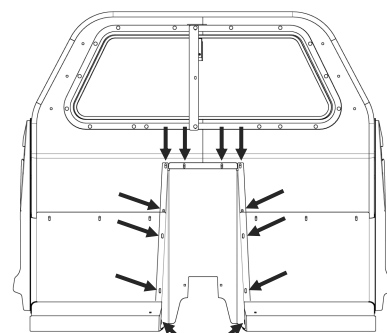

Figure 7c

XI. Tightening the Bolts

- A. Adjust the partition forwards or backwards until a desirable fit is achieved. Sliding the partition forward will maximize prisoner space while sliding the partition backward will maximize officer space. If using the OEM rear seat it is recommended to slide the partition all the way forward. Tighten the (6) fasteners holding the partition to the mounting plates using a 7/16" socket. These are the fasteners that were loosely installed in section VII, step C.
- B. Have a second person push forward on the top of the partition while the first person uses a 3/16" Hex wrench to tighten the (6) button head screws holding the mounting plates to the B-pillar brackets. These are the fasteners that were loosely installed in section VI, step B. This step will slightly rotate the partition causing it to fit tighter against the headliner.
- C. Adjust the Lower Extension Panel(s) (if applicable) to achieve the desired fitment and then tighten all the relevant fasteners using a 7/16" socket.

XII. Install the Reinforcement Brackets

- A. Using a 13mm socket, remove the rear inboard bolt from the drivers seat.
- B. Place (1) Reinforcement Bracket [3PAK472004] on top of the seat rail and loosely reinstall the OEM bolt removed in step A.
- C. Align the slotted end of the Reinforcement Bracket with the corresponding hole in the Lower Extension Panel (3LEP472000 or 3LEP472002). Use (1) carriage bolt [3X36] and (1) whiz nut [3X16Z] to secure the bracket to the Lower Extension Panel. Tighten with a 7/16" socket.
- D. Tighten the seat bolt that was loosely installed in step B to OEM torque.
- E. Repeat for the passenger side using the second Reinforcement Bracket [3PAK472004], (1) carriage bolt [3X36] and (1) whiz nut [3X16Z].

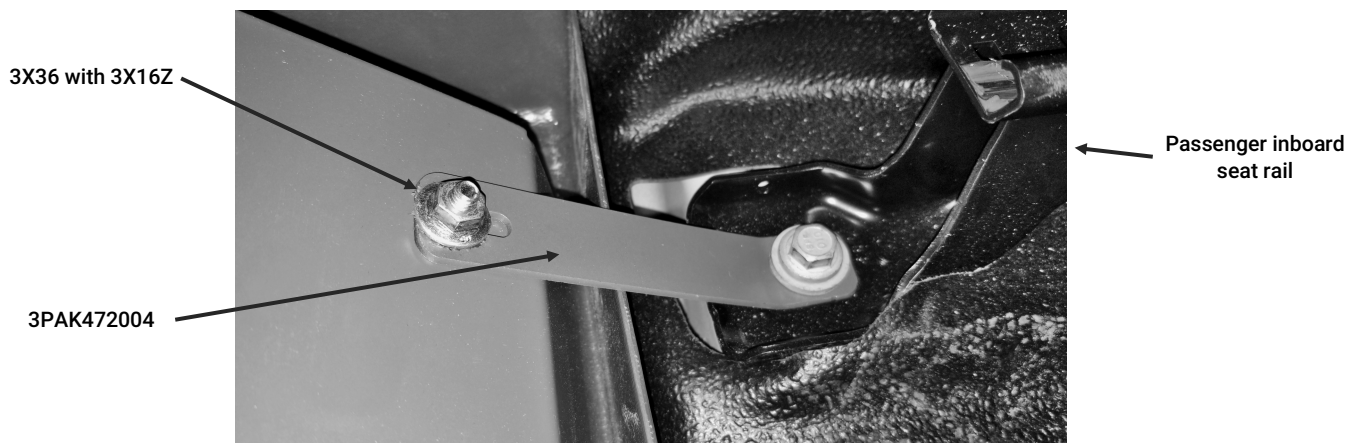

Figure 8

XIII. Finishing Steps

- A. Ensure all fasteners installed in this installation are tight and all panels secure.
- B. Install the wings according to the instructions included with them.
- C. Place plastic caps [3X145] over all fasteners protruding from the partition.

Installation complete

If you have any problems with this installation or have any questions please call (800-480-6680) and ask for technical assistance.

Full Width Lower Extension Panel

4PAK472000			
ITEM	QTY	PART NUMBER	REVISION NUMBER DESCRIPTION
1	1	3P5000	PARTITION
2	1	3PAK472000	A DRIVER B-PILLAR BRACKET
3	1	3PAK472001	A PASSENGER B-PILLAR BRACKET
4	1	3PAK472010	A DRIVER MOUNTING PLATE
5	1	3PAK472009	A PASSENGER MOUNTING PLATE
6	1	3LEP472002	C LOWER EXTENSION PANEL FW
7	10	3X16Z	#14 x 3/4" SELF DRILLING HEX HEAD SCREW
8	6	3X149	5/16-18 X 3/4 BSHCS, BK
9	6	3X36	1/4-20 X 5/8 CARRIAGE BOLT
10	6	3X16Z	1/4-20 LARGE HEX WHIZ NUT-ZINC
11	2	3PAK472004	A REINFORCEMENT BRACKET

4LEK472000			
ITEM	QTY	PART NUMBER	REVISION NUMBER DESCRIPTION
12	12	3X36	1/4-20 X 5/8 CARRIAGE BOLT
13	12	3X16Z	1/4-20 LARGE HEX WHIZ NUT-ZINC

4LEK472003			
ITEM	QTY	PART NUMBER	REVISION NUMBER DESCRIPTION
14	1	3LEP472004	B WIRE RACEWAY COVER PANEL
15	2	3X36	1/4-20 X 5/8 CARRIAGE BOLT
16	2	3X16Z	1/4-20 LARGE HEX WHIZ NUT-ZINC

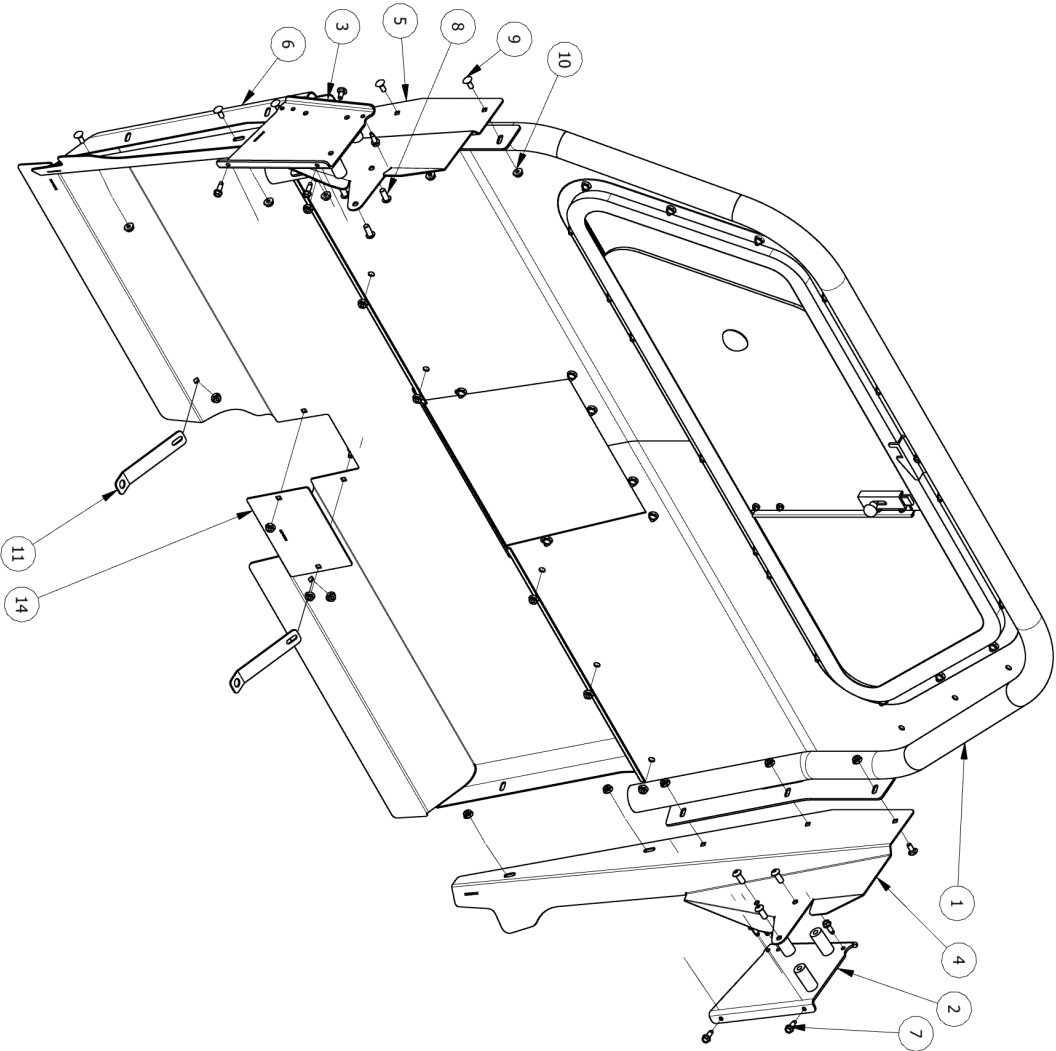

Lower Extension Panels with Recess Panel

4PAK472000			
ITEM	QTY	PART NUMBER	DESCRIPTION
1	1	3P5000	PARTITION
2	1	3PAK472000	DRIVER B-PILLAR BRACKET
3	1	3PAK472001	PASSENGER B-PILLAR BRACKET
4	1	3PAK472010	DRIVER MOUNTING PLATE
5	1	3PAK472009	PASSENGER MOUNTING PLATE
6	1	3LEP472000	DRIVER LOWER EXTENSION PANEL
7	1	3LEP472001	PASSENGER LOWER EXTENSION PANEL
8	1	3REP472000	RECESS PANEL WELDMENT
9	10	3X16Z	#14 X 3/4" SELF DRILLING HEX HEAD SCREW
10	6	3X149	5/16-18 X 3/4 BSHCS, BK
11	6	3X36	1/4-20 X 5/8 CARRIAGE BOLT
12	6	3X16Z	1/4-20 LARGE HEX WHIZ NUT-ZINC
13	2	3PAK472004	REINFORCEMENT BRACKET

4LEK472001			
ITEM	QTY	PART NUMBER	DESCRIPTION
14	18	3X36	1/4-20 X 5/8 CARRIAGE BOLT
15	18	3X16Z	1/4-20 LARGE HEX WHIZ NUT-ZINC

4LEK472003			
ITEM	QTY	PART NUMBER	DESCRIPTION
16	1	3LEP472004	WIRE RACEWAY COVER PANEL
17	2	3X36	1/4-20 X 5/8 CARRIAGE BOLT
18	2	3X16Z	1/4-20 LARGE HEX WHIZ NUT-ZINC

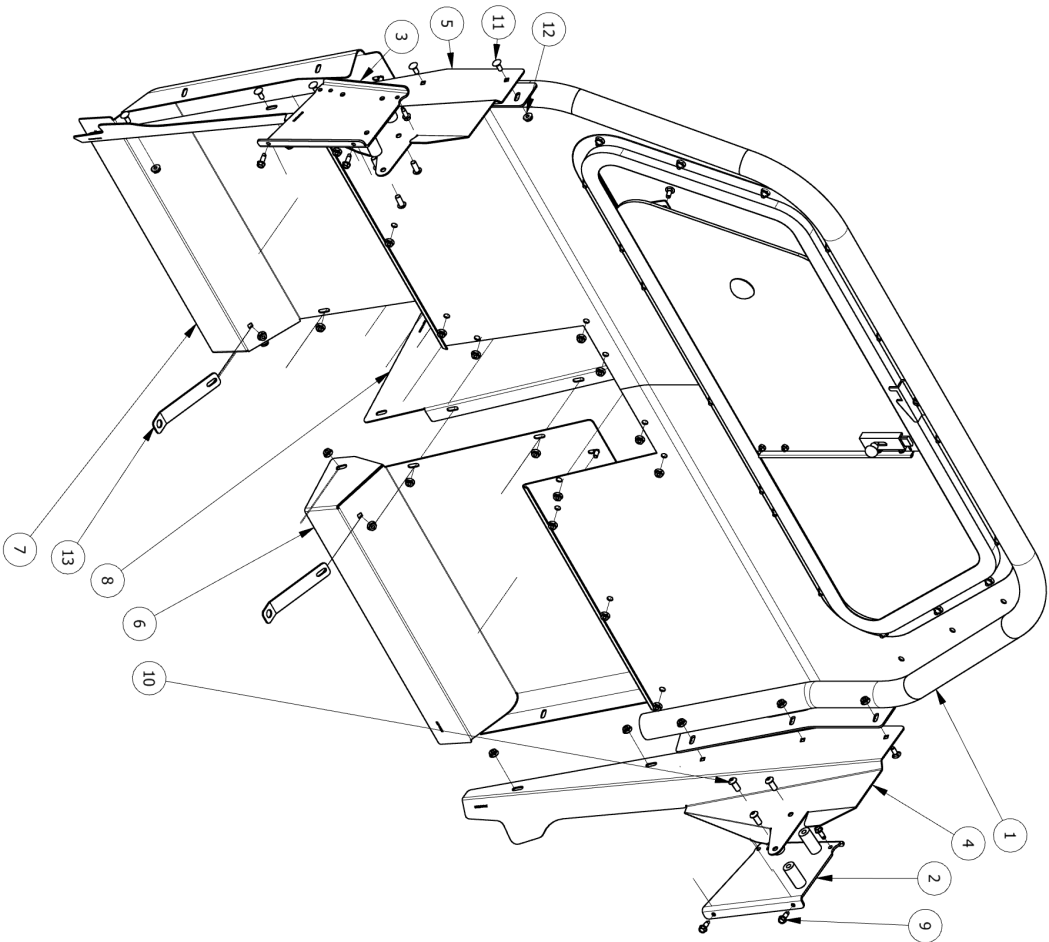

2020 - Current
Ford Police Interceptor Utility
B-pillar Template

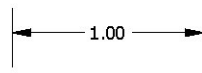
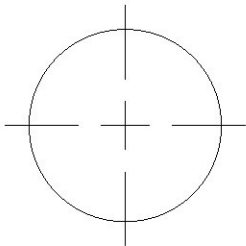
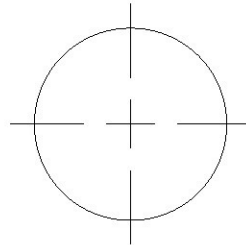
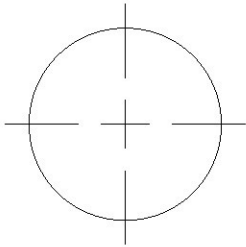

Directions

1. Cut and remove the hatched area. Cut the horizontal lines on the left side of the template.
2. Place the template against the back side of the lower passenger B-pillar trim.
3. Align as shown in the image with the slices in the top left of the template allowing the top three ribs of the trim to protrude through. The lower tab of the template should be just touching the uppermost trim standoff.
4. Use a center punch to mark the center of the holes in the B-pillar trim.
5. Remove the template and drill the marked locations with a 1" hole saw.
6. Flip the template over and repeat for the driver B-pillar trim. Use the holes left in the template from step 4 for the locations to center punch the driver side.